

Extracted from Approved Kam Tin North Outline Zoning Plan No. S/YL-KTN/11

N.T.S	<b>Location Plan</b>	<b>Goldrich Planners &amp; Surveyors Ltd.</b>
January 2024	Lot 27 RP in D.D. 110 and adjoining Government Land Kam Tin North, New Territories	Plan 1 ( P 23025 )

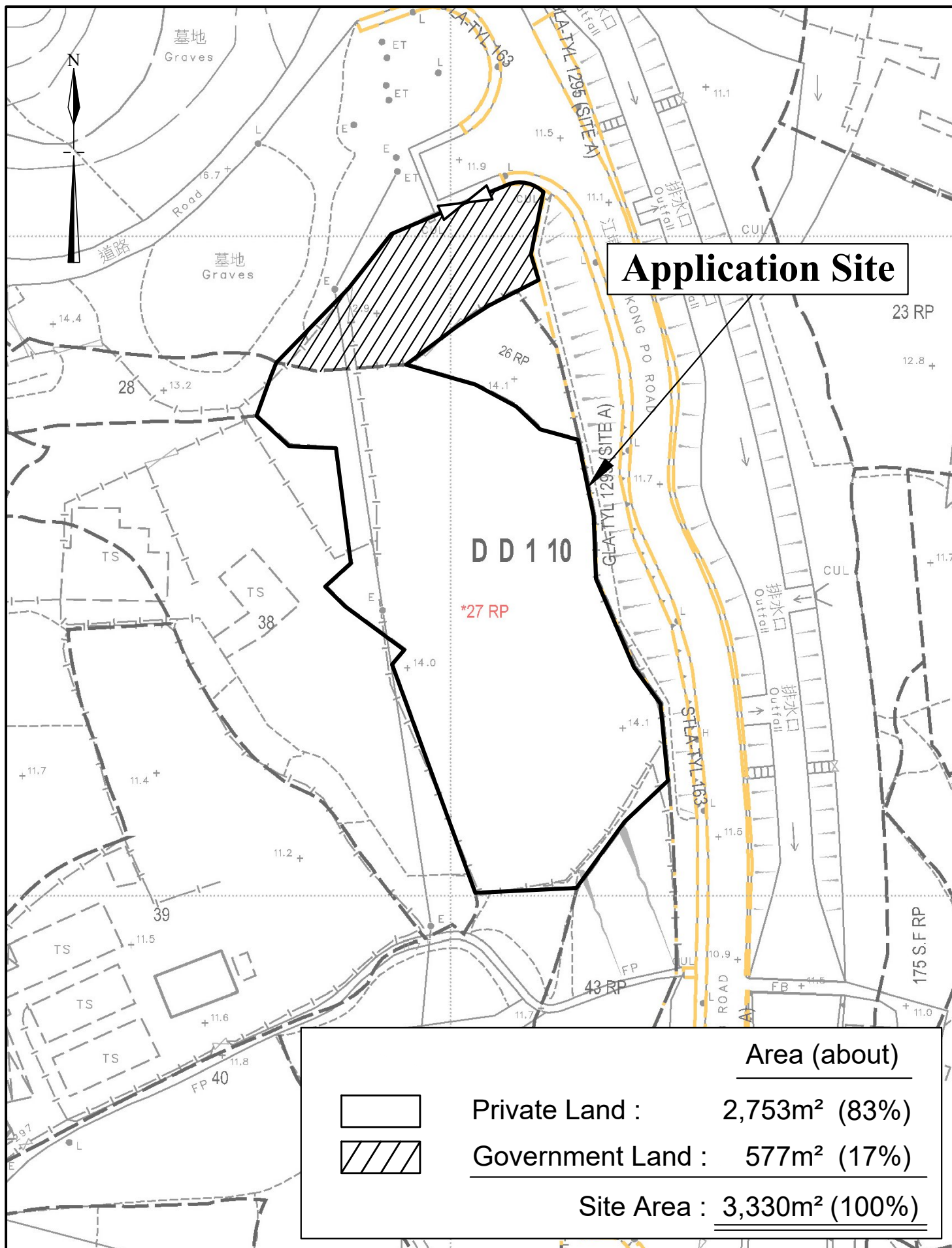

1:750

**Lot Index Plan**

**Goldrich Planners & Surveyors Ltd.**

January 2024

**Lot 27 RP in D.D. 110 and adjoining Government Land  
Kam Tin North, New Territories**

**Plan 2  
( P 23025 )**

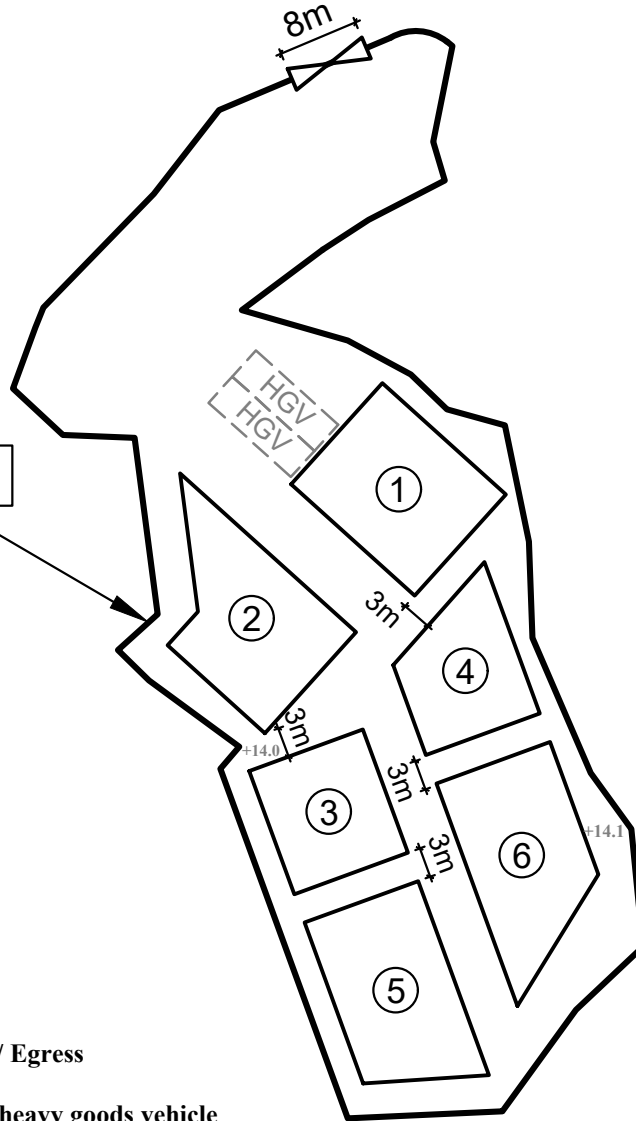

**Application Site**

## Legend



Vehicular Ingress / Egress



Parking space for heavy goods vehicle  
(11m (L) x 3.5m (W))

Site Area (about) : 3,330m<sup>2</sup>

No.	Uses	Floor Area (about)	Covered Area (about)	Storeys	Height
1	Warehouse and Ancillary Office	223 m <sup>2</sup>	223 m <sup>2</sup>	1	9m
2	Warehouse and Ancillary Office	223 m <sup>2</sup>	223 m <sup>2</sup>	1	9m
3	Warehouse and Ancillary Office	156 m <sup>2</sup>	156 m <sup>2</sup>	1	9m
4	Warehouse and Ancillary Office	153 m <sup>2</sup>	153 m <sup>2</sup>	1	9m
5	Warehouse and Ancillary Office	225 m <sup>2</sup>	225 m <sup>2</sup>	1	9m
6	Warehouse and Ancillary Office	225 m <sup>2</sup>	225 m <sup>2</sup>	1	9m
Total Area : (About)		<u>1,205 m<sup>2</sup></u>	<u>1,205 m<sup>2</sup></u>		

1:750

### Layout Plan

Goldrich Planners &  
Surveyors Ltd.

January 2024

Lot 27 RP in D.D. 110 and adjoining Government Land  
Kam Tin North, New Territories

Plan 3  
( P 23025 )



**Existing hard paving  
(about) 618m<sup>2</sup>**

**This portion of land is not flat.  
The existing ground level ranges from  
12.0mPD to 14.0mPD.**

**It was paved with concrete at  
a depth of 0.1m. The paved ground  
level ranges from 12.1mPD to 14.1mPD.**

**Landscape Area (unpaved)  
(about) 125m<sup>2</sup>**

**Existing filling of land (about 314m<sup>2</sup>)  
with concrete of about 0.1m in depth  
(from 14.0mPD to 14.1mPD)**

**Existing filling of land with gravel  
(about) 2,273m<sup>2</sup>  
The ground level was about 14.0mPD  
It was covered with gravel at  
a depth of about 0.1m  
The existing ground level  
is about 14.1mPD**

**Application Site**

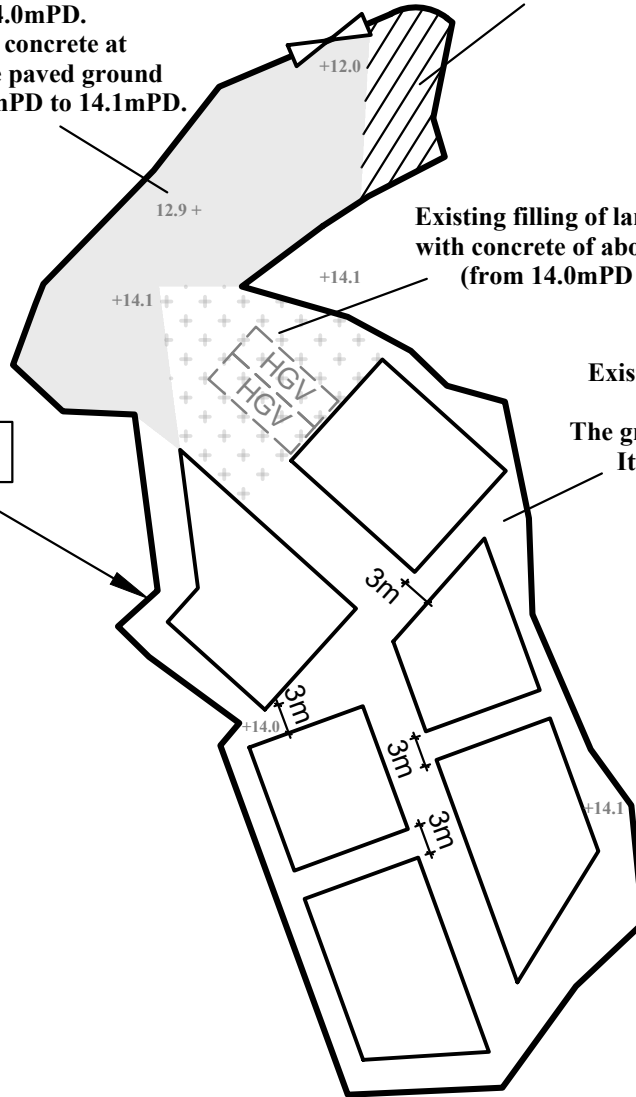

**Total Paved Area : about 3,205m<sup>2</sup>**

**Unpaved Area : about 125m<sup>2</sup>**

---

**Site Area : about 3,330m<sup>2</sup>**

**1:750**

**Plan showing Existing Filling of Land**

**Goldrich Planners &  
Surveyors Ltd.**

**January 2024**

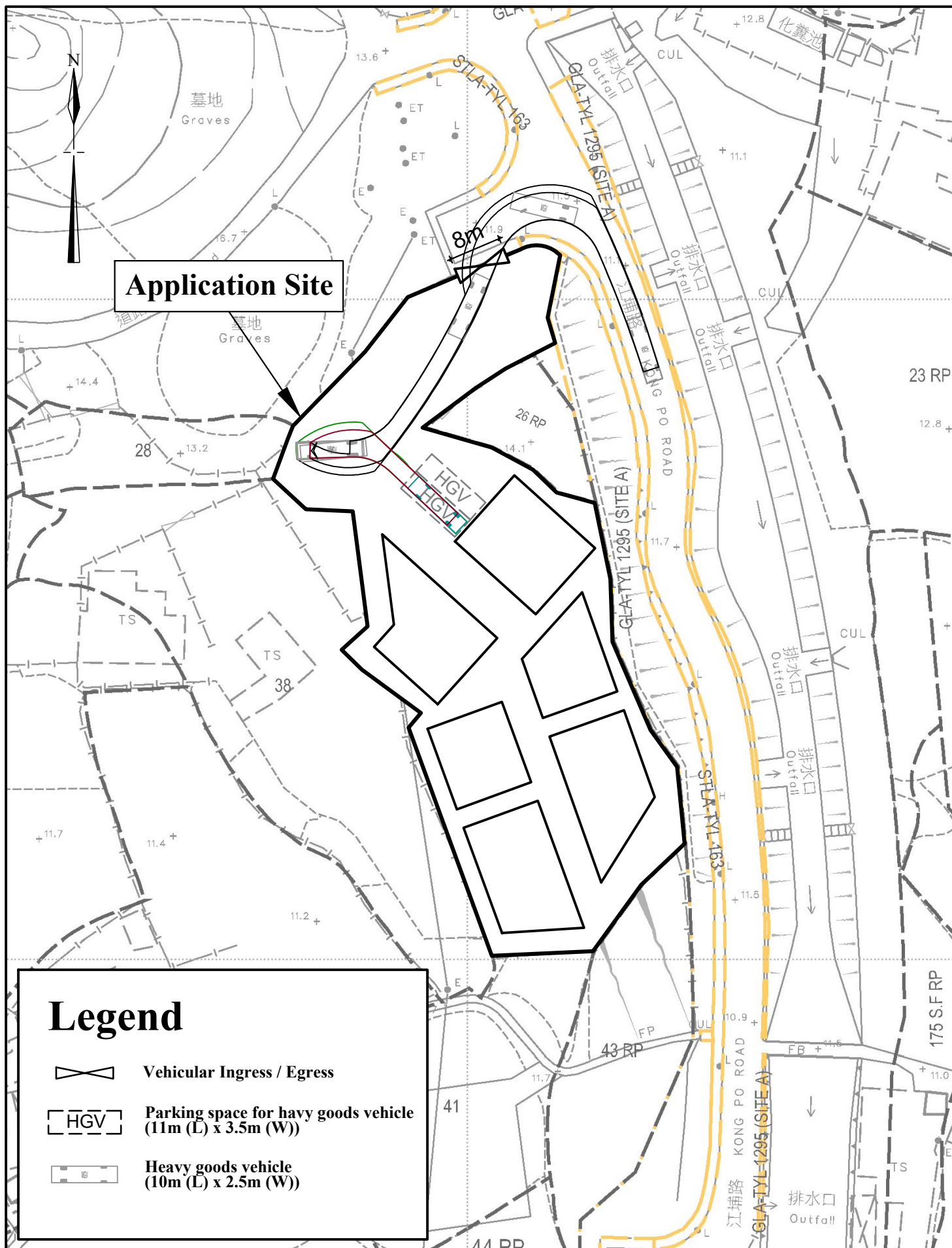

**Lot 27 RP in D.D. 110 and adjoining Government Land  
Kam Tin North, New Territories**

**Plan 3a  
( P 23025 )**



**Application Site**

**Legend**

-  Vehicular Ingress / Egress
-  Parking space for havy goods vehicle (11m (L) x 3.5m (W))
-  Heavy goods vehicle (10m (L) x 2.5m (W))

1:750

**Swept-Path Analysis**

**Goldrich Planners & Surveyors Ltd.**

January 2024

Lot 27 RP in D.D. 110 and adjoining Government Land  
Kam Tin North, New Territories

**Plan 4**  
**( P 23025 )**





N.T.S	Plan showing Nearest Transportation Services	Goldrich Planners & Surveyors Ltd.
January 2024	Lot 27 RP in D.D. 110 and adjoining Government Land Kam Tin North, New Territories	Plan 5 ( P 23025 )