

LOCATION OF THE APPLICATION SITE

APPLICATION SITE AREA : 2,588 m² (ABOUT)

VEHICULAR ACCESS
ACCESSIBLE FROM MEI FUNG ROAD VIA A LOCAL ACCESS

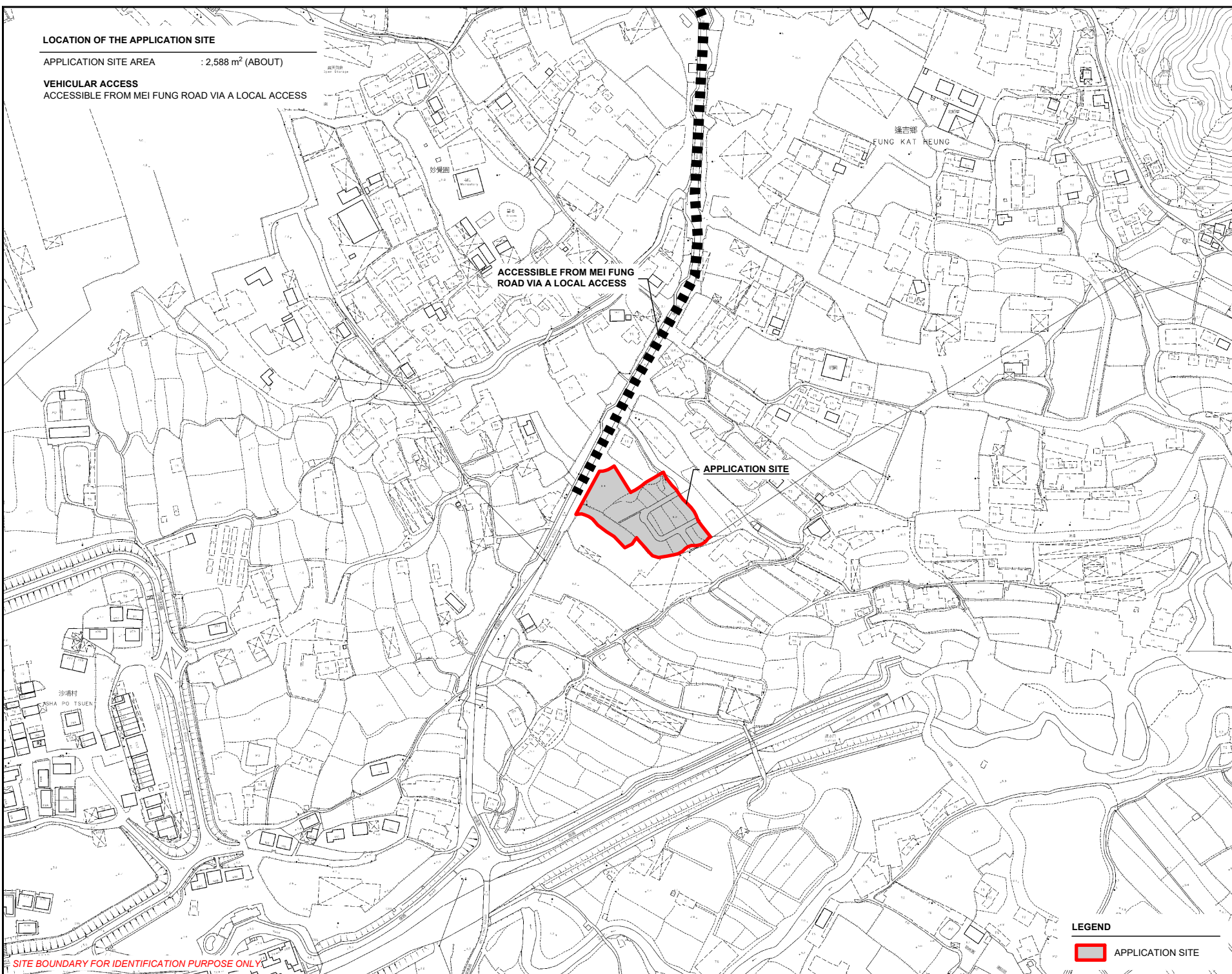
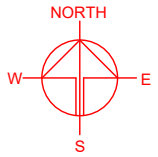

ACCESSIBLE FROM MEI FUNG ROAD VIA A LOCAL ACCESS

APPLICATION SITE

SITE BOUNDARY FOR IDENTIFICATION PURPOSE ONLY

LEGEND

 APPLICATION SITE

PLANNING CONSULTANT



PROJECT

PROPOSED WAREHOUSE (EXCLUDING DANGEROUS GOODS GODOWN) WITH ANCILLARY FACILITIES FOR A PERIOD OF 3 YEARS AND ASSOCIATED FILLING OF LAND

SITE LOCATION

VARIOUS LOTS IN D.D. 107, FUNG KAT HEUNG, KAM TIN, YUEN LONG, NEW TERRITORIES

SCALE
1 : 3000 @ A4

DRAWN BY	DATE
MN	24.6.2024
CHECKED BY	DATE
APPROVED BY	DATE

DWG. TITLE
LOCATION PLAN

DWG NO.	VER.
PLAN 1	001

ZONING OF THE APPLICATION SITE

APPLICATION SITE AREA : 2,588 m² (ABOUT)

OUTLINE ZONING PLAN : APPROVED KAM TIN NORTH OZP
 OZP PLAN NO. : S/YL-KTN/11
 ZONING OF THE SITE : "AGRICULTURE" ("AGR")

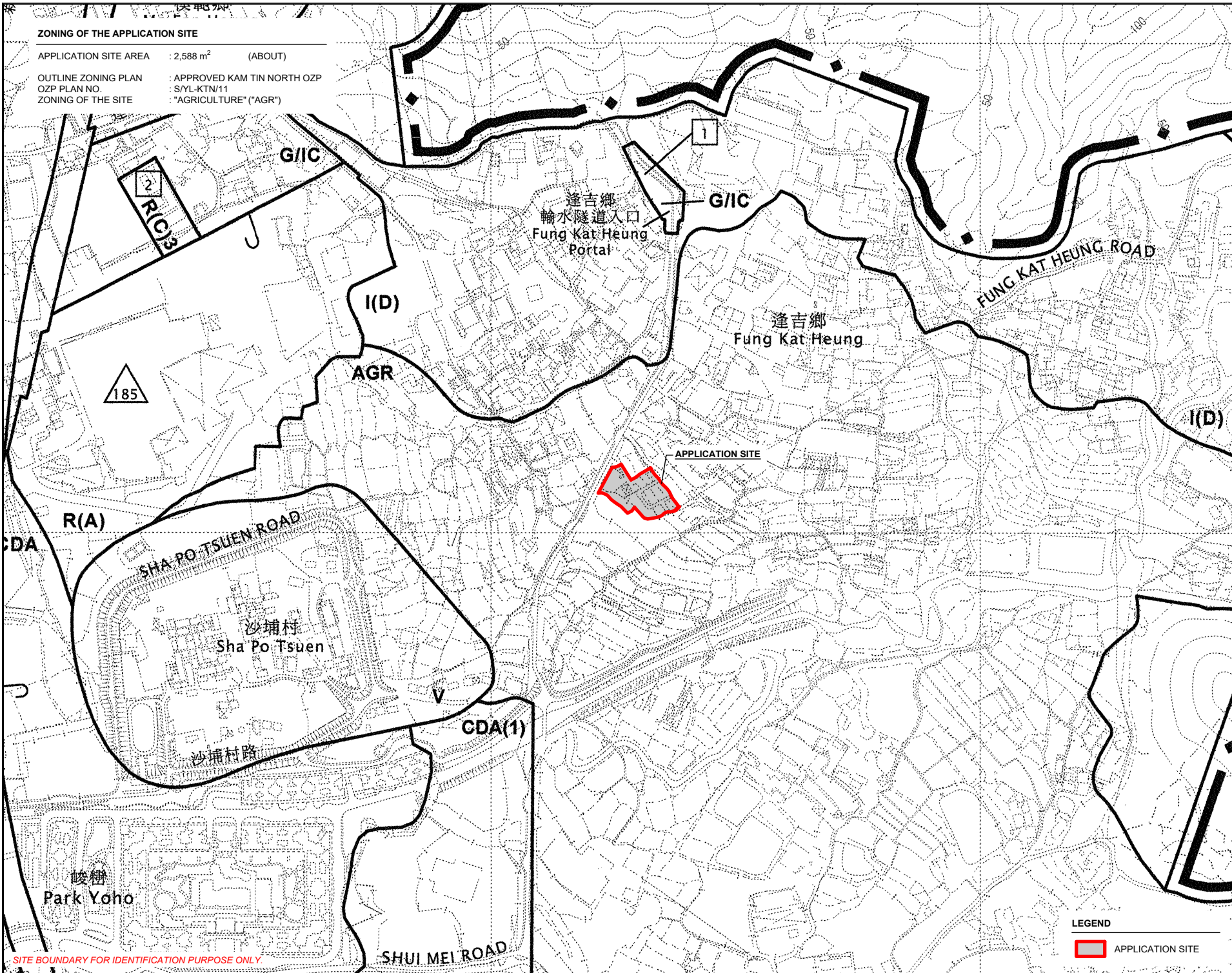
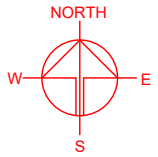

SITE BOUNDARY FOR IDENTIFICATION PURPOSE ONLY

PLANNING CONSULTANT



PROJECT

PROPOSED WAREHOUSE (EXCLUDING DANGEROUS GOODS GODOWN) WITH ANCILLARY FACILITIES FOR A PERIOD OF 3 YEARS AND ASSOCIATED FILLING OF LAND

SITE LOCATION

VARIOUS LOTS IN D.D. 107, FUNG KAT HEUNG, KAM TIN, YUEN LONG, NEW TERRITORIES

SCALE

1 : 5000 @ A4

DRAWN BY

MN

DATE

24.6.2024

CHECKED BY

DATE

APPROVED BY

DATE

LEGEND

APPLICATION SITE

DWG. TITLE

ZONING OF THE SITE

DWG. NO.

PLAN 2

VER.

001

LAND STATUS OF THE APPLICATION SITE

APPLICATION SITE AREA : 2,588 m² (ABOUT)
 AREA OF PRIVATE LAND : 2,588 m² (ABOUT)
 AREA OF GOVERNMENT LAND : NOT APPLICABLE

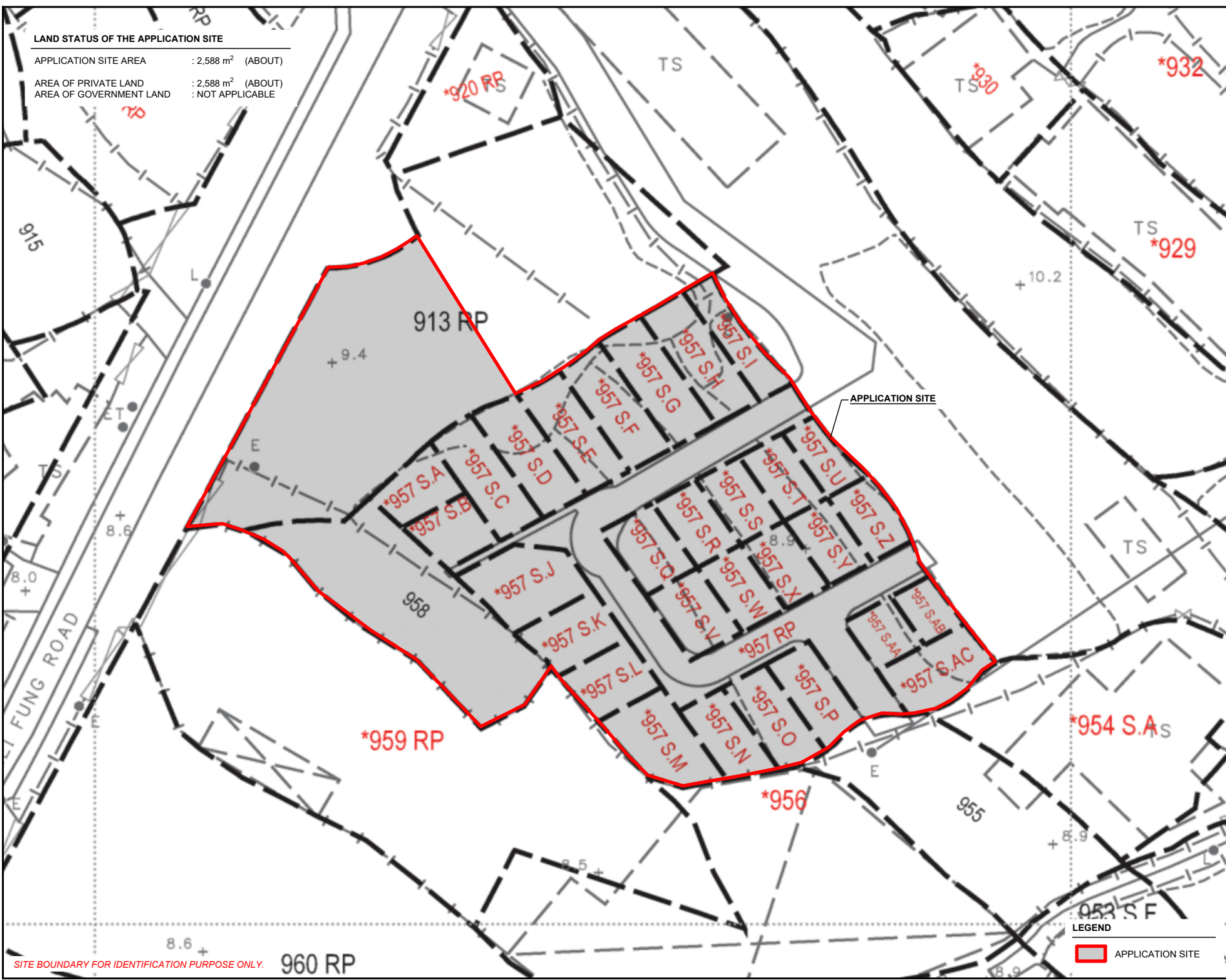
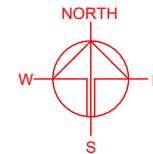

SITE BOUNDARY FOR IDENTIFICATION PURPOSE ONLY.

LEGEND

APPLICATION SITE

PLANNING CONSULTANT

PROJECT

PROPOSED WAREHOUSE (EXCLUDING DANGEROUS GOODS GODOWN) WITH ANCILLARY FACILITIES FOR A PERIOD OF 3 YEARS AND ASSOCIATED FILLING OF LAND

TEMPORARY (EXCLUDING DANGEROUS GOODS GODOWN) WITH ANCILLARY FACILITIES FOR A PERIOD OF 3 YEARS AND ASSOCIATED FILLING OF LAND

SITE LOCATION

VARIOUS LOTS IN D.D. 107, FUNG KAT HEUNG, KAM TIN, YUEN LONG, NEW TERRITORIES

SCALE	
1 : 500 @ A4	
DRAWN BY	DATE
MN	24.6.2024
CHECKED BY	DATE
APPROVED BY	DATE
DWG. TITLE	
LAND STATUS OF THE SITE	
DWG. NO.	VER.
PLAN 3	001

DEVELOPMENT PARAMETERS

APPLICATION SITE AREA	: 2,588 m ²	(ABOUT)
COVERED AREA	: 1,635 m ²	(ABOUT)
UNCOVERED AREA	: 953 m ²	(ABOUT)
PLOT RATIO	: 1.3	(ABOUT)
SITE COVERAGE	: 63 %	(ABOUT)
NO. OF STRUCTURE	: 1	
DOMESTIC GFA	: NOT APPLICABLE	
NON-DOMESTIC GFA	: 3,270 m ²	(ABOUT)
TOTAL GFA	: 3,270 m ²	(ABOUT)
BUILDING HEIGHT	: 11 m	(ABOUT)
NO. OF STOREY	: 2	

STRUCTURE	USE	COVERED AREA	GFA	BUILDING HEIGHT
B1	WAREHOUSE (EXCLUDING D.G.G.) SITE OFFICE, WASHROOM, FS WATER TANK AND PUMP ROOM	1,635 m ² (ABOUT)	3,270 m ² (ABOUT)	11 m (ABOUT)(2-STOREY)
TOTAL		1,635 m² (ABOUT)	3,270 m² (ABOUT)	

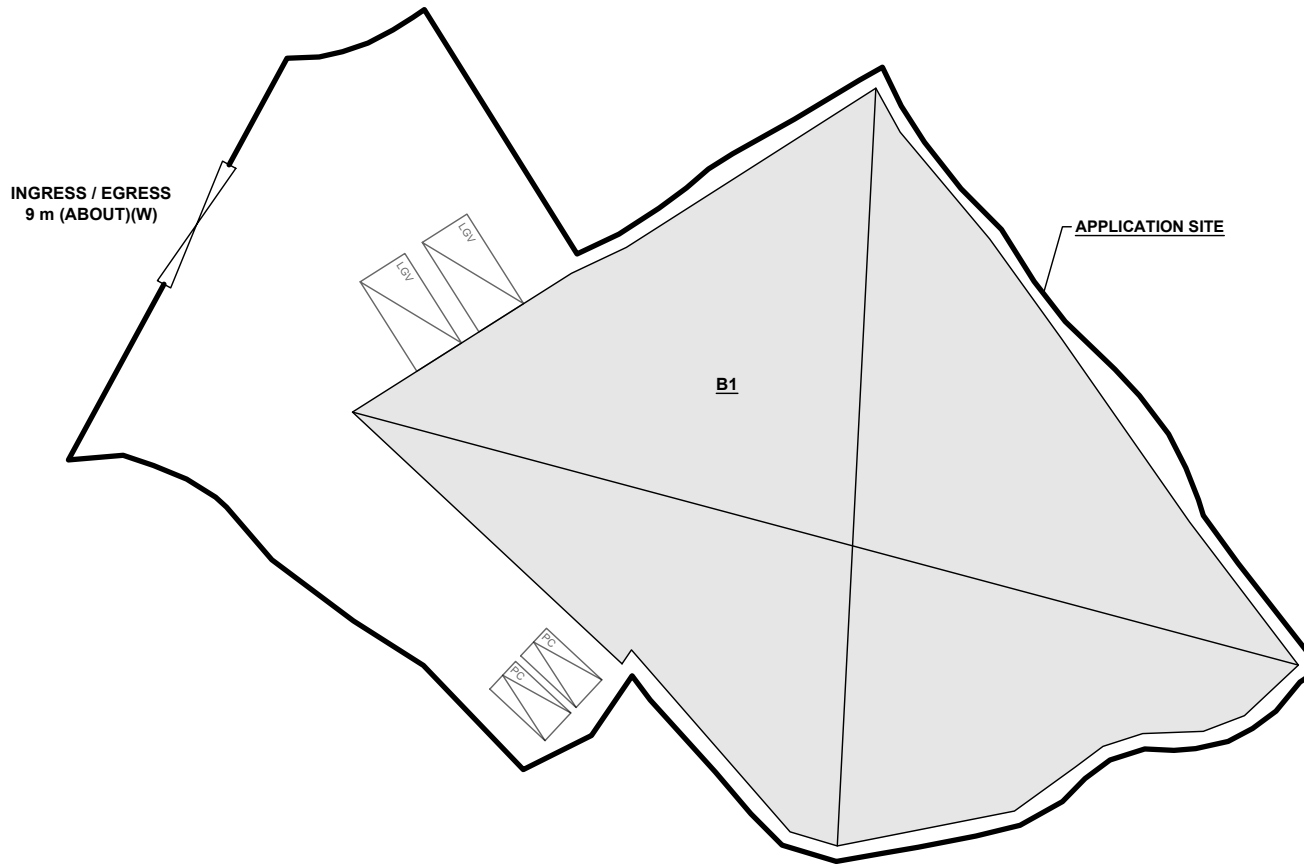
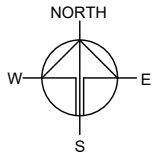

PARKING AND LOADING/UNLOADING PROVISION

NO. OF PRIVATE CAR PARKING SPACE	: 2
DIMENSION OF PARKING SPACE	: 5 m (L) X 2.5 m (W)
NO. L/UL SPACE FOR LIGHT GOODS VEHICLE	: 2
DIMENSION OF LOADING/UNLOADING SPACE	: 7 m (L) X 3.5 m (W)

LEGEND

- APPLICATION SITE
- STRUCTURE
- PARKING SPACE (PC)
- L/UL SPACE (LGV)
- INGRESS / EGRESS

PLANNING CONSULTANT



PROJECT

PROPOSED WAREHOUSE (EXCLUDING DANGEROUS GOODS GODOWN) WITH ANCILLARY FACILITIES FOR A PERIOD OF 3 YEARS AND ASSOCIATED FILLING OF LAND

SITE LOCATION

VARIOUS LOTS IN D.D. 107, FUNG KAT HEUNG, KAM TIN, YUEN LONG, NEW TERRITORIES

SCALE

1 : 500 @ A4

DRAWN BY	DATE
MN	24.6.2024
CHECKED BY	DATE
APPROVED BY	DATE

DWG. TITLE
LAYOUT PLAN

DWG NO.	VER.
PLAN 4	001

EXISTING CONDITION OF THE APPLICATION SITE



APPLICATION SITE AREA : 2,588 m² (ABOUT)
 EXISTING SITE SURFACE : SOILED GROUND AND HARD-PAVED
 EXISTING SITE LEVELS : +8.9 mPD TO +9.5 mPD (ABOUT)

PORTION OF THE APPLICATION SITE HAS ALREADY BEEN HARD-PAVED FOR CIRCULATION AND SITE FORMATION OF EXISTING STRUCTURES.



EXISTING SITE LEVEL OF THE APPLICATION SITE
(INDICATIVE ONLY)

LEGEND

-  APPLICATION SITE
-  EXISTING PAVED AREA
-  +8.9 EXISTING SITE LEVEL

SITE LEVELS ARE FOR REFERENCE ONLY.

PROPOSED FILLING OF LAND AREA OF THE APPLICATION SITE

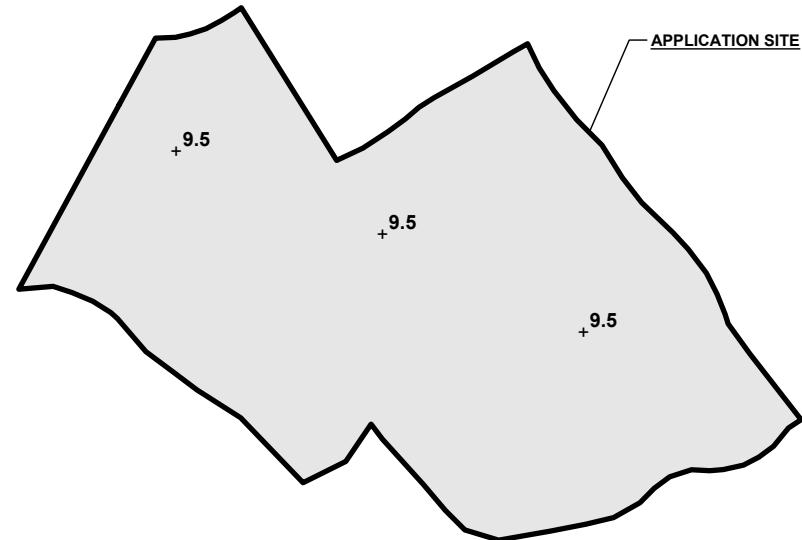

APPLICATION SITE AREA : 2,588 m² (ABOUT)
 PROPOSED FILLING OF LAND AREA : 2,588 m² (ABOUT)
 DEPTH OF LAND FILLING : NOT MORE THAN 0.6 m
 PROPOSED SITE LEVELS : +9.5 mPD (ABOUT)
 MATERIAL OF LAND FILLING : CONCRETE
 PURPOSE OF LAND FILLING : SITE FORMATION OF STRUCTURE AND CIRCULATION SPACE

ALL THE EXISTING HARD-PAVING WILL BE REMOVED BY THE APPLICANT. THE SITE WILL BE FILLED TO THE PROPOSED SITE LEVELS AFTER PLANNING PERMISSION HAS BEEN OBTAINED FROM THE TOWN PLANNING BOARD.



PROPOSED SITE LEVEL OF THE APPLICATION SITE
(INDICATIVE ONLY)

LEGEND

-  APPLICATION SITE
-  PROPOSED FILLED AREA
-  +9.5 PROPOSED SITE LEVEL

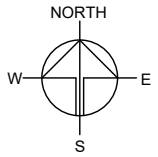

PLANNING CONSULTANT



PROJECT

PROPOSED TEMPORARY WAREHOUSE (EXCLUDING DANGEROUS GOODS GODOWN) WITH ANCILLARY FACILITIES FOR A PERIOD OF 3 YEARS AND ASSOCIATED FILLING OF LAND

SITE LOCATION

VARIOUS LOTS IN D.D. 107, FUNG KAT HEUNG, KAM TIN, YUEN LONG, NEW TERRITORIES

SCALE

1 : 800 @ A4

DRAWN BY	DATE
MN	21.6.2024

CHECKED BY	DATE

APPROVED BY	DATE

DWG. TITLE
FILLING OF LAND AREA

DWG NO.	VER.
PLAN 5	001

SWEPT PATH ANALYSIS

TYPE OF VEHICLE : LIGHT GOODS VEHICLE
 DIMENSION OF VEHICLE : 2.1 m (W) X 5.2 m (L)

SWEPT PATHS GENERATED BY AUTODESK VEHICLE TRACKING

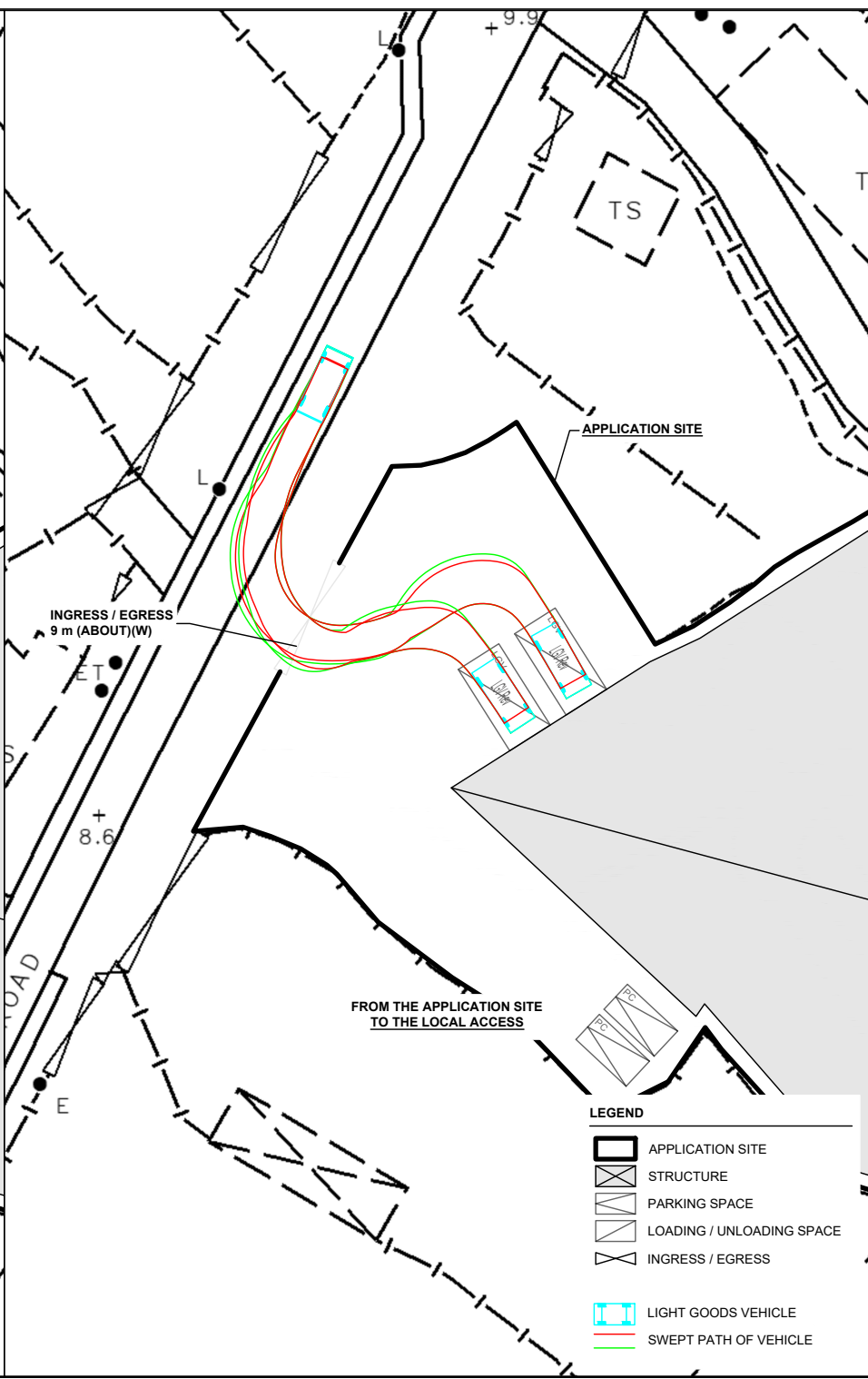
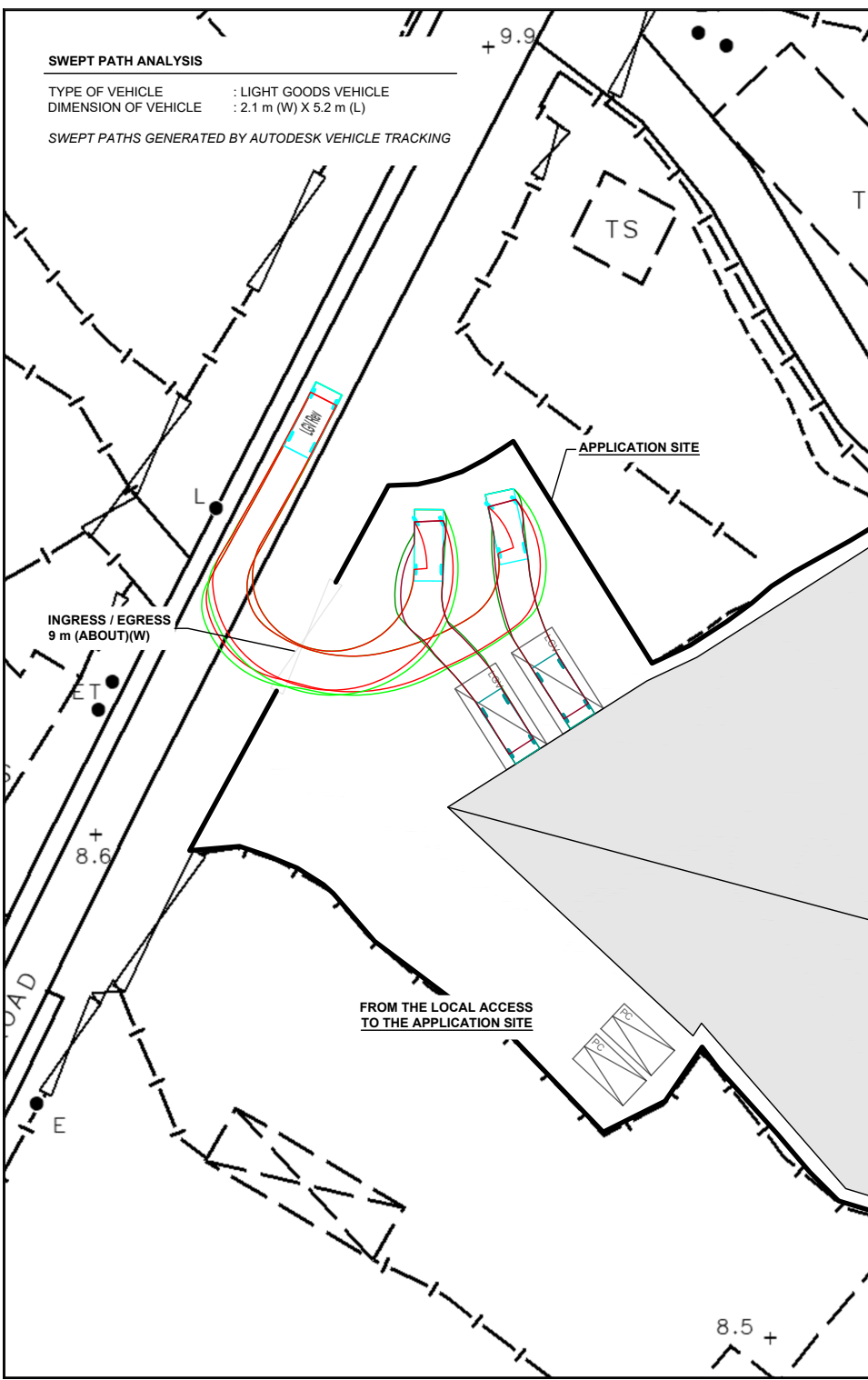
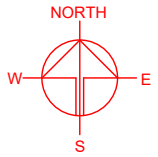

LEGEND

- APPLICATION SITE
- STRUCTURE
- PARKING SPACE
- LOADING / UNLOADING SPACE
- INGRESS / EGRESS
- LIGHT GOODS VEHICLE
- SWEPT PATH OF VEHICLE

PLANNING CONSULTANT	
PROJECT	
PROPOSED WAREHOUSE (EXCLUDING DANGEROUS GOODS GODOWN) WITH ANCILLARY FACILITIES FOR A PERIOD OF 3 YEARS AND ASSOCIATED FILLING OF LAND	
SITE LOCATION	
VARIOUS LOTS IN D.D. 107, FUNG KAT HEUNG, KAM TIN, YUEN LONG, NEW TERRITORIES	
SCALE	
1 : 500 @ A4	
DRAWN BY	DATE
MN	24.6.2024
CHECKED BY	DATE
APPROVED BY	DATE
DWG. TITLE	
SWEPT PATH ANALYSIS	
DWG NO.	VER.
PLAN 6	001