

寄件者: Rich Gold [REDACTED]
寄件日期: 2025年02月06日星期四 14:22
收件者: tpbpd/PLAND
副本: Andrea Wing Yin YAN/PLAND
主旨: S.16 Planning Application No. A/YL-KTN/1061 - Submission of Further Information
附件: KTN1061_P23044_FI_6.2.2025.pdf
類別: Internet Email

Your Ref.: A/YL-KTN/1061
Our Ref.: P23044/TL25038

Dear Sir/Madam,

Attached please find our further information for the captioned s.16 planning application. Hard copy will be delivered to the Board.

Regards,
Janice Tang

--

[REDACTED]

Notice to recipient: This e-mail is meant for only the intended recipient of the transmission, and may contain information of Goldrich Planners and Surveyors Ltd. that is confidential and/or privileged. If you received this e-mail in error, any review, use, dissemination, distribution, or copying of this e-mail is strictly prohibited. Please notify us immediately of the error by return e-mail and please delete this message from your system. Thank you in advance for your cooperation.

Your Ref.: A/YL-KTN/1061

Our Ref.: P23044/TL25038

6 February 2025

The Secretary
Town Planning Board
15/F., North Point Government Offices
333 Java Road, North Point, Hong Kong

By Post and E-mail
tpbpd@pland.gov.hk

Dear Sir,

Submission of Further Information (FI)

**Temporary Animal Boarding Establishment with Ancillary Facilities
for a Period of 5 Years and Associated Filling of Land in "Agriculture" Zone,
Lot Nos. 1493 (Part) and 1500 (Part) in D. D. 107 and Adjoining Government Land,
Kam Tin, Yuen Long, New Territories
(Application No. A/YL-KTN/1061)**

We write to submit FI in response to departmental comments conveyed by the Planning Department for the captioned application.

Yours faithfully,
For and on behalf of
Goldrich Planners & Surveyors Ltd.



Francis LAU

Encl.

c.c.

DPO/FSYLE, PlanD

(Attn.: Ms. Andrea YAN)

By E-mail only

Further Information for Planning Application No. A/YL-KTN/1061**Response-to-Comment****Comments from the Transport Department**

Contact Person: Mr. Phil CAI (Tel: 2399 2421)

I.	Comments	Responses
1.	The hammerhead at Shui Mei Road is for vehicles to turn around instead of loading / unloading purpose. Please review.	A loading/unloading space for light goods vehicle is proposed on the south-western side near the site. Please refer to the revised Plan showing the proposed location for loading/unloading for details (Plan 8a). It is expected that the loading/unloading activity of material would be carried out once per week and would take about 15 minutes. As such, it would not cause adverse traffic impact to the local access road.

Comments from the Urban Design & Landscape Section, Planning Department

Contact Person: Mr. Samuel HUI (Tel: 3565 3957)

II.	Comments	Responses
1.	Some existing trees seems to be found along the eastern boundary within Site which is different from the existing tree locations as shown in Plan 9 (Plan showing Tree Locations). The applicant should further review and clarify the information of the existing trees within Site.	The number of existing trees within the Site has been reviewed. A total of 4 trees are located within the Site. Other trees are located on adjoining site along the eastern boundary of the Site, but parts of their tree crowns may be within the site. Please refer to the revised tree location plan for details (Plan 9a).

- END -

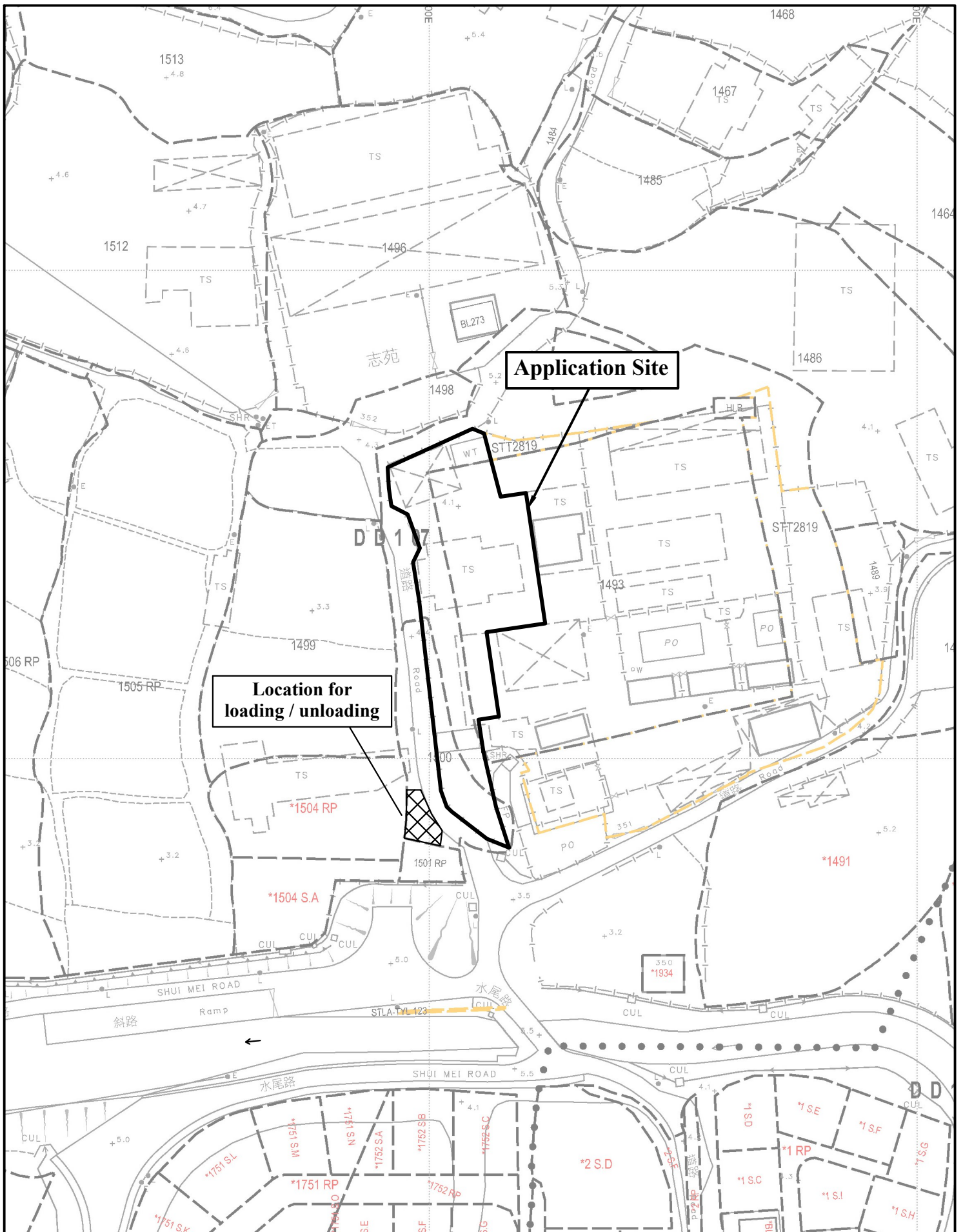

1:1000

Plan Showing Location for Loading / unloading

Goldrich Planners & Surveyors Ltd.

February 2025

Lots 1493 (part), 1500 (part) in DD. 107 and adjoining government land Kam Tin North, New Territories

Plan 8a (P 23044)

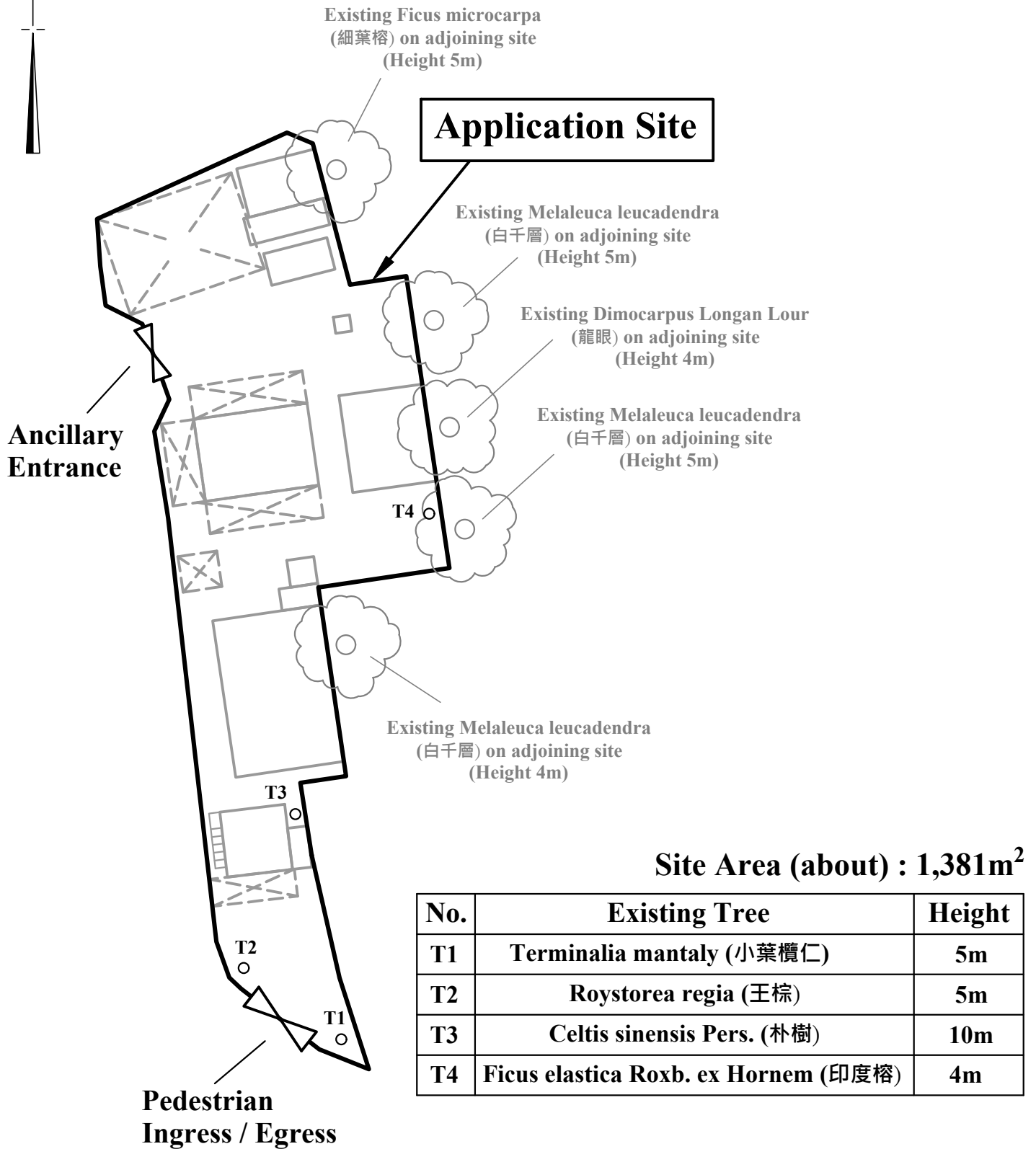

Site Area (about) : 1,381m²

No.	Existing Tree	Height
T1	Terminalia mantaly (小葉欖仁)	5m
T2	Roystorea regia (王棕)	5m
T3	Celtis sinensis Pers. (朴樹)	10m
T4	Ficus elastica Roxb. ex Hornem (印度榕)	4m

1:500	Plan showing Tree Locations	Goldrich Planners & Surveyors Ltd.
February 2025	Lots 1493 (part), 1500 (part) in DD. 107 and adjoining government land Kam Tin North, New Territories	Plan 9a (P 23044)