

LOCATION OF THE APPLICATION SITE

APPLICATION SITE AREA : 1,460 m² (ABOUT)

VEHICULAR ACCESS
ACCESSIBLE FROM KAM TIN ROAD VIA A LOCAL ACCESS

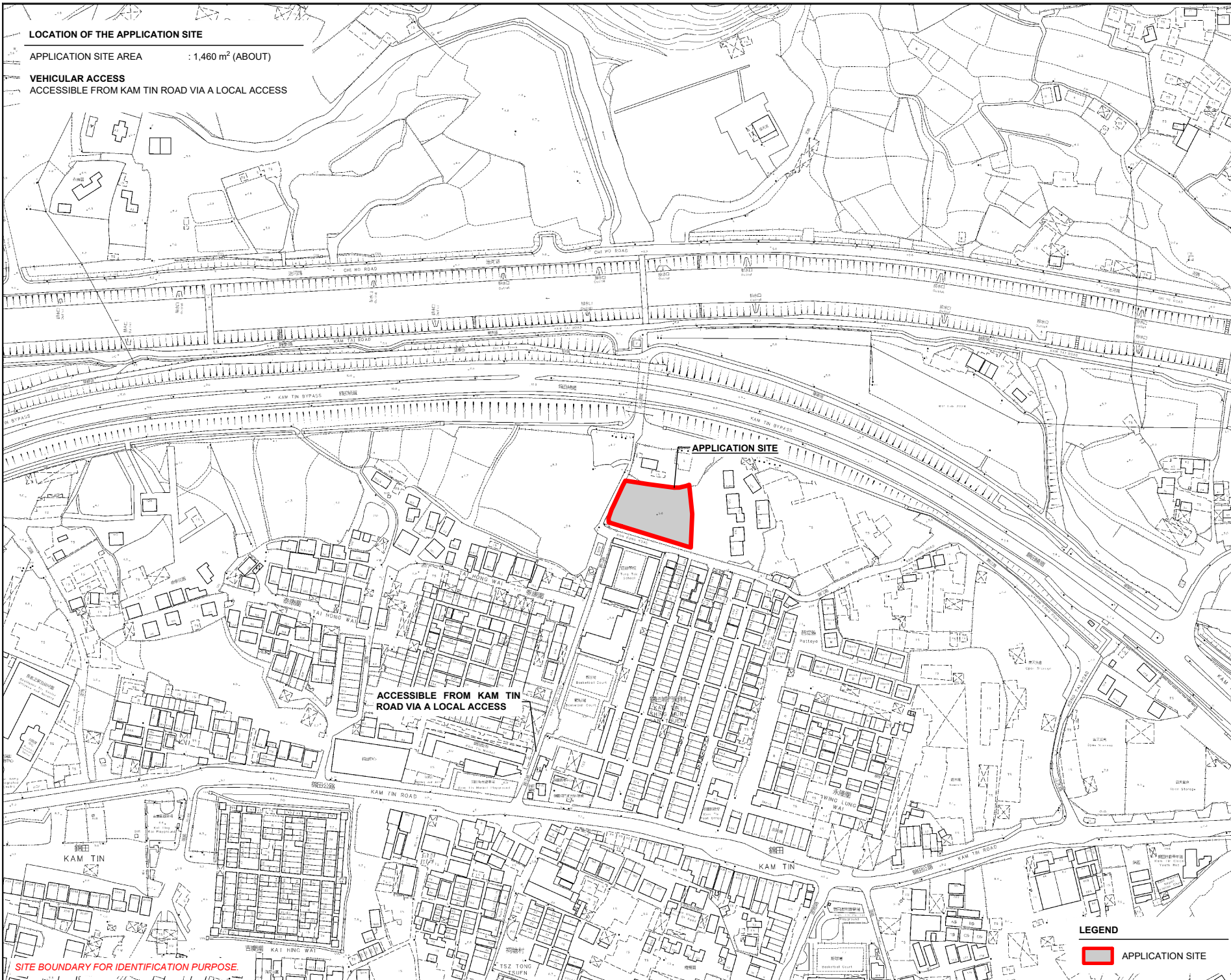
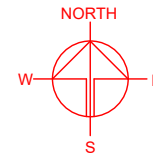

APPLICATION SITE

ACCESSIBLE FROM KAM TIN ROAD VIA A LOCAL ACCESS

LEGEND

 APPLICATION SITE

SITE BOUNDARY FOR IDENTIFICATION PURPOSE.

PLANNING CONSULTANT



PROJECT

PROPOSED TEMPORARY
PUBLIC VEHICLE PARK
(EXCLUDING CONTAINER
VEHICLE) WITH ANCILLARY
FACILITIES FOR A PERIOD OF 5
YEARS

SITE LOCATION

VARIOUS LOTS IN D.D. 109, KAM
TIN, YUEN LONG, NEW
TERRITORIES

SCALE

1 : 3000 @ A4

DRAWN BY

MN

DATE

13.11.2024

REVISED BY

DATE

APPROVED BY

DATE

DWG. TITLE

LOCATION PLAN

DWG NO.

PLAN 1

VER.

001

ZONING OF THE APPLICATION SITE

APPLICATION SITE AREA : 1,460 m² (ABOUT)
 OUTLINE ZONING PLAN : APPROVED KAM TIN NORTH OZP
 OZP PLAN NO. : SYL-KTN/11
 ZONING OF THE SITE : "VILLAGE TYPE DEVELOPMENT" ("V")

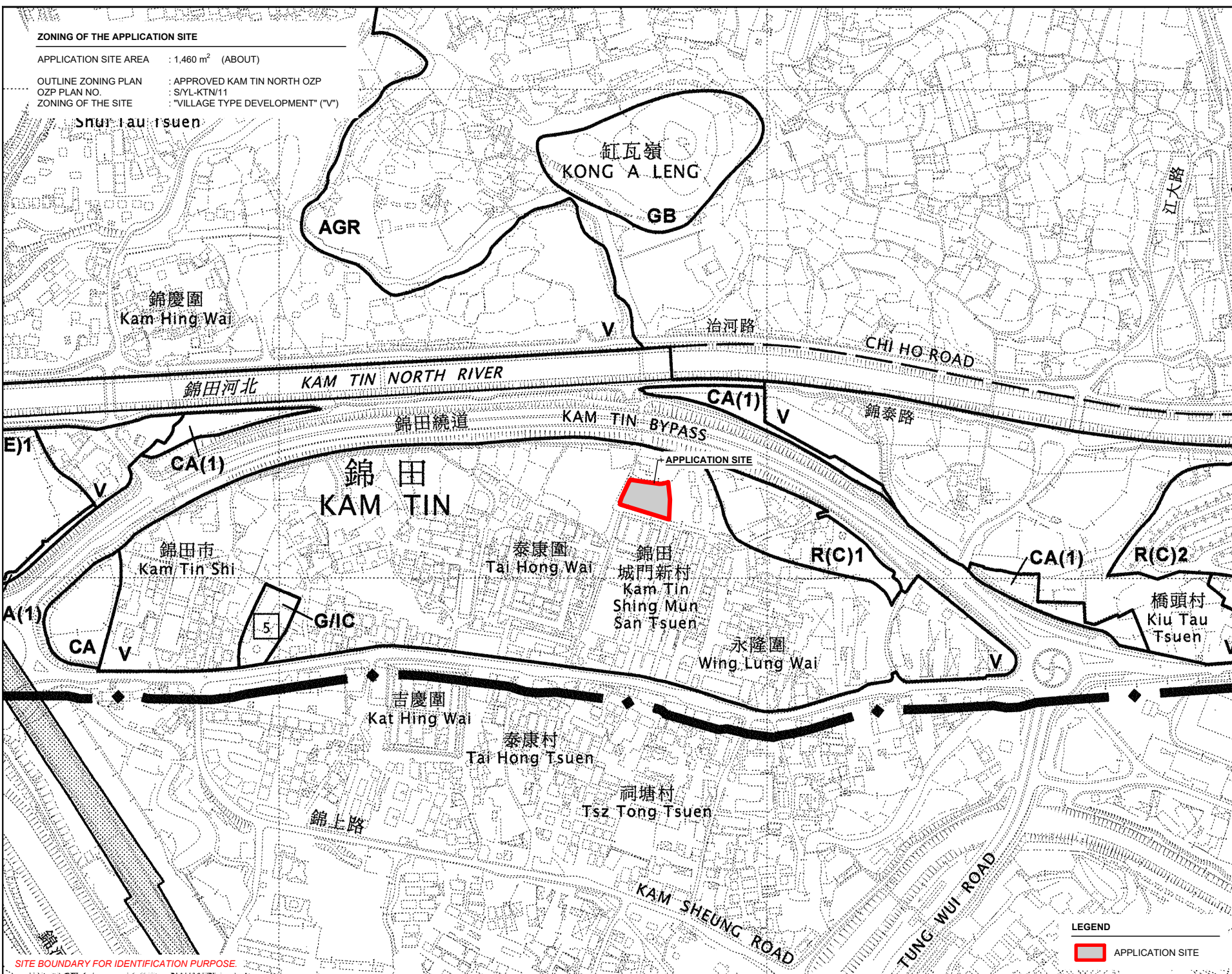
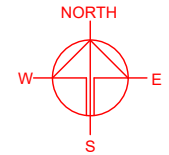

SITE BOUNDARY FOR IDENTIFICATION PURPOSE.

LEGEND

APPLICATION SITE

PLANNING CONSULTANT

PROJECT

PROPOSED PUBLIC VEHICLE (EXCLUDING VEHICLE) WITH ANCILLARY FACILITIES FOR A PERIOD OF 5 YEARS

TEMPORARY CONTAINER PARK FOR A PERIOD OF 5 YEARS

SITE LOCATION

VARIOUS LOTS IN D.D. 109, KAM TIN, YUEN LONG, NEW TERRITORIES

SCALE	
1 : 5000 @ A4	
DRAWN BY	DATE
MN	13.11.2024
REVISED BY	DATE
APPROVED BY	DATE
DWG. TITLE	
ZONING OF THE SITE	
DWG NO.	VER.
PLAN 2	001

LAND STATUS OF THE APPLICATION SITE

APPLICATION SITE AREA : 1,460 m² (ABOUT)
 AREA OF PRIVATE LAND : 1,460 m² (ABOUT)
 AREA OF GOVERNMENT LAND : NOT APPLICABLE

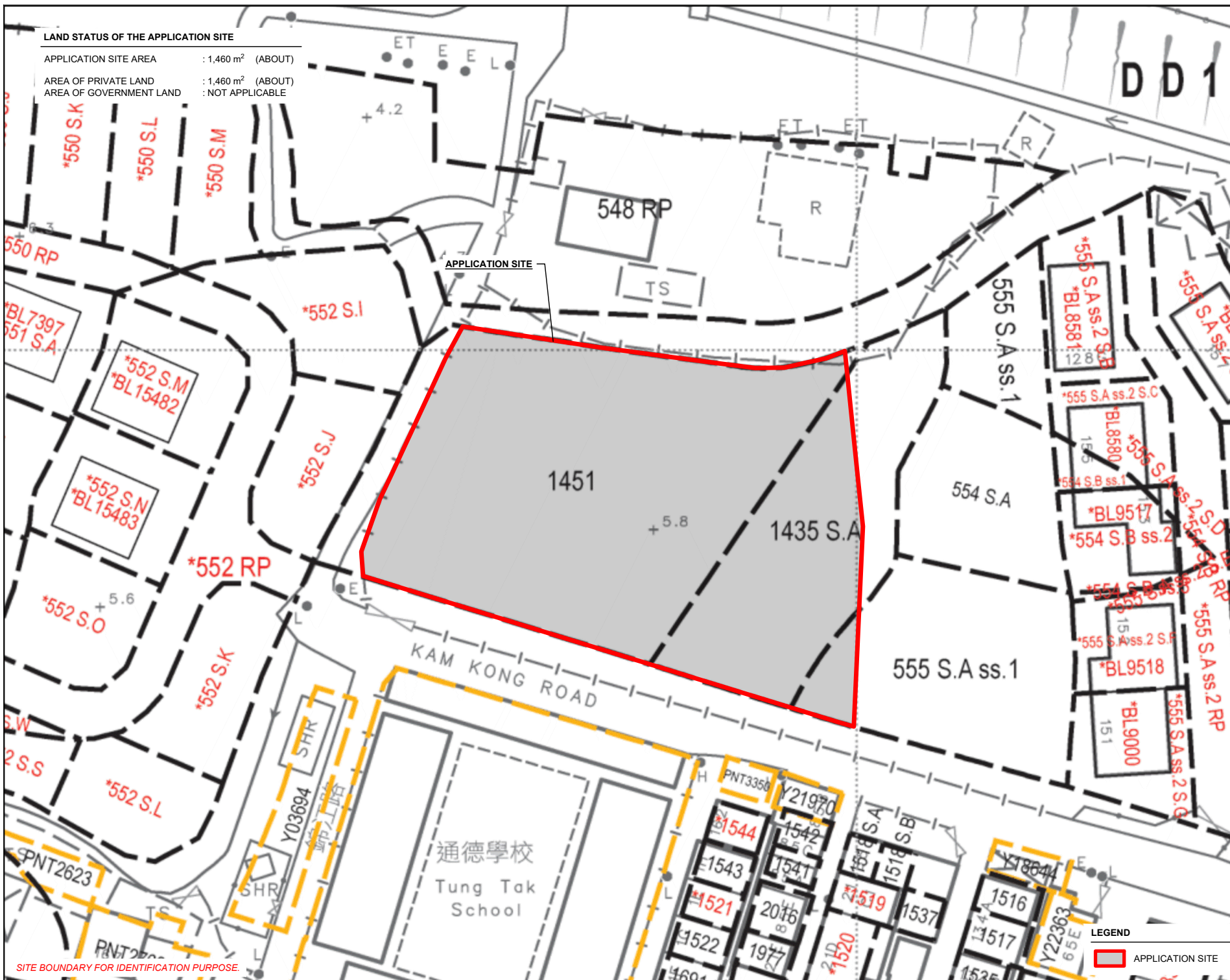
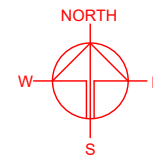

SITE BOUNDARY FOR IDENTIFICATION PURPOSE.

PLANNING CONSULTANT



PROJECT

PROPOSED TEMPORARY PUBLIC VEHICLE PARK (EXCLUDING CONTAINER VEHICLE) WITH ANCILLARY FACILITIES FOR A PERIOD OF 5 YEARS

SITE LOCATION

VARIOUS LOTS IN D.D. 109, KAM TIN, YUEN LONG, NEW TERRITORIES

SCALE

1 : 500 @ A4

DRAWN BY

MN

DATE

12.11.2024

REVISED BY

DATE

APPROVED BY

DATE

LEGEND

APPLICATION SITE

DWG. TITLE

LAND STATUS OF THE SITE

DWG NO.

PLAN 3

VER.

001

DEVELOPMENT PARAMETERS

APPLICATION SITE AREA	: 1,460 m ²	(ABOUT)
COVERED AREA	: 52 m ²	(ABOUT)
UNCOVERED AREA	: 1,408 m ²	(ABOUT)
PLOT RATIO	: 0.04	(ABOUT)
SITE COVERAGE	: 4 %	(ABOUT)
NO. OF STRUCTURE	: 3	
DOMESTIC GFA	: NOT APPLICABLE	
NON-DOMESTIC GFA	: 52 m ²	(ABOUT)
TOTAL GFA	: 52 m ²	(ABOUT)
BUILDING HEIGHT	: 3 m	(ABOUT)
NO. OF STOREY	: 1	

STRUCTURE	USE	COVERED AREA	GROSS FLOOR AREA	BUILDING HEIGHT
B1	GUARDROOM	12 m ² (ABOUT)	12 m ² (ABOUT)	3 m (ABOUT)(1-STOREY)
B2	SITE OFFICE	18 m ² (ABOUT)	18 m ² (ABOUT)	3 m (ABOUT)(1-STOREY)
B3	METER ROOM AND WASHROOM	22 m ² (ABOUT)	22 m ² (ABOUT)	3 m (ABOUT)(1-STOREY)
TOTAL		52 m² (ABOUT)	52 m² (ABOUT)	

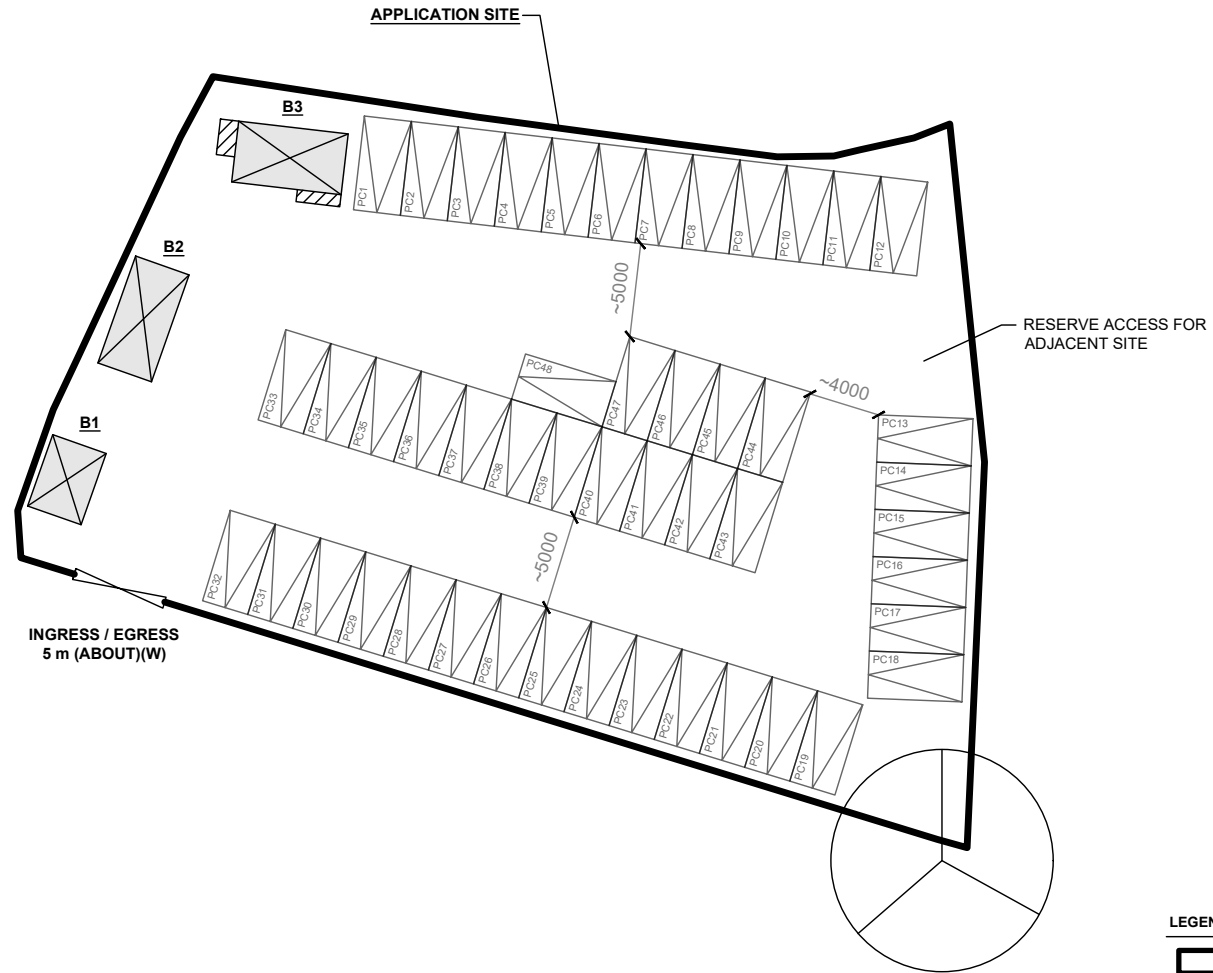
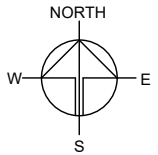

LEGEND

- APPLICATION SITE
- STRUCTURE (ENCLOSED)
- STRUCTURE (CANOPY)
- PARKING SPACE (PRIVATE CAR)
- EXISTING TREE
- INGRESS / EGRESS

PARKING AND LOADING / UNLOADING PROVISIONS

NO. OF PRIVATE CAR PARKING SPACE	: 48
DIMENSION OF PARKING SPACE	: 5 m (L) x 2.5 m (W)

PLANNING CONSULTANT



PROJECT

PROPOSED TEMPORARY
PUBLIC VEHICLE PARK
(EXCLUDING CONTAINER
VEHICLE) WITH ANCILLARY
FACILITIES FOR A PERIOD OF 5
YEARS

SITE LOCATION

VARIOUS LOTS IN D.D. 109, KAM
TIN, YUEN LONG, NEW
TERRITORIES

SCALE

1 : 400 @ A4

DRAWN BY	DATE
MN	13.11.2024

CHECKED BY	DATE

APPROVED BY	DATE

DWG. TITLE
LAYOUT PLAN

DWG NO.	VER.
PLAN 4	001

DEVELOPMENT PARAMETERS

APPLICATION SITE AREA	: 1,460 m ²	(ABOUT)
COVERED AREA	: 52 m ²	(ABOUT)
UNCOVERED AREA	: 1,408 m ²	(ABOUT)
PLOT RATIO	: 0.04	(ABOUT)
SITE COVERAGE	: 4 %	(ABOUT)
NO. OF STRUCTURE	: 3	
DOMESTIC GFA	: NOT APPLICABLE	
NON-DOMESTIC GFA	: 52 m ²	(ABOUT)
TOTAL GFA	: 52 m ²	(ABOUT)
BUILDING HEIGHT	: 3 m	(ABOUT)
NO. OF STOREY	: 1	

STRUCTURE	USE	COVERED AREA	GROSS FLOOR AREA	BUILDING HEIGHT
B1	GUARDROOM	12 m ² (ABOUT)	12 m ² (ABOUT)	3 m (ABOUT)(1-STOREY)
B2	SITE OFFICE	18 m ² (ABOUT)	18 m ² (ABOUT)	3 m (ABOUT)(1-STOREY)
B3	METER ROOM AND WASHROOM	22 m ² (ABOUT)	22 m ² (ABOUT)	3 m (ABOUT)(1-STOREY)
TOTAL		52 m² (ABOUT)	52 m² (ABOUT)	

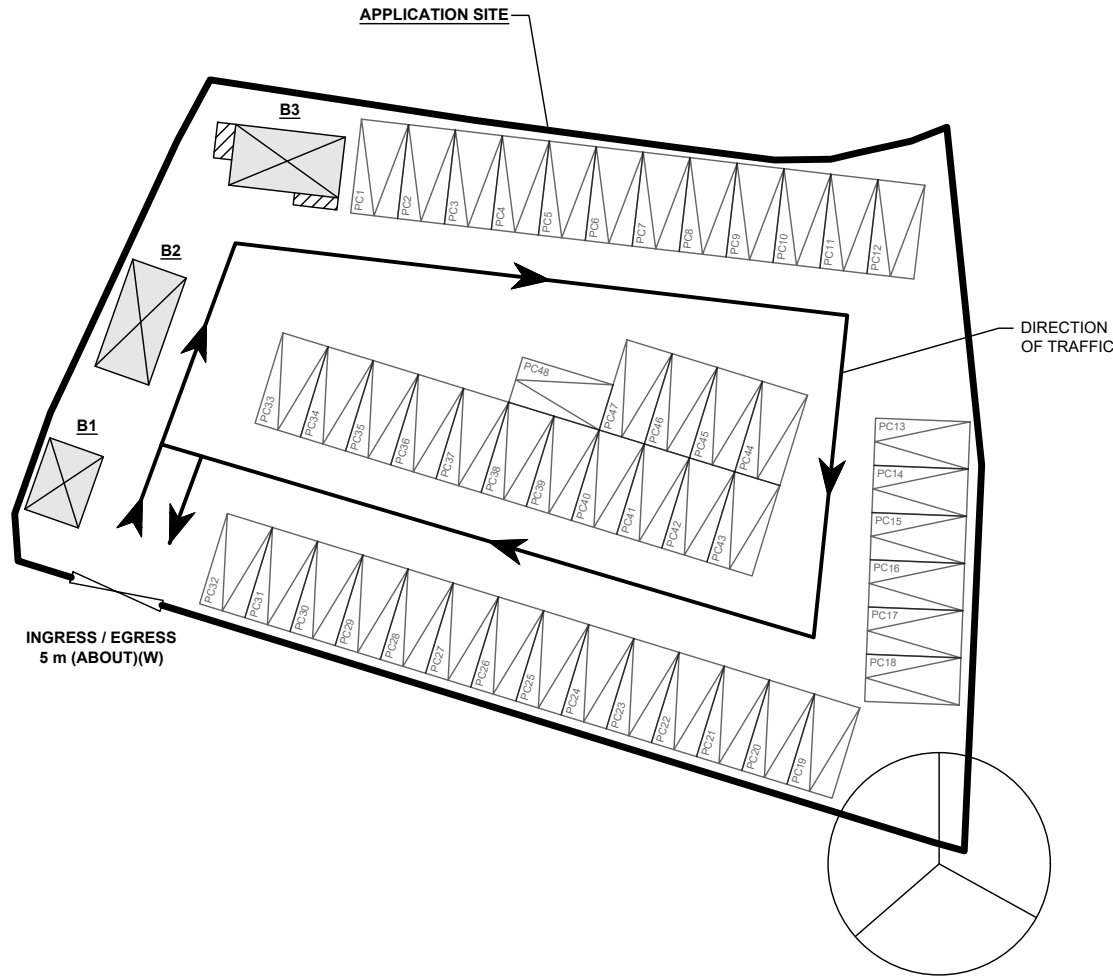
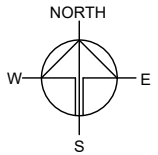

INGRESS / EGRESS
5 m (ABOUT)(W)

DIRECTION
OF TRAFFIC

APPLICATION SITE

PARKING AND LOADING / UNLOADING PROVISIONS

NO. OF PRIVATE CAR PARKING SPACE	: 48
DIMENSION OF PARKING SPACE	: 5 m (L) x 2.5 m (W)

LEGEND

- APPLICATION SITE
- STRUCTURE (ENCLOSED)
- STRUCTURE (CANOPY)
- PARKING SPACE (PRIVATE CAR)
- EXISTING TREE
- INGRESS / EGRESS

PLANNING CONSULTANT



PROJECT

PROPOSED TEMPORARY
PUBLIC VEHICLE PARK
(EXCLUDING CONTAINER
VEHICLE) WITH ANCILLARY
FACILITIES FOR A PERIOD OF 5
YEARS

SITE LOCATION

VARIOUS LOTS IN D.D. 109, KAM
TIN, YUEN LONG, NEW
TERRITORIES

SCALE

1 : 400 @ A4

DRAWN BY: MN DATE: 13.11.2024

CHECKED BY: DATE:

APPROVED BY: DATE:

DWG. TITLE
DIRECTION OF TRAFFIC

DWG NO. VER.
PLAN 5 001

SWEPT PATH ANALYSIS

TYPE OF VEHICLE : PRIVATE CAR
 DIMENSION OF VEHICLE : 1.7 m (W) X 4.6 m (L)

SWEPT PATHS GENERATED BY AUTODESK VEHICLE TRACKING

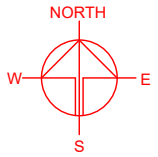

+ 5.6

INGRESS / EGRESS
5 m (ABOUT)(W)

KAM KONG ROAD

FROM THE LOCAL ACCESS TO
THE APPLICATION SITE

APPLICATION SITE

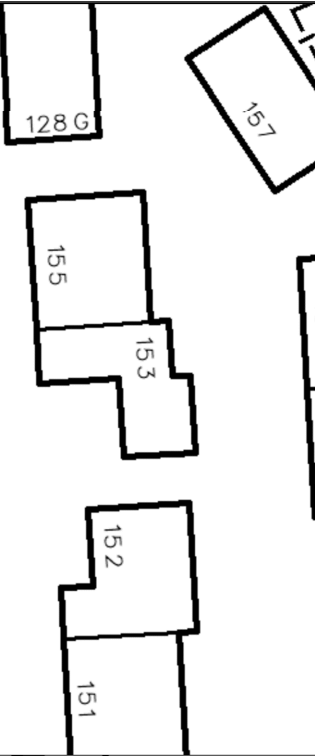

+ 5.6

INGRESS / EGRESS
5 m (ABOUT)(W)

KAM KONG ROAD

FROM THE APPLICATION SITE
TO THE LOCAL ACCESS

APPLICATION SITE

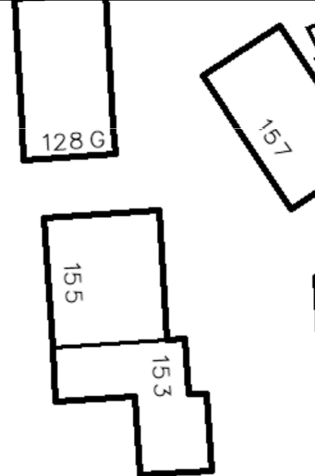

PLANNING CONSULTANT



PROJECT

PROPOSED TEMPORARY
PUBLIC VEHICLE PARK
(EXCLUDING CONTAINER
VEHICLE) WITH ANCILLARY
FACILITIES FOR A PERIOD OF 5
YEARS

SITE LOCATION

VARIOUS LOTS IN D.D. 109, KAM
TIN, YUEN LONG, NEW
TERRITORIES

SCALE

1 : 500 @ A4

DRAWN BY

MN

DATE

13.11.2024

CHECKED BY

DATE

APPROVED BY

DATE

DWG. TITLE

SWEPT PATH ANALYSIS (PC)

DWG. NO.

PLAN 6

VER.

001

LEGEND

- APPLICATION SITE
- STRUCTURE
- PARKING SPACE (PRIVATE CAR)
- INGRESS / EGRESS
- PRIVATE CAR
- SWEPT PATH OF VEHICLE

SITE BOUNDARY FOR IDENTIFICATION PURPOSE.