

<p>Not to Scale</p>	<p>Location Plan</p>	<p>Goldrich Planners & Surveyors Ltd.</p>
<p>January 2025</p>	<p>Lot 1376 RP in D. D. 109 Yuen Long, New Territories</p>	<p>Plan 1 (P 21071)</p>

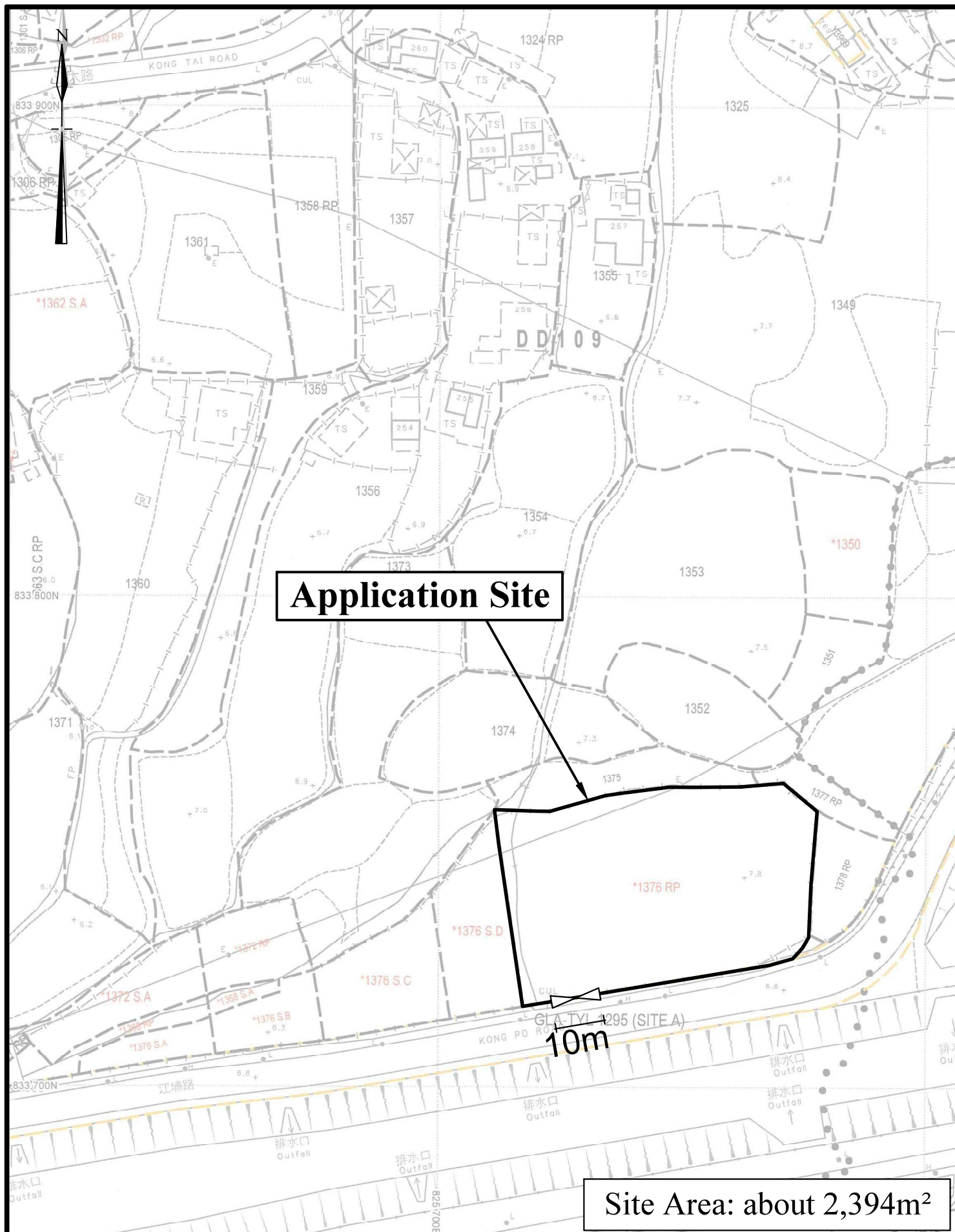

Application Site

Site Area: about 2,394m²

1 : 1000 (A4)

January 2025

Lot Index Plan
 Lot 1376 RP in D. D. 109
 Yuen Long, New Territories

Goldrich Planners & Surveyors Ltd.

**Plan 2
 (P 21071)**

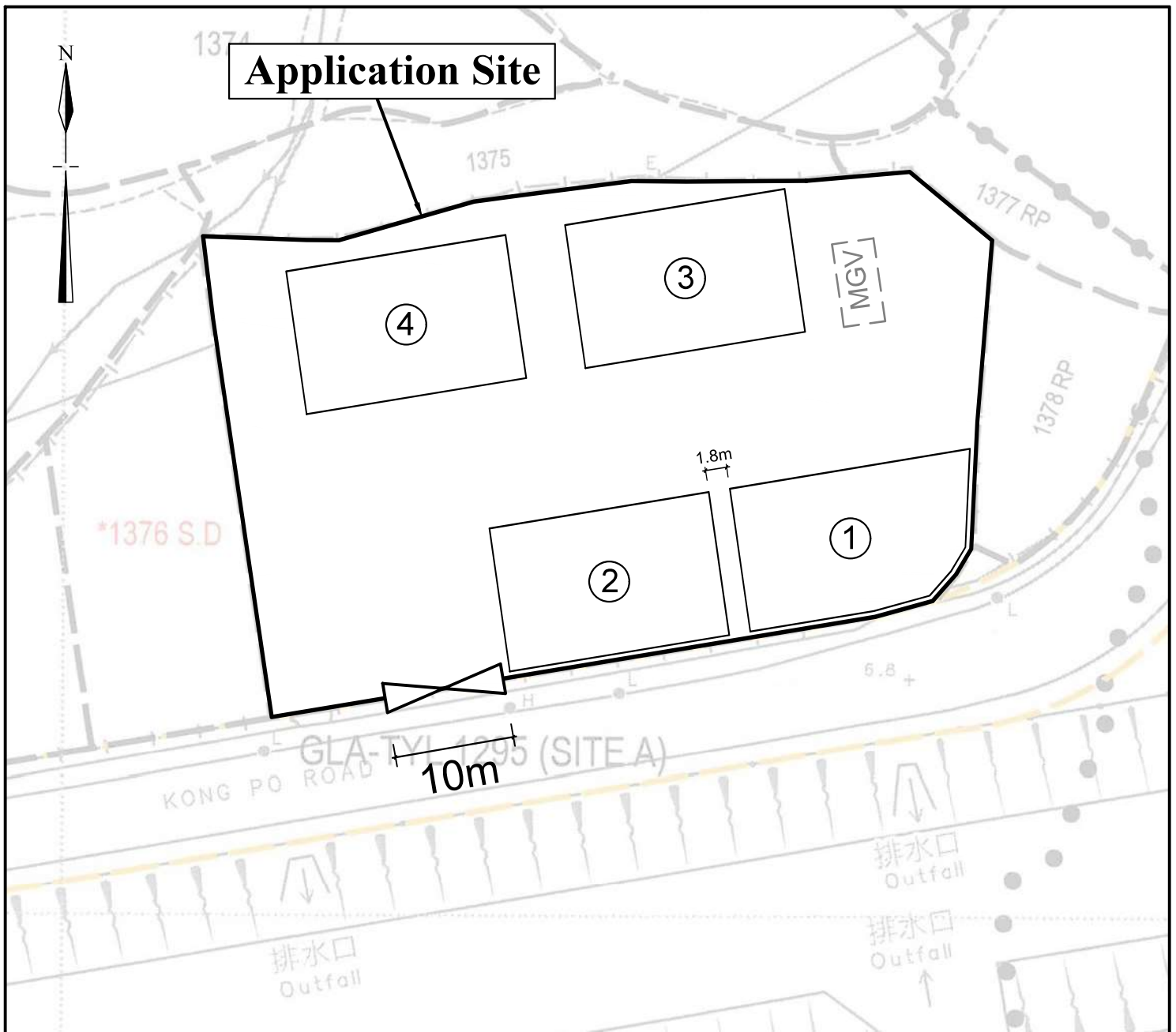

Legend

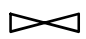
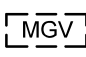
-  Vehicular Ingress / Egress
-  Parking space for medium goods vehicle
(7m (L) x 3.5m (W))

Site Area (about): 2,394m²

No.	Structure / Use	Floor Area (about)	Covered Area (about)	Height	No. of Storeys
1	Warehouse with Ancillary Office	225m ²	225m ²	9m	1
2	Warehouse with Ancillary Office	225m ²	225m ²	9m	1
3	Warehouse with Ancillary Office	225m ²	225m ²	9m	1
4	Warehouse with Ancillary Office	225m ²	225m ²	9m	1
Total		<u>900m²</u>	<u>900m²</u>		

1 : 500

Layout Plan

**Goldrich Planners &
Surveyors Ltd.**

January 2025

Lot 1376 RP in D. D. 109
Yuen Long, New Territories

**Plan 3
(P 21071)**



Application Site

The remaining area has been paved with concrete at a depth of 0.9m (from 6.9mPD to 7.8mPD) to provide waterproof surface for erection of structures.

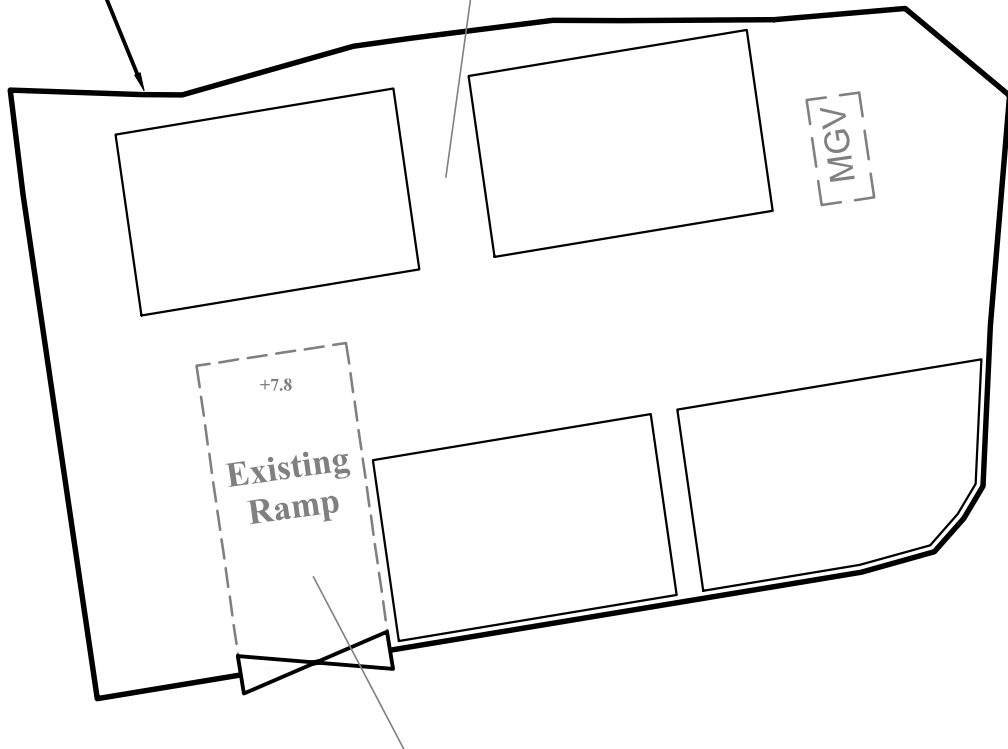

This existing ramp has been paved with concrete at a depth of 0.1m to 0.9m (from 6.9mPD to 7.8mPD) to provide waterproof surface for maneuvering.

Legend

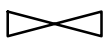

Vehicular Ingress / Egress

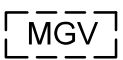

**Parking space for medium goods vehicle
(7m (L) x 3.5m (W))**

1 : 500

**Plan Showing the Area of Site
Has Been Paved**

**Goldrich Planners &
Surveyors Ltd.**

January 2025

Lot 1376 RP in D. D. 109
Yuen Long, New Territories

**Plan 4
(P 21071)**

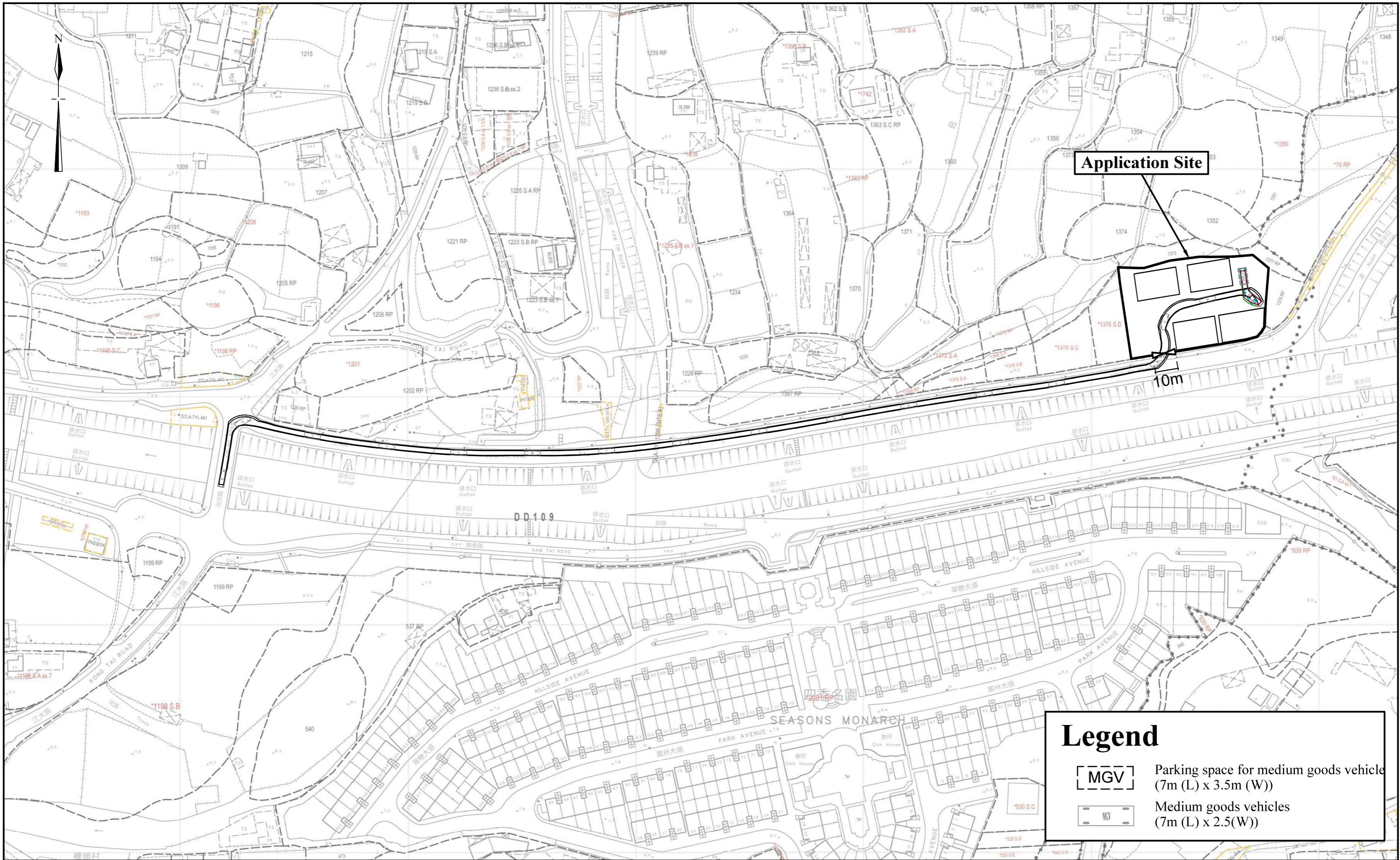

Application Site

10m

Legend

[MGV] Parking space for medium goods vehicle (7m (L) x 3.5m (W))

MGV Medium goods vehicles (7m (L) x 2.5(W))

1:1500 (A3)

January 2025

Swept Path Analysis

Lot 1376 RP in D. D. 109
Yuen Long, New Territories

Goldrich Planners & Surveyors Ltd.

Plan 5 (P 21071)