

Our Ref. : DD107 Lot 1434
Your Ref. : TPB/A/YL-KTN/979

The Secretary,
Town Planning Board,
15/F, North Point Government Offices,
333 Java Road,
North Point, Hong Kong

By Email

31 May 2024

Dear Sir,

5th Further Information

**Proposed Temporary Warehouse (Excluding Dangerous Goods Godown) with Ancillary Facilities
for a Period of 3 Years and Associated Filling of Land and Pond in “Agriculture” Zone,
Lot 1434 (Part) in D.D. 107, Kam Tin, Yuen Long, New Territories**

(S.16 Planning Application No. A/YL-KTN/979)

We are writing to submit further information to address departmental comments of the subject application (**Appendix I**).

Should you require more information regarding the application, please contact our Mr. Louis TSE at or the undersigned at your convenience. Your kind attention to the matter is much appreciated.

Yours faithfully,

For and on behalf of
R-riches Property Consultants Limited

Matthew NG
Planning and Development Manager

cc DPO/FSYLE, PlanD (Attn.: Ms. Andrea YAN email:)
(Attn.: Ms. Olivia NG email:)



Responses-to-Comments

Proposed Temporary Warehouse (Excluding Dangerous Goods Godown) with Ancillary Facilities for a Period of 3 Years and Associated Filling of Land and Pond in “Agriculture” Zone, Lot 1434 (Part) in D.D. 107, Kam Tin, Yuen Long, New Territories

(Application No. A/YL-KTN/979)

(i) A RtoC Table:

Departmental Comments		Applicant’s Responses
1. Comments of the Chief Engineer/Mainland North, Drainage Services Department (CE/MN, DSD) (Contact Person: Mr. Terence TANG; Tel.: 2300 1257)		
(1)	Response 4: 100mm dia. opening is not acceptable. 100mm separation opening from ground level along the hoarding should be provided.	Noted. 100mm separation opening from ground level along the hoarding will be provided.
(2)	Invert level of CP2.3 is higher than its upstream which is not acceptable.	Noted. The typo is corrected. The invert level of CP2.3 is +9.11 mPD. Please find revised Figure 3B for your perusal (Annex I).

PROJECT:
 Proposed Temporary Warehouse (Excluding Dangerous Goods Godown) with Ancillary Facilities for a Period of 3 Years and Associated Filling of Land and Pond in "Agriculture" Zone, Lot 1434 (part) in D.D. 107, Kam Tin, Yuen Long, New Territories

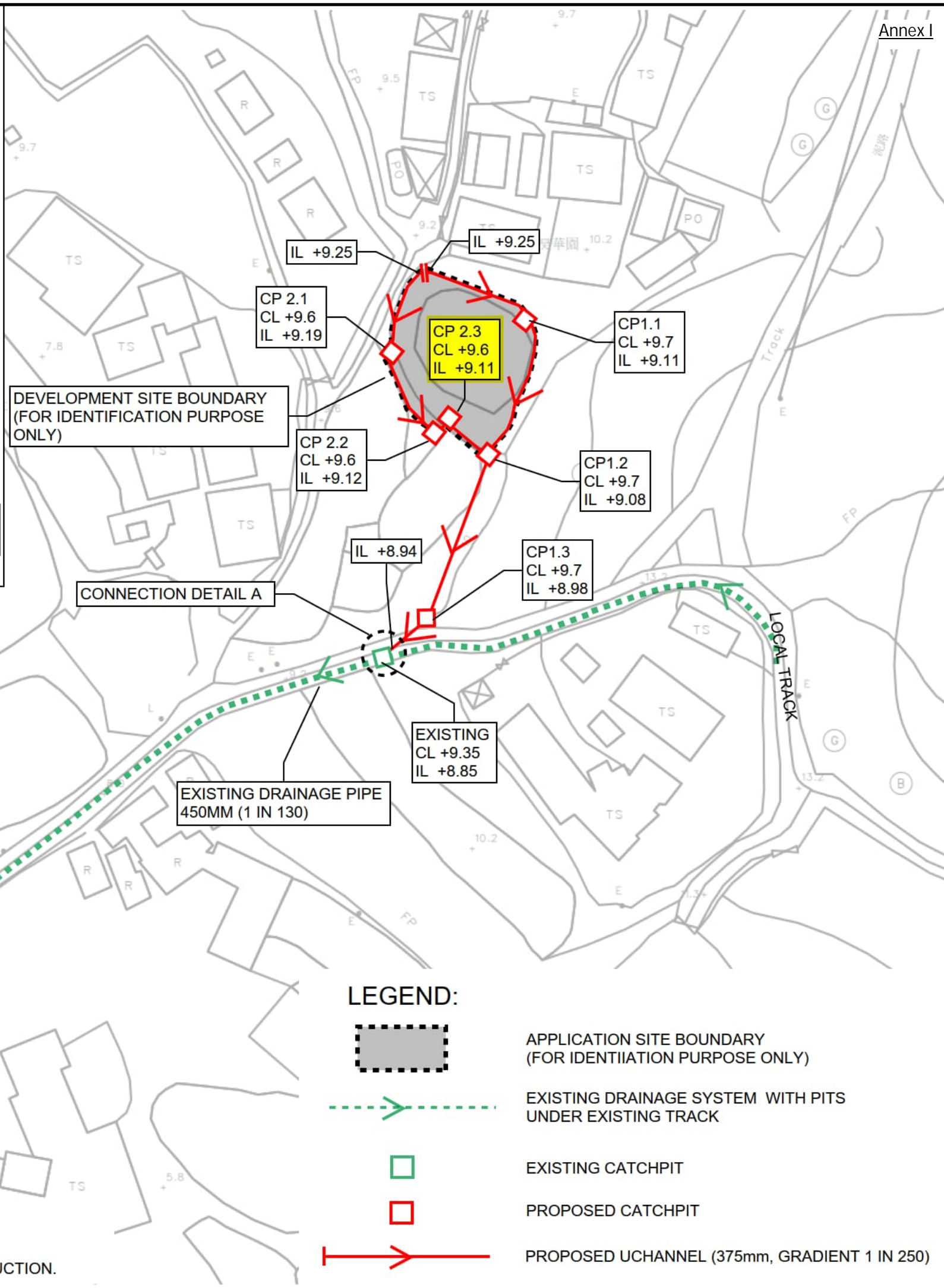
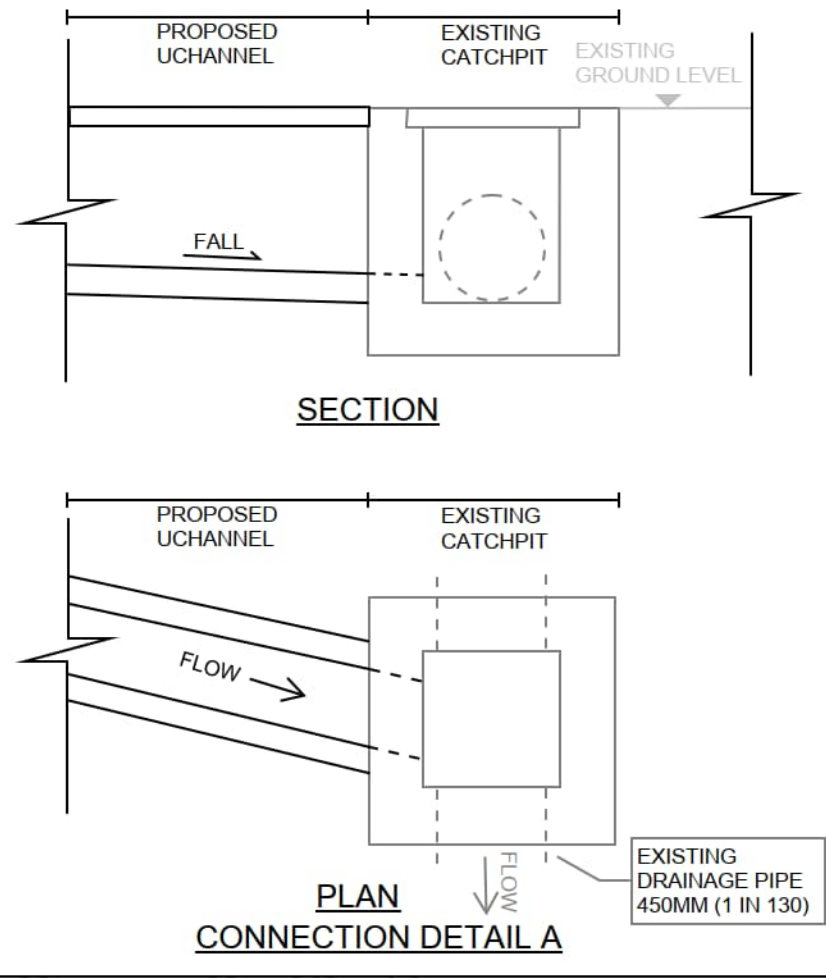





DEVELOPMENT SITE BOUNDARY (FOR IDENTIFICATION PURPOSE ONLY)

CONNECTION DETAIL A

EXISTING DRAINAGE PIPE 450MM (1 IN 130)

LEGEND:

-  APPLICATION SITE BOUNDARY (FOR IDENTIFICATION PURPOSE ONLY)
-  EXISTING DRAINAGE SYSTEM WITH PITS UNDER EXISTING TRACK
-  EXISTING CATCHPIT
-  PROPOSED CATCHPIT
-  PROPOSED UCHANNEL (375mm, GRADIENT 1 IN 250)

NOTES:
 1. COVER AND INVERT LEVEL OF CONNECTION POINT AND SIZE OF EXISTING DRAINS SHOULD BE VERIFIED ON SITE BEFORE CONSTRUCTION.

REV	DESCRIPTION	DATE
DRAWING TITLE: PROPOSED DRAINAGE SYSTEM		
DRAWING NUMBER: FIGURE 3B		