

Application Site



Project 項目名稱:
 Proposed Temporary Warehouse (Excluding Dangerous Goods Godown) with Ancillary Facilities for a Period of 3 Years and Associated Filling of Land at Lots 552 RP (Part) and 553 (Part) in D.D. 113 and Adjoining Government Land, Kam Tin, Yuen Long, New Territories

Drawing Title 圖紙標題:
 Location Plan

Drawing No. 圖號:
 20240813

Remarks 備註:
 ●●● Vehicular access leading from Kam Ho Road

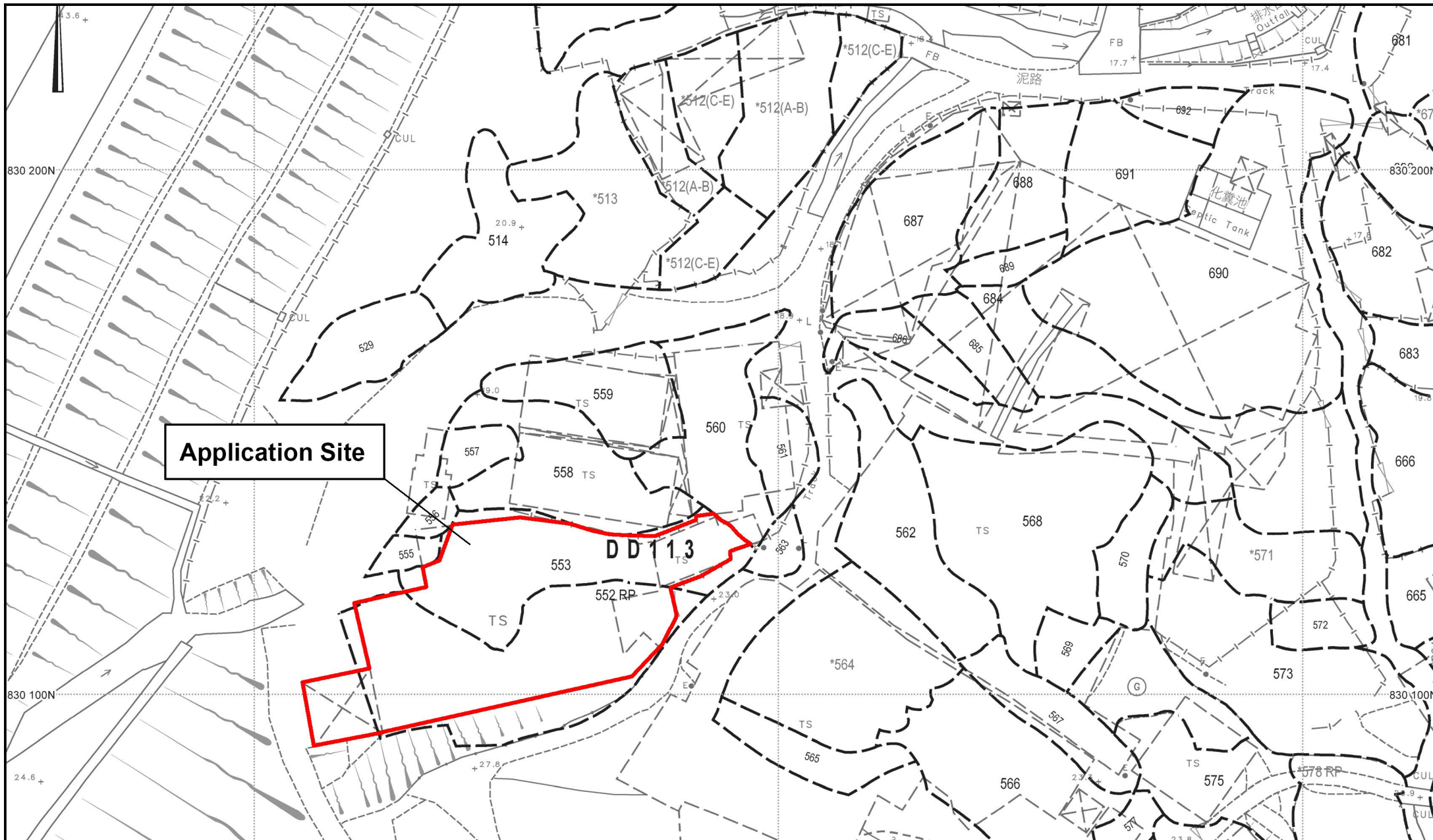

Application Site



Project 項目名稱:
Proposed Temporary Warehouse (Excluding Dangerous Goods Godown) with Ancillary Facilities for a Period of 3 Years and Associated Filling of Land at Lots 552 RP (Part) and 553 (Part) in D.D. 113 and Adjoining Government Land, Kam Tin, Yuen Long, New Territories

Drawing Title 圖紙標題:
Site Plan

Drawing No. 圖號:
20240813

Remarks 備註:

Application Site

Structure 1
Warehouse (Excluding D.G.G)
GFA:1470 m² (ABOUT)
No. of storey: 1
Height: Not exceeding 7m

Structure 2
Warehouse (Excluding D.G.G)
GFA:110 m² (ABOUT)
No. of storey: 1
Height: Not exceeding 7m

Structure 3
Warehouse (Excluding D.G.G)
GFA:120 m² (ABOUT)
No. of storey: 1
Height: Not exceeding 7m

Structure 5
Shelter
GFA:170 m² (ABOUT)
No. of storey: 1
Height: Not exceeding 7m

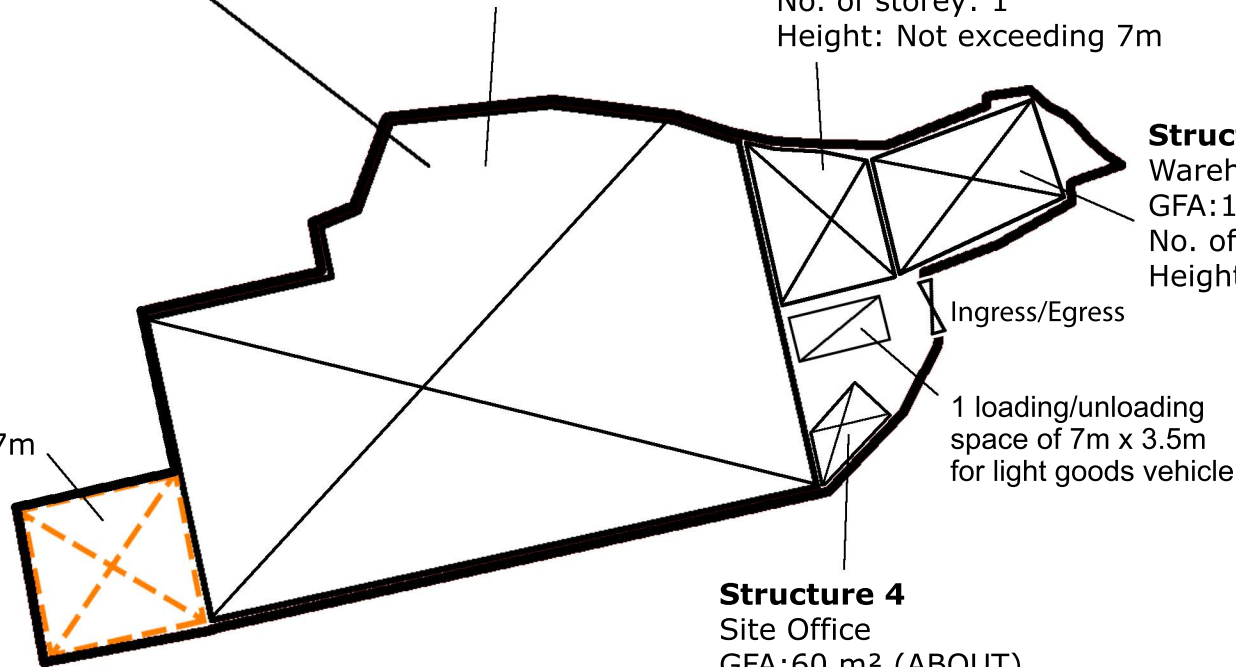

Ingress/Egress

1 loading/unloading space of 7m x 3.5m for light goods vehicle



Structure 4
Site Office
GFA:60 m² (ABOUT)
No. of storey: 2
Height: Not exceeding 7 m



Project 項目名稱:
Proposed Temporary Warehouse (Excluding Dangerous Goods Godown) with Ancillary Facilities for a Period of 3 Years and Associated Filling of Land at Lots 552 RP (Part) and 553 (Part) in D.D. 113 and Adjoining Government Land, Kam Tin, Yuen Long, New Territories

Drawing Title 圖紙標題:
Layout Plan

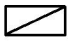
Drawing No. 圖號:
202480813

Remarks 備註:
 Light goods vehicle
 Structure
 Rain shelter

Application Site

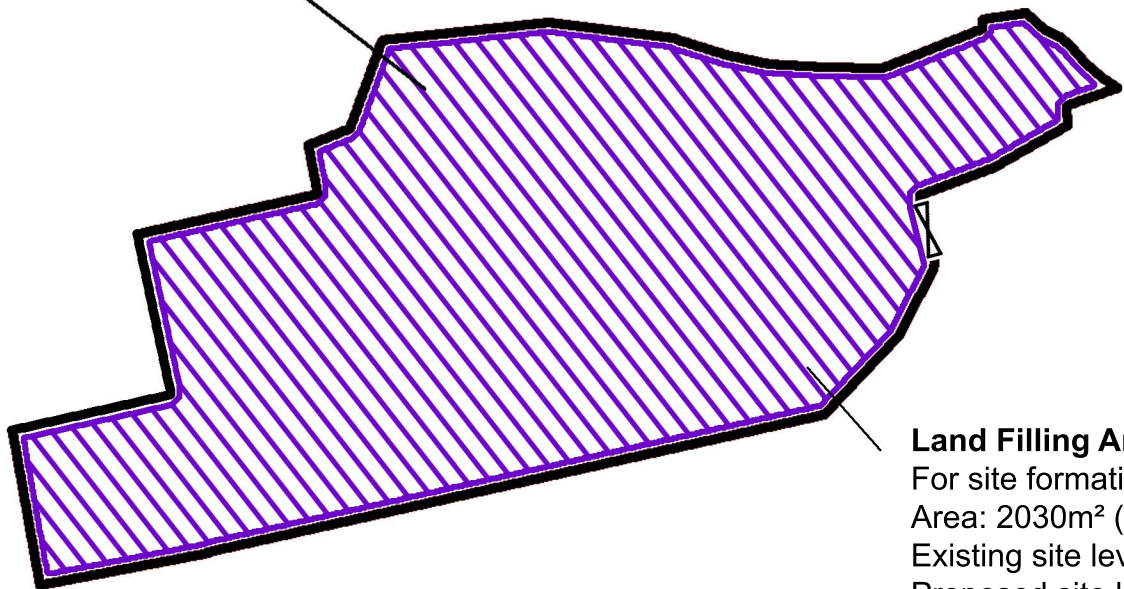

Land Filling Area
For site formation of structures and circulation path
Area: 2030m² (ABOUT)
Existing site level: +23.4mPD (ABOUT)
Proposed site level: +23.6mPD (ABOUT)
Depth of land filling : No more than 0.2m
Land Filling Materials : Concrete



Project 項目名稱:
Proposed Temporary Warehouse (Excluding Dangerous Goods Godown) with Ancillary Facilities for a Period of 3 Years and Associated Filling of Land at Lots 552 RP (Part) and 553 (Part) in D.D. 113 and Adjoining Government Land, Kam Tin, Yuen Long, New Territories

Drawing Title 圖紙標題:
Paved Ratio Plan
Drawing No. 圖號:
202480813

Remarks 備註:
 Land filling area