

Project 項目名稱:  
 Proposed Temporary Warehouse (Excluding Dangerous Goods Godown) with Ancillary Facilities for a Period of 3 Years and Associated Filling of Land at Lot 1384 S.A RP (Part) in D.D. 112 and Adjoining Government Land, Kam Sheung Road, Yuen Long, New Territories.

Drawing Title 圖紙標題:  
 Location Plan

Drawing No. 圖號:  
 20241112

Remarks 備註:  
 ●●● Vehicular access leading from Kam Sheung Road



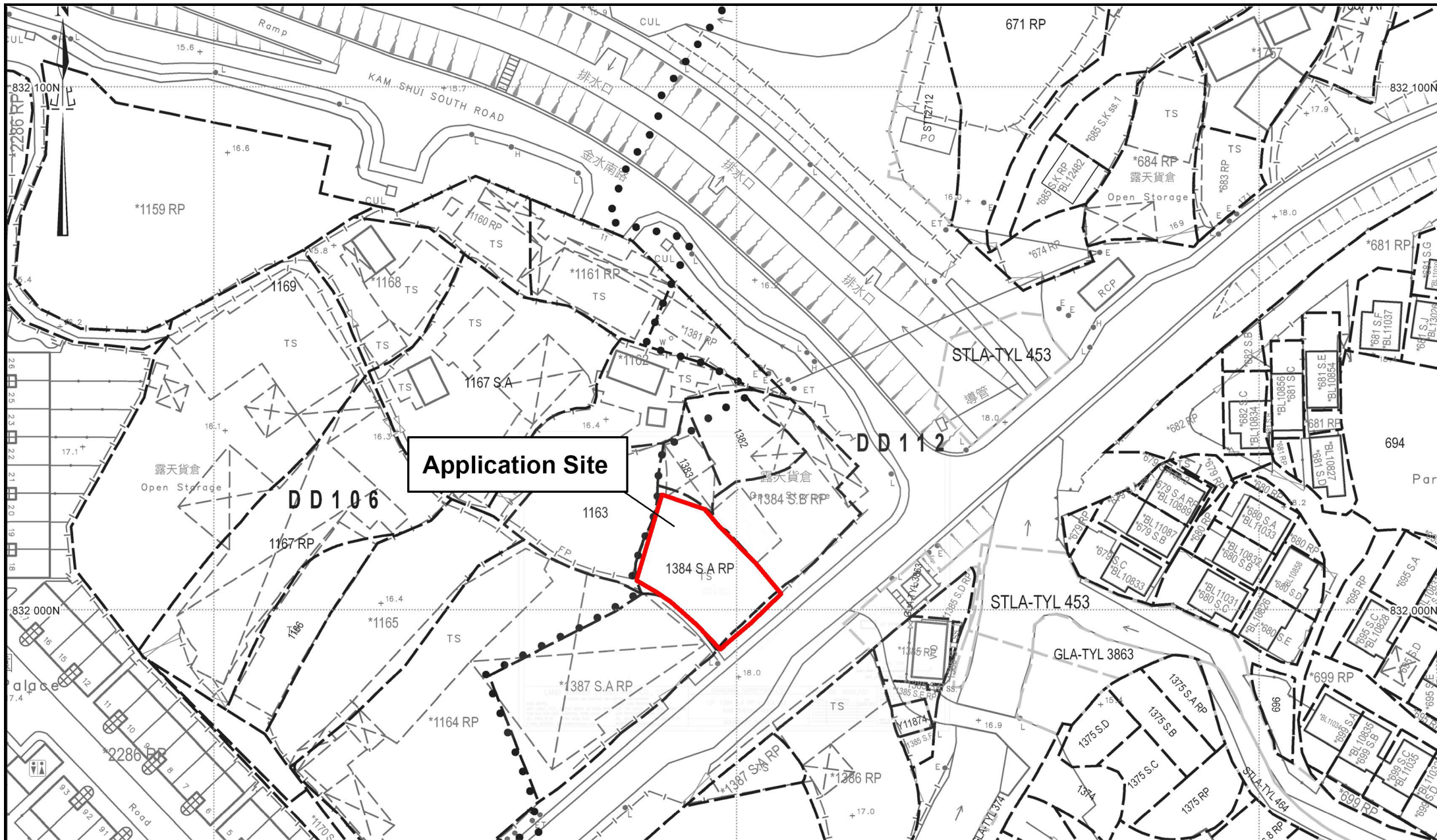

**Application Site**



Project 項目名稱:  
**Proposed Temporary Warehouse (Excluding Dangerous Goods Godown) with Ancillary Facilities for a Period of 3 Years and Associated Filling of Land at Lot 1384 S.A RP (Part) in D.D. 112 and Adjoining Government Land, Kam Sheung Road, Yuen Long, New Territories.**

Drawing Title 圖紙標題:  
**Site Plan**

Drawing No. 圖號:  
**20241112**

Remarks 備註:

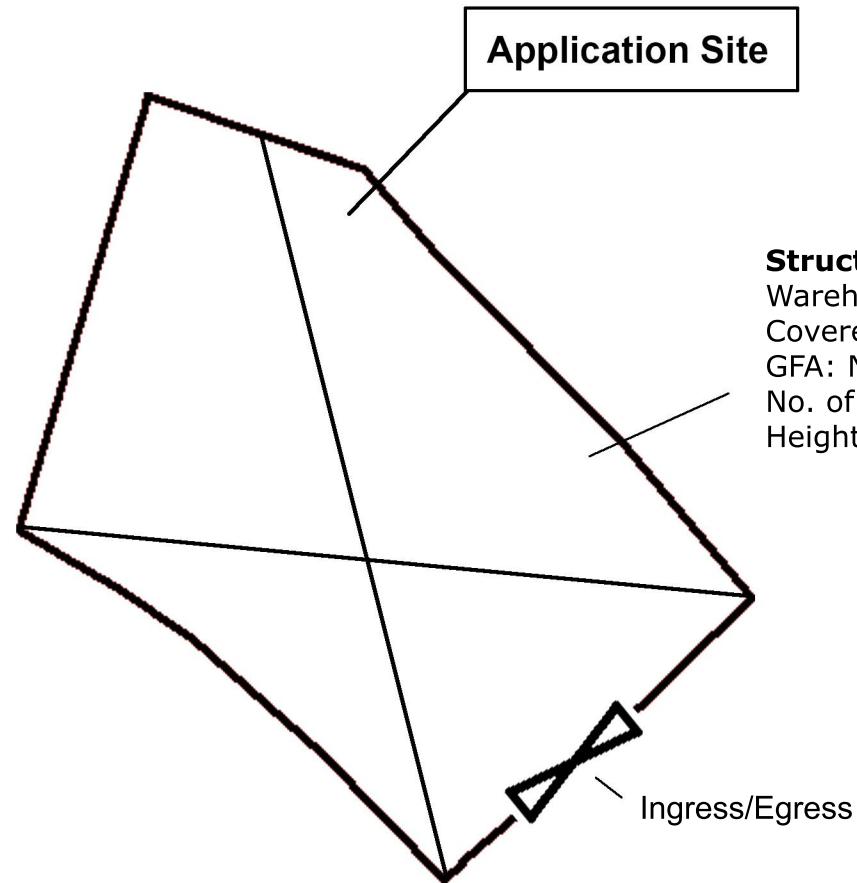

**Structure 1**

Warehouse

Covered Area: 440m<sup>2</sup> (ABOUT)

GFA: Not exceeding 750m<sup>2</sup> (ABOUT)

No. of storey: 2

Height: Not exceeding 6m

Project 項目名稱:

Proposed Temporary Warehouse (Excluding Dangerous Goods Godown) with Ancillary Facilities for a Period of 3 Years and Associated Filling of Land at Lot 1384 S.A RP (Part) in D.D. 112 and Adjoining Government Land, Kam Sheung Road, Yuen Long, New Territories.

Drawing Title 圖紙標題:

Layout Plan

Drawing No. 圖號:

20241112

Remarks 備註:

☒ Structure



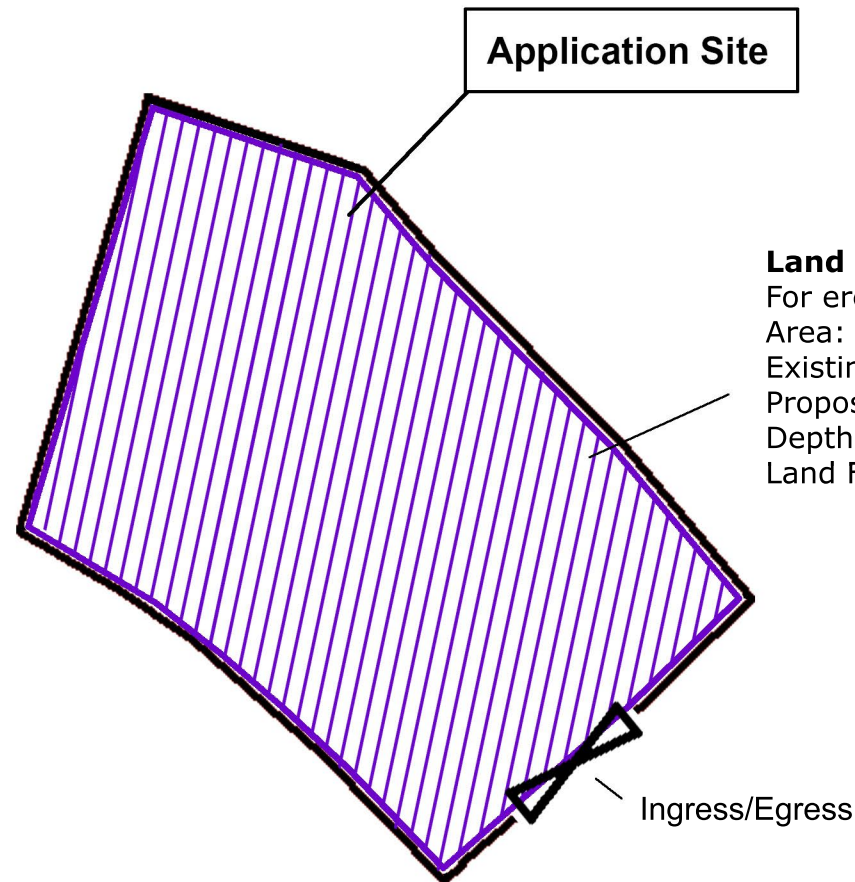

**Land Filling Area**

For erection of structures

Area: 440m<sup>2</sup> (ABOUT)

Existing site level: +18.0mPD (ABOUT)

Proposed site level: +18.2mPD (ABOUT)

Depth of land filling : No more than 0.2m

Land Filling Materials : Concret



Project 項目名稱:

Proposed Temporary Warehouse (Excluding Dangerous Goods Godown) with Ancillary Facilities for a Period of 3 Years and Associated Filling of Land at Lot 1384 S.A RP (Part) in D.D. 112 and Adjoining Government Land, Kam Sheung Road, Yuen Long, New Territories.

Drawing Title 圖紙標題:

Paved Ratio Plan

Drawing No. 圖號:

20241112

Remarks 備註:

 Land filling area