

Legend:

 Application Site 申請範圍

<p><u>Appendix 1</u></p> <p>Location: DD 106 Lot 480 (Part)</p> <p>OZP: S/YL-KTS/15</p> <p>District: Kam Tin South</p> <p>Zoning: Other Specified Uses (Rural Use)</p> <p>Date: 28 December 2024</p>	<p><u>Location</u></p> <p>位置圖</p> <p>擬議臨時貨倉 (危險品倉庫除外) 連附屬設施 (為期3年)</p> <p>Proposed Temporary Warehouse (excluding Dangerous Goods Godown) with Ancillary Facilities for a Period of 3 Years</p>	<p><u>SCALE</u></p> <p>1:1000</p> <p>@A4</p> <p>For Identification Only</p>
		<p>Drawing No.:</p> <p>1-01</p>

Proposed Structures Details

	Structures	Gross Floor Area (GFA)	Height (Not Exceeding)	Storey	Unit(s)
A	Warehouse (Excluding D.G.G.) with Ancillary Office	About 31m x 7m = 217 m ²	8m	1	1
B	Warehouse (Excluding D.G.G.) with Ancillary Office	About 20m x 11m = 220 m ²	8m	1	1
C	Ancillary Office	About 12m x 2.5m = 30 m ²	6m	2	2
D	Open Shed	About 14m x 7.5m = 105m ²	8m	/	1
Total Non-Domestic GFA		About 662 m ²			
Private Car Parking Space		5m x 2.5m			2
Light Goods Vehicle L/UL Space		7m x 3.5m			1
Medium Goods Vehicle L/UL Space		11m x 3.5m			1

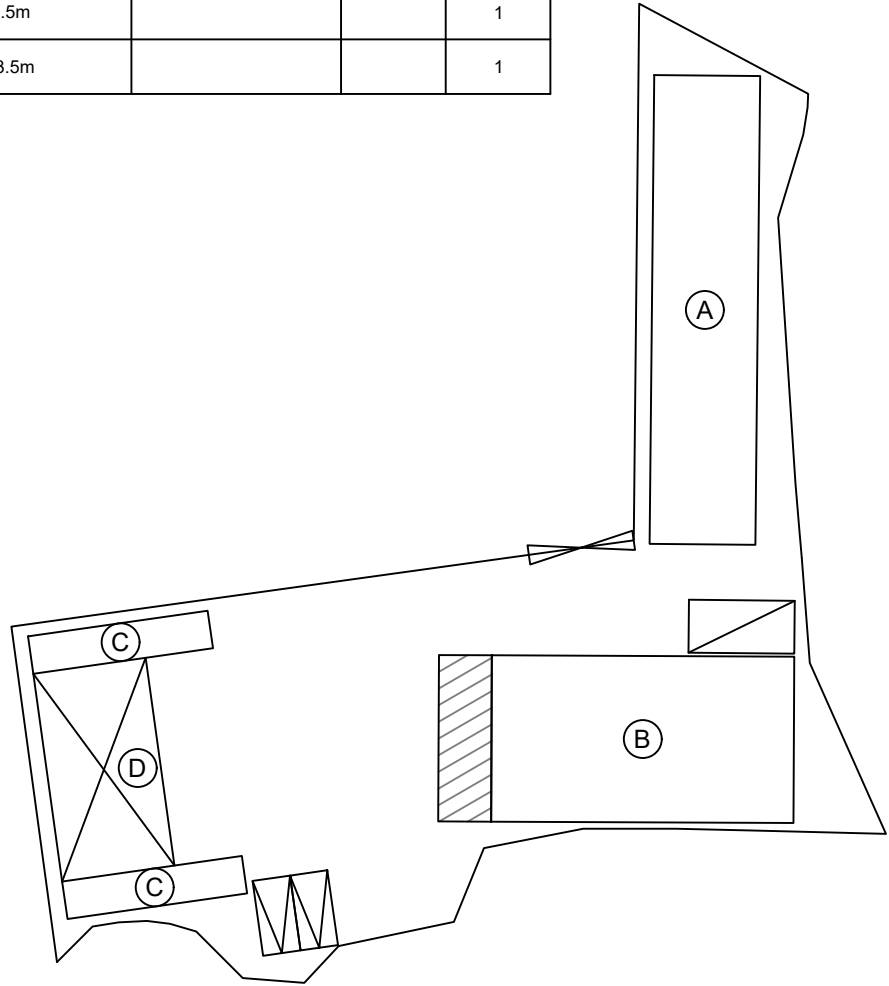

Legend:

- ⊗ Ingress/egress (Width: About 7m)
- ⊠ Proposed Structures
- ⊞ Open Shed
- ⊡ Private Car Parking Space
- ⊟ Light Goods Vehicle L/UL Sapce
- ▨ Medium Good Vehicle L/UL Space

Total Area: 1,457.6 m² (About)
 Covered Area: 602 m² (About)
 Uncovered Area: 855.6 m² (About)
 Non-Domestic GFA: 662 m² (About)
 Nos. of Proposed Structures: 5

Appendix 2
 Location: DD 106 Lot 480 (Part)
 OZP: S/YL-KTS/15
 District: Kam Tin South
 Zoning: Other Specified Uses (Rural Use)
 Date: 28 December 2024

Proposed Layout Plan
 擬議佈局平面圖
 擬議臨時貨倉 (危險品倉庫除外)
 連附屬設施 (為期3年)
 Proposed Temporary Warehouse (excluding Dangerous Goods Godown) with Ancillary Facilities for a Period of 3 Years

SCALE
 1:500
 @A4

For Identification Only	Drawing No.:
	2-01

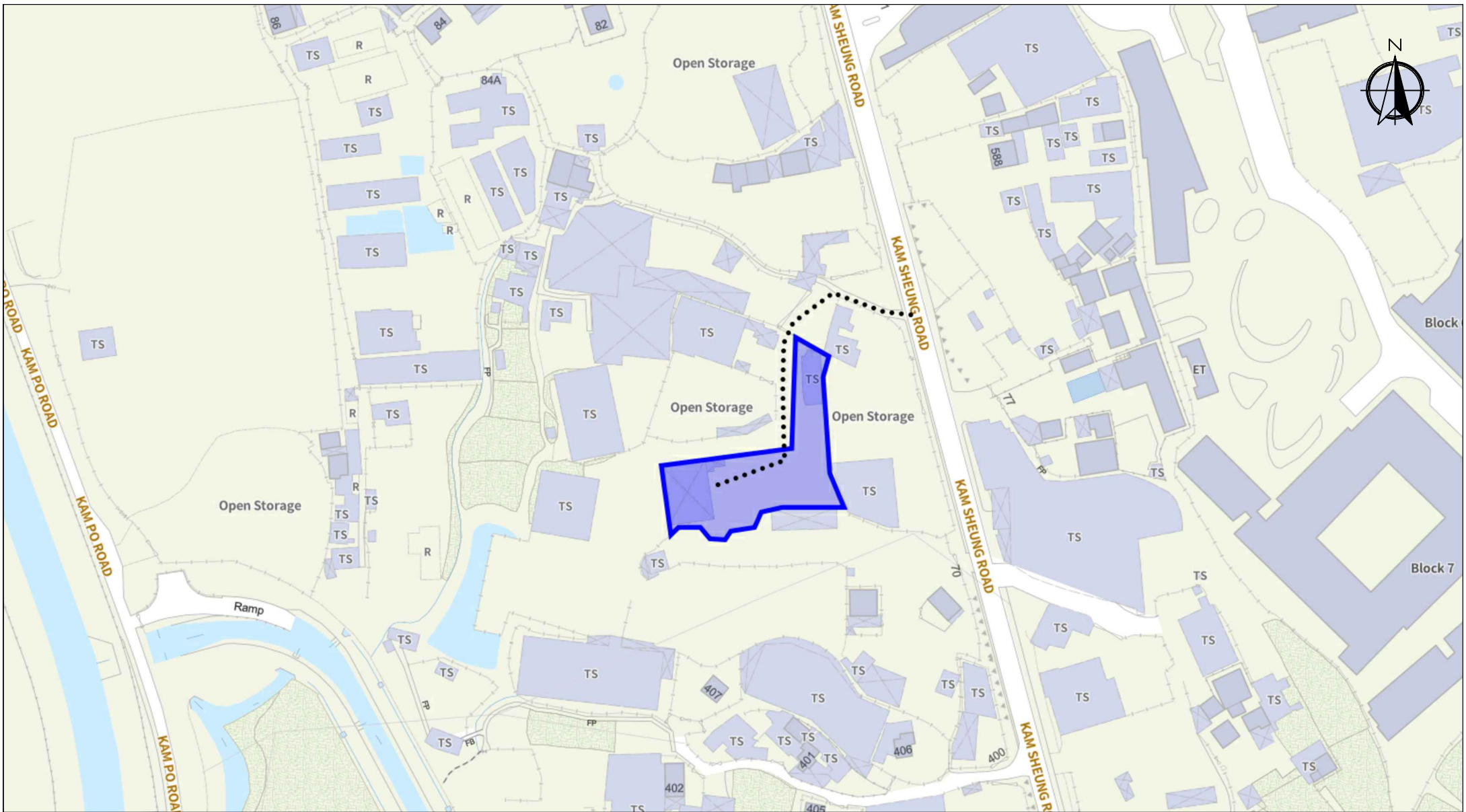

Scale: Undefined @A4

Captured from map.gov.hk on 28th December 2024

<p>Appendix 3</p> <p>Existing Vehicular Access</p>	<p>Location: D.D. 106 Lot 480 (Part)</p> <p>OZP: S/YL-KTS/15</p> <p>District: Kam Tin South</p> <p>Zoning: Other Specified Uses (Rural Use)</p>	<p>Proposed Temporary Warehouse (excluding Dangerous Goods Godown) with Ancillary Facilities for a Period of 3 Years</p>	<p>Width of Kam Sheung Road: 6m (About)</p> <p>Map Legend:</p> <ul style="list-style-type: none"> ●●●● Road Path — Site Boundary 	<p>Drawing No.: 3-01</p> <p>For Identification Only</p> <p>Date: 28/12/2024</p>
---	---	--	--	---