

Application Site

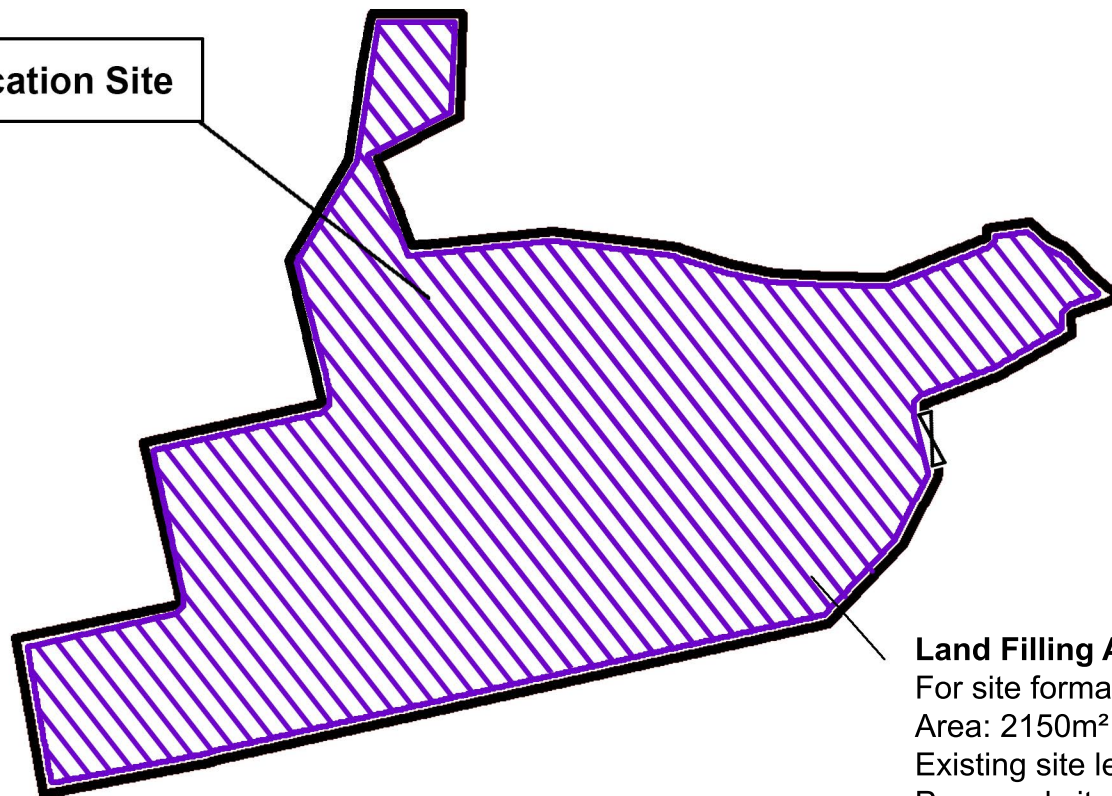

Land Filling Area

For site formation of structures and circulation path

Area: 2150m² (ABOUT)

Existing site level: +23.4mPD (ABOUT)

Proposed site level: +23.6mPD (ABOUT)

Depth of land filling : No more than 0.2m

Land Filling Materials : Concrete



Project 項目名稱:

Proposed Temporary Warehouse (Excluding Dangerous Goods Godown) with Ancillary Facilities and Associated Filling of Land for a Period of 3 Years at Lots 552 RP(Part), 553(Part), 555(Part), 556(Part) and 557(Part) in D.D. 113 and Adjoining Government Land, Kam Tin, Yuen Long, N.T.

Drawing Title 圖紙標題:

Paved Ratio Plan

Drawing No. 圖號:

20250308

Remarks 備註:

 Land filling area

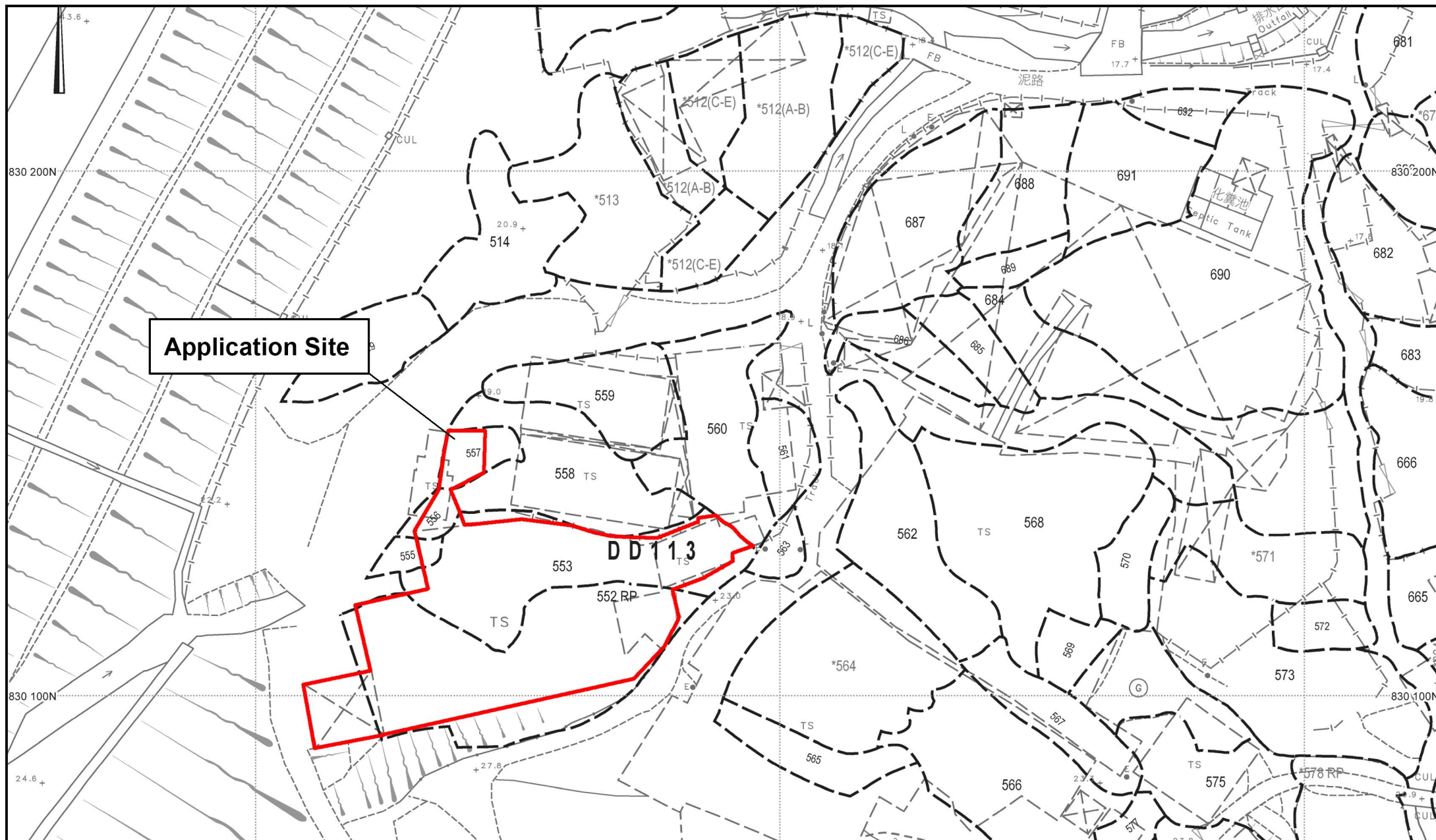

Application Site

Project 項目名稱:

Proposed Temporary Warehouse (Excluding Dangerous Goods Godown) with Ancillary Facilities and Associated Filling of Land for a Period of 3 Years at Lots 552 RP(Part), 553(Part), 555(Part), 556(Part) and 557(Part) in D.D. 113 and Adjoining Government Land, Kam Tin, Yuen Long, N.T.

Drawing Title 圖紙標題:

Site Plan

Remarks 備註:

Drawing No. 圖號:

20250222

Structure 6

Site Office

GFA:80 m² (ABOUT)

No. of storey: 2

Height: Not exceeding 7m

Structure 1

Warehouse (Excluding D.G.G)

GFA:1470 m² (ABOUT)

No. of storey: 1

Height: Not exceeding 7m

Structure 2

Warehouse (Excluding D.G.G)

GFA:110 m² (ABOUT)

No. of storey: 1

Height: Not exceeding 7m

Structure 3

Warehouse (Excluding D.G.G)

GFA:120 m² (ABOUT)

No. of storey: 1

Height: Not exceeding 7m

Application Site**Structure 5**

Shelter

GFA:170 m² (ABOUT)

No. of storey: 1

Height: Not exceeding 7m

Ingress/Egress

1 loading/unloading
space of 7m x 3.5m
for light goods vehicle**Structure 4**

Site Office

GFA:60 m² (ABOUT)

No. of storey: 2

Height: Not exceeding 7 m

Project 項目名稱:

Proposed Temporary Warehouse (Excluding Dangerous Goods Godown) with Ancillary Facilities and Associated Filling of Land for a Period of 3 Years at Lots 552 RP(Part), 553(Part), 555(Part), 556(Part) and 557(Part) in D.D. 113 and Adjoining Government Land, Kam Tin, Yuen Long, N.T.

Drawing Title 圖紙標題:

Layout Plan

Drawing No. 圖號:

20250222

Remarks 備註:



Light goods vehicle



Structure



Rain shelter



Project 項目名稱:

Proposed Temporary Warehouse (Excluding Dangerous Goods Godown) with Ancillary Facilities and Associated Filling of Land for a Period of 3 Years at Lots 552 RP(Part), 553(Part), 555(Part), 556(Part) and 557(Part) in D.D. 113 and Adjoining Government Land, Kam Tin, Yuen Long, N.T.

Drawing Title 圖紙標題:

Location Plan

Drawing No. 圖號:

20250222

Remarks 備註:

●●● Vehicular access leading from Kam Ho Road

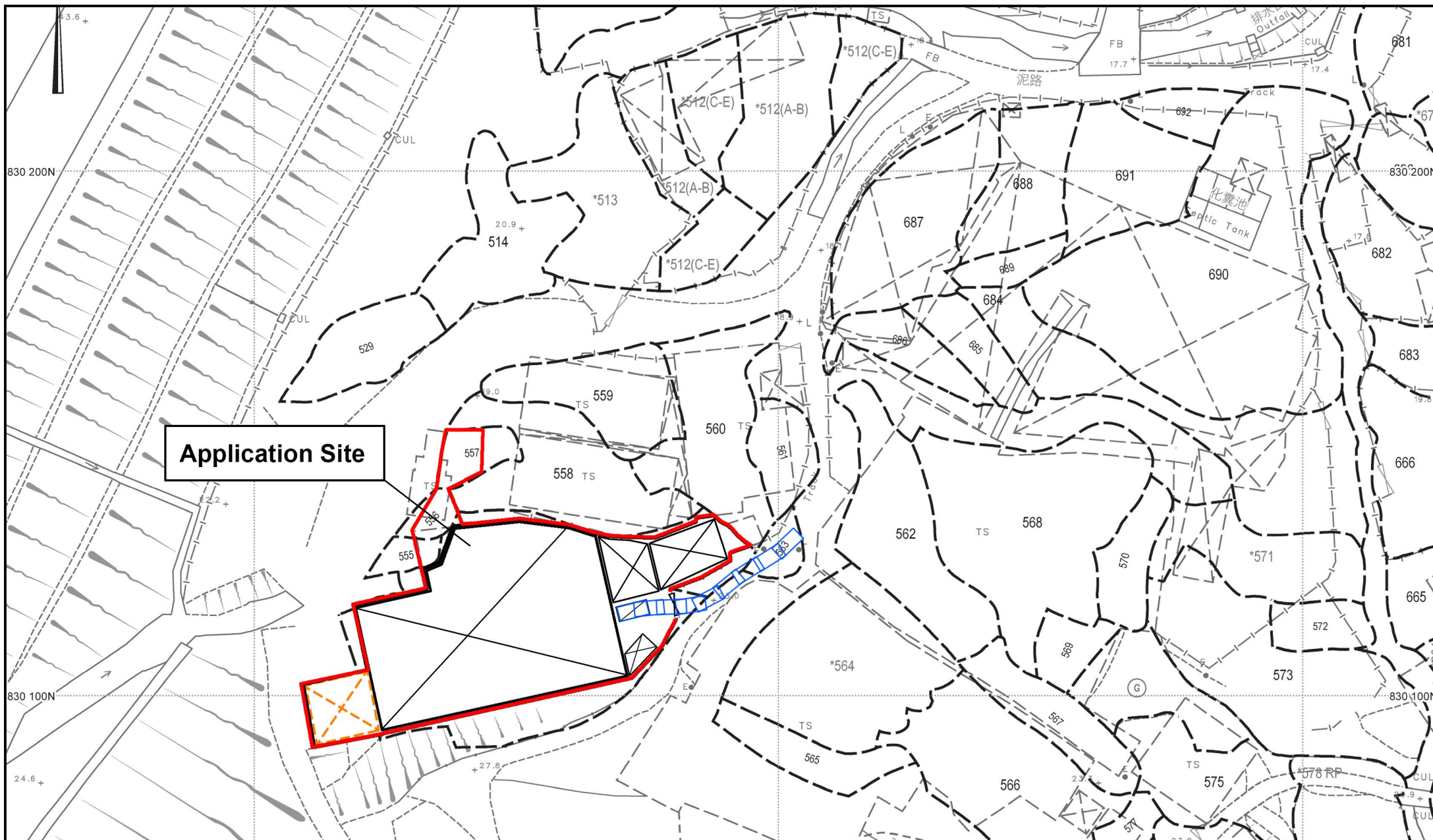

Project 項目名稱:
 Proposed Temporary Warehouse (Excluding Dangerous Goods Godown) with Ancillary Facilities for a Period of 3 Years and Associated Filling of Land at Lots 552 RP(Part), 553(Part), 555(Part), 556(Part) and 557(Part) in D.D. 113 and Adjoining Government Land, Kam Tin, Yuen Long, N.T.

Drawing Title 圖紙標題:
 Swept Path (IN)

Drawing No. 圖號:
 20250401

Remarks 備註:
 IN
 OUT

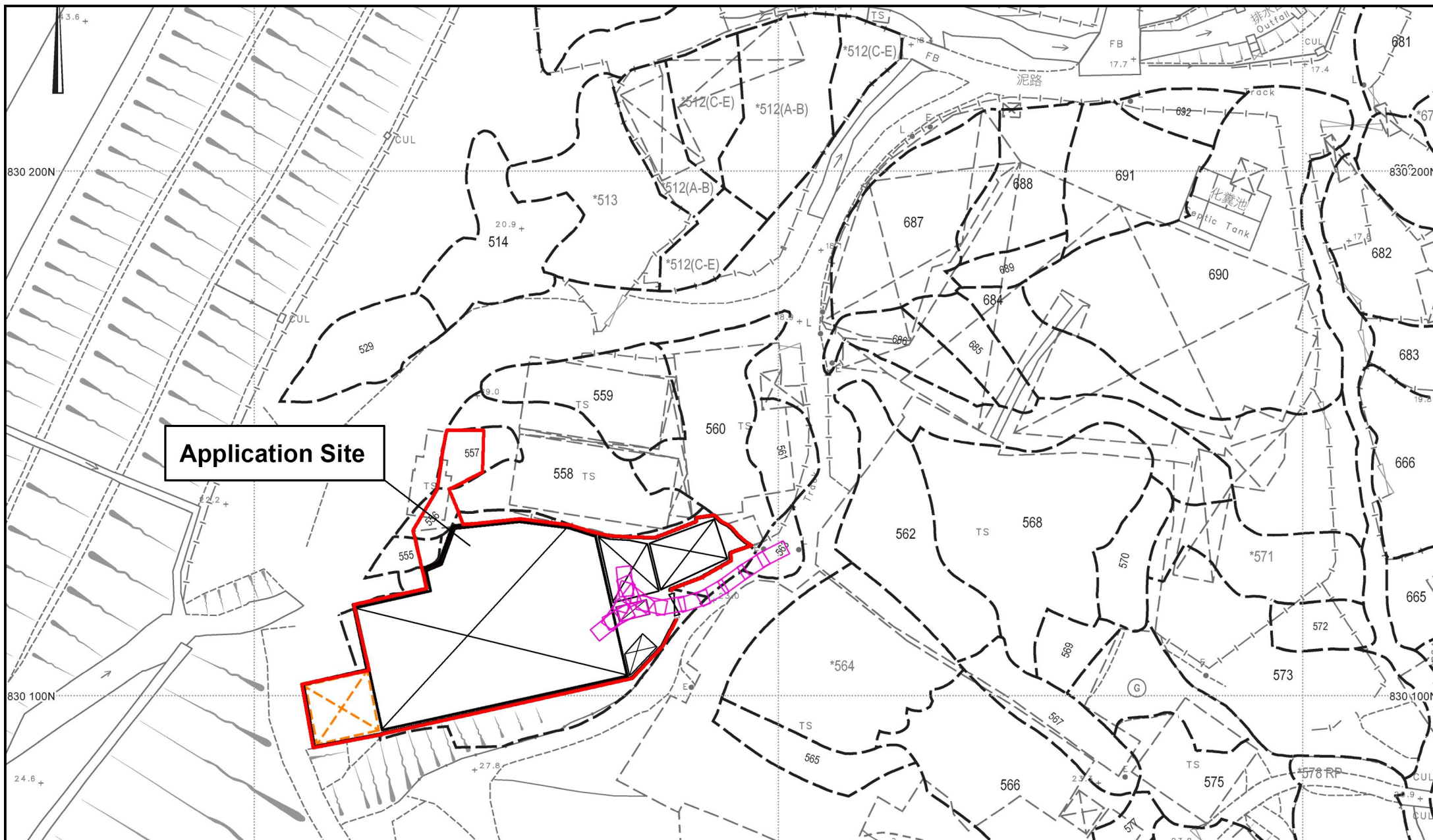

Project 項目名稱:

Proposed Temporary Warehouse (Excluding Dangerous Goods Godown) with Ancillary Facilities for a Period of 3 Years and Associated Filling of Land at Lots 552 RP(Part), 553(Part), 555(Part), 556(Part) and 557(Part) in D.D. 113 and Adjoining Government Land, Kam Tin, Yuen Long, N.T.

Drawing Title 圖紙標題:

Swept Path (OUT)

Drawing No. 圖號:

20250401

Remarks 備註:

IN

OUT