

**LAND STATUS OF THE APPLICATION SITE**

APPLICATION SITE AREA: 5,630 m<sup>2</sup> (ABOUT)  
 AREA OF PRIVATE LAND: 5,630 m<sup>2</sup> (ABOUT)  
 AREA OF GOVERNMENT LAND: 0 m<sup>2</sup> (ABOUT)



**PROJECT**

PROPOSED TEMPORARY PUBLIC VEHICLE PARK FOR PRIVATE CARS, LIGHT GOODS VEHICLES AND MEDIUM GOODS VEHICLES FOR A PERIOD OF 3 YEARS AND ASSOCIATED FILLING OF LAND

**SITE LOCATION**

LOTS 2749, 2750, 2751, 2752 (PART), 2762 RP, 2764 RP(PART), 2765 RP(PART), 2766 RP(PART), 2768(PART), 2770(PART), 2771, 2772, 2773, 2779(PART) AND 2780(PART) IN D.D. 129, LAU FAU SHAN, YUEN LONG, NEW TERRITORIES

**SCALE**

1 : 1000 @ A4

**DRAWING TITLE**

LAND STATUS

**DRAWN BY**

J.W

**DATE**

10.08.2024

**REVISED BY**

**DATE**

**APPROVED BY**

**DATE**

**DWG NO.**

PLAN 1

**VER.**

A-1

**LEGEND**

- APPLICATION SITE
- PRIVATE LOT

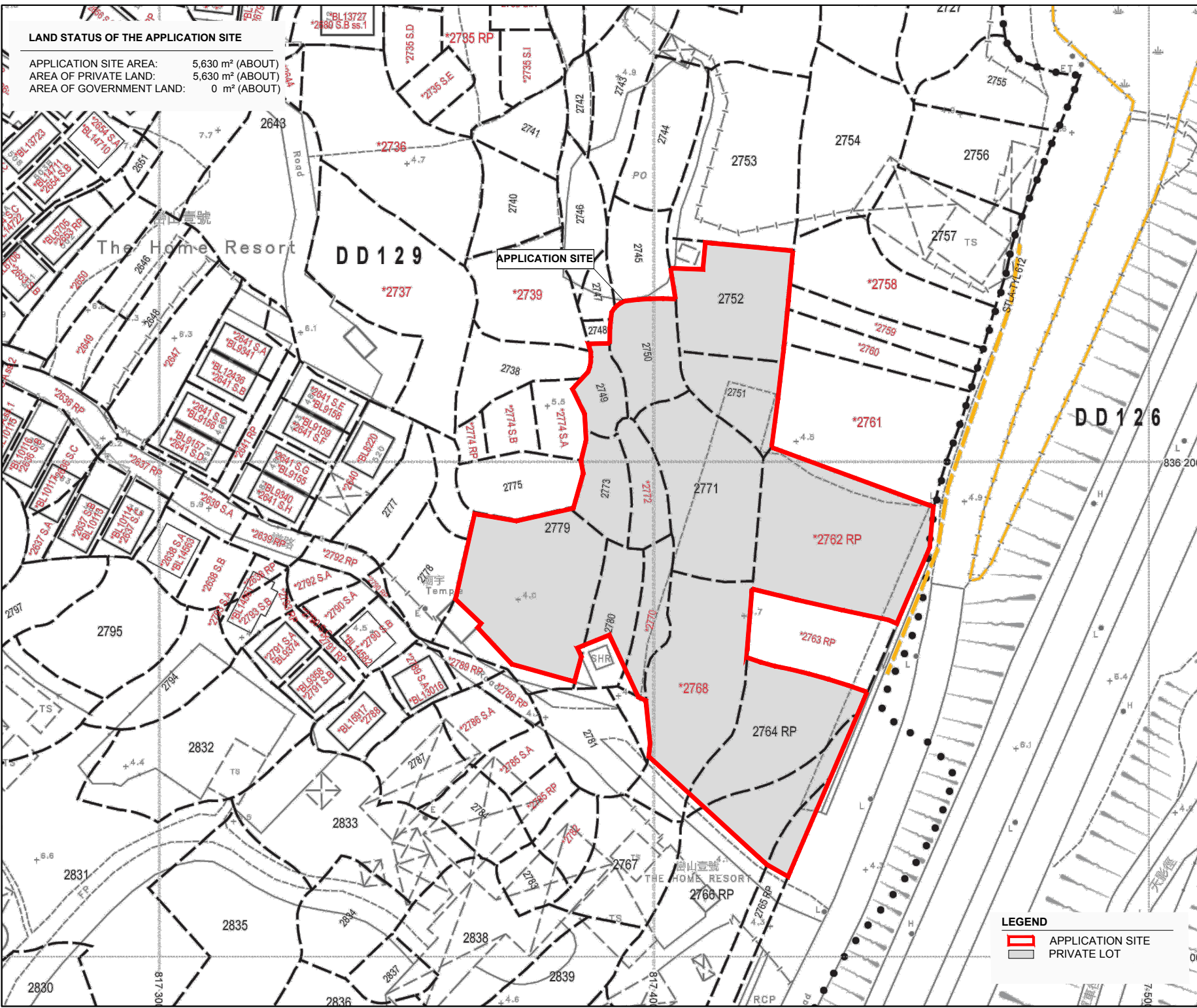

**DEVELOPMENT PARAMETERS**

APPLICATION SITE AREA: 5,630m<sup>2</sup> (ABOUT)  
 COVERED AREA: 18m<sup>2</sup> (ABOUT)  
 UNCOVERED AREA: 5,612m<sup>2</sup> (ABOUT)

PLOT RATIO: 0.003(AABOUT)  
 SITE COVERAGE: 0.3%(ABOUT)

NO. OF STRUCTURE: 1  
 DOMESTIC GFA: NOT APPLICABLE  
 NON- DOMESTIC GFA: 18m<sup>2</sup> (ABOUT)  
 TOTAL GFA: 18m<sup>2</sup> (ABOUT)

BUILDING HEIGHT: 3m (ABOUT)  
 NO. OF STOREY: 1

**MEDIUM GOODS VEHICLE PARKING SPACE**

DIMENSION: 3.5m x 11m  
 No. OF PARKING: 23

**LIGHT GOODS VEHICLE PARKING SPACE**

DIMENSION: 3.5m x 7m  
 No. OF PARKING: 7

**PRIVATE CAR PARKING SPACE**

DIMENSION: 2.5m x 5m  
 No. OF PARKING: 49

**STRUCTURE B1**

USE: GUARD ROOM  
 COVERED AREA: 18 m<sup>2</sup> (ABOUT)  
 HEIGHT: 3m(AABOUT)  
 STOREY: 1  
 GFA: 18m<sup>2</sup> (ABOUT)

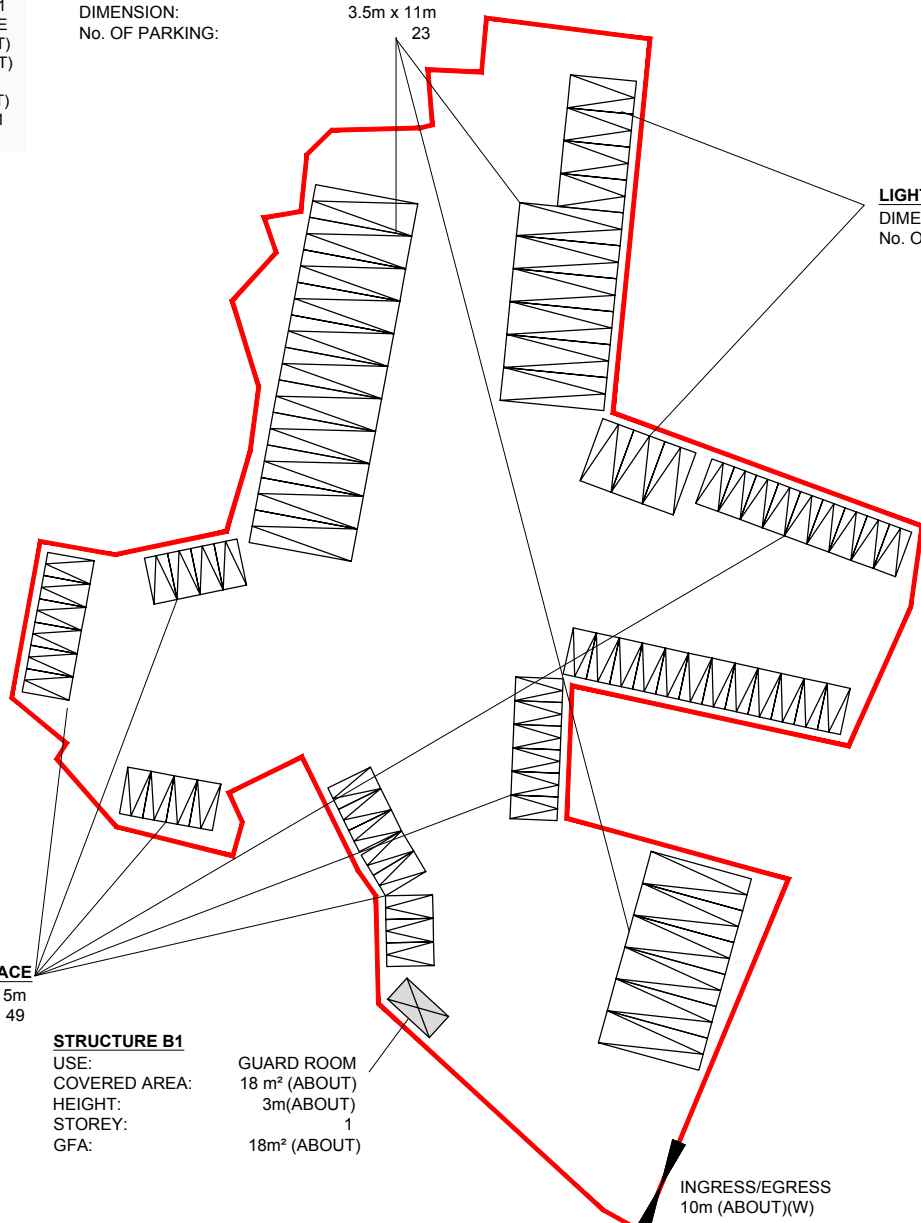

**LEGEND**

- APPLICATION SITE
- STRUCTURE (ENCLOSED)
- PC PARKING SPACE
- LGV PARKING SPACE
- MGV PARKING SPACE
- INGRESS/EGRESS



**PROJECT**

PROPOSED TEMPORARY PUBLIC VEHICLE PARK FOR PRIVATE CARS, LIGHT GOODS VEHICLES AND MEDIUM GOODS VEHICLES FOR A PERIOD OF 3 YEARS AND ASSOCIATED FILLING OF LAND

**SITE LOCATION**

LOTS 2749, 2750, 2751, 2752 (PART), 2762 RP, 2764 RP(PART), 2765 RP(PART), 2766 RP(PART), 2768(PART), 2770(PART), 2771, 2772, 2773, 2779(PART) AND 2780(PART) IN D.D. 129, LAU FAU SHAN, YUEN LONG, NEW TERRITORIES

**SCALE**

1 : 800 @ A4

**DRAWING TITLE**

LAYOUT PLAN

**DRAWN BY**

J.W

**DATE**

10.08.2024

**REVISED BY**

**DATE**

**APPROVED BY**

**DATE**

**DWG NO.**

PLAN 2

**VER.**

A-1

**LOCATION OF THE APPLICATION SITE**

APPLICATION SITE AREA: 5,630 m<sup>2</sup> (ABOUT)

**VEHICULAR ACCESS**

ACCESSIBLE FROM TIN WAH ROAD



**PROJECT**

PROPOSED TEMPORARY PUBLIC VEHICLE PARK FOR PRIVATE CARS, LIGHT GOODS VEHICLES AND MEDIUM GOODS VEHICLES FOR A PERIOD OF 3 YEARS AND ASSOCIATED FILLING OF LAND

**SITE LOCATION**

LOTS 2749, 2750, 2751, 2752 (PART), 2762 RP, 2764 RP(PART), 2765 RP(PART), 2766 RP(PART), 2768(PART), 2770(PART), 2771, 2772, 2773, 2779(PART) AND 2780(PART) IN D.D. 129, LAU FAU SHAN, YUEN LONG, NEW TERRITORIES

**SCALE**

1 : 5000 @ A4

**DRAWING TITLE**

LOCATION AND ACCESS PLAN

**DRAWN BY**

J.W

**DATE**

10.08.2024

**REVISED BY**

**DATE**

**APPROVED BY**

**DATE**

**DWG NO.**

PLAN 3

**VER.**

A-1

**LEGEND**

 APPLICATION SITE

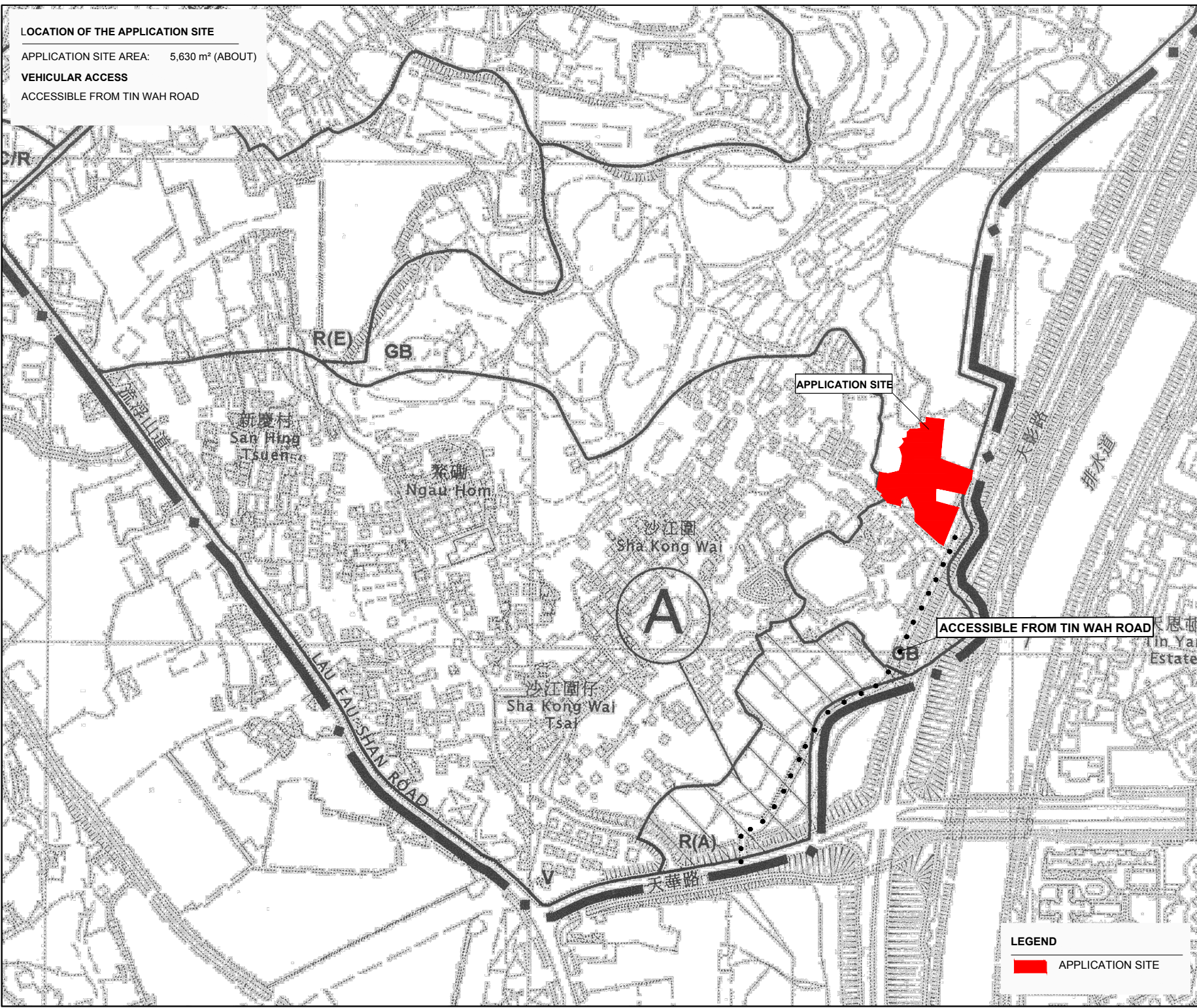

**PROPOSED SITE LEVEL OF THE APPLICATION SITE**

APPLICATION SITE AREA: 5,630 m<sup>2</sup> (ABOUT)  
 HARD PAVED AREA: 5,630 m<sup>2</sup> (ABOUT)  
 PROPOSED MEAN SITE LEVELS: +4.7 mPD (ABOUT)  
 DEPTH OF LAND FILLING: NOT MORE THAN 0.2 m

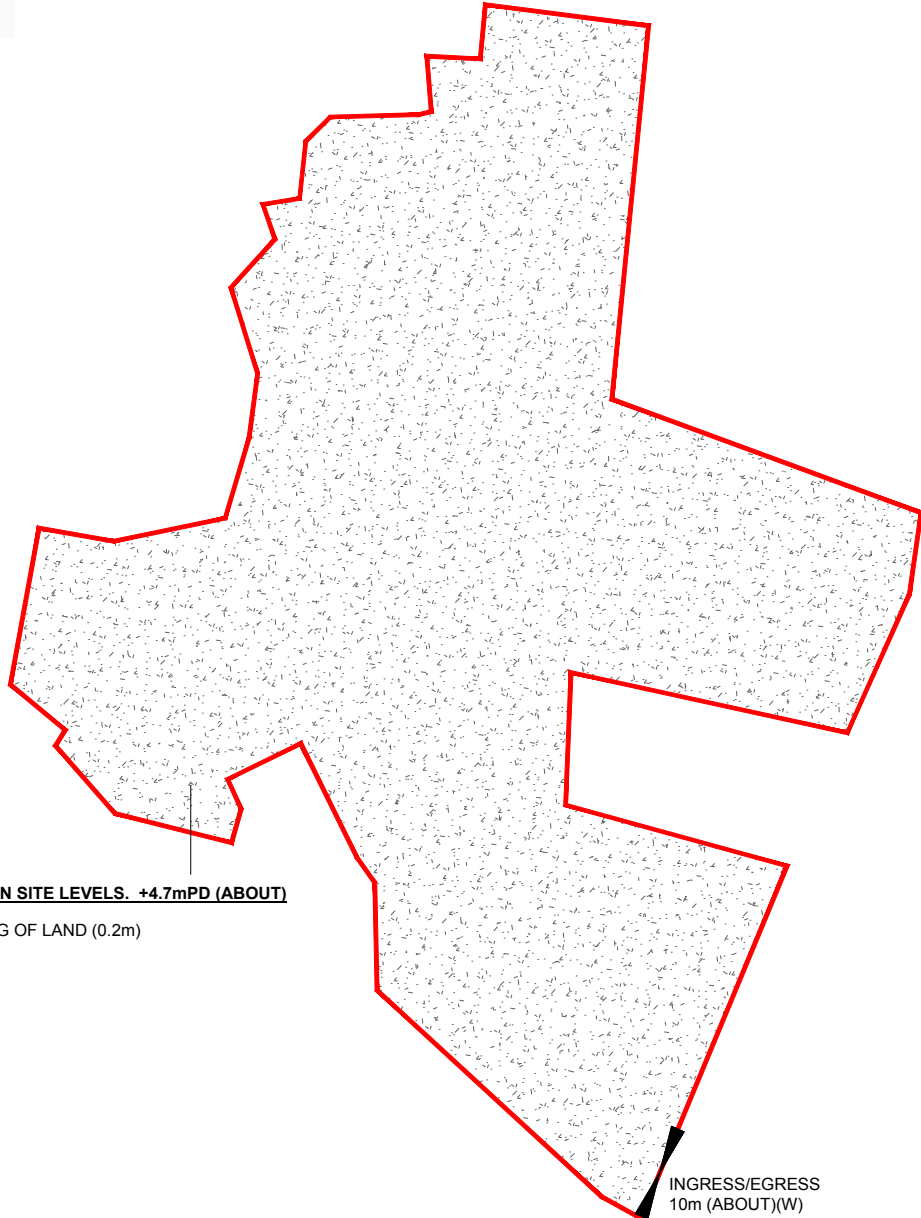

**PROPOSED MEAN SITE LEVELS. +4.7mPD (ABOUT)**

-INVOLVE FILLING OF LAND (0.2m)

INGRESS/EGRESS  
10m (ABOUT)(W)

**LEGEND**

-  APPLICATION SITE
-  CONCRETE
-  INGRESS/EGRESS



**PROJECT**

PROPOSED TEMPORARY  
PUBLIC VEHICLE PARK FOR  
PRIVATE CARS, LIGHT GOODS  
VEHICLES AND MEDIUM  
GOODS VEHICLES FOR A  
PERIOD OF 3 YEARS AND  
ASSOCIATED FILLING OF LAND

**SITE LOCATION**

LOTS 2749, 2750, 2751, 2752 (PART),  
2762 RP, 2764 RP(PART), 2765  
RP(PART), 2766 RP(PART),  
2768(PART), 2770(PART), 2771, 2772,  
2773, 2779(PART) AND 2780(PART)  
IN D.D. 129, LAU FAU SHAN, YUEN  
LONG, NEW TERRITORIES

**SCALE**

1 : 800 @ A4

**DRAWING TITLE**

PAVED RATIO PLAN

**DRAWN BY**

J.W

**DATE**

10.08.2024

**REVISED BY**

**DATE**

**APPROVED BY**

**DATE**

**DWG NO.**

PLAN 4

**VER.**

A-1