

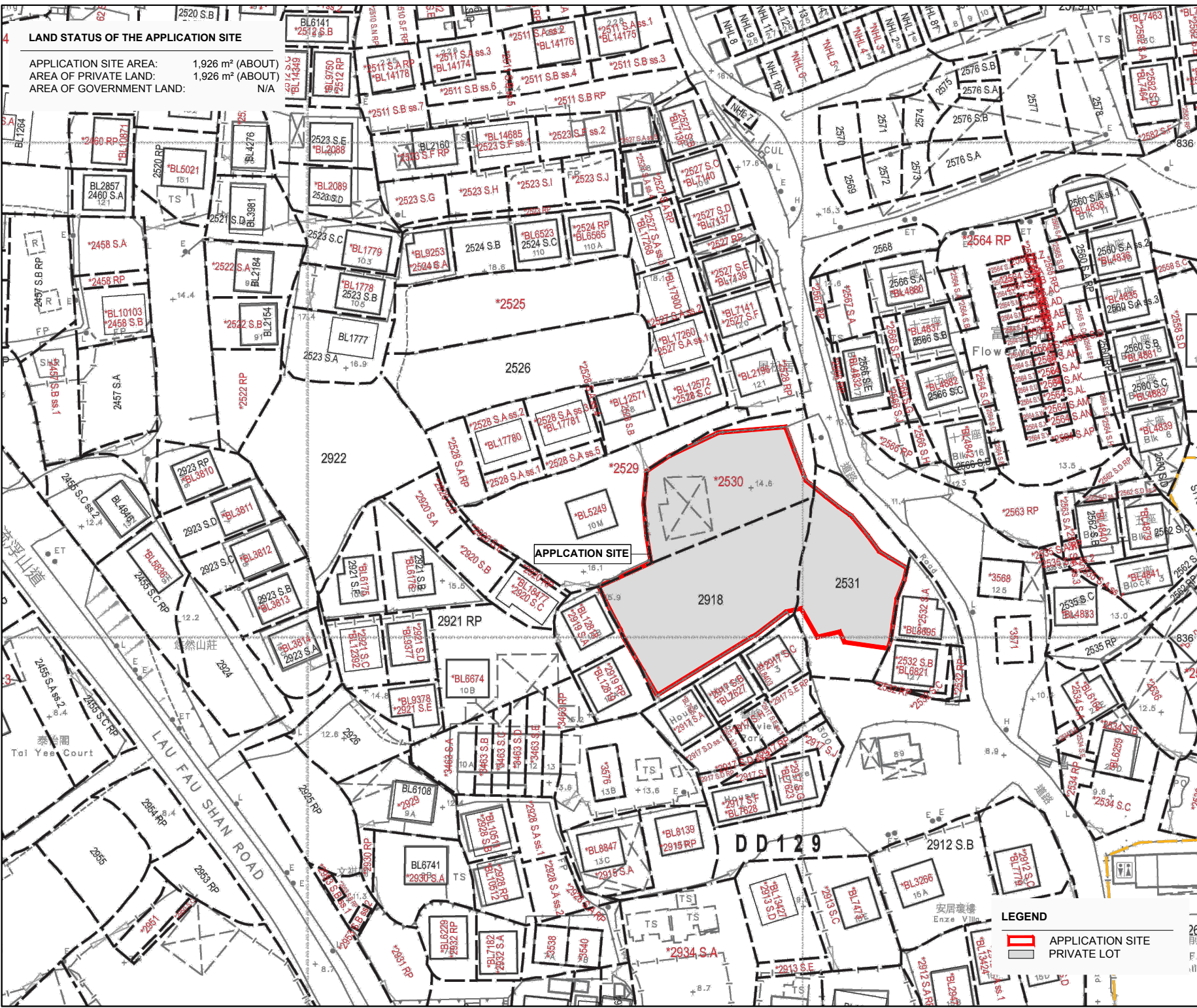

LAND STATUS OF THE APPLICATION SITE

APPLICATION SITE AREA: 1,926 m² (ABOUT)
AREA OF PRIVATE LAND: 1,926 m² (ABOUT)
AREA OF GOVERNMENT LAND: N/A



PROJECT
**PROPOSED TEMPORARY
PUBLIC VEHICLE PARK FOR
PRIVATE CARS FOR A PERIOD
OF 3 YEARS AND ASSOCIATED
FILLING OF LAND**

SITE LOCATION
LOTS 2530 (PART), 2531 (PART)
AND 2918 (PART) IN D.D.129, LAU
FAU SHAN, YUEN LONG, NEW
TERRITORIES

SCALE
1 : 1000 @ A4

DRAWING TITLE
LAND STATUS

DRAWN BY DATE
J.W 20.7.2024

REVISED BY DATE
APPROVED BY DATE

DWG NO. VER.
PLAN 1 A-1

LEGEND
[Red outline] APPLICATION SITE
[Grey fill] PRIVATE LOT

DEVELOPMENT PARAMETERS

APPLICATION SITE AREA: 1,926 m² (ABOUT)
 COVERED AREA: 4 m² (ABOUT)
 UNCOVERED AREA: 1,922 m² (ABOUT)

PLOT RATIO: 0.002(ABOUT)
 SITE COVERAGE: 0.2%(ABOUT)

NO. OF STRUCTURE: 1
 DOMESTIC GFA: NOT APPLICABLE
 NON- DOMESTIC GFA: 4 m² (ABOUT)
 TOTAL GFA: 4 m² (ABOUT)

BUILDING HEIGHT: 3m (ABOUT)
 NO. OF STOREY: 1

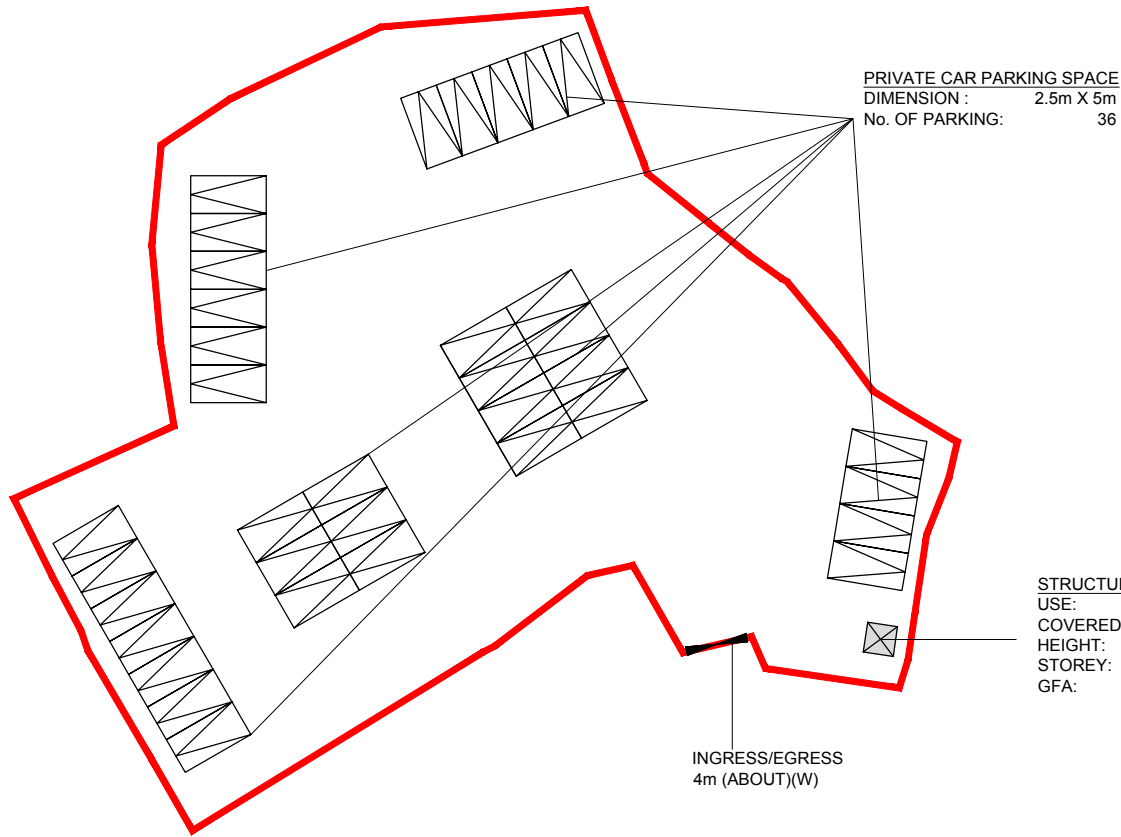

LEGEND

- APPLICATION SITE
- STRUCTURE (ENCLOSED)
- PARKING SPACES (PC)
- INGRESS/EGRESS



PROJECT
**PROPOSED TEMPORARY
 PUBLIC VEHICLE PARK FOR
 PRIVATE CARS FOR A PERIOD
 OF 3 YEARS AND ASSOCIATED
 FILLING OF LAND**

SITE LOCATION
 LOTS 2530 (PART), 2531 (PART)
 AND 2918 (PART) IN D.D.129, LAU
 FAU SHAN, YUEN LONG, NEW
 TERRITORIES

SCALE
1 : 500 @ A4

DRAWING TITLE
LAYOUT PLAN

DRAWN BY J.W	DATE 20.7.2024
------------------------	--------------------------

REVISED BY DATE

APPROVED BY DATE

DWG NO. PLAN 2	VER. A-1
--------------------------	--------------------

LOCATION OF THE APPLICATION SITE

APPLICATION SITE AREA: 1,926 m² (ABOUT)

VEHICULAR ACCESS

ACCESSIBLE FROM MAN TAK ROAD

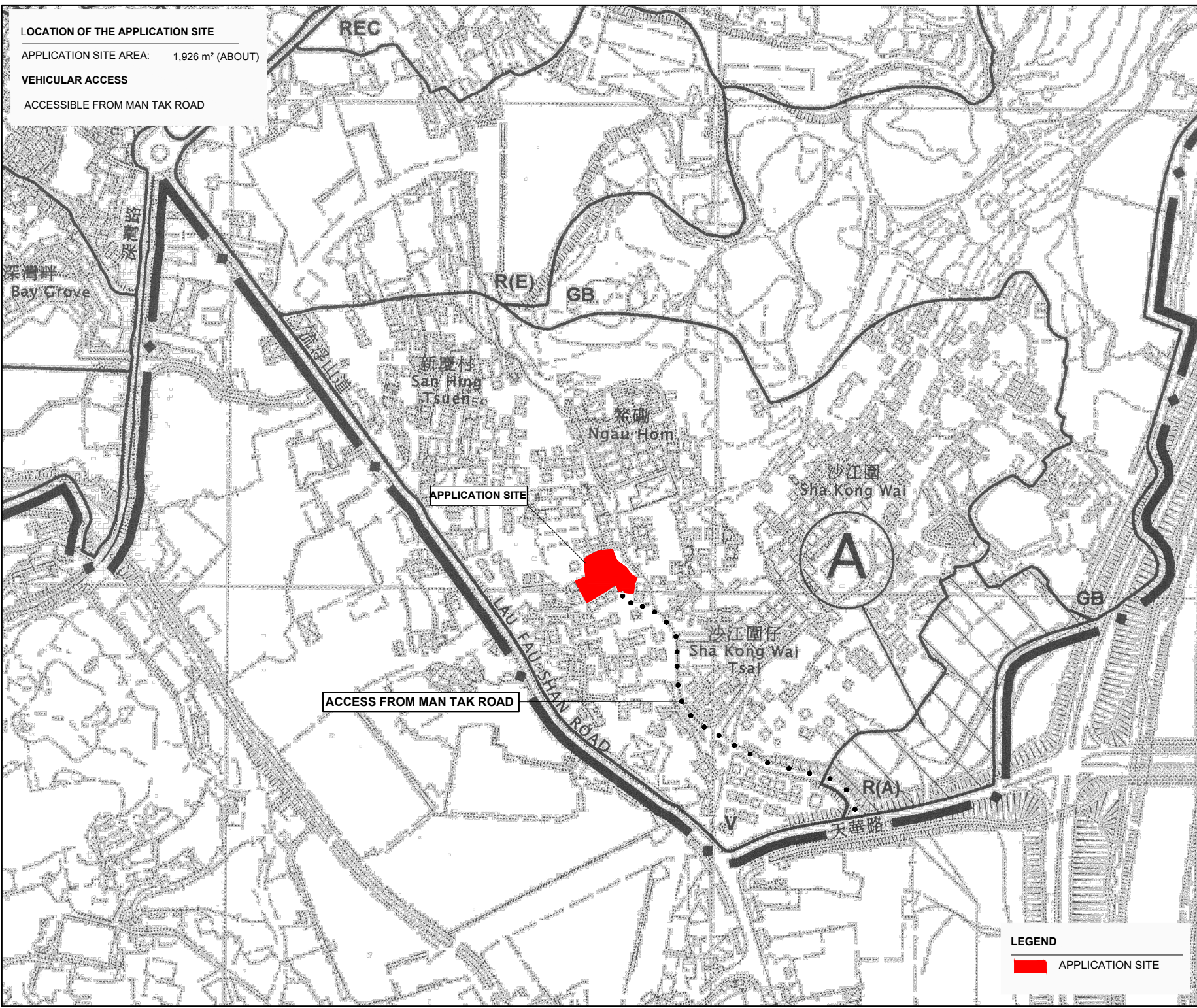

PROJECT
PROPOSED TEMPORARY
PUBLIC VEHICLE PARK FOR
PRIVATE CARS FOR A PERIOD
OF 3 YEARS AND ASSOCIATED
FILLING OF LAND

SITE LOCATION
LOTS 2530 (PART), 2531 (PART)
AND 2918 (PART) IN D.D.129, LAU
FAU SHAN, YUEN LONG, NEW
TERRITORIES

SCALE
1 : 5000 @ A4

DRAWING TITLE
LOCATION AND ACCESS PLAN

DRAWN BY
J.W

DATE
20.7.2024

REVISED BY
DATE

APPROVED BY
DATE

DWG NO.
PLAN 3

VER.
A-1

LEGEND
APPLICATION SITE

PROPOSED SITE LEVEL OF THE APPLICATION SITE

APPLICATION SITE AREA: 1926 m² (ABOUT)
HARD PAVED AREA: 1926 m² (ABOUT)
PROPOSED MEAN SITE LEVELS: +14.6 mPD (ABOUT)
DEPTH OF LAND FILLING: NOT MORE THAN 0.2 m

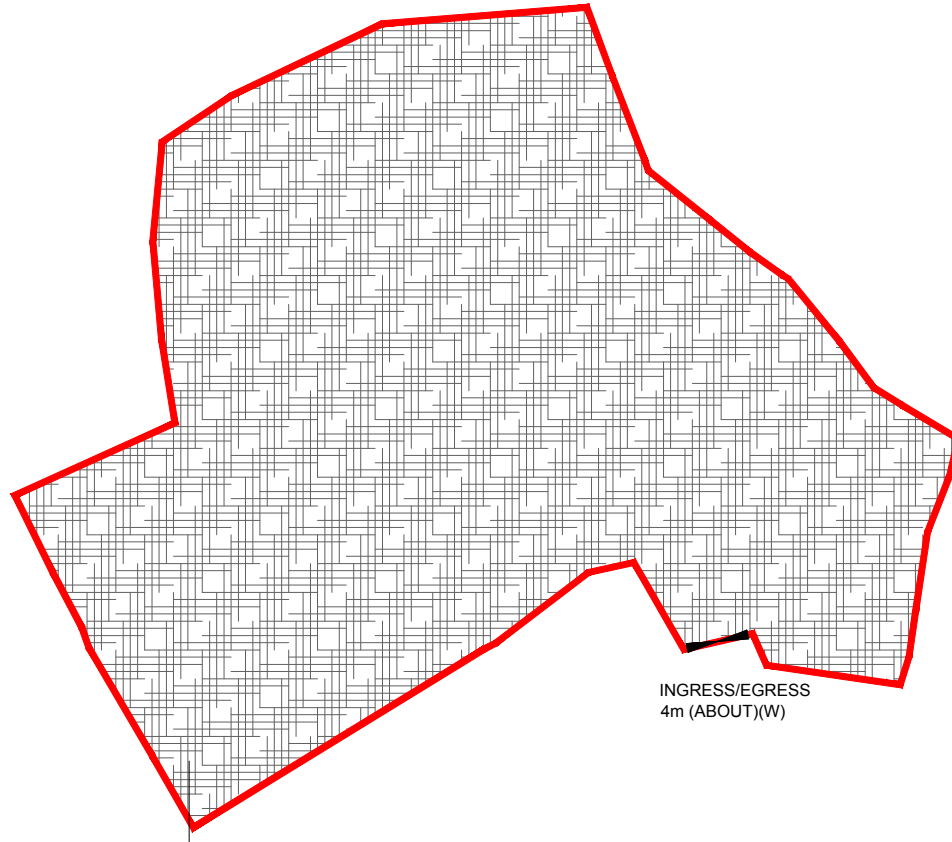



INGRESS/EGRESS
4m (ABOUT)(W)

PROPOSED MEAN SITE LEVELS. +14.6mPD (ABOUT)

-INVOLVE FILLING OF LAND (0.2m)

LEGEND

-  APPLICATION SITE
-  ASPHALT
-  INGRESS/EGRESS



PROJECT

PROPOSED TEMPORARY
PUBLIC VEHICLE PARK FOR
PRIVATE CARS FOR A PERIOD
OF 3 YEARS AND ASSOCIATED
FILLING OF LAND

SITE LOCATION

LOTS 2530 (PART), 2531 (PART)
AND 2918 (PART) IN D.D.129, LAU
FAU SHAN, YUEN LONG, NEW
TERRITORIES

SCALE

1 : 500 @ A4

DRAWING TITLE

PAVED RATIO PLAN

DRAWN BY

J.W

DATE

20.7.2024

REVISED BY

DATE

APPROVED BY

DATE

DWG NO.

PLAN 4

VER.

A-1