

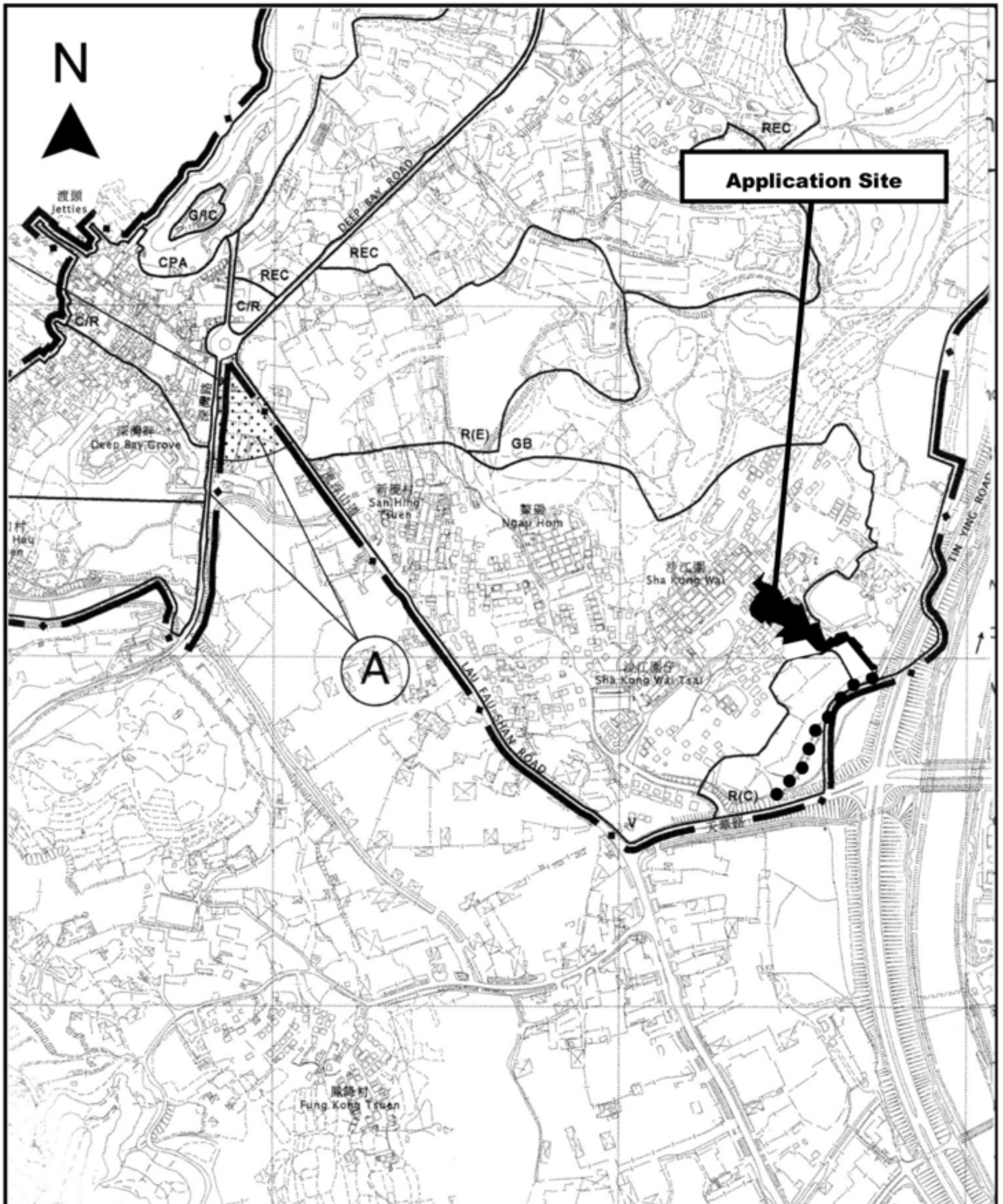

<p>Project 項目名稱: Temporary Public Vehicle Park for Private Cars & Light Goods Vehicles for a Period of 3 Years and Associated Filling of Land at Lots 2804 (Part), 2826, 2827, 2844 & 2845RP (Part) in D.D.129 & Adjoining Government Land, Sha Kong Wai, Yuen Long, N.T.</p>	<p>Drawing Title 圖目: Site Plan</p>	<p>Remarks 備註:</p>
	<p>Drawing No. 圖號: Figure 1</p>	<p>Scale 比例: 1:1000</p>

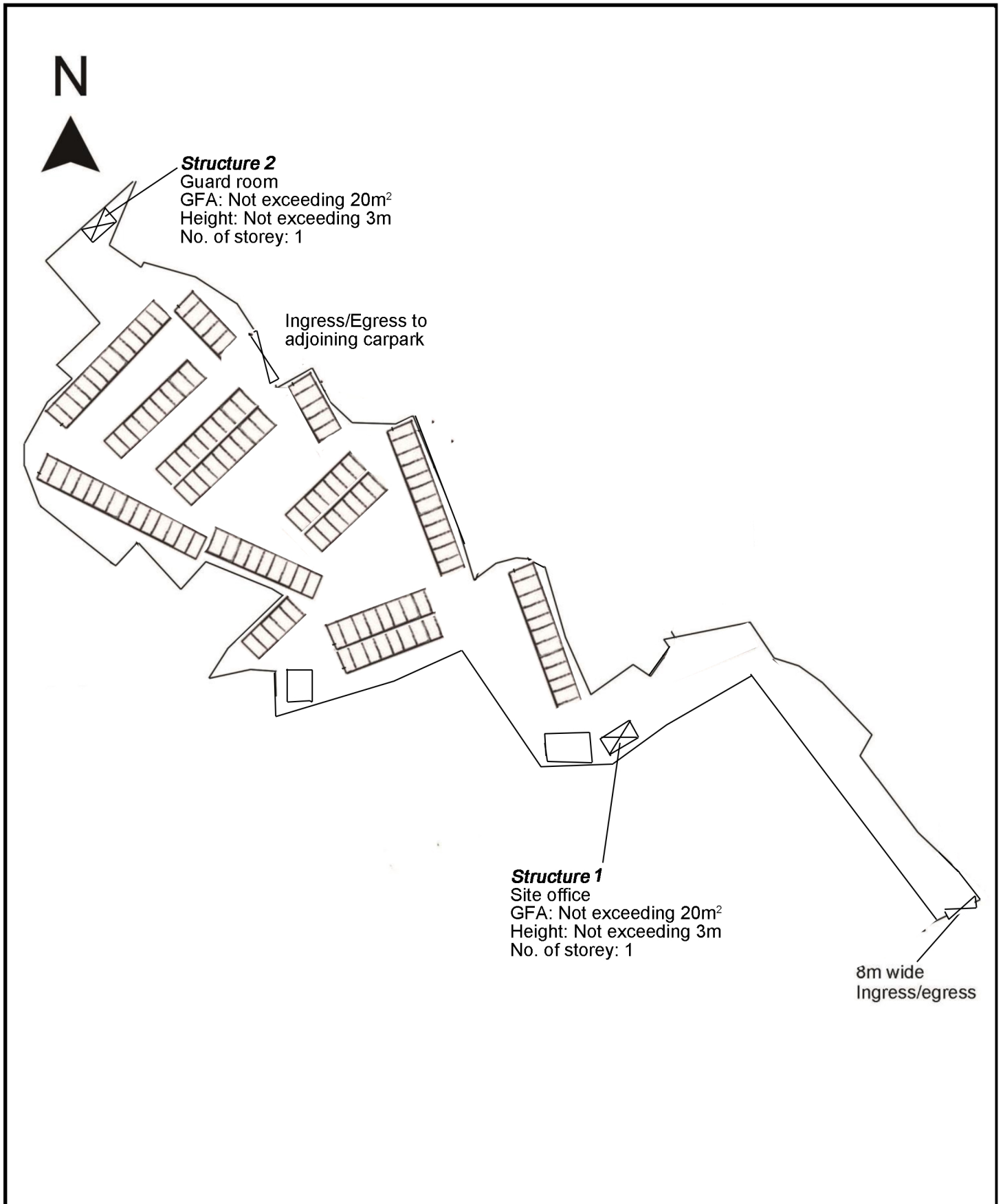

<p>Project 項目名稱: Temporary Public Vehicle Park for Private Cars & Light Goods Vehicles for a Period of 3 Years and Associated Filling of Land at Lots 2804 (Part), 2826, 2827, 2844 & 2845RP (Part) in D.D.129 & Adjoining Government Land, Sha Kung Wai, Yuen Long, N.T.</p>	<p>Drawing Title 圖目: Location Plan</p> <p>Drawing No. 圖號: Figure 2</p>	<p>Remarks 備註: ●●● Vehicular access leading from Tin Wah Road</p> <p>Scale 比例: 1:7500</p>
--	--	---

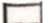

Project 項目名稱: Temporary Public Vehicle Park for Private Cars & Light Goods Vehicles for a Period of 3 Years and Associated Filling of Land at Lots 2804 (Part), 2826, 2827, 2844 & 2845RP (Part) in D.D.129 & Adjoining Government Land, Sha Kong Wai, Yuen Long, N.T.	Drawing Title 圖目: Proposed Layout Plan	Remarks 備註:  130 parking spaces of 5m x 2.5m for private car  2 parking spaces of 7m x 3.5m for light goods vehicle
	Drawing No. 圖號: Figure 3	Scale 比例: 1:1000

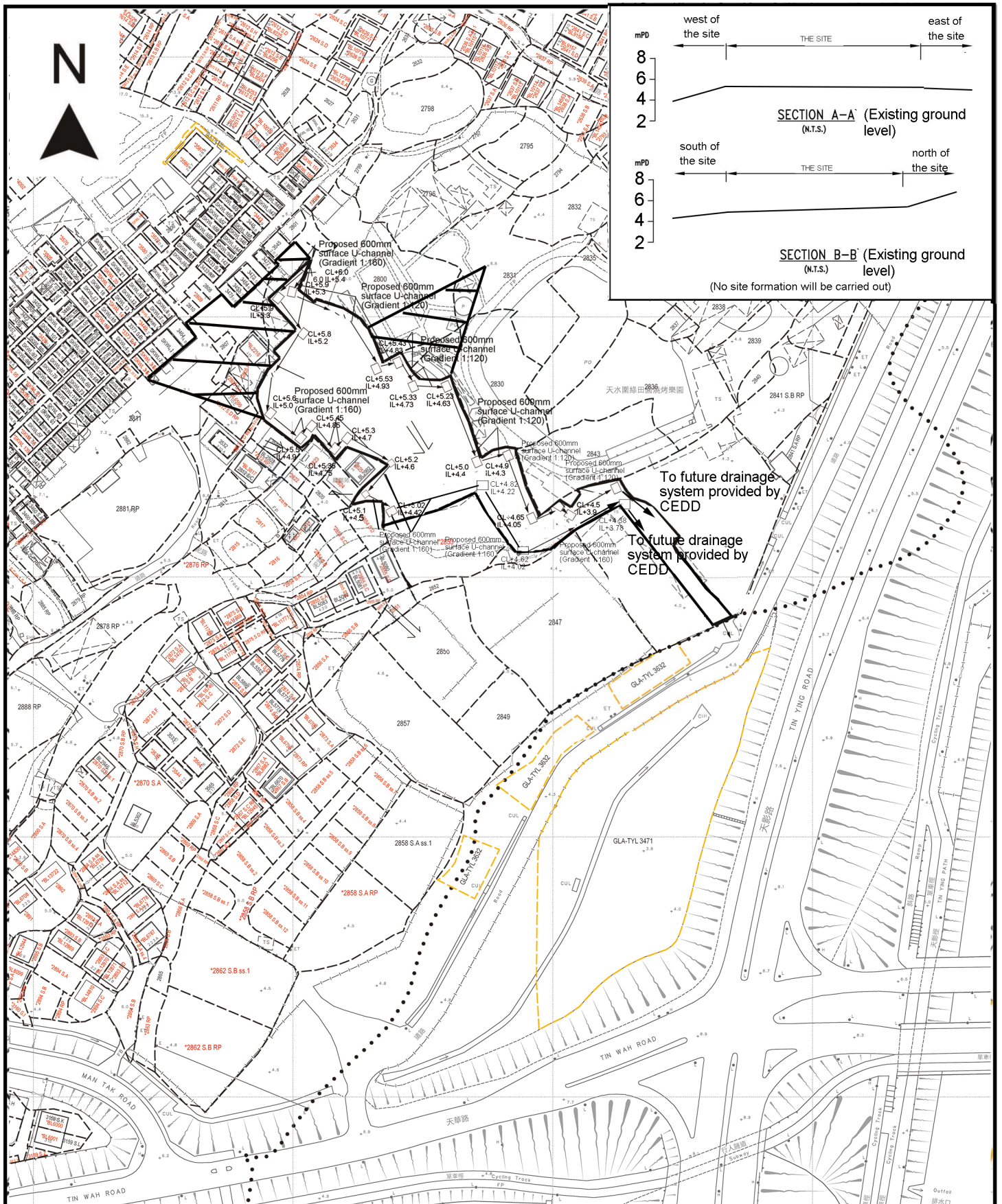

Project 項目名稱:
Temporary Public Vehicle Park for Private Cars & Light Goods Vehicles for a Period of 3 Years and Associated Filling of Land at Lots 2804 (Part), 2826, 2827, 2844 & 2845RP (Part) in D.D.129 & Adjoining Government Land, Sha Kong Wai, Yuen Long, N.T.

Drawing Title 圖目:
Proposed Drainage Plan

Drawing No. 圖號:
Figure 4

Remarks 備註:
 Proposed catchpit
 Proposed catchpit with sand trap
 Flow of surface runoff
 +6.0Level (in mPD)

Scale 比例:
1:2000

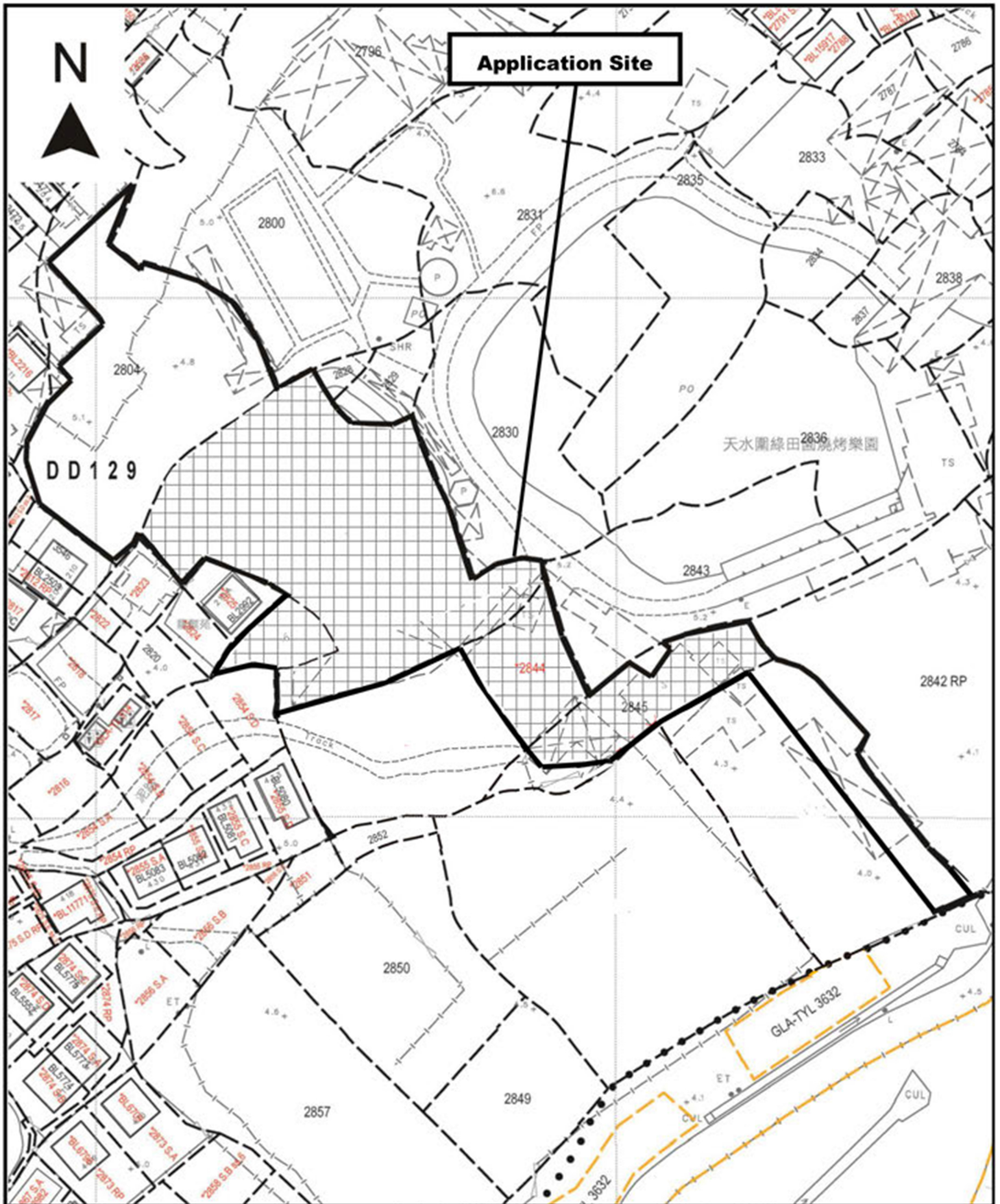

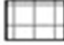
<p>Project 項目名稱: Temporary Public Vehicle Park for Private Cars & Light Goods Vehicles for a Period of 3 Years and Associated Filling of Land at Lots 2804 (Part), 2826, 2827, 2844 & 2845RP (Part) in D.D.129 & Adjoining Government Land, Sha Kong Wai, Yuen Long, N.T.</p>	<p>Drawing Title 圖目: Land Filling Area Plan</p> <p>Drawing No. 圖號: Figure 5</p>	<p>Remarks 備註:  Land filling area (About 3,800m²)</p> <p>Scale 比例: 1:1000</p>
--	---	--