

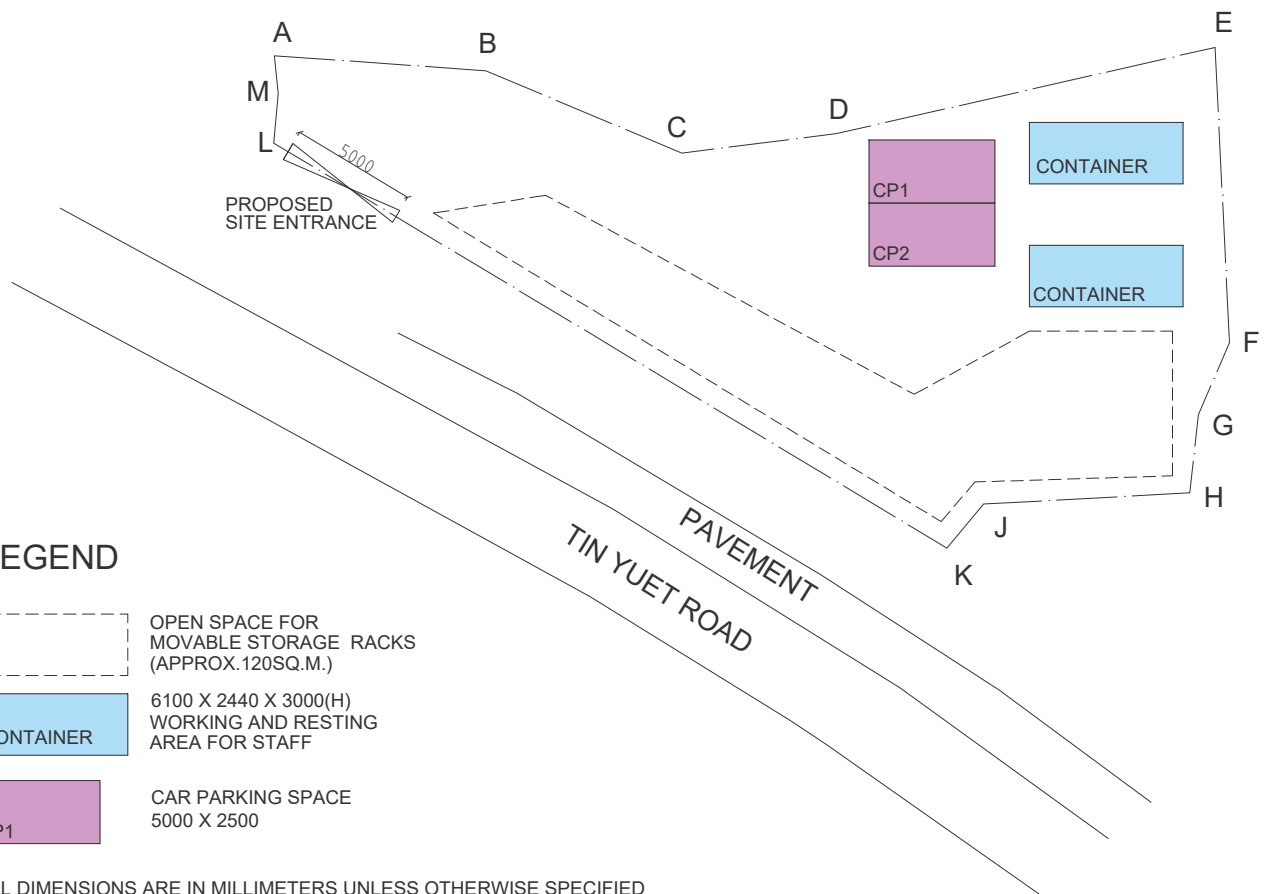

### LOT DIMENSIONS

Boundary Point	Bearing ° ' "	Distance in metres
Lot No. 911 S.B RP in D.D. 129 (SITE I - 443.9 sq.m about)		
A		
B	94 18 22	8.391
C	112 13 04	8.584
D	83 39 06	6.195
E	76 56 38	15.568
F	176 37 50	11.881
G	204 36 50	3.241
H	186 40 20	3.108
J	266 46 22	8.168
K	223 04 43	2.404
L	301 13 57	31.421
M	05 30 00	2.012
A	354 10 20	1.498

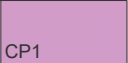

### LEGEND

-  OPEN SPACE FOR MOVABLE STORAGE RACKS (APPROX. 120SQ.M.)
-  CONTAINER  
6100 X 2440 X 3000(H)  
WORKING AND RESTING AREA FOR STAFF
-  CP1  
CAR PARKING SPACE  
5000 X 2500

ALL DIMENSIONS ARE IN MILLIMETERS UNLESS OTHERWISE SPECIFIED

# PROPOSED TEMPORARY STORAGE AREA AT LOT 911 S.B RP (SITE I)

SCALE 1:300 @ A4

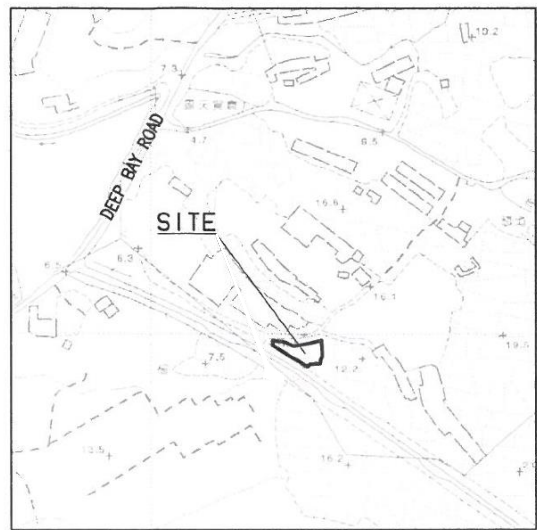
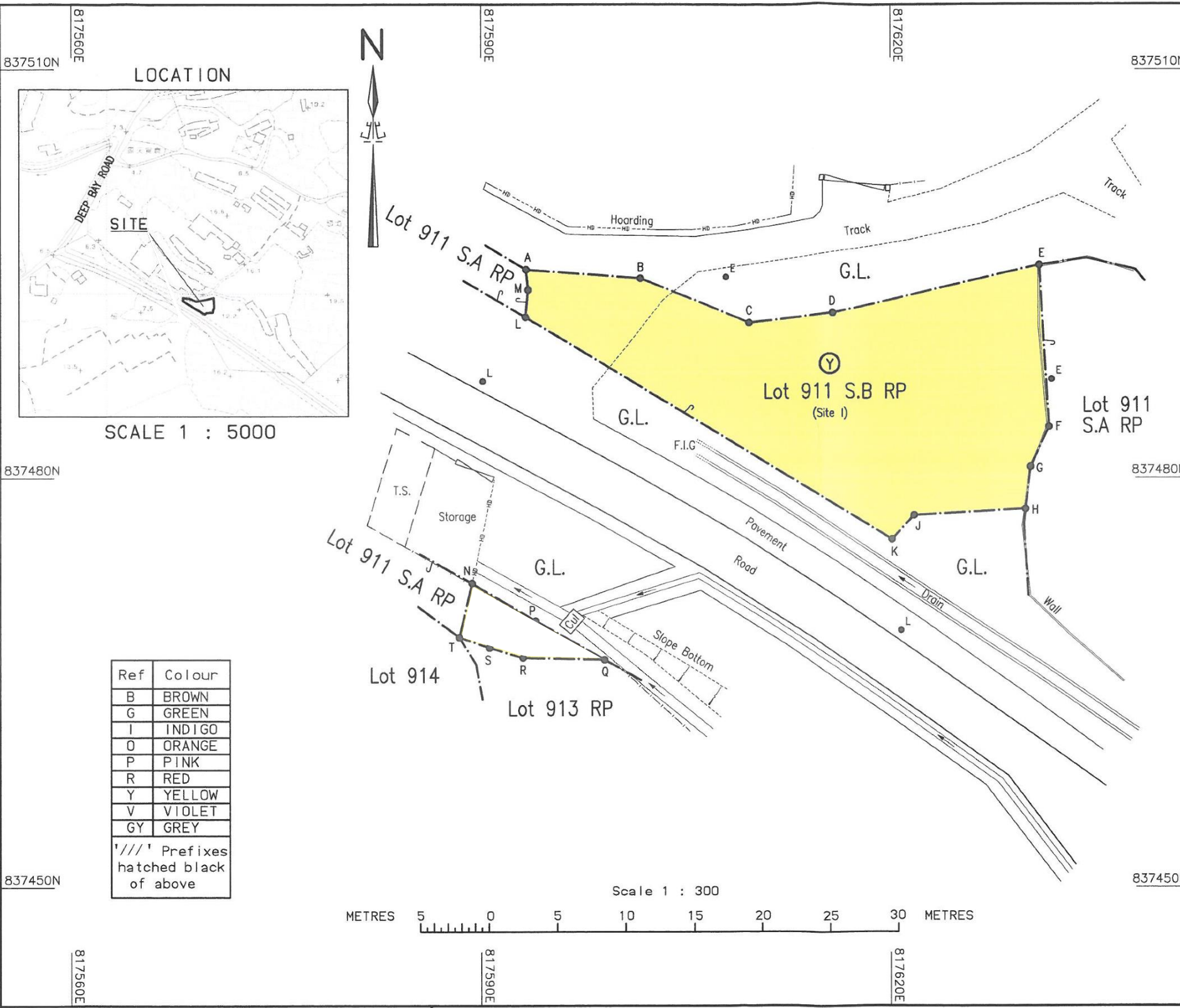

SCALE 1 : 5000



Ref	Colour
B	BROWN
G	GREEN
I	INDIGO
O	ORANGE
P	PINK
R	RED
Y	YELLOW
V	VIOLET
GY	GREY

'///' Prefixes hatched black of above

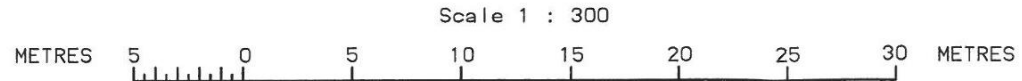

**LOT DIMENSIONS**

Boundary Point	Bearing ° ' "	Distance in metres
Lot No. 911 S.B RP in D.D. 129 (SITE I - 443.9 sq.m about)		
A		
B	94 18 22	8.391
C	112 13 04	8.584
D	83 39 06	6.195
E	76 56 38	15.568
F	176 37 50	11.881
G	204 36 50	3.241
H	186 40 20	3.108
J	266 46 22	8.168
K	223 04 43	2.404
L	301 13 57	31.421
M	05 30 00	2.012
A	354 10 20	1.498

- Legends:
- E - Electric Pole
  - L - Lamp Post
  - Cul - Culvert
  - F.I.G. - Feed Into Ground
  - G.L. - Government Land
  - T.S. - Temporary Structure
  - A - Lot Boundary Pt.(A)
  - — — - Boundary Line
  - - - X - - - - Fence & Gate

Lot No.	Surveyed Area (About)	Registered Area
911 S.B RP (Coloured Yellow)	469.7m <sup>2</sup>	0.20ac. - 478.5m <sup>2</sup>

Dated this ....24th..... day of .....August....., 2012.

*Pang Chi-wing*  
Pang Chi-wing, MRICS MHKIS  
Authorized Land Surveyor

Survey District : YUEN LONG  
Date of survey : August 2012  
Survey Sheet No. : 2-SW-17D  
Survey Record Plan No.: SRP/YL/049/1427/D1

**DIMENSIONED PLAN**  
**LOT No. 911 S.B RP IN D.D. 129**

**FOR OFFICIAL USE**  
Land Boundary Plan No. : LBP/YL/049/1427/D1