

# Figures

---

- Figure 1 Location Plan
- Figure 2 Lot Index Plan
- Figure 3 Vehicular Access to the Site
- Figure 4 Indicative Layout Plan

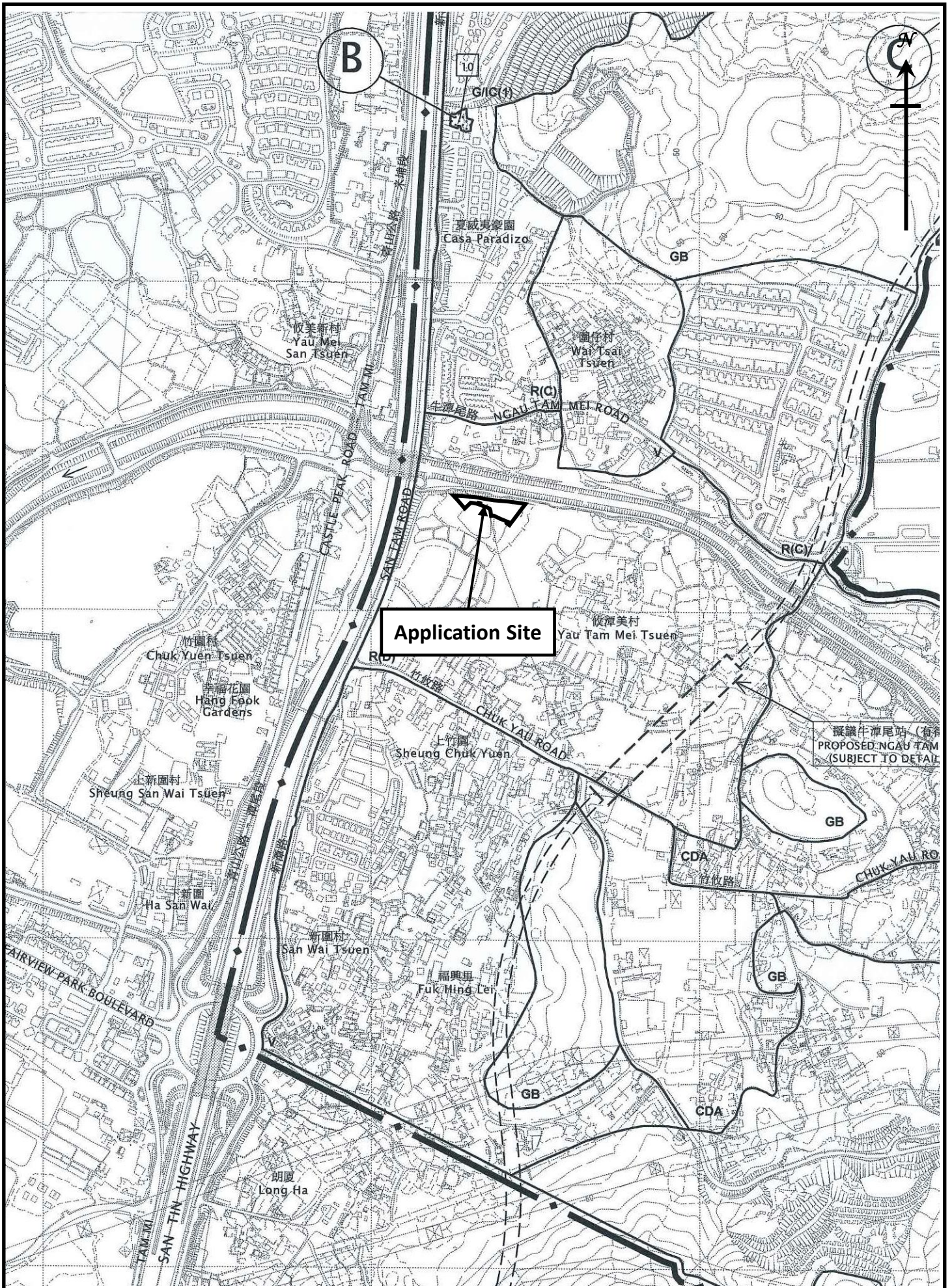

**Application Site**

擬議牛潭尾站 (有待  
PROPOSED NGAU TAM  
(SUBJECT TO DETAIL)

Location Plan  
(Extract from Draft Ngau Tam Mei Outline Zoning Plan  
No. S/YL-NTM/13)

Figure 1

1 : 7500



羅迅測計師行  
**Lawson David & Sung**  
SURVEYORS LIMITED  
Property Consultants • Planning • Valuers • Auctioneers  
Estate Agency Licence No. C-006328



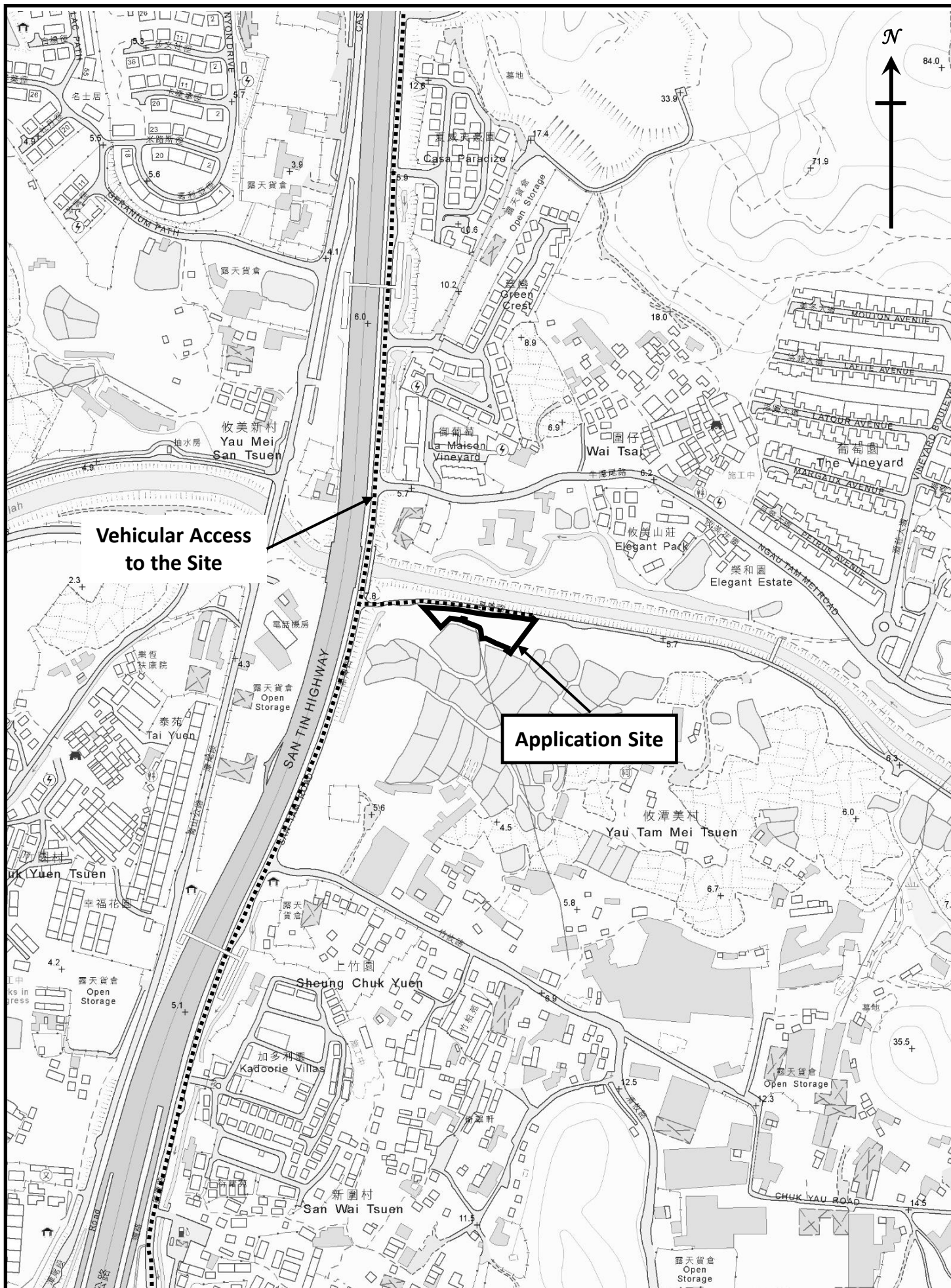

Vehicular Access to the Application Site

Figure 3

1 : 5000



羅迅測計師行  
Lawson David & Sung

SURVEYORS LIMITED  
Property Consultants • Planning • Valuers • Auctioneers  
Estate Agency Licence No. C-006528

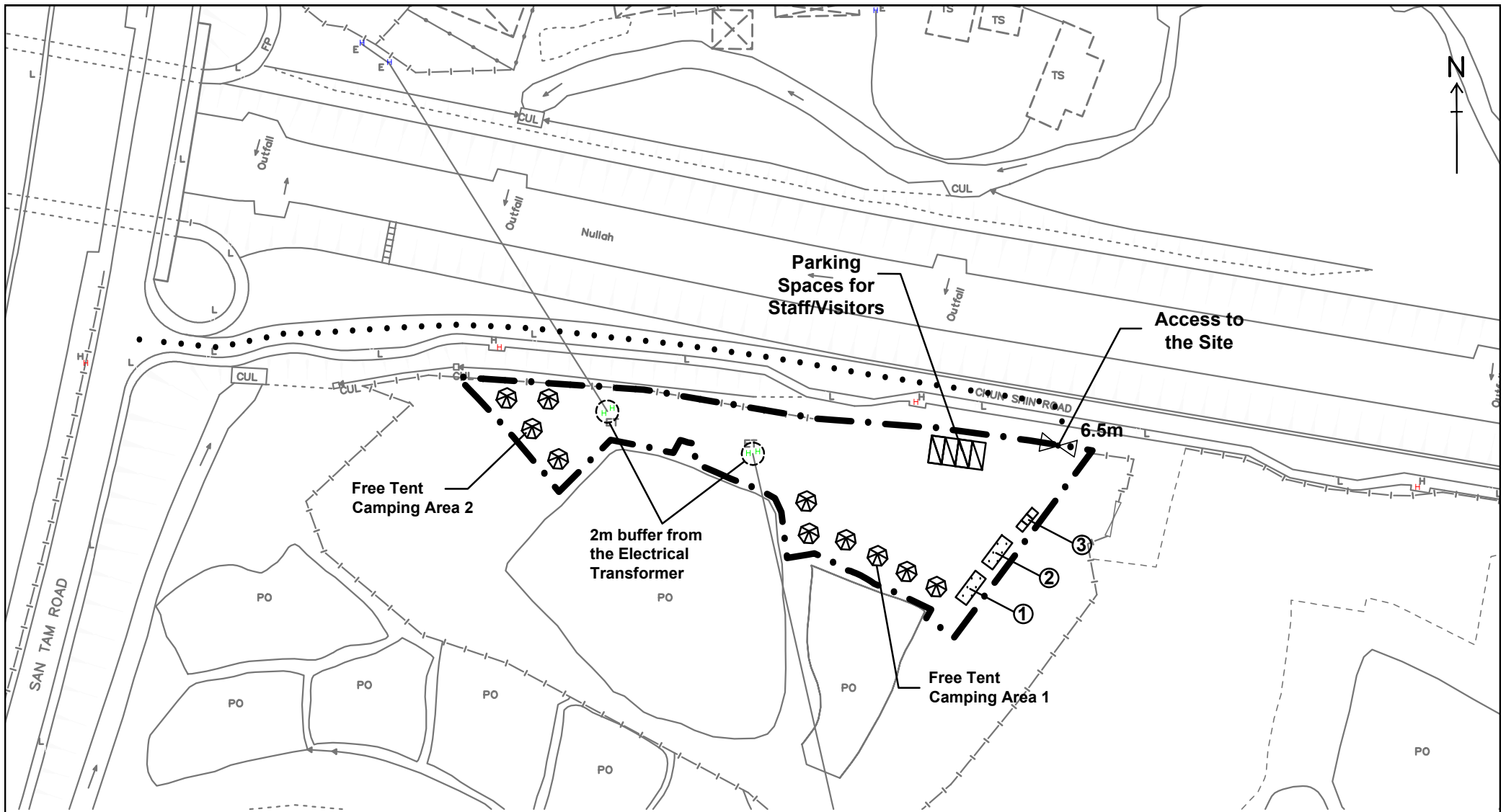

**Legend:**

- Application Site (Area: about 2,109 sq.m.)
- Temporary Structures
- Parking Spaces for Staff/Visitors (Private Vehicles) (2.5m x 5m) (4 nos.)

Structure No.	Use	Area (m <sup>2</sup> )	Height (m)
1	Storeroom	15	2.5 (1-storey)
2	Site Office	15	2.5 (1-storey)
3	Portable Toilet (3 nos.)	7	2.5 (1-storey)

Indicative Layout Plan

Figure 4

Scale 1:1000



羅迅測計師行  
**Lawson David & Sung**  
 SURVEYORS LIMITED  
 Property Consultants • Planning • Valuers • Auctioneers  
 Estate Agency Licence No. C-906328

## Site Photos

---

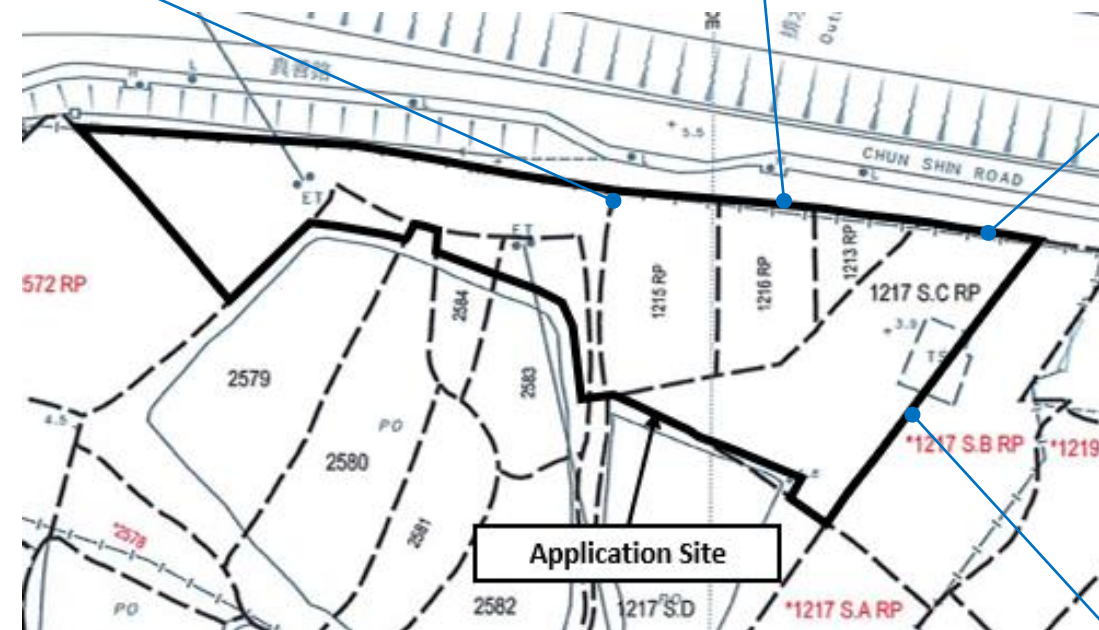

Existing Condition of the Application Site

Site Photos



羅迅測計師行  
**Lawson David & Sung**  
 SURVEYORS LIMITED  
 Property Consultants • Planning • Valuers • Auctioneers  
 Estate Agency Licence No. C-066328