

LOCATION OF THE APPLICATION SITE

APPLICATION SITE AREA : 6,593 m² (ABOUT)

VEHICULAR ACCESS
ACCESSIBLE FROM KAM TIN ROAD VIA A LOCAL ACCESS

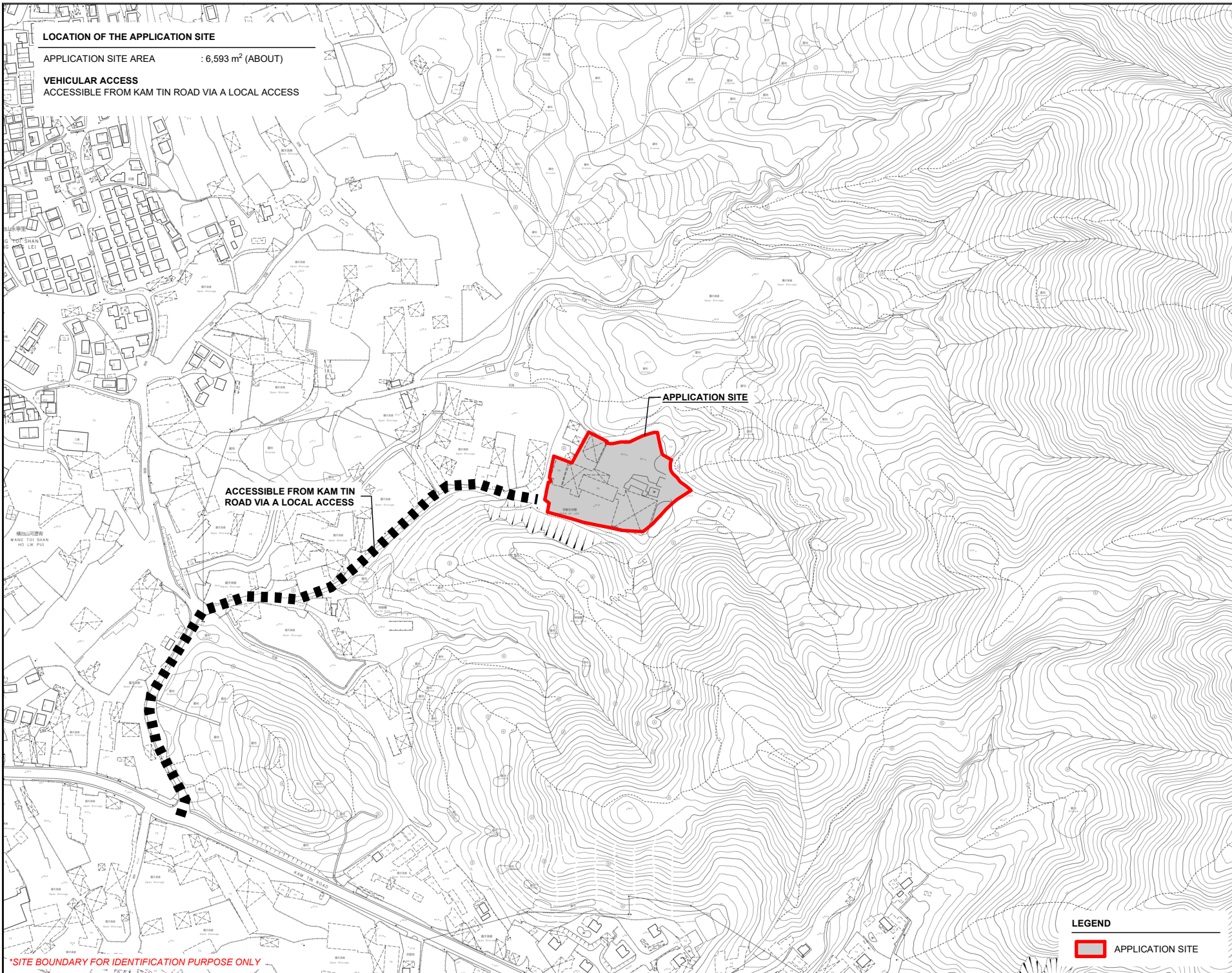
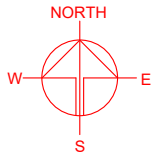

APPLICATION SITE

ACCESSIBLE FROM KAM TIN ROAD VIA A LOCAL ACCESS

橫山山仔頂
HANG TO SHAN
HO LK PUI

*SITE BOUNDARY FOR IDENTIFICATION PURPOSE ONLY

LEGEND
 APPLICATION SITE

PLANNING CONSULTANT



PROJECT
PROPOSED TEMPORARY PLACE OF RECREATION, SPORTS OR CULTURE AND BARBECUE SITE WITH ANCILLARY FACILITIES FOR A PERIOD OF 3YEARS AND ASSOCIATED FILLING OF LAND

SITE LOCATION
VARIOUS LOTS IN D.D. 111 AND ADJOINING GOVERNMENT LAND, PAT HEUNG, YUEN LONG, NEW TERRITORIES

SCALE 1 : 4000 @ A4	
DRAWN BY MN	DATE 24.9.2024
REVISED BY	DATE
APPROVED BY	DATE
DWG. TITLE LOCATION PLAN	
DWG NO. PLAN 1	VER. 001

ZONING OF THE APPLICATION SITE

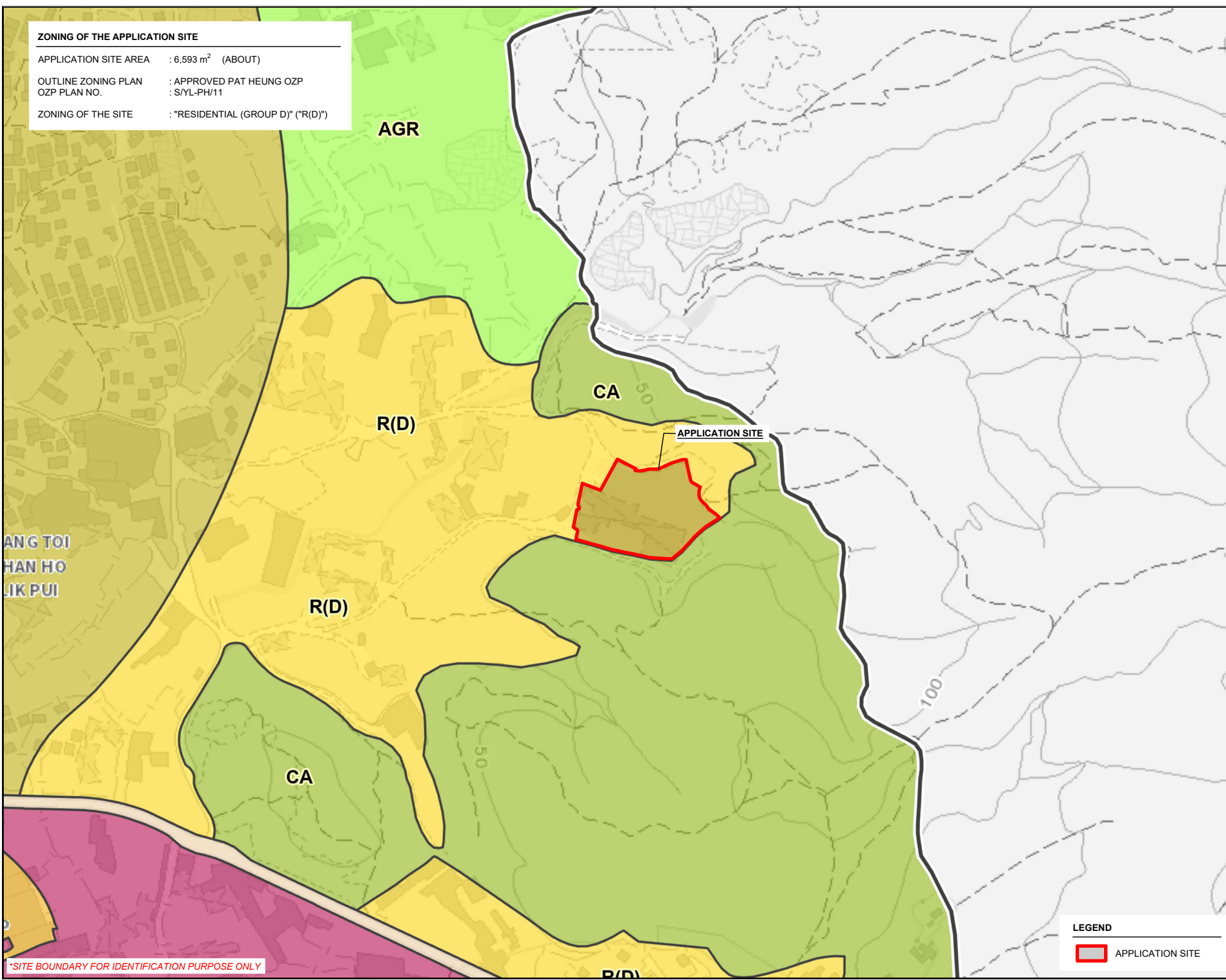
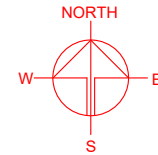
APPLICATION SITE AREA : 6,593 m² (ABOUT)
 OUTLINE ZONING PLAN : APPROVED PAT HEUNG OZP
 OZP PLAN NO. : S/YL-PH/11
 ZONING OF THE SITE : "RESIDENTIAL (GROUP D)" ("R(D)")



*SITE BOUNDARY FOR IDENTIFICATION PURPOSE ONLY

LEGEND

APPLICATION SITE

PLANNING CONSULTANT

PROJECT

PROPOSED TEMPORARY PLACE OF RECREATION, SPORTS OR CULTURE AND BARBECUE SITE WITH ANCILLARY FACILITIES FOR A PERIOD OF 3 YEARS AND ASSOCIATED FILLING OF LAND

SITE LOCATION

VARIOUS LOTS IN D.D. 111 AND ADJOINING GOVERNMENT LAND, PAT HEUNG, YUEN LONG, NEW TERRITORIES

SCALE

1 : 4000 @ A4

DRAWN BY	DATE
MN	24.9.2024
REVISED BY	DATE
APPROVED BY	DATE

DWG. TITLE	
ZONING OF THE SITE	
DWG. NO.	VER.
PLAN 2	001

LAND STATUS OF THE APPLICATION SITE

APPLICATION SITE AREA : 6,593 m² (ABOUT)
 AREA OF PRIVATE LAND : 4,760 m² (ABOUT)
 AREA OF GOVERNMENT LAND : 1,833 m² (ABOUT)

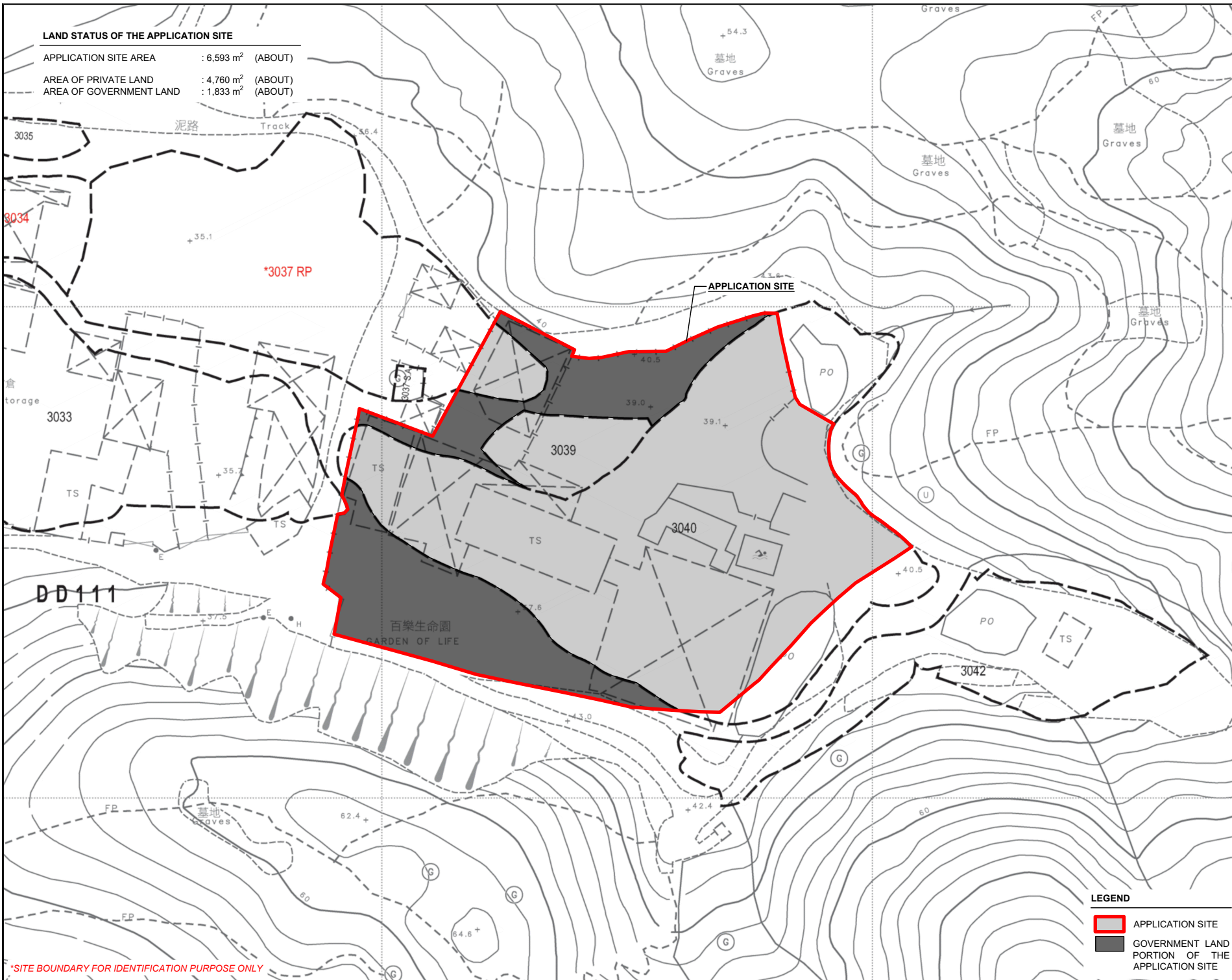
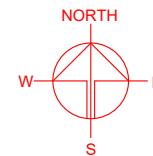

*SITE BOUNDARY FOR IDENTIFICATION PURPOSE ONLY

LEGEND

	APPLICATION SITE
	GOVERNMENT LAND PORTION OF THE APPLICATION SITE

PLANNING CONSULTANT

PROJECT
 PROPOSED TEMPORARY PLACE OF RECREATION, SPORTS OR CULTURE AND BARBECUE SITE WITH ANCILLARY FACILITIES FOR A PERIOD OF 3YEARS AND ASSOCIATED FILLING OF LAND

SITE LOCATION
 VARIOUS LOTS IN D.D. 111 AND ADJOINING GOVERNMENT LAND, PAT HEUNG, YUEN LONG, NEW TERRITORIES

SCALE 1: 1000 @ A4	
DRAWN BY MN	DATE 24.9.2024
REVISED BY	DATE
APPROVED BY	DATE
DWG. TITLE LAND STATUS OF THE SITE	
DWG NO. PLAN 3	VER. 001

DEVELOPMENT PARAMETERS

APPLICATION SITE AREA	: 6,593 m ²	(ABOUT)
COVERED AREA	: 1,932 m ²	(ABOUT)
UNCOVERED AREA	: 4,661 m ²	(ABOUT)
PLOT RATIO	: 0.3	(ABOUT)
SITE COVERAGE	: 29 %	(ABOUT)
NO. OF STRUCTURE	: 14	
DOMESTIC GFA	: NOT APPLICABLE	
NON-DOMESTIC GFA	: 2,183 m ²	(ABOUT)
TOTAL GFA	: 2,183 m ²	(ABOUT)
BUILDING HEIGHT	: 2.7 m - 6.5 m	(ABOUT)
NO. OF STOREY	: 1 - 2	

PLEASE REFER TO PLAN 5 FOR DETAILS OF STRUCTURES.

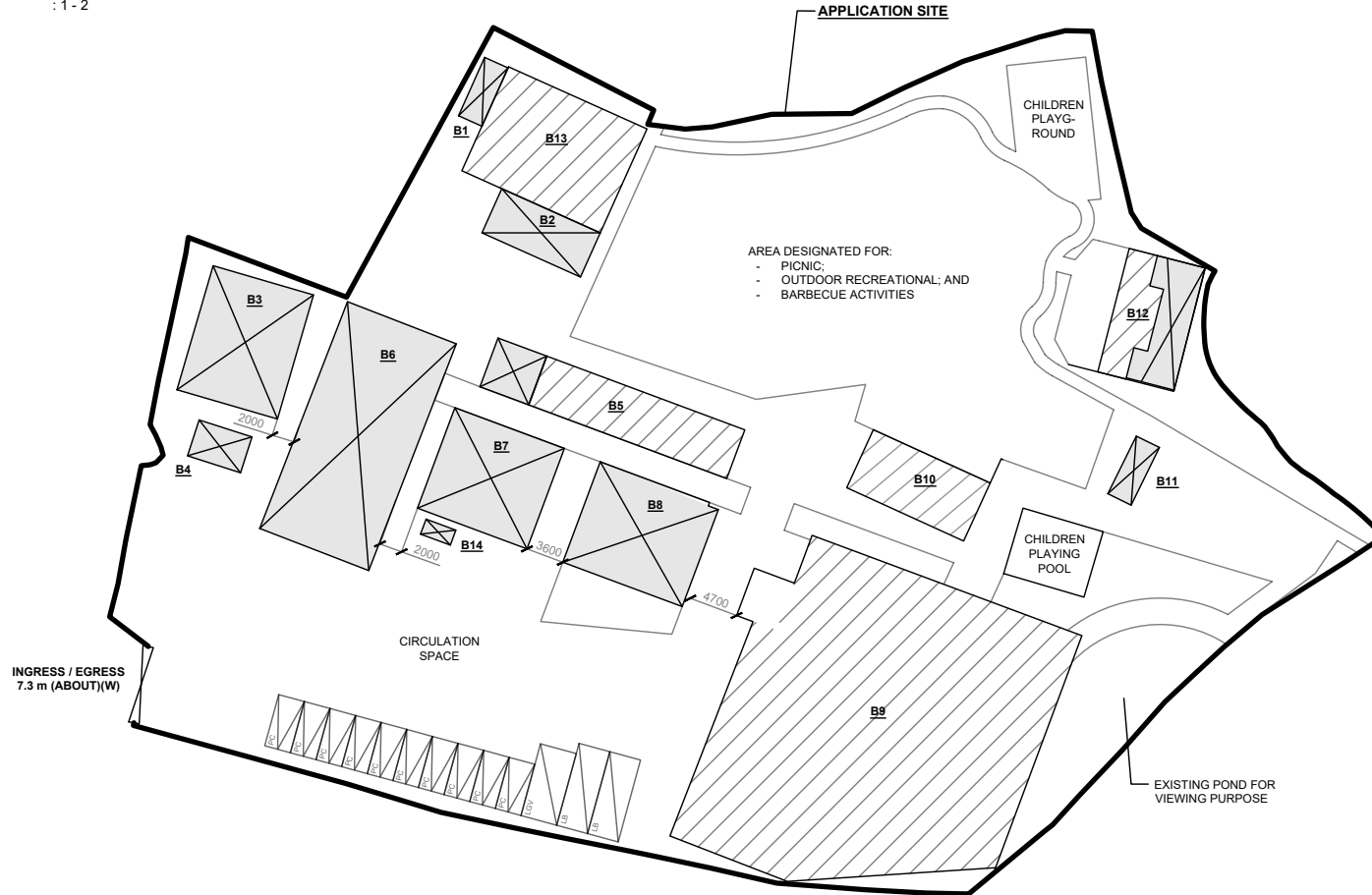
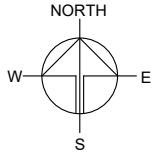

PARKING AND LOADING / UNLOADING PROVISIONS

NO. OF PRIVATE CAR PARKING SPACE	: 10
DIMENSION OF PARKING SPACE	: 5 m (L) x 2.5 m (W)
NO. OF L/UL SPACE FOR LIGHT GOODS VEHICLE	: 1
DIMENSION OF L/UL SPACE	: 7 m (L) x 3.5 m (W)
NO. OF L/UL SPACE FOR LIGHT BUS	: 2
DIMENSION OF L/UL SPACE	: 8 m (L) x 3 m (W)

LEGEND

- APPLICATION SITE
- STRUCTURE (ENCLOSED)
- STRUCTURE (SHED STRUCTURE)
- PARKING SPACE (PC)
- LOADING / UNLOADING SPACE (LGV)
- LOADING / UNLOADING SPACE (LB)
- INGRESS / EGRESS

PLANNING CONSULTANT



PROJECT

PROPOSED TEMPORARY PLACE OF RECREATION, SPORTS OR CULTURE AND BARBECUE SITE WITH ANCILLARY FACILITIES FOR A PERIOD OF 3YEARS AND ASSOCIATED FILLING OF LAND

SITE LOCATION

VARIOUS LOTS IN D.D. 111 AND ADJOINING GOVERNMENT LAND, PAT HEUNG, YUEN LONG, NEW TERRITORIES

SCALE

1 : 700 @ A4

DRAWN BY	DATE
MN	2.10.2024

REVISED BY	DATE

APPROVED BY	DATE

DWG. TITLE
LAYOUT PLAN

DWG. NO.	VER.
PLAN 4	001

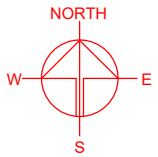

STRUCTURE	USE	COVERED AREA	GROSS FLOOR AREA	BUILDING HEIGHT
B1	AGRICULTURAL TOOLS EXHIBITION CENTRE	15 m ² (ABOUT)	30 m ² (ABOUT)	5.2 m (ABOUT)(2-STOREY)
B2	PET GARDEN	46 m ² (ABOUT)	46 m ² (ABOUT)	3.6 m (ABOUT)(1-STOREY)
B3	FARMING LECTURE ROOM	120 m ² (ABOUT)	230 m ² (ABOUT) ^{#1}	5.6 m (ABOUT)(2-STOREY)
B4	REFRESHMENT KIOSK	18 m ² (ABOUT)	18 m ² (ABOUT)	2.7 m (ABOUT)(1-STOREY)
B5**	PET GARDEN	122 m ² (ABOUT)	122 m ² (ABOUT)	3.5 m (ABOUT)(1-STOREY)
B6	CHILDREN LEARNING CENTRE	214 m ² (ABOUT)	229 m ² (ABOUT) ^{#2}	5.3 m (ABOUT)(2-STOREY)
B7	CHILDREN LEARNING CENTRE	111 m ² (ABOUT)	111 m ² (ABOUT)	3.5 m (ABOUT)(1-STOREY)
B8	MULTI-FUNCTION ROOM FOR CHILDREN ACTIVITIES	119 m ² (ABOUT)	230 m ² (ABOUT) ^{#3}	6.5 m (ABOUT)(2-STOREY)
B9*	RAIN SHELTER FOR ACTIVITY PLAZA	832 m ² (ABOUT)	832 m ² (ABOUT)	5.2 m (ABOUT)(1-STOREY)
B10*	OBSERVATORY VIEWING DECK	73 m ² (ABOUT)	73 m ² (ABOUT)	2.8 m (ABOUT)(1-STOREY)
B11	STORAGE OF MISCELLANEOUS GOODS	15 m ² (ABOUT)	15 m ² (ABOUT)	3.5 m (ABOUT)(1-STOREY)
B12**	AGRICULTURAL DEMONSTRATION CENTRE	89 m ² (ABOUT)	89 m ² (ABOUT)	3.8 m (ABOUT)(1-STOREY)
B13*	RAIN SHELTER FOR CHILDREN ACTIVITY	153 m ² (ABOUT)	153 m ² (ABOUT)	5.2 m (ABOUT)(1-STOREY)
B14	WASHROOM	5 m ² (ABOUT)	5m ² (ABOUT)	3 m (ABOUT)(1-STOREY)
TOTAL		1,932 m² (ABOUT)	2,183 m² (ABOUT)	

*STRUCTURES B9, B10 AND B13 ARE SHED STRUCTURES

** STRUCTURES B5 AND B12 ARE COMBINED WITH ENCLOSED STRUCTURE AND SHED STRUCTURES

#1 - STRUCTURE B3 GFA CALCULATION:
 $120 \text{ m}^2 \text{ (G/F)} + 110 \text{ m}^2 \text{ (1/F)} = 230 \text{ m}^2 \text{ (ABOUT)}$

#2 - STRUCTURE B6 GFA CALCULATION:
 $214 \text{ m}^2 \text{ (G/F)} + 15 \text{ m}^2 \text{ (1/F)} = 229 \text{ m}^2 \text{ (ABOUT)}$

#3 - STRUCTURE B8 GFA CALCULATION:
 $119 \text{ m}^2 \text{ (G/F)} + 111 \text{ m}^2 \text{ (1/F)} = 230 \text{ m}^2 \text{ (ABOUT)}$

PLANNING CONSULTANT



PROJECT

PROPOSED TEMPORARY PLACE OF RECREATION, SPORTS OR CULTURE AND BARBECUE SITE WITH ANCILLARY FACILITIES FOR A PERIOD OF 3YEARS AND ASSOCIATED FILLING OF LAND

SITE LOCATION

VARIOUS LOTS IN D.D. 111 AND ADJOINING GOVERNMENT LAND, PAT HEUNG, YUEN LONG, NEW TERRITORIES

SCALE

-

DRAWN BY	DATE
MN	2.10.2024

REVISED BY	DATE

APPROVED BY	DATE

DWG. TITLE
 DETAILS OF STRUCTURES

DWG. NO.	VER.
PLAN 5	001

FILLING OF LAND AREA OF THE APPLICATION SITE

APPLICATION SITE AREA	: 6,593 m ²	(ABOUT)
EXISTING FILLED AREA	: 4,773 m ²	(ABOUT)
MATERIAL OF FILLING	: CONCRETE	
PURPOSE OF FILLING	: SITE FORMATION OF STRUCTURE CIRCULATION SPACE, FOOT PATH VEHICLE MANOEUVERING SPACE	
DEPTH OF FILLING	: NOT MORE THAN 0.2 m	



THE SITE HAS ALREADY BEEN FILLED. NO FURTHER FILLING OF LAND WILL BE CARRIED OUT AT THE SITE AFTER PLANNING APPROVAL HAS BEEN GRANTED FROM THE TOWN PLANNING BOARD.

REMAINING AREA OF THE APPLICATION SITE

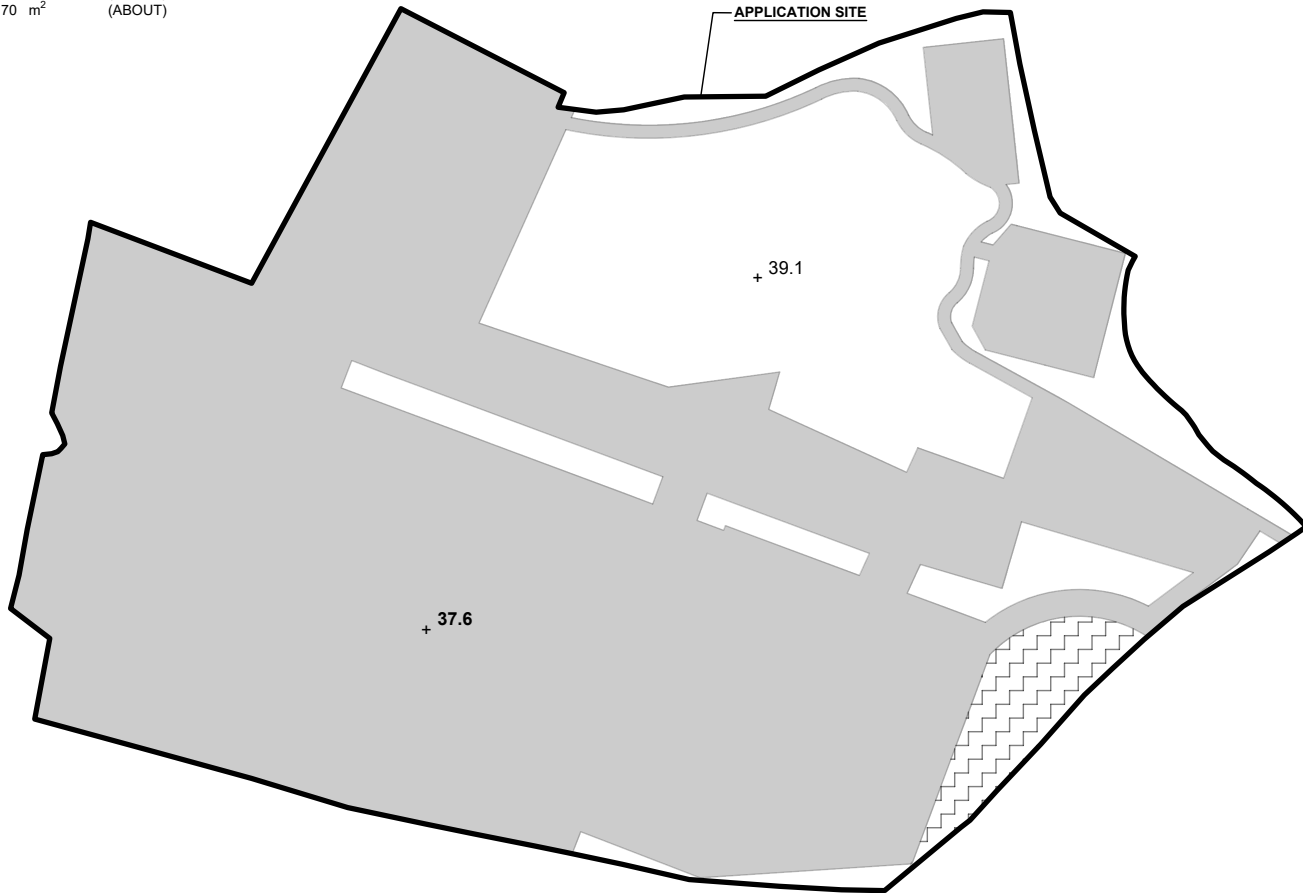
EXISTING LAWN / LANDSCAPING AREA	: 1,650 m ²	(ABOUT)
EXISTING POND FOR VIEWING PURPOSE	: 170 m ²	(ABOUT)

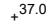

LEGEND

-  APPLICATION SITE
-  EXISTING HARD-PAVED AREA
-  EXISTING POND
-  +37.0 EXISTING SITE LEVEL

SITE LEVELS ARE FOR REFERENCE ONLY.

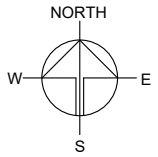

PLANNING CONSULTANT



PROJECT

PROPOSED TEMPORARY PLACE OF RECREATION, SPORTS OR CULTURE AND BARBECUE SITE WITH ANCILLARY FACILITIES FOR A PERIOD OF 3YEARS AND ASSOCIATED FILLING OF LAND

SITE LOCATION

VARIOUS LOTS IN D.D. 111 AND ADJOINING GOVERNMENT LAND, PAT HEUNG, YUEN LONG, NEW TERRITORIES

SCALE

1 : 700 @ A4

DRAWN BY	DATE
MN	30.9.2024

REVISED BY	DATE

APPROVED BY	DATE

DWG. TITLE
FILLING OF LAND

DWG NO.	VER.
PLAN 6	001

SWEPT PATH ANALYSIS

TYPE OF VEHICLE : LIGHT BUS
 DIMENSION OF VEHICLE : 2.3 m (W) X 7 m (L)

SWEPT PATHS GENERATED BY AUTODESK VEHICLE TRACKING

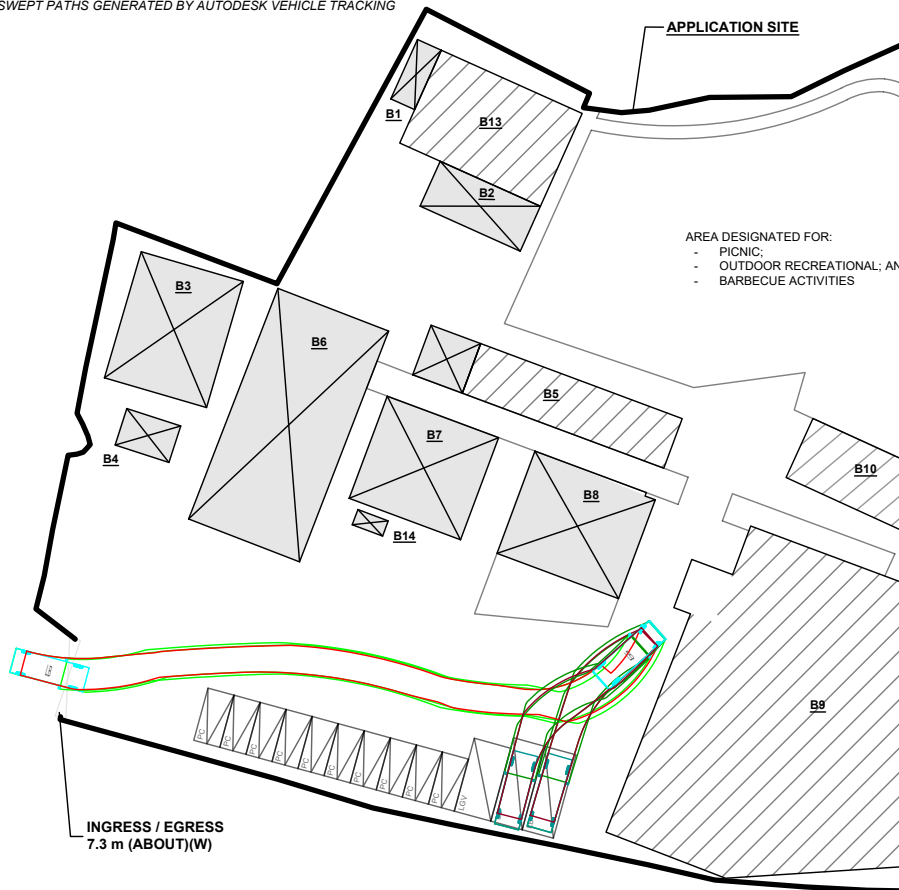

INGRESS / EGRESS
7.3 m (ABOUT)(W)

FROM THE LOCAL ACCESS TO
THE APPLICATION SITE

*SITE BOUNDARY FOR IDENTIFICATION PURPOSE ONLY

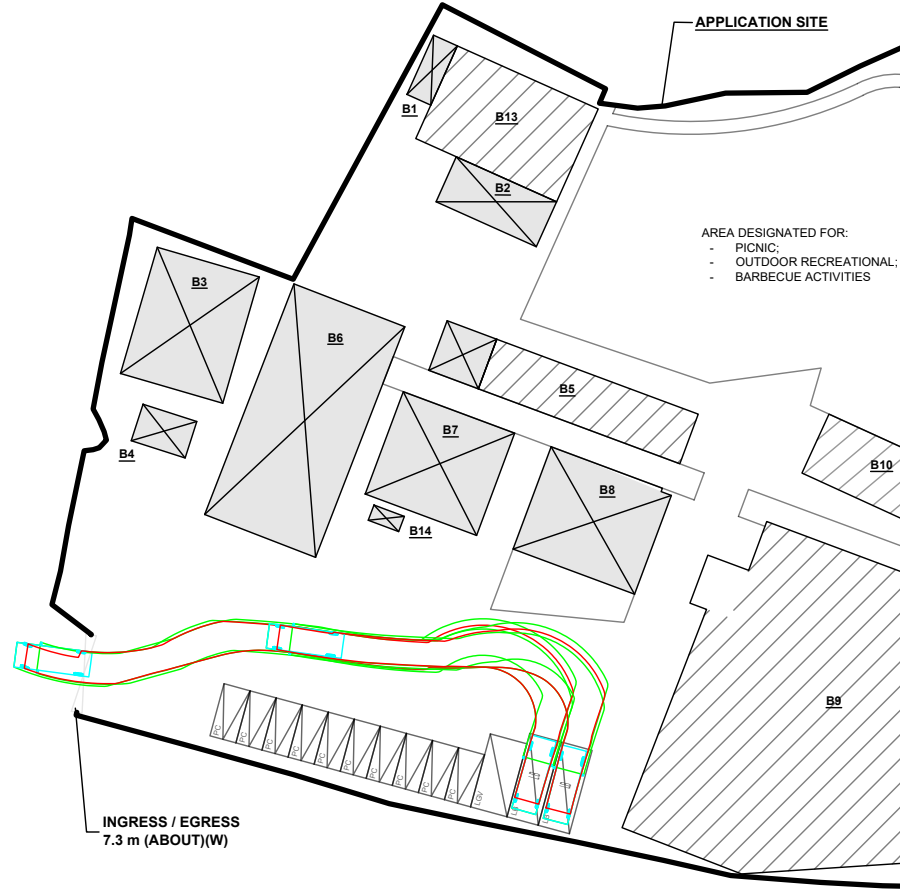

INGRESS / EGRESS
7.3 m (ABOUT)(W)

FROM THE APPLICATION SITE
TO THE LOCAL ACCESS

LEGEND

- APPLICATION SITE
- STRUCTURE (ENCLOSED)
- STRUCTURE (NOT ENCLOSED)
- PARKING SPACE (PC)
- LOADING / UNLOADING SPACE (LGV)
- LOADING / UNLOADING SPACE (LB)
- INGRESS / EGRESS
- LIGHT BUS
- SWEPT PATH OF LIGHT BUS

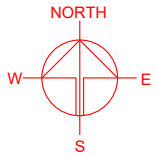

PLANNING CONSULTANT



PROJECT

PROPOSED TEMPORARY PLACE OF RECREATION, SPORTS OR CULTURE AND BARBECUE SITE WITH ANCILLARY FACILITIES FOR A PERIOD OF 3YEARS AND ASSOCIATED FILLING OF LAND

SITE LOCATION

VARIOUS LOTS IN D.D. 111 AND ADJOINING GOVERNMENT LAND, PAT HEUNG, YUEN LONG, NEW TERRITORIES

SCALE

1 : 700 @ A4

DRAWN BY

MN

DATE

30.9.2024

CHECKED BY

DATE

APPROVED BY

DATE

DWG. TITLE

SWEPT PATH ANALYSIS

DWG NO.

PLAN 7

VER.

001