

LOCATION OF THE APPLICATION SITE

APPLICATION SITE AREA : 4,226 m² (ABOUT)

VEHICULAR ACCESS

ACCESSIBLE FROM KAM SHEUNG ROAD VIA KAM SHUI SOUTH ROAD AND A LOCAL ACCESS

ACCESSIBLE FROM KAM SHEUNG ROAD VIA KAM SHUI SOUTH ROAD AND A LOCAL ACCESS

APPLICATION SITE

SITE BOUNDARY FOR IDENTIFICATION PURPOSE.

LEGEND

 APPLICATION SITE

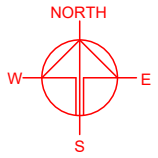

PLANNING CONSULTANT



PROJECT

PROPOSED TEMPORARY OPEN STORAGE OF CONSTRUCTION MATERIALS WITH ANCILLARY FACILITIES FOR A PERIOD OF 3 YEARS AND ASSOCIATED FILLING OF LAND

SITE LOCATION

LOT 1080 (PART) IN D.D. 106, KAM TIN, YUEN LONG, NEW TERRITORIES

SCALE
1 : 3000 @ A4

DRAWN BY
MN 12.6.2024

REVISED BY
DATE

APPROVED BY
DATE

DWG. TITLE
LOCATION PLAN

DWG NO.
PLAN 1

VER.
001

ZONING OF THE APPLICATION SITE

APPLICATION SITE AREA : 4,226 m² (ABOUT)
 OUTLINE ZONING PLAN : APPROVED SHEK KONG OZP
 OZP PLAN NO. : S/YL-SK/9
 ZONING OF THE SITE : "AGRICULTURE" ("AGR")

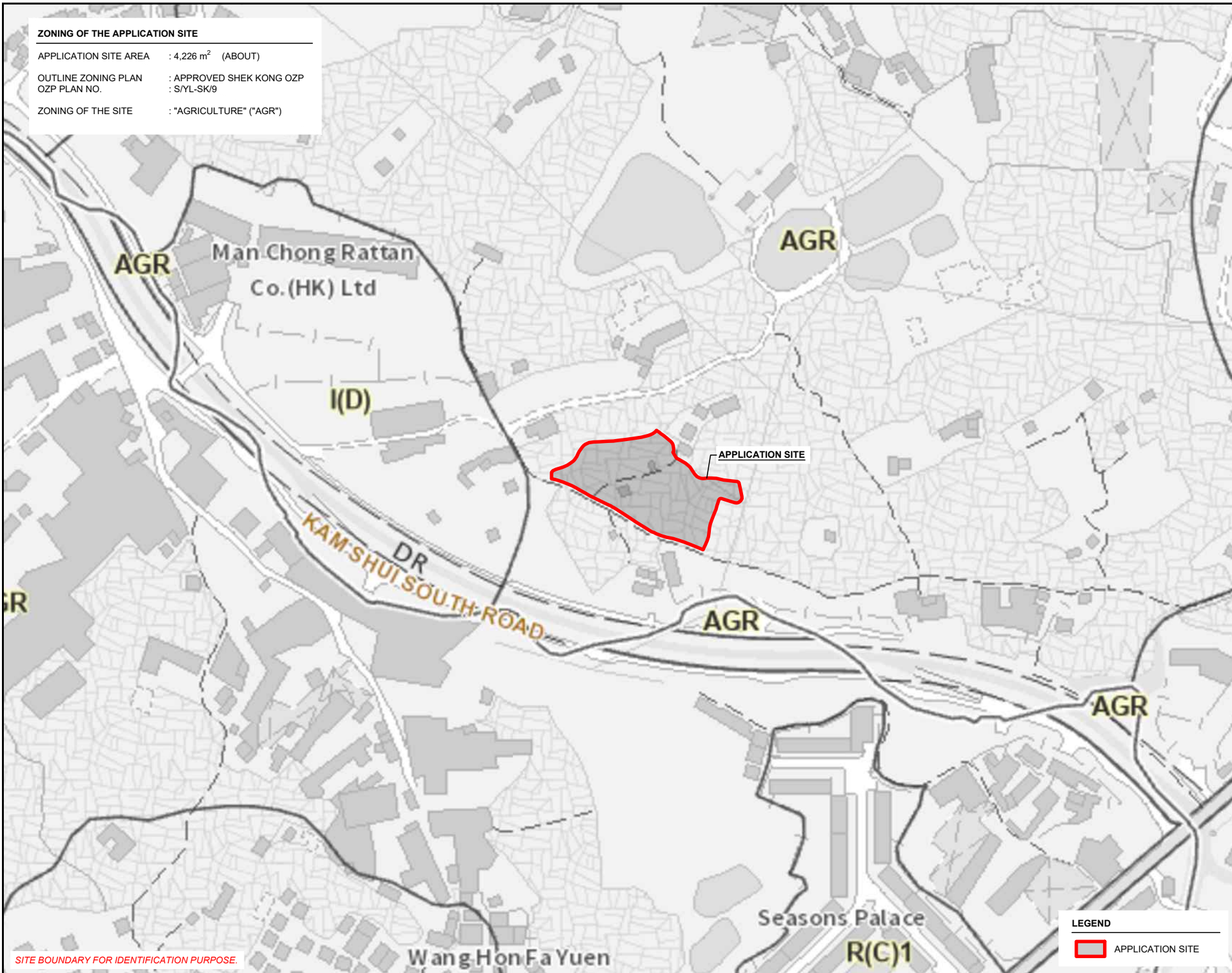
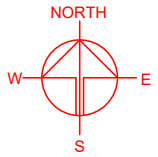

SITE BOUNDARY FOR IDENTIFICATION PURPOSE.

LEGEND

APPLICATION SITE

PLANNING CONSULTANT

PROJECT

PROPOSED TEMPORARY OPEN STORAGE OF CONSTRUCTION MATERIALS WITH ANCILLARY FACILITIES FOR A PERIOD OF 3 YEARS AND ASSOCIATED FILLING OF LAND

SITE LOCATION

LOT 1080 (PART) IN D.D. 106, KAM TIN, YUEN LONG, NEW TERRITORIES

| | |
|--------------------|-----------|
| SCALE | |
| 1 : 3000 @ A4 | |
| DRAWN BY | DATE |
| MN | 12.6.2024 |
| REVISED BY | DATE |
| APPROVED BY | DATE |
| DWG. TITLE | |
| ZONING OF THE SITE | |
| DWG NO. | VER. |
| PLAN 2 | 001 |

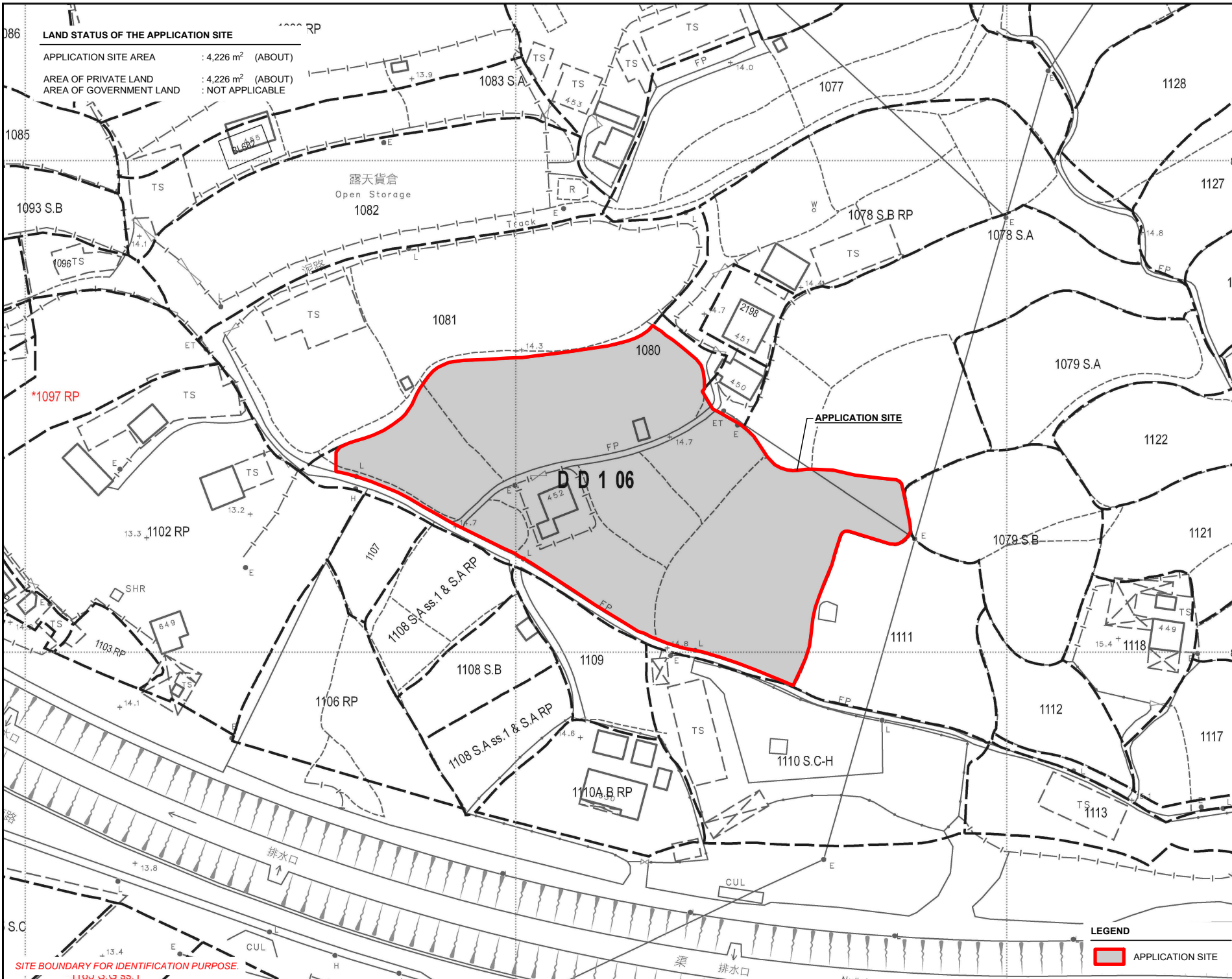

LAND STATUS OF THE APPLICATION SITE

APPLICATION SITE AREA : 4,226 m² (ABOUT)
 AREA OF PRIVATE LAND : 4,226 m² (ABOUT)
 AREA OF GOVERNMENT LAND : NOT APPLICABLE

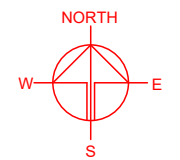

PLANNING CONSULTANT
R-Riches
 Property Consultants Ltd.

PROJECT
 PROPOSED TEMPORARY OPEN STORAGE OF CONSTRUCTION MATERIALS WITH ANCILLARY FACILITIES FOR A PERIOD OF 3 YEARS AND ASSOCIATED FILLING OF LAND

SITE LOCATION
 LOT 1080 (PART) IN D.D. 106, KAM TIN, YUEN LONG, NEW TERRITORIES

| | |
|-----------------------|-------------------|
| SCALE 1: 1000 @ A4 | |
| DRAWN BY MN | DATE 12.6.2024 |
| REVISED BY | DATE |
| APPROVED BY | DATE |

LEGEND
 APPLICATION SITE

| | |
|---------------------------------------|-------------|
| DWG. TITLE LAND STATUS OF THE SITE | |
| DWG. NO. PLAN 3 | VER. 001 |

SITE BOUNDARY FOR IDENTIFICATION PURPOSE.
 1:1000 @ A4

**TOWN PLANNING BOARD GUIDELINES NO. 13G
FOR APPLICATION FOR OPEN STORAGE AND PORT BACK-UP
USES UNDER SECTION 16 OF THE TOWN PLANNING ORDINANCE**

APPLICATION SITE AREA : 4,226 m² (ABOUT)

CATEGORY OF THE SITE : CATEGORY 2 AREA

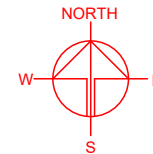

Man Chong
Rattan
Co.(HK) Ltd

Open
Storage

APPLICATION SITE





Factory

AGR

KAM SHUI SOUTH ROAD

Open
Storage

TPB Guidelines No. 13G

-  Category 1 Areas
-  Category 2 Areas
-  Category 3 Areas
-  Category 4 Areas

SITE BOUNDARY FOR IDENTIFICATION PURPOSE.

LEGEND

 APPLICATION SITE

PLANNING CONSULTANT



PROJECT

PROPOSED TEMPORARY OPEN STORAGE OF CONSTRUCTION MATERIALS WITH ANCILLARY FACILITIES FOR A PERIOD OF 3 YEARS AND ASSOCIATED FILLING OF LAND

SITE LOCATION

LOT 1080 (PART) IN D.D. 106, KAM TIN, YUEN LONG, NEW TERRITORIES

SCALE

1 : 2000 @ A4

DRAWN BY

MN

DATE

12.6.2024

REVISED BY

DATE

APPROVED BY

DATE

DWG. TITLE

TPB PG-NO. 13G

DWG NO.

PLAN 4

VER.

001

DEVELOPMENT PARAMETERS

| | | |
|-----------------------|------------------------|---------|
| APPLICATION SITE AREA | : 4,226 m ² | (ABOUT) |
| COVERED AREA | : 320 m ² | (ABOUT) |
| UNCOVERED AREA | : 3,906 m ² | (ABOUT) |
| | | |
| PLOT RATIO | : 0.08 | (ABOUT) |
| SITE COVERAGE | : 8 % | (ABOUT) |
| | | |
| NO. OF STRUCTURE | : 2 | |
| DOMESTIC GFA | : NOT APPLICABLE | |
| NON-DOMESTIC GFA | : 320 m ² | (ABOUT) |
| TOTAL GFA | : 320 m ² | (ABOUT) |
| | | |
| BUILDING HEIGHT | : 5 m | (ABOUT) |
| NO. OF STOREY | : 1 | |

| STRUCTURE | USE | COVERED AREA | GFA | BUILDING HEIGHT |
|--------------|--|----------------------------------|----------------------------------|-----------------------|
| B1 | SHED FOR STORAGE OF CONSTRUCTION MATERIALS AND SITE OFFICE | 160 m ² (ABOUT) | 160 m ² (ABOUT) | 5 m (ABOUT)(1-STOREY) |
| B2 | SHED FOR STORAGE OF CONSTRUCTION MATERIALS AND SITE OFFICE | 160 m ² (ABOUT) | 160 m ² (ABOUT) | 5 m (ABOUT)(1-STOREY) |
| TOTAL | | 320 m² (ABOUT) | 320 m² (ABOUT) | |

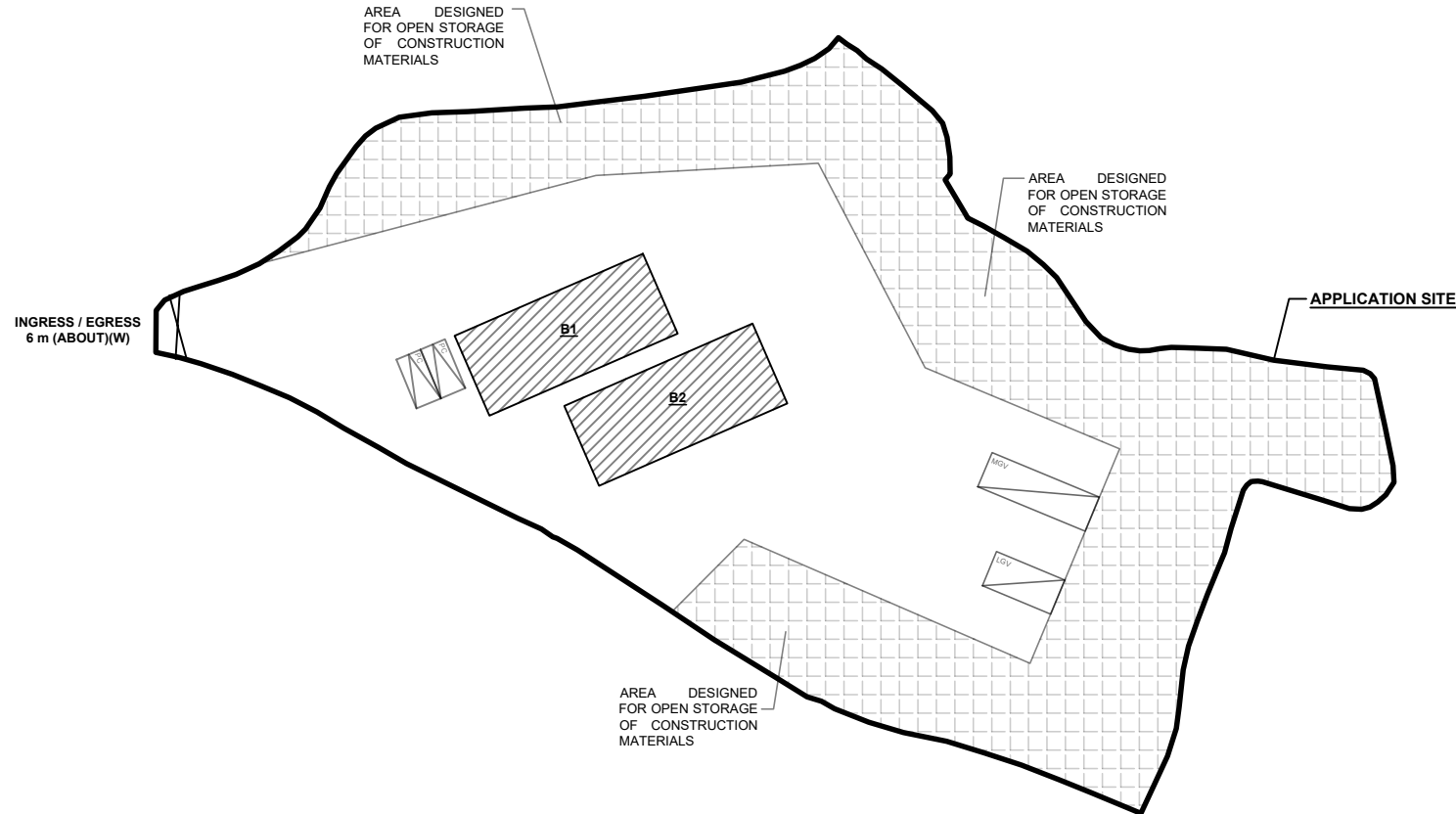
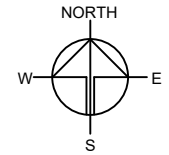

PARKING AND LOADING / UNLOADING (L/UL) PROVISIONS

| | |
|--|------------------------|
| NO. OF PRIVATE CAR PARKING SPACE | : 2 |
| DIMENSION OF PARKING SPACE | : 5 m (L) x 2.5 m (W) |
| | |
| NO. OF L/UL SPACE FOR LIGHT GOODS VEHICLE | : 1 |
| DIMENSION OF L/UL SPACE | : 7 m (L) X 3.5 m (W) |
| | |
| NO. OF L/UL SPACE FOR MEDIUM GOODS VEHICLE | : 1 |
| DIMENSION OF L/UL SPACE | : 11 m (L) X 3.5 m (W) |

LEGEND

- APPLICATION SITE
- STRUCTURE (SHED)
- PARKING SPACE (PRIVATE CAR)
- L/UL SPACE (LIGHT GOODS VEHICLE)
- L/UL SPACE (MEDIUM GOODS VEHICLE)
- INGRESS / EGRESS

PLANNING CONSULTANT



PROJECT

PROPOSED TEMPORARY OPEN STORAGE OF CONSTRUCTION MATERIALS WITH ANCILLARY FACILITIES FOR A PERIOD OF 3 YEARS AND ASSOCIATED FILLING OF LAND

SITE LOCATION

LOT 1080 (PART) IN D.D. 106, KAM TIN, YUEN LONG, NEW TERRITORIES

SCALE

1 : 700 @ A4

DRAWN BY: MN DATE: 12.6.2024

CHECKED BY: DATE:

APPROVED BY: DATE:

DWG. TITLE
LAYOUT PLAN

DWG NO.: PLAN 5 VER.: 001

PAVED RATIO OF THE APPLICATION SITE

| | | |
|-----------------------|--------------------------|---------|
| APPLICATION SITE AREA | : 4,226 m ² | (ABOUT) |
| EXISTING SITE SURFACE | : HARD-PAVED | |
| EXISTING SITE LEVEL | : +14.7 mPD TO +14.8 mPD | (ABOUT) |
| DEPTH OF LAND FILLING | : NOT MORE THAN 0.2 m | |

THE APPLICATION SITE HAS BEEN HARD-PAVED WITH CONCRETE. NO FURTHER FILLING OF LAND WILL BE CARRIED OUT AT THE SITE DURING THE PLANNING APPROVAL PERIOD.

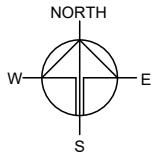
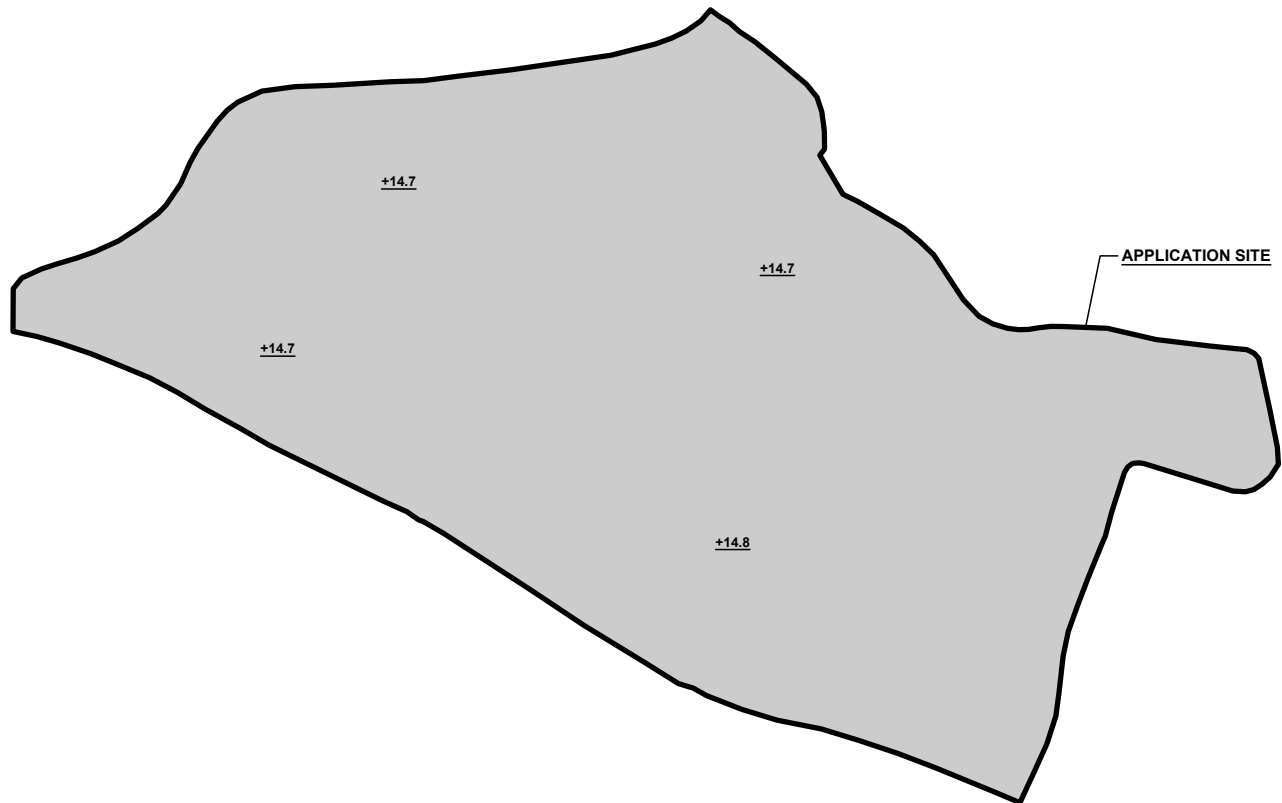

PLANNING CONSULTANT



PROJECT

PROPOSED TEMPORARY OPEN STORAGE OF CONSTRUCTION MATERIALS WITH ANCILLARY FACILITIES FOR A PERIOD OF 3 YEARS AND ASSOCIATED FILLING OF LAND

SITE LOCATION

LOT 1080 (PART) IN D.D. 106, KAM TIN, YUEN LONG, NEW TERRITORIES

SCALE

1 : 700 @ A4

| | |
|----------|-----------|
| DRAWN BY | DATE |
| MN | 12.6.2024 |

| | |
|------------|------|
| REVISED BY | DATE |
| | |

| | |
|-------------|------|
| APPROVED BY | DATE |
| | |

DWG. TITLE
FILLING OF LAND AREA

| | |
|---------|------|
| DWG NO. | VER. |
| PLAN 6 | 001 |

LEGEND

- APPLICATION SITE
- EXISTING SITE LEVELS
- EXISTING HARD-PAVED AREA

SITE BOUNDARY FOR IDENTIFICATION PURPOSE.

SWEPT PATH ANALYSIS

TYPE OF VEHICLE : MEDIUM GOODS VEHICLE
 DIMENSION OF VEHICLE : 2.5 m (W) X 11 m (L)

SWEPT PATHS GENERATED BY AUTODESK VEHICLE TRACKING

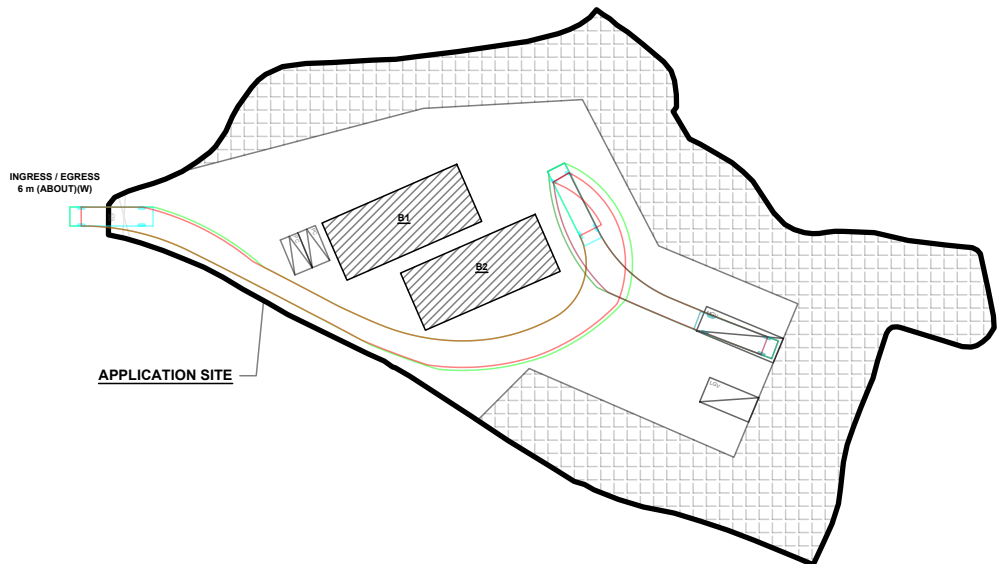

FROM THE LOCAL ACCESS TO
 THE APPLICATION SITE

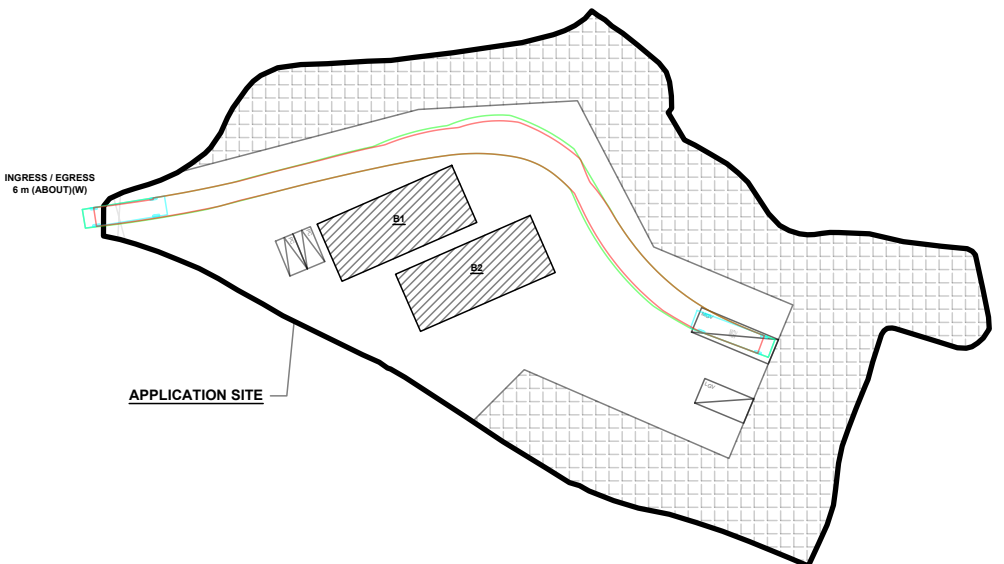

FROM THE APPLICATION SITE
 TO THE LOCAL ACCESS

LEGEND

- APPLICATION SITE
- LOADING / UNLOADING SPACE
- MEDIUM GOODS VEHICLE
- SWEEP PATH OF VEHICLE

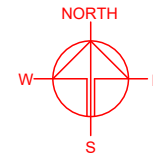

PLANNING CONSULTANT



PROJECT

PROPOSED TEMPORARY OPEN STORAGE OF CONSTRUCTION MATERIALS WITH ANCILLARY FACILITIES FOR A PERIOD OF 3 YEARS AND ASSOCIATED FILLING OF LAND

SITE LOCATION

LOT 1080 (PART) IN D.D. 106, KAM TIN, YUEN LONG, NEW TERRITORIES

SCALE

1 : 1000 @ A4

| | |
|----------|-----------|
| DRAWN BY | DATE |
| MN | 12.6.2024 |

| | |
|------------|------|
| CHECKED BY | DATE |
| | |

| | |
|-------------|------|
| APPROVED BY | DATE |
| | |

DWG. TITLE
 SWEEP PATH ANALYSIS

| | |
|---------|------|
| DWG NO. | VER. |
| PLAN 7 | 001 |