

Extracted from Approved Shek Kong Outline Zoning Plan No. S/YL-SK/9

N.T.S	Location Plan	Goldrich Planners & Surveyors Ltd.
November 2023	Lots 906 RP and 907 in D.D. 114 and Adjoining Government Land Yuen Long, New Territories	Plan 1 (P 23050)

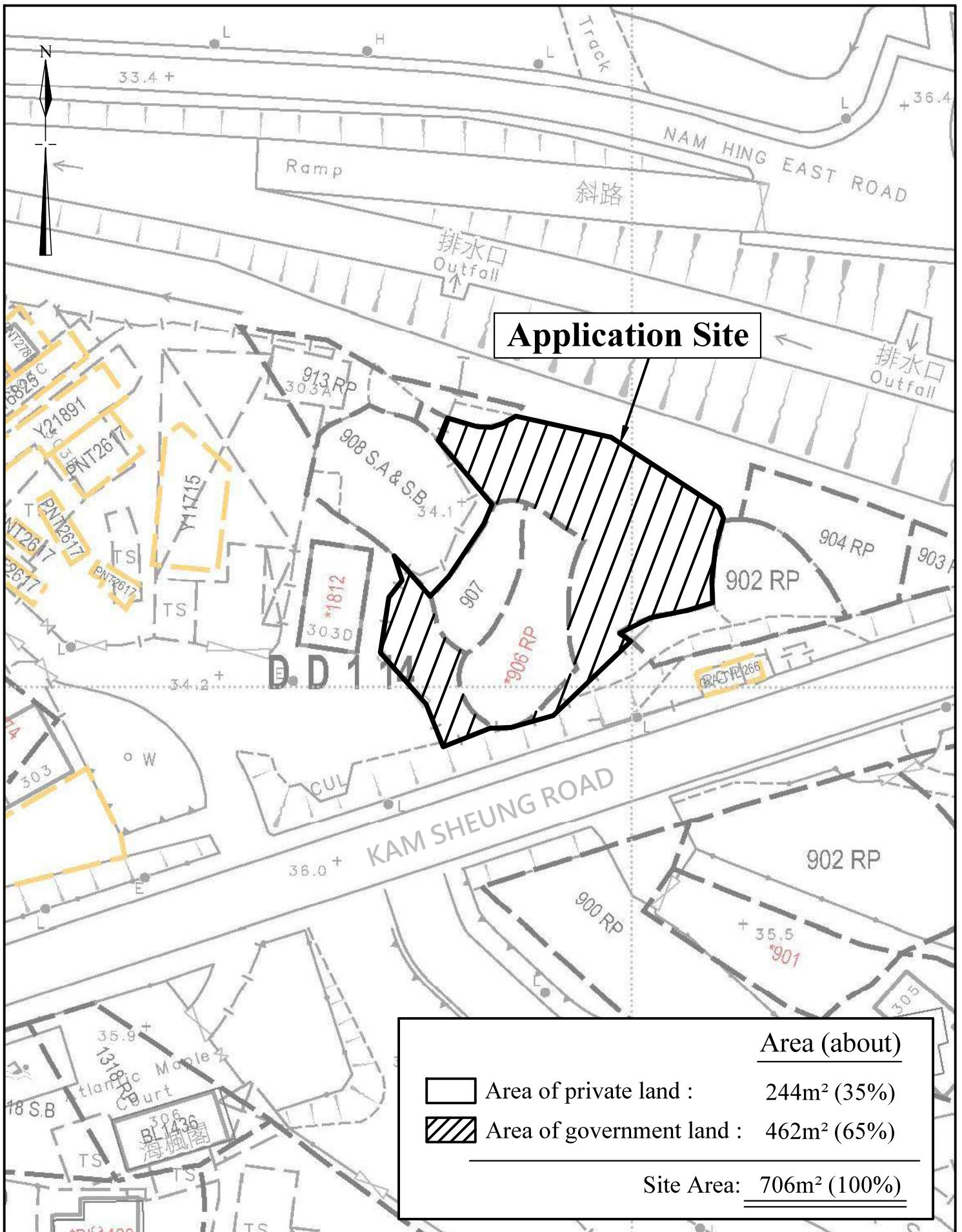

1:500

November 2023

Lot Index Plan



Lots 906 RP and 907 in D.D. 114
and Adjoining Government Land
Yuen Long, New Territories

**Goldrich Planners &
Surveyors Ltd.**

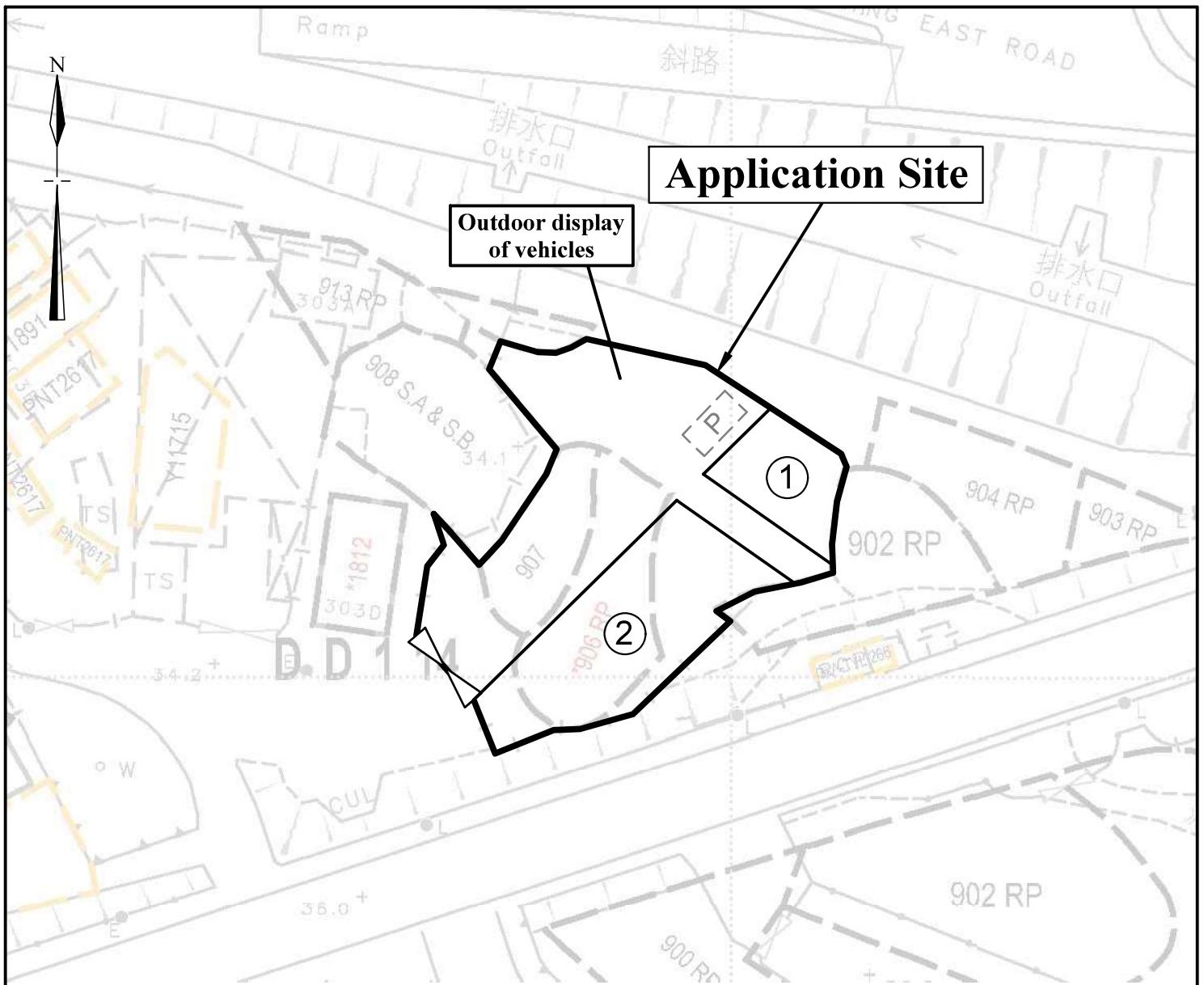
**Plan 2
(P 23050)**



Legend

-  Vehicular Ingress / Egress
-  Parking space for private cars
(5m (L) x 2.5m (W))

Site Area (about) : 706m²

No.	Structure / Uses	Floor Area (about)	Covered Area (about)	Storeys	Height
1	Vehicle Showroom	77 m ²	77 m ²	1	5m
2	Vehicle Showroom	225 m ²	225 m ²	1	5m
Total :		302 m²	302 m²		

1:500	Layout Plan	Goldrich Planners & Surveyors Ltd.
December 2023	Lots 906 RP and 907 in D.D. 114 and Adjoining Government Land Yuen Long, New Territories	Plan 3 (P 23050)

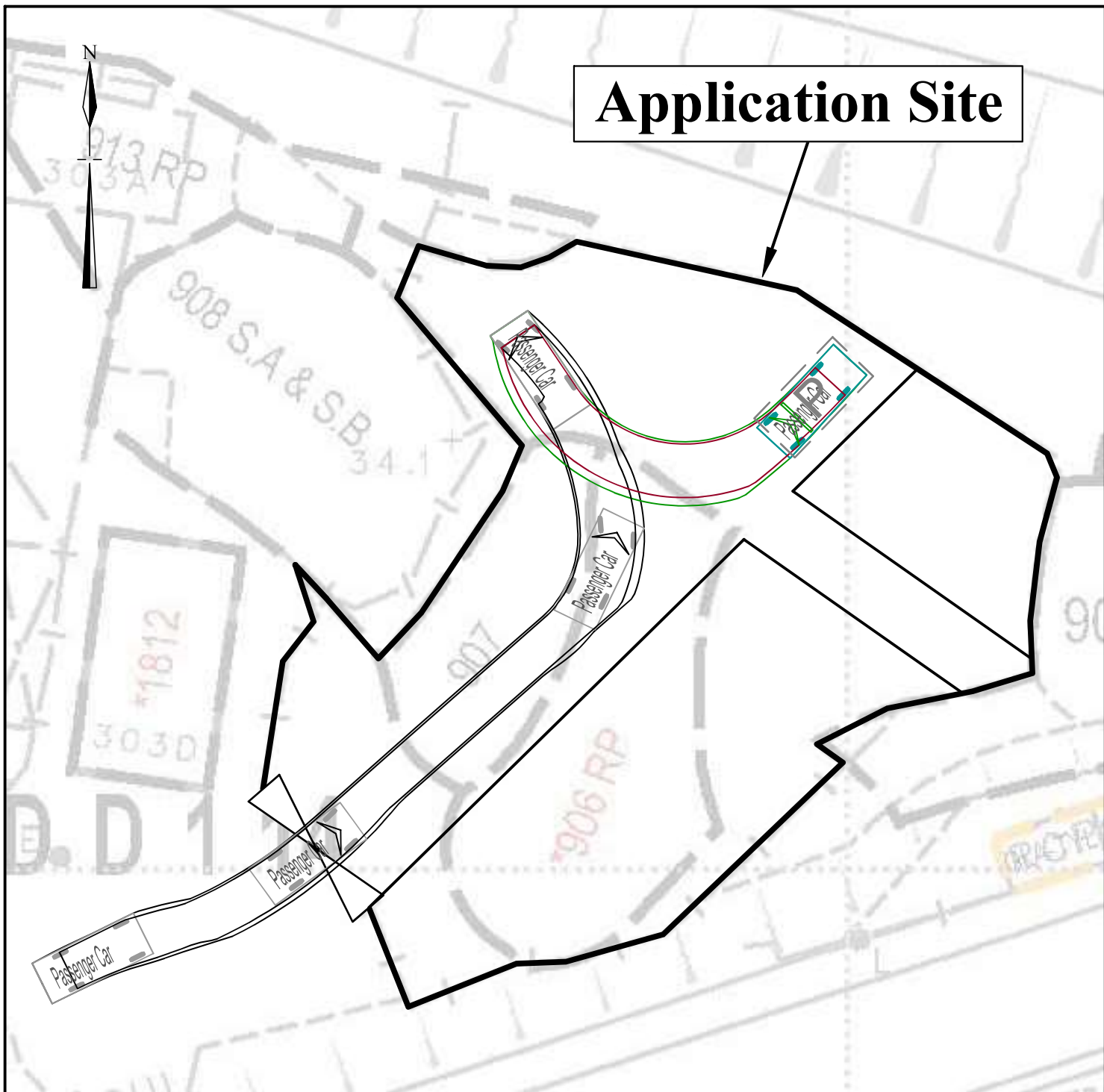

Legend

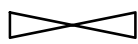

Vehicular Ingress / Egress

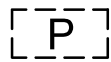

**Parking space for private cars
(5m (L) x 2.5m (W))**



**Private cars
(5m (L) x 2m (W))**

<p>1:250</p>	<p>Swept Path Analysis</p>	<p>Goldrich Planners & Surveyors Ltd.</p>
<p>December 2023</p>	<p>Lots 906 RP and 907 in D.D. 114 and Adjoining Government Land Yuen Long, New Territories</p>	<p>Plan 4 (P 23050)</p>

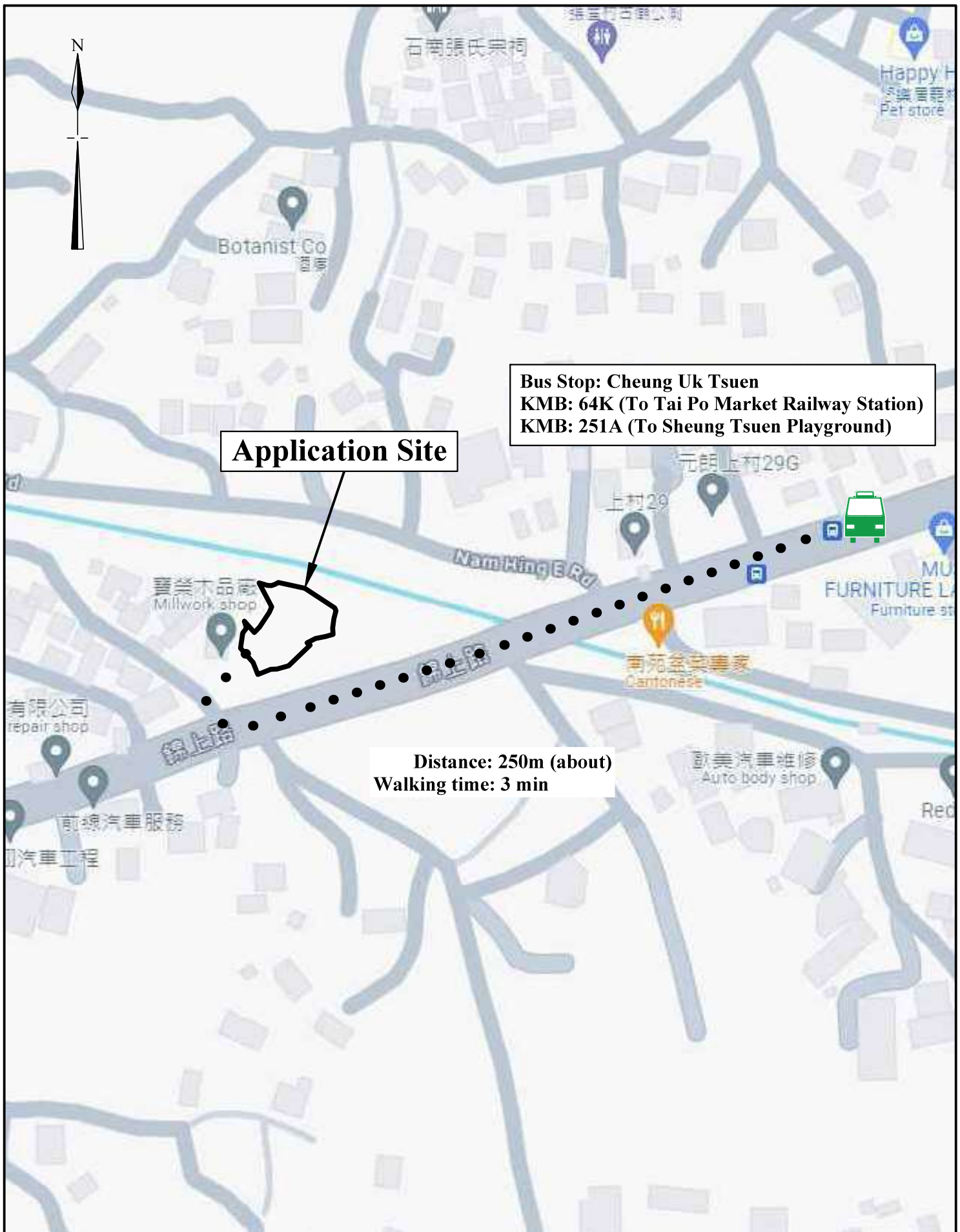

N.T.S	<p align="center">Plan Showing Nearest Public Transport Services</p> <p align="center">Lots 906 RP and 907 in D.D. 114 and Adjoining Government Land Yuen Long, New Territories</p>	<p align="center">Goldrich Planners & Surveyors Ltd.</p>
<p align="center">November 2023</p>		<p align="center">Plan 5 (P 23050)</p>

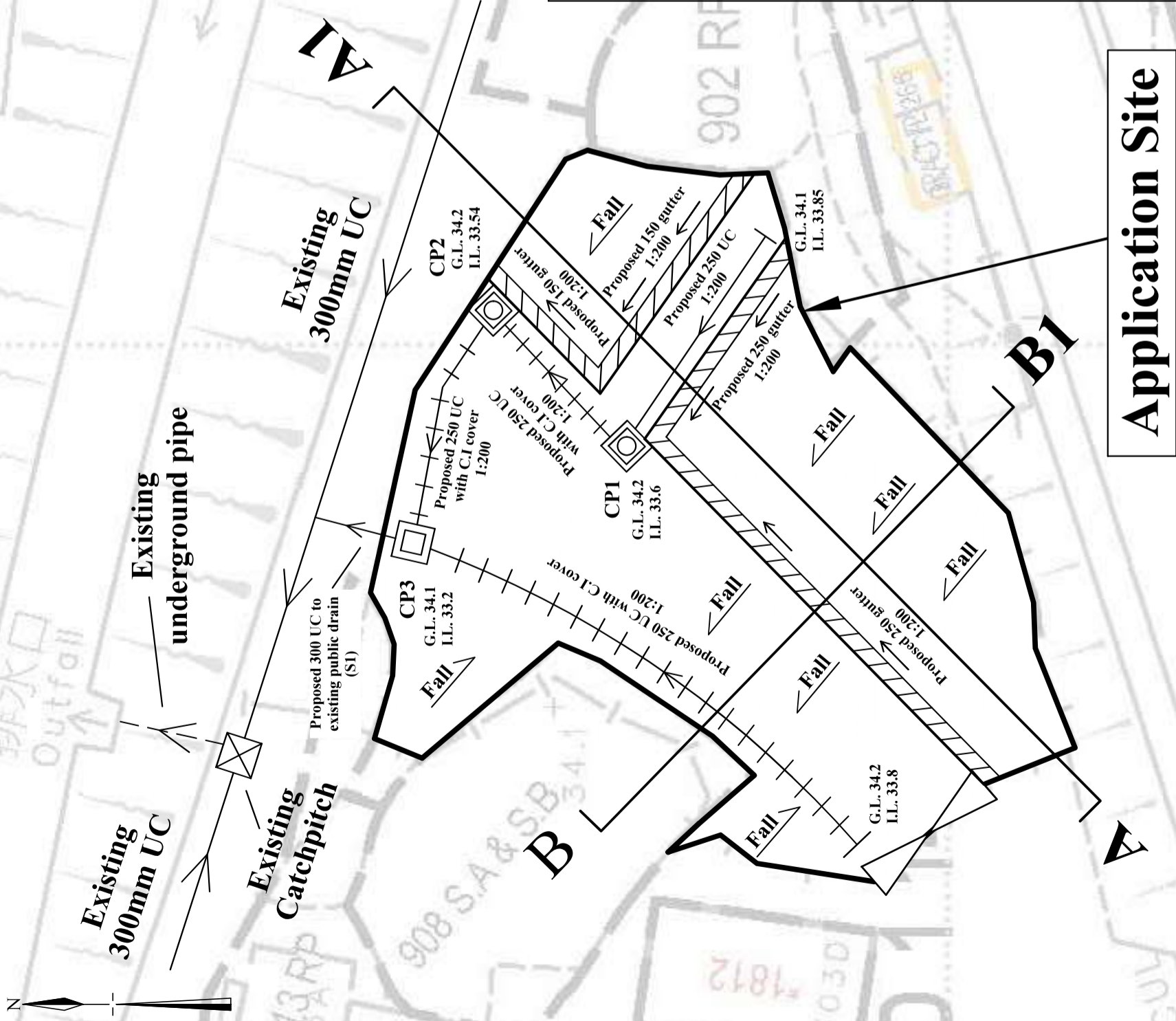

Existing 300mm UC

Existing underground pipe

Existing Catchpitch

Existing 300mm UC

Site Area (about) : 706m²

Legend

- Proposed Catch-pit with down-pipe
- Proposed Catch-pit
- Proposed Catch-pit with trap
- Proposed U-Channel
- Proposed U-Channel with C.I cover
- Proposed Gutter
- Vehicular Ingress / Egress

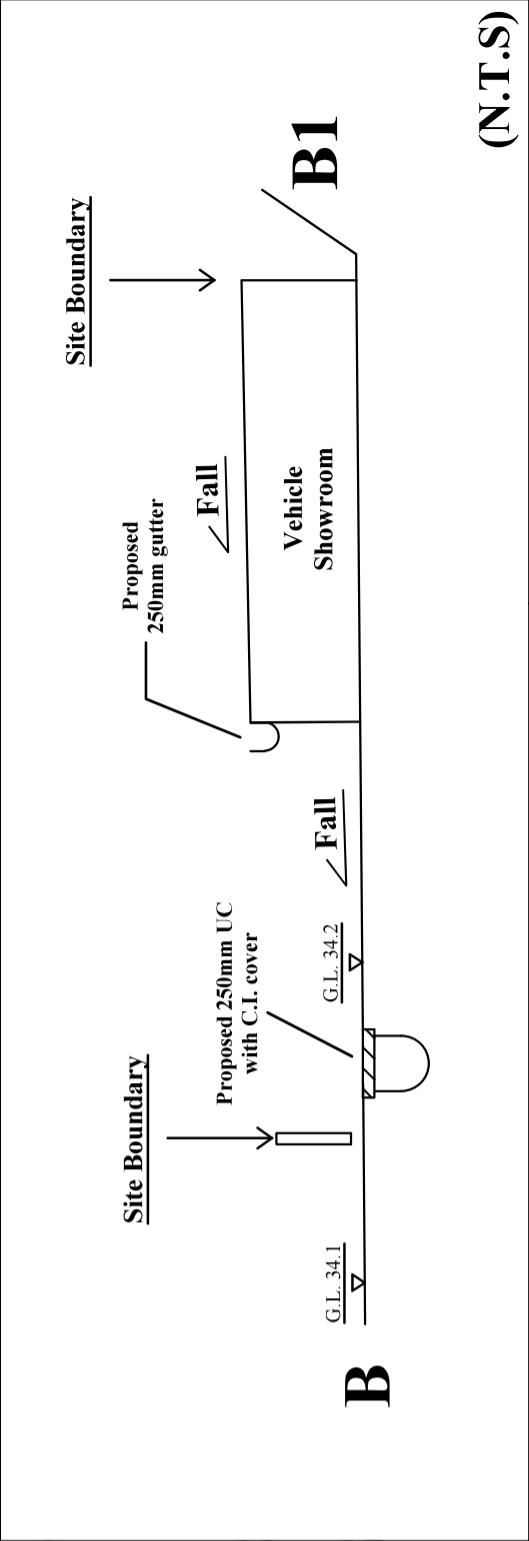
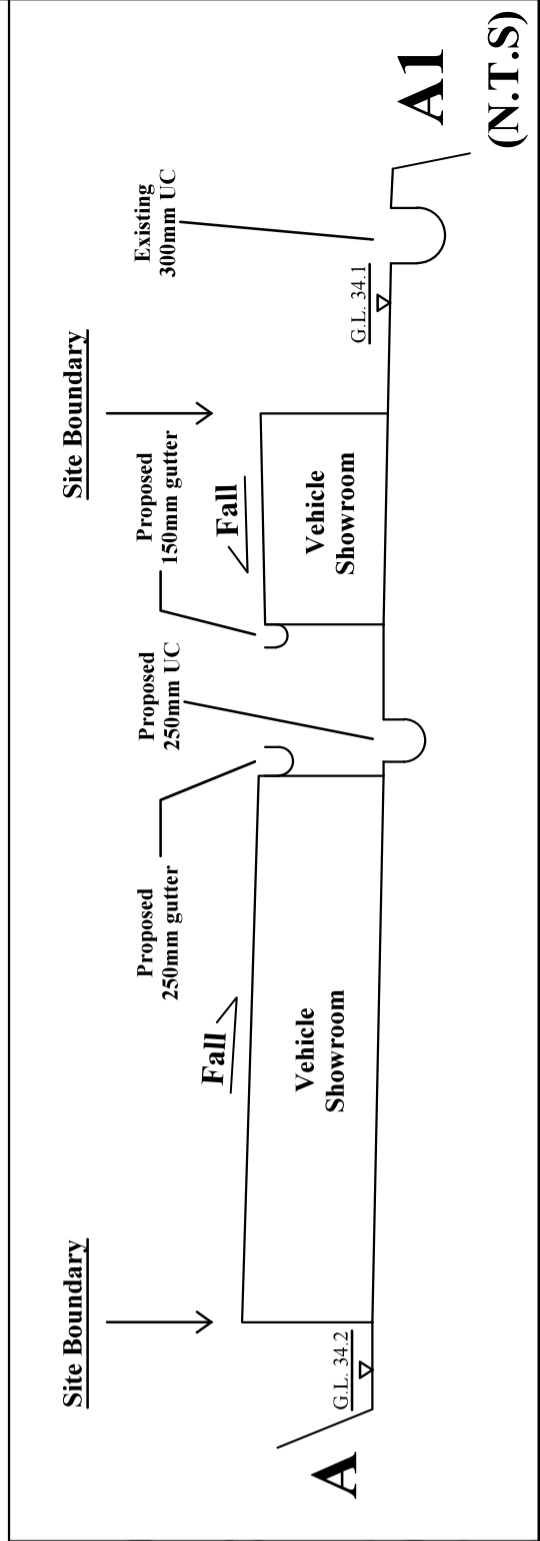

Drainage Proposal

Lots 906 RP and 907 in D.D. 114
and Adjoining Government Land
Yuen Long, New Territories

1:250 (A3)

April 2024

Goldrich Planners & Surveyors Ltd.

Plan 6.1
(P 23050)

(N.T.S)

(N.T.S)

Connection details of proposed outfall between CP3, S1 and existing 300 UC

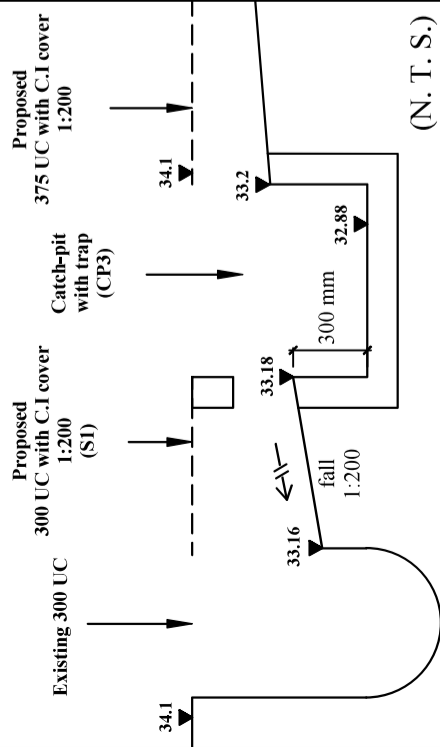

(N. T. S.)

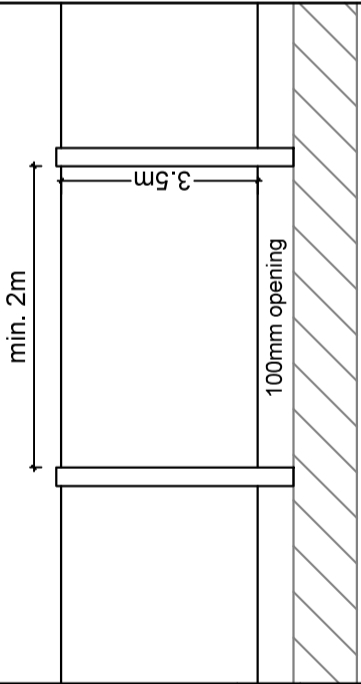

Details of hoarding with 100mm opening

(N. T. S.)

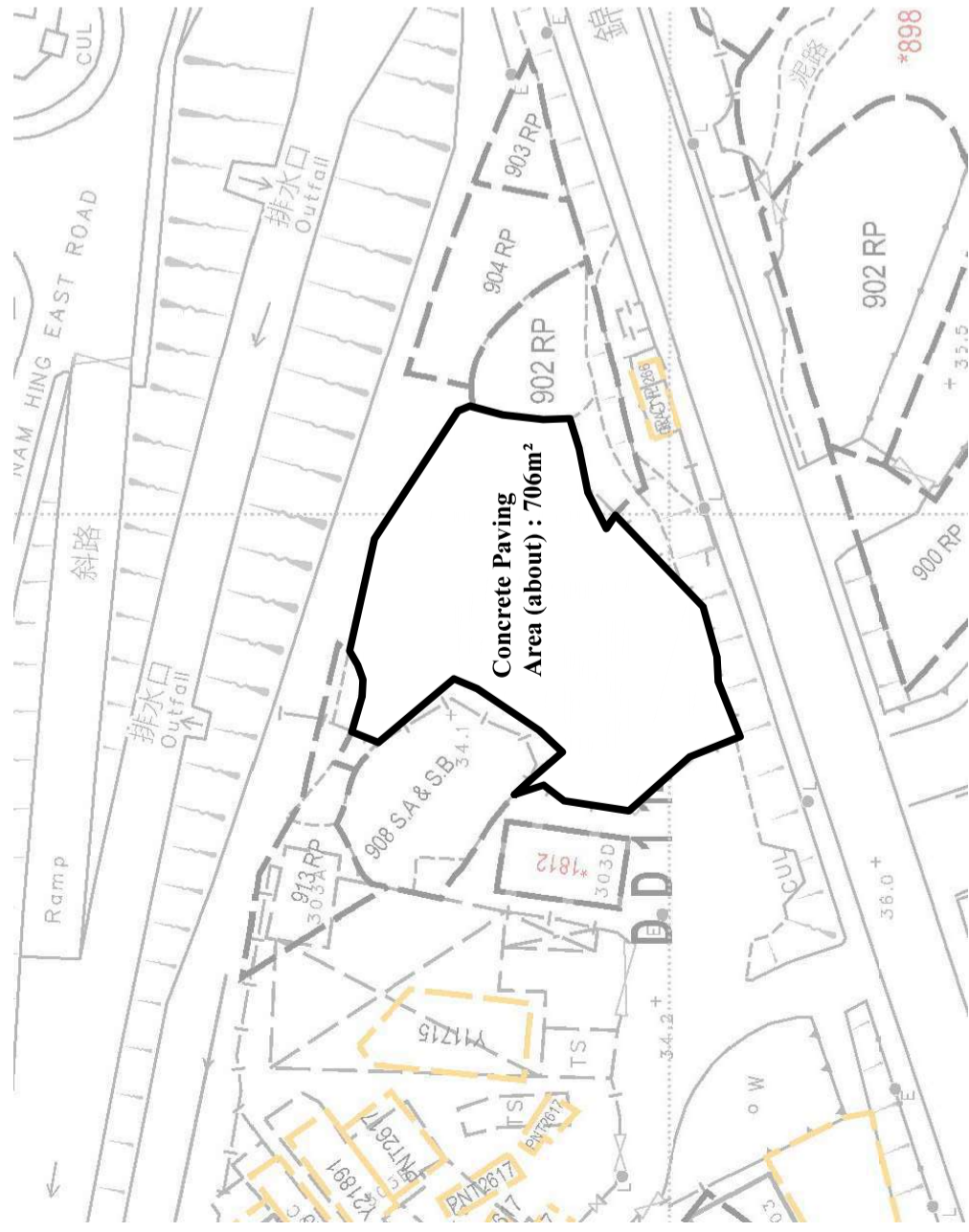

AREA OF CATCHMENT

(N.T.S)

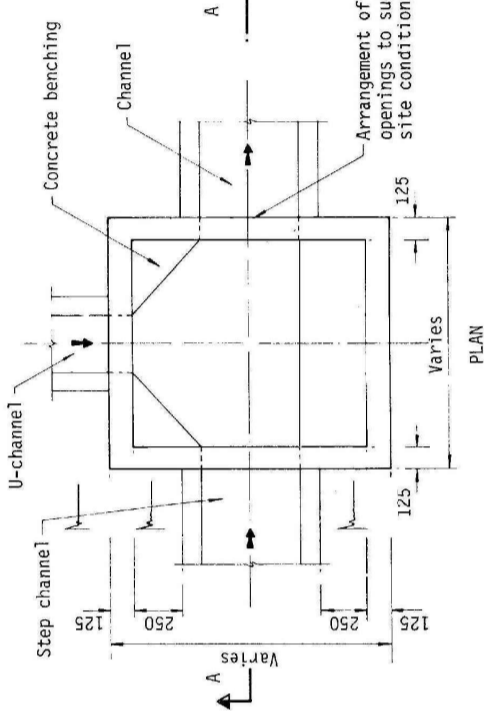

SECTION A-A

TYPICAL DETAILS OF CATCHPIT

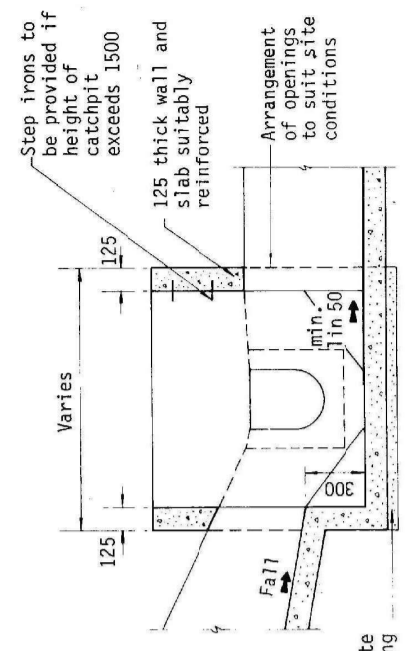

NOMINAL SIZE (LARGEST OF H1, H2, H3 & H4)	B
300 - 600	150
675 - 900	175

PLAN

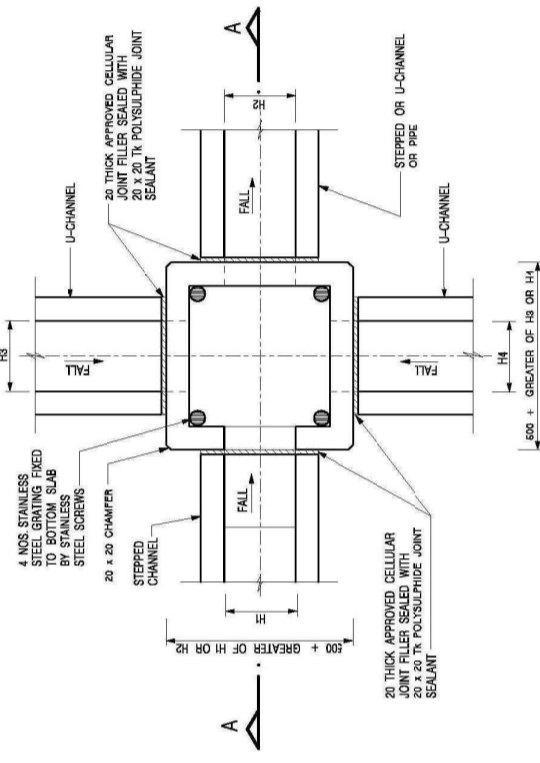

SECTION A - A

DETAILS OF CATCHPIT WITH TRAP
(REFER TO CEDD'S STANDARD DWG. C2406/1)

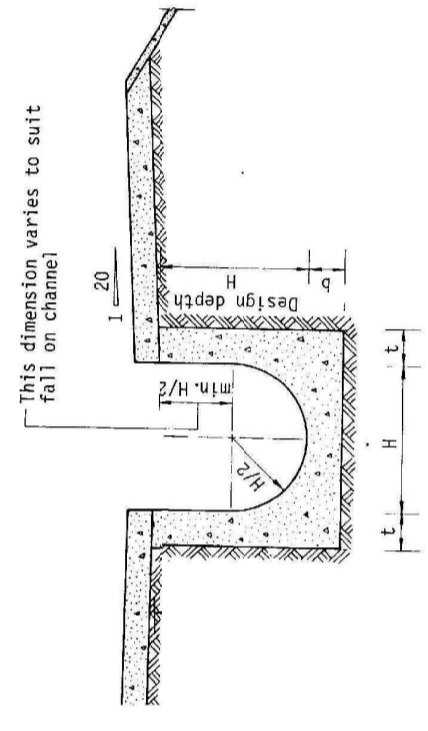

TYPICAL DETAILS OF U CHANNEL

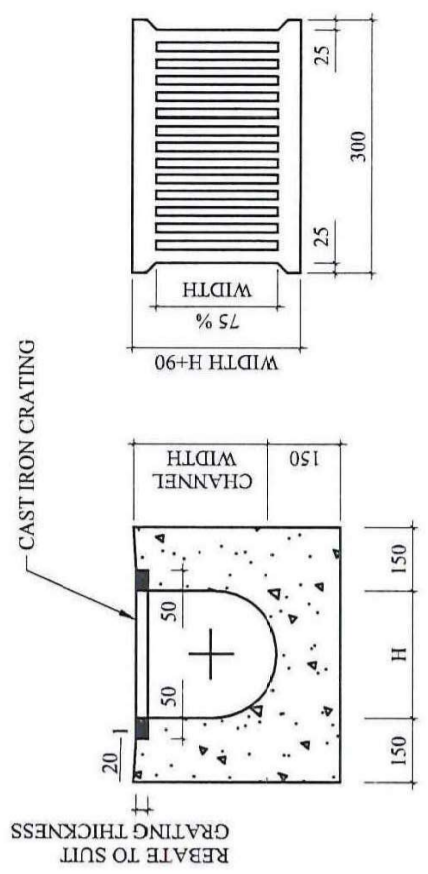

TYPICAL SECTION OF U-CHANNEL WITH COVER
(N.T.S.)

CAST IRON CRATING (HEAVY DUTY)

N.T.S

March 2024

Drainage Proposal

Lots 906 RP and 907 in D.D. 114 and Adjoining Government Land Yuen Long, New Territories

Goldrich Planners & Surveyors Ltd.

Plan 6.2 (P 23050)



Application Site

Outdoor display of vehicles

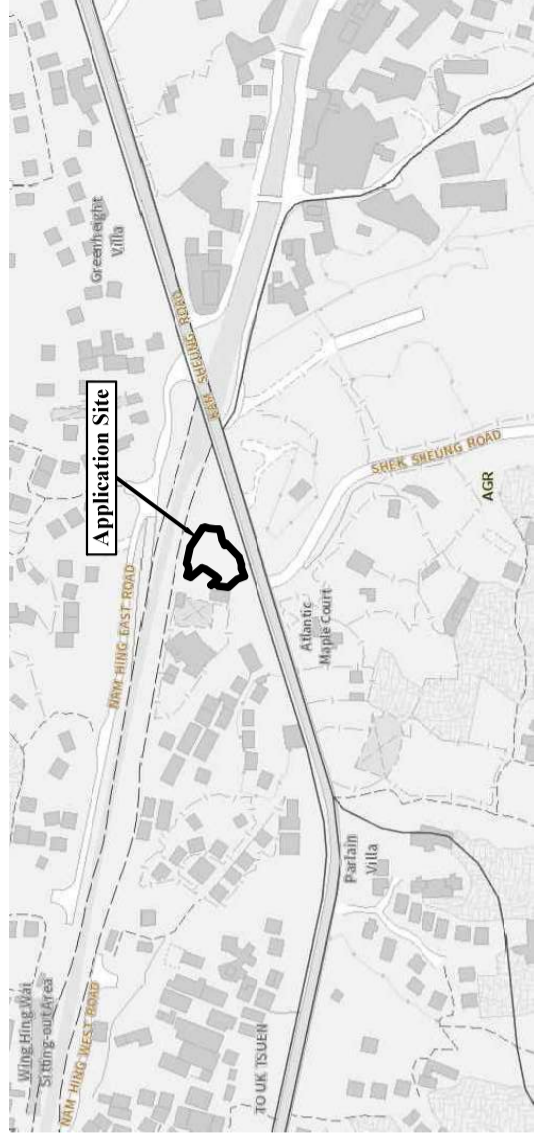
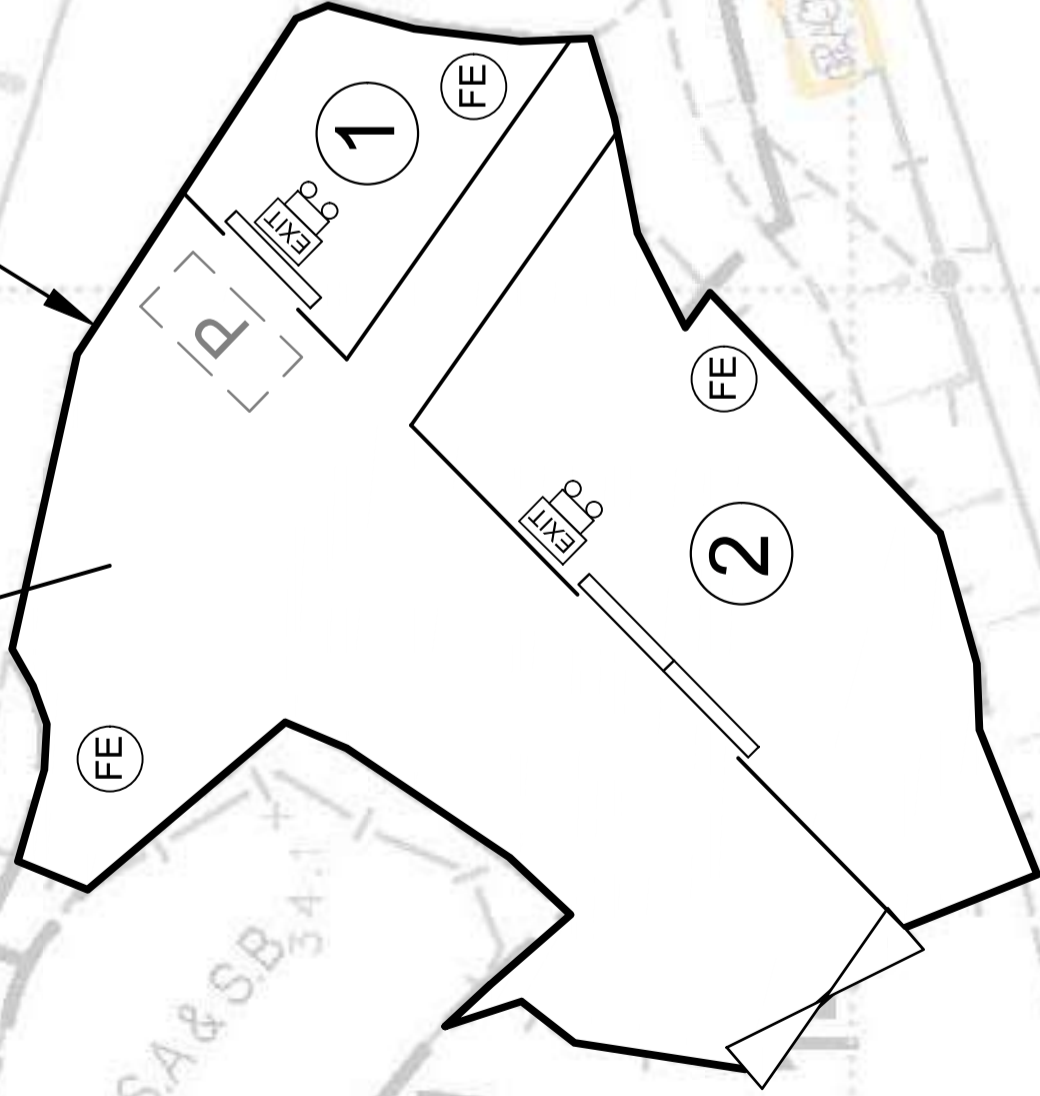

Location Plan

(N.T.S)

FS NOTES:

- (i) Sufficient emergency lighting shall be provided in accordance with BS 5266-1:2016, BS EN 1838:2013 and the FSD Circular Letter No. 4/2021
- (ii) Sufficient directional and exit sign shall be provided in accordance with BS 5266: Part 1 and FSD Circular Letter 5/2008.
- (iii) Portable hand-operated approved appliances shall be provided as required by occupancy.

Legend

- Vehicular Ingress / Egress
- Parking space for private cars (5m (L) x 2.5m (W))
- Sliding door
- 5.0kg CO2 Gas type Fire Extinguisher x3
- Emergency Light x2
- Exit sign x2

Site Area (about) : 706m²

No.	Structure / Uses	Floor Area (about)	Covered Area (about)	Storeys	Height
1	Vehicle Showroom	77 m ²	77 m ²	1	5m
2	Vehicle Showroom	225 m ²	225 m ²	1	5m
Total :		302 m ²	302 m ²		

Fire Service Installation Proposal

1:250 (A3)

April 2024

Lots 906 RP and 907 in D.D. 114
and Adjoining Government Land
Yuen Long, New Territories

Goldrich Planners &
Surveyors Ltd.

Plan 7
(P 23050)

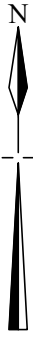

Application Site

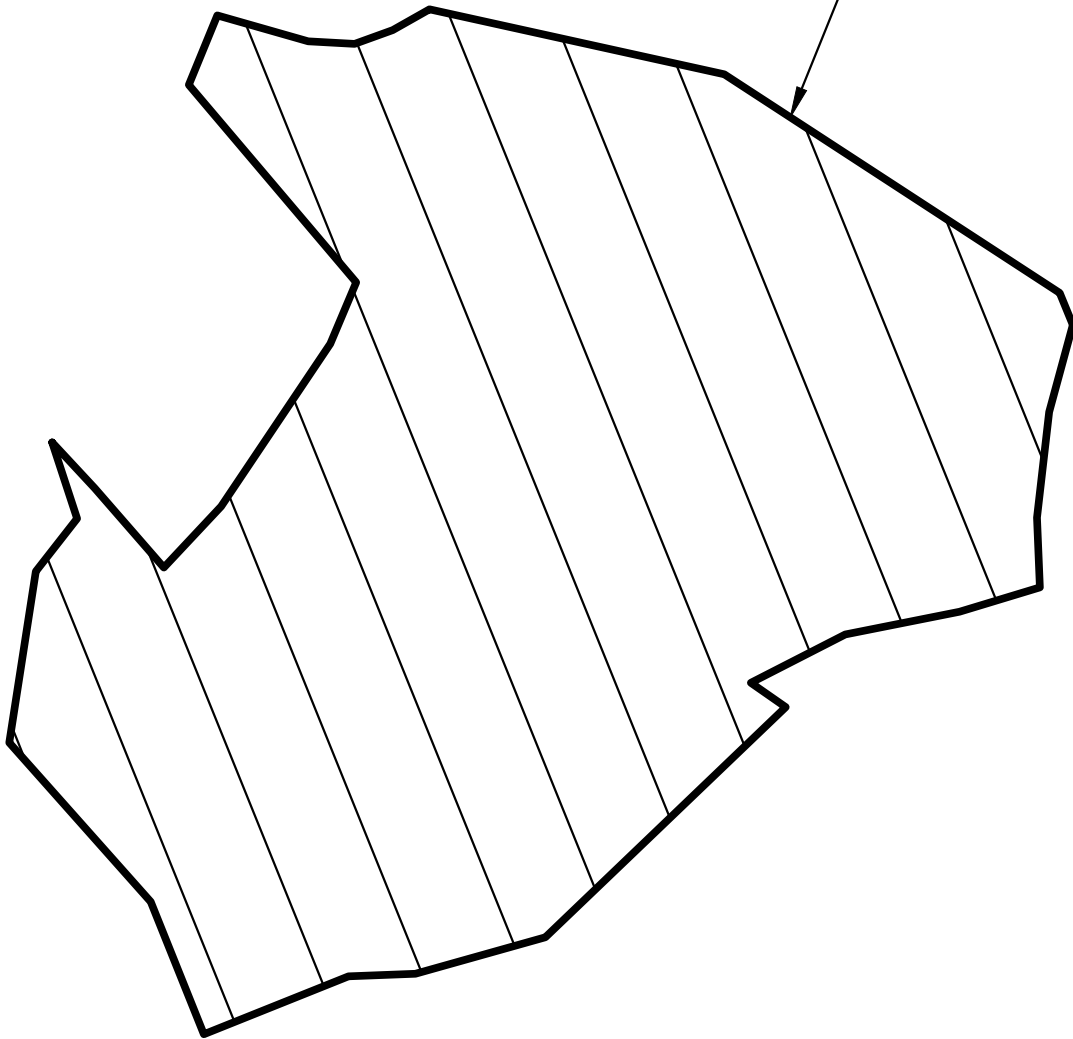

**The current application serves to regularise
the existing hard-paving on site with
concrete of about 0.2m in depth
(from 34.0mPD to 34.2mPD)
to provide waterproof surface for erection of
structure and vehicle maneuvering**

N.T.S

Plan Showing Filling of Land

**Goldrich Planners &
Surveyors Ltd.**

July 2024

**Lots 906 RP and 907 in D.D. 114
and Adjoining Government Land
Yuen Long, New Territories**

**Plan 8
(P 23050)**