

<p>Project 項目名稱:</p> <p>Temporary Shop and Services (Shop for Selling Vehicle Spare Parts) for a Period of 3 Years at Lot 878 (Part) in D.D.114 & Adjoining Government Land, Pat Heung, Yuen Long, N.T.</p>	<p>Drawing Title 圖目:</p> <p>Application Site</p>	<p>Remarks 備註:</p> <p>→ Vehicular access leading from Kam Sheung Road</p>
	<p>Drawing No. 圖號:</p> <p>Figure 1</p>	<p>Scale 比例:</p> <p>1:1000</p>

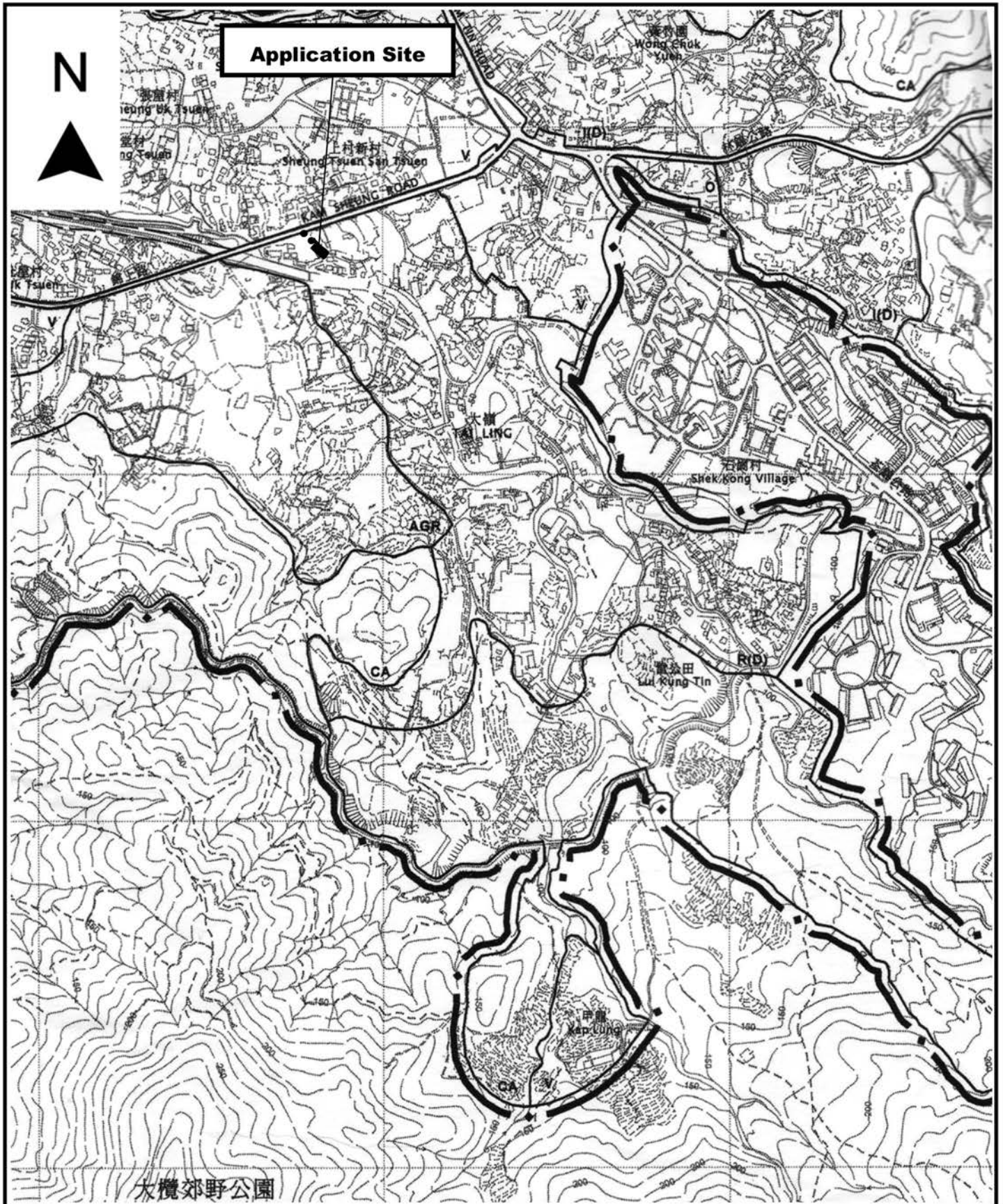

<p>Project 項目名稱: Temporary Shop and Services (Shop for Selling Vehicle Spare Parts) for a Period of 3 Years at Lot 878 (Part) in D.D.114 & Adjoining Government Land, Pat Heung, Yuen Long, N.T.</p>	<p>Drawing Title 圖目: Location Plan</p>	<p>Remarks 備註: ●●● Vehicular access leading from Kam Sheung Road</p>
	<p>Drawing No. 圖號: Figure 2</p>	<p>Scale 比例: 1:7500</p>

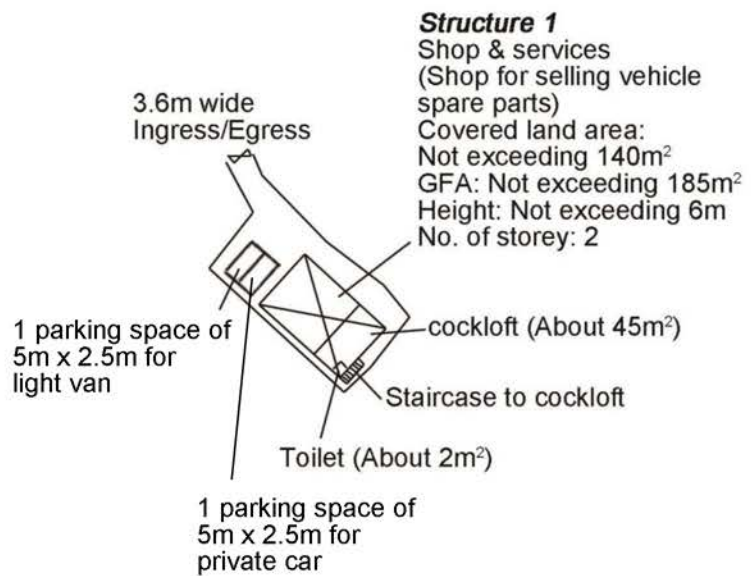

<p>Project 項目名稱:</p> <p>Temporary Shop and Services (Shop for Selling Vehicle Spare Parts) for a Period of 3 Years at Lot 878 (Part) in D.D.114 & Adjoining Government Land, Pat Heung, Yuen Long, N.T.</p>	<p>Drawing Title 圖目:</p> <p>Proposed Layout Plan</p> <p>Drawing No. 圖號:</p> <p>Figure 3</p>	<p>Remarks 備註:</p> <p>Scale 比例:</p> <p>1:1000</p>
---	---	---

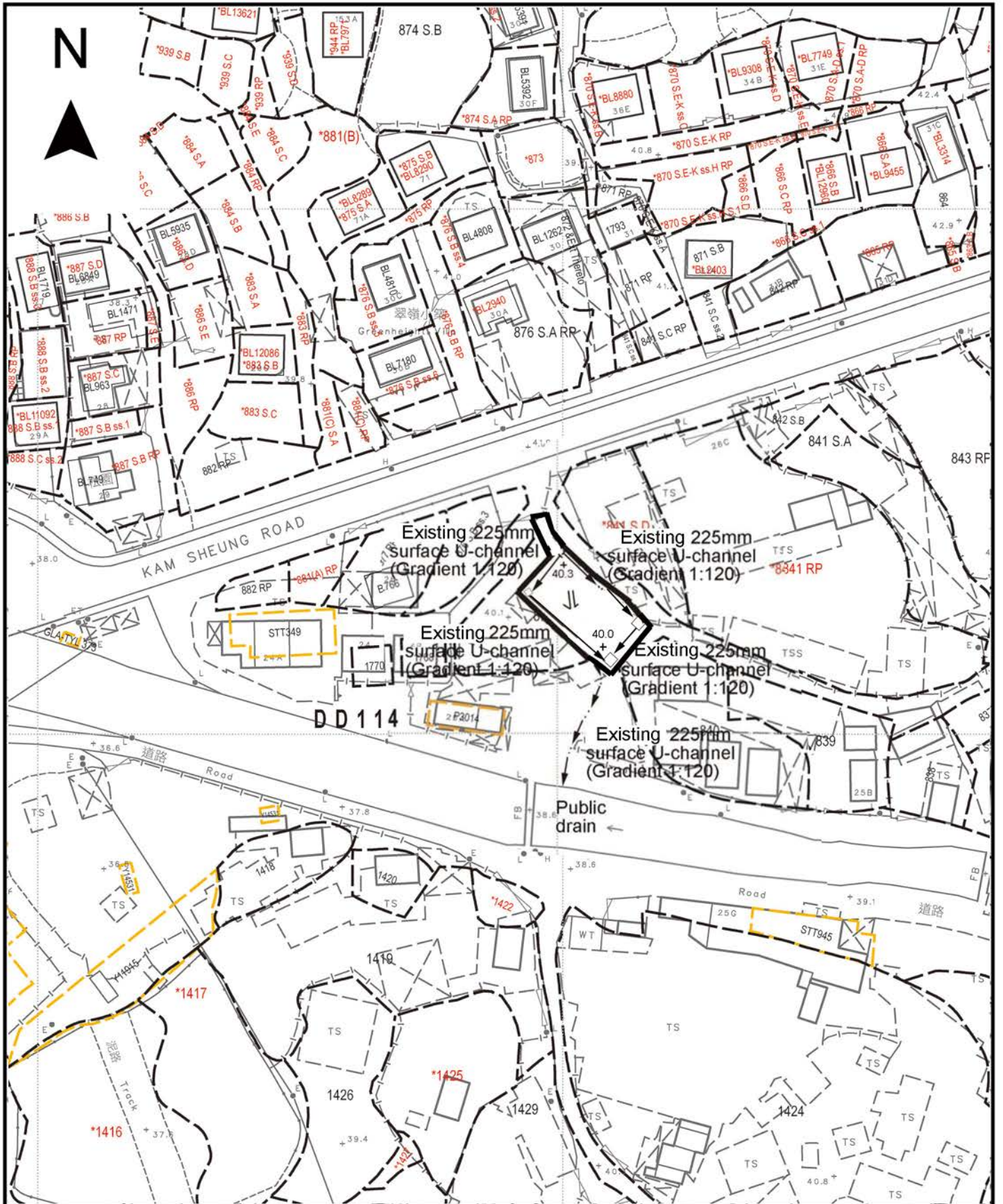

Project 項目名稱:

Temporary Shop and Services (Shop for Selling Vehicle Spare Parts) for a Period of 3 Years at Lot 878 (Part) in D.D.114 & Adjoining Government Land, Pat Heung, Yuen Long, N.T.

Drawing Title 圖目:

As-built Drainage Plan

Remarks 備註:

+40.3 Level (in mPD)

← Flow of surface runoff

□ Existing catchpit

■ Existing catchpit with sand trap

Drawing No. 圖號:

Figure 4

Scale 比例:

1:1000

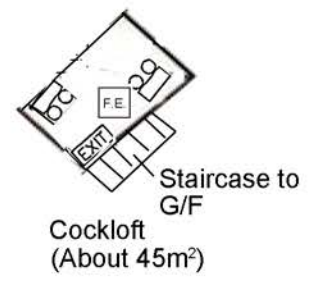
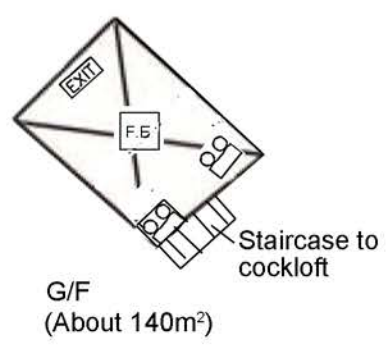
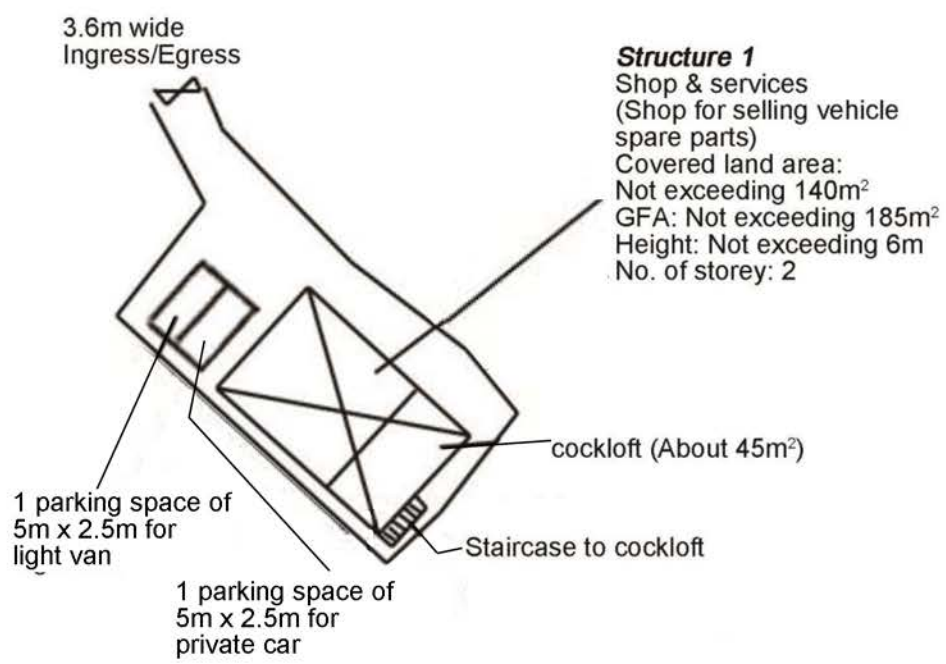

<p>Project 項目名稱: Temporary Shop and Services (Shop for Selling Vehicle Spare Parts) for a Period of 3 Years at Lot 878 (Part) in D.D.114 & Adjoining Government Land, Pat Heung, Yuen Long, N.T.</p>	<p>Drawing Title 圖目: Proposed Fire Service Installations Plan</p>	<p>Remarks 備註: 出口 Exit Sign 緊急照明燈 Emergency Light 5kg carbon dioxide fire extinguisher</p>
	<p>Drawing No. 圖號: Figure 5</p>	<p>Scale 比例: 1:500</p>