

Extracted form Approved Shek Kong Outline Zoning Plan No. S/YL-SK/9

1:1000

Location Plan

**Goldrich Planners &
Surveyors Ltd.**

July 2024

**Lot 386 S.A in D.D 112
Yuen Long, New Territories**

**Plan 1
(P 24047)**

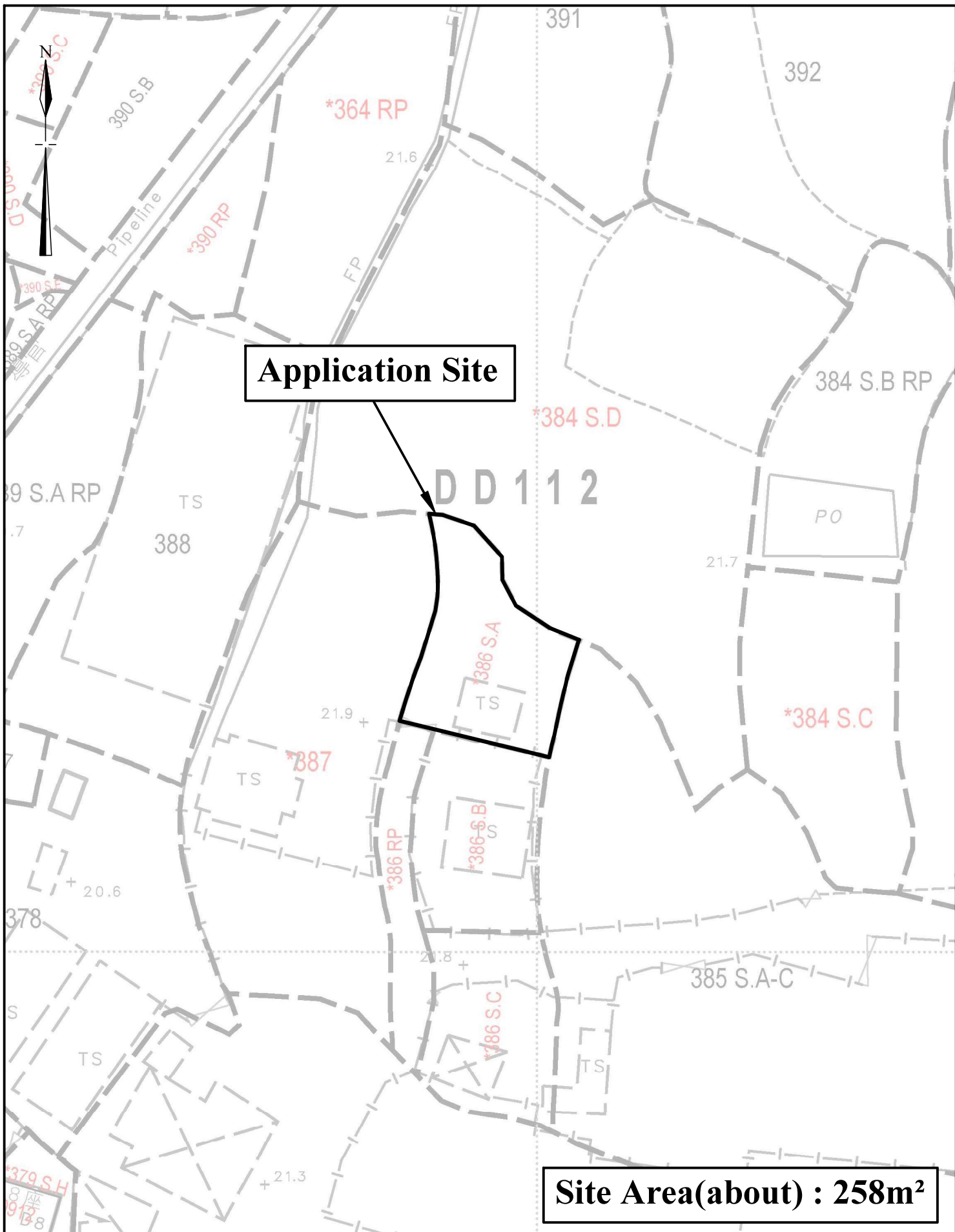

Application Site

Site Area(about) : 258m²

<p>1:500</p>	<p>Lot Index Plan</p>	<p>Goldrich Planners & Surveyors Ltd.</p>
<p>July 2024</p>	<p>Lot 386 S.A in D.D 112 Yuen Long, New Territories</p>	<p>Plan 2 (P 24047)</p>

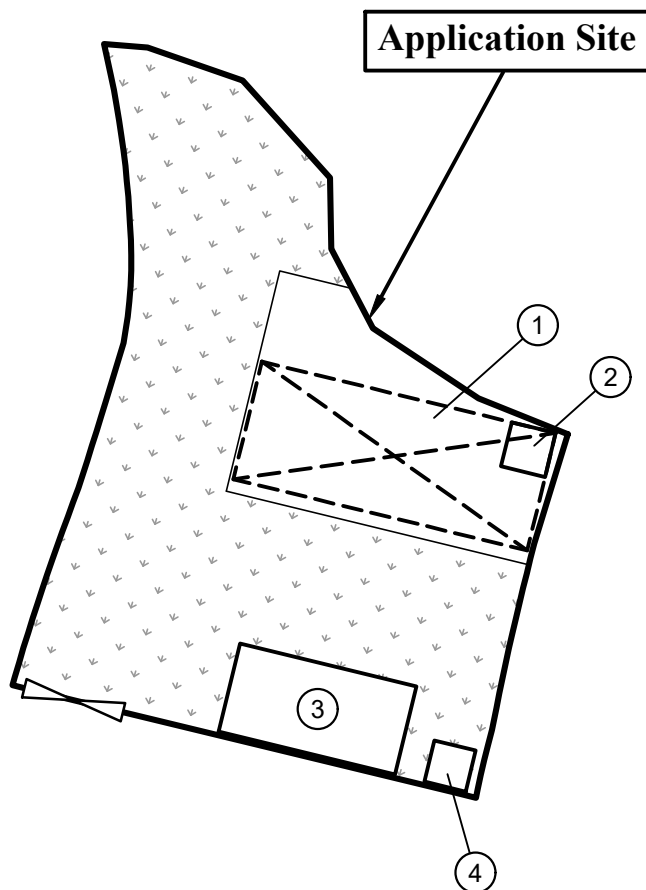

Legend

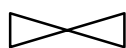

Pedestrian Ingress/ Egress



Paved Area: 82m² (32%)



Farming Area: 176m² (68%)

Site Area: 258m² (100%)

Site Area(about) : 258m²

No.	Uses	Covered Area (about)	Floor Area (about)	No. of Storeys	Height
1	Open Shed	40m ²	40m ²	1	4.5m
2	Toilet	under structure 1	under structure 1	1	3m
3	Multi-function room (Office and storage)	18m ²	36m ²	2	7m
4	Existing Meter room	<u>2m²</u>	<u>2m²</u>	1	2.3m
Total		<u>60 m²</u>	<u>78 m²</u>		

1:250

Layout Plan

Goldrich Planners & Surveyors Ltd.

November 2024

Lot 386 S.A in D.D 112
Yuen Long, New Territories

**Plan 3
(P 24047)**

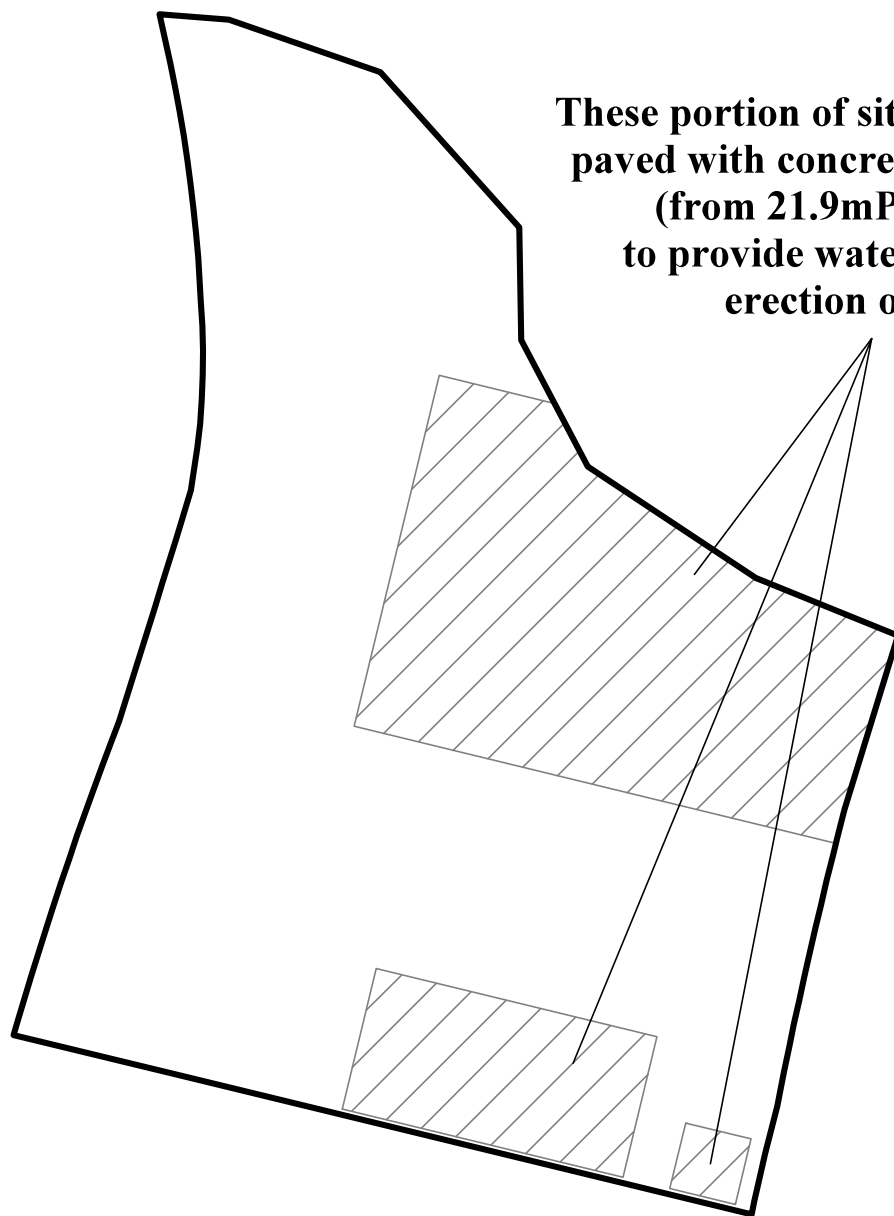

These portion of site(about 82m²) will be paved with concrete at a depth of 0.1m (from 21.9mPD to 22.0 mPD) to provide waterproof surface for erection of structures

N.T.S

Plan Showing Filling of Land

Goldrich Planners & Surveyors Ltd.

November 2024

**Lot 386 S.A in D.D 112
Yuen Long, New Territories**

**Plan 4
(P 24047)**

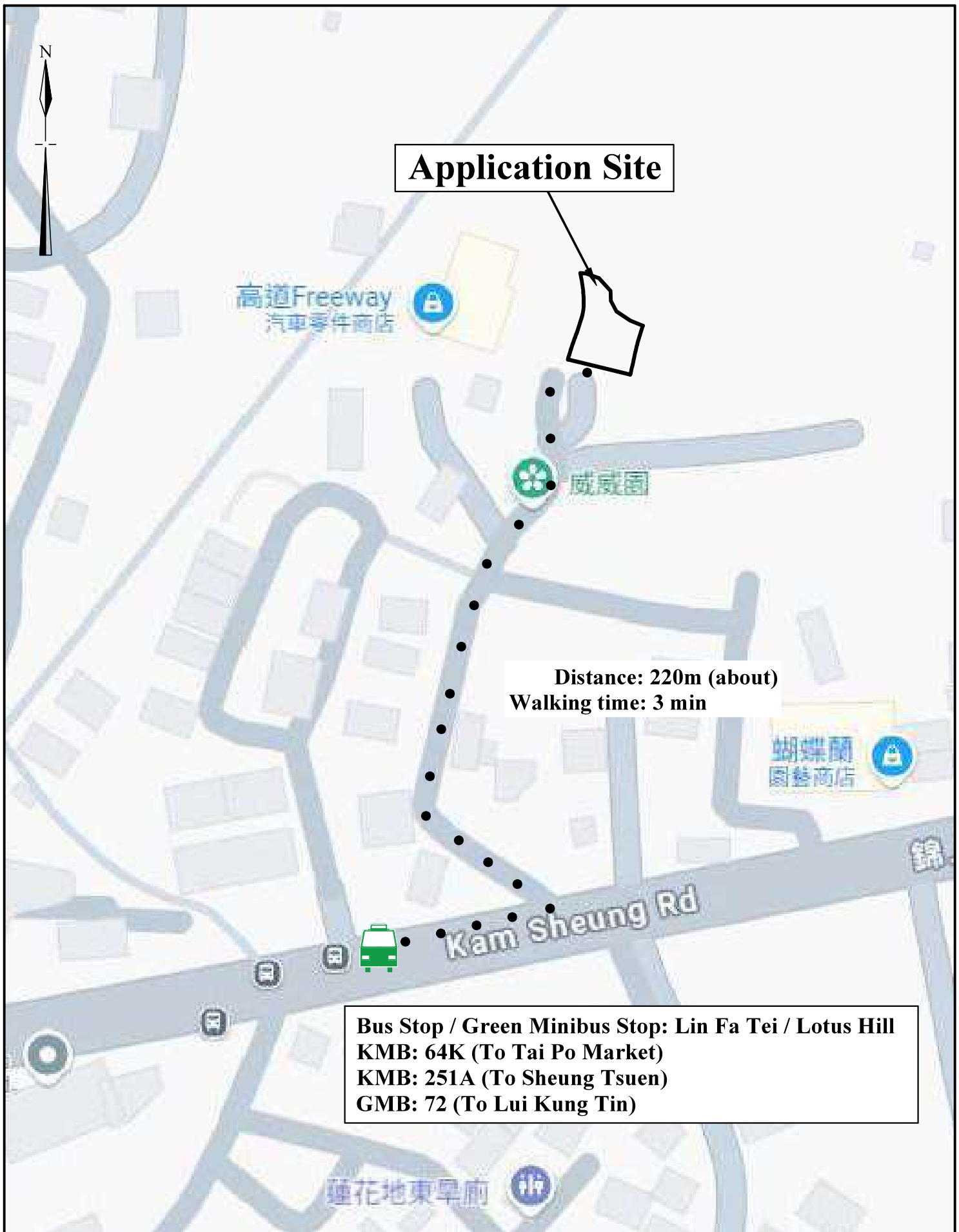

Application Site

**Distance: 220m (about)
Walking time: 3 min**

Bus Stop / Green Minibus Stop: Lin Fa Tei / Lotus Hill
KMB: 64K (To Tai Po Market)
KMB: 251A (To Sheung Tsuen)
GMB: 72 (To Lui Kung Tin)

N.T.S	Plan Showing Nearest Public Transport Services	Goldrich Planners & Surveyors Ltd.
November 2024	Lot 386 S.A in D.D 112 Yuen Long, New Territories	Plan 5 (P 24047)