

**LOCATION OF THE APPLICATION SITE**

APPLICATION SITE AREA : 2,438 m<sup>2</sup> (ABOUT)

**VEHICULAR ACCESS**

ACCESSIBLE FROM SHEK KONG AIRFIELD ROAD VIA A LOCAL ACCESS

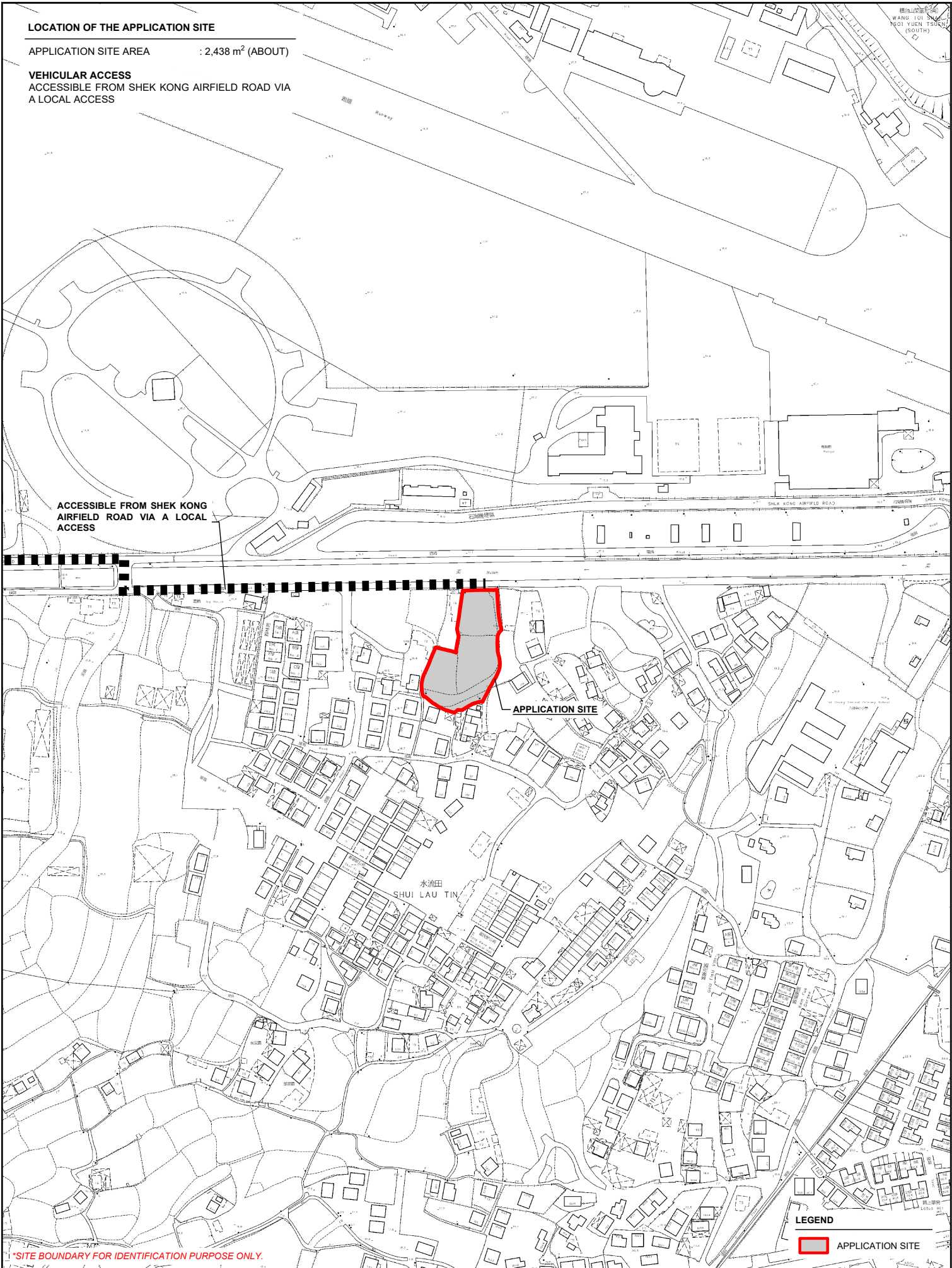

ACCESSIBLE FROM SHEK KONG AIRFIELD ROAD VIA A LOCAL ACCESS

APPLICATION SITE

水漣田  
SHUI LAU TIN

**LEGEND**

 APPLICATION SITE

\*SITE BOUNDARY FOR IDENTIFICATION PURPOSE ONLY.

	PROJECT PROPOSED TEMPORARY SHOP AND SERVICES AND PUBLIC VEHICLE PARK (EXCLUDING CONTAINER VEHICLE) FOR A PERIOD OF 5 YEARS AND ASSOCIATED FILLING OF LAND	ADDRESS LOT 593 IN D.D. 112, SHEK KONG, YUEN LONG, NEW TERRITORIES	SCALE 1 : 3000 @ A4		TITLE LOCATION PLAN	
			DRAWN BY MN	DATE 8.1.2025	DWG NO. PLAN 1	VER. 001
			REVISED BY	DATE		

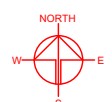

**ZONING OF THE APPLICATION SITE**

APPLICATION SITE AREA : 2,438 m<sup>2</sup> (ABOUT)  
 OUTLINE ZONING PLAN : APPROVED SHEK KONG OZP  
 OZP PLAN NO. : SYL-SK/9  
 ZONING OF THE SITE : "VILLAGE TYPE DEVELOPMENT" ("V")

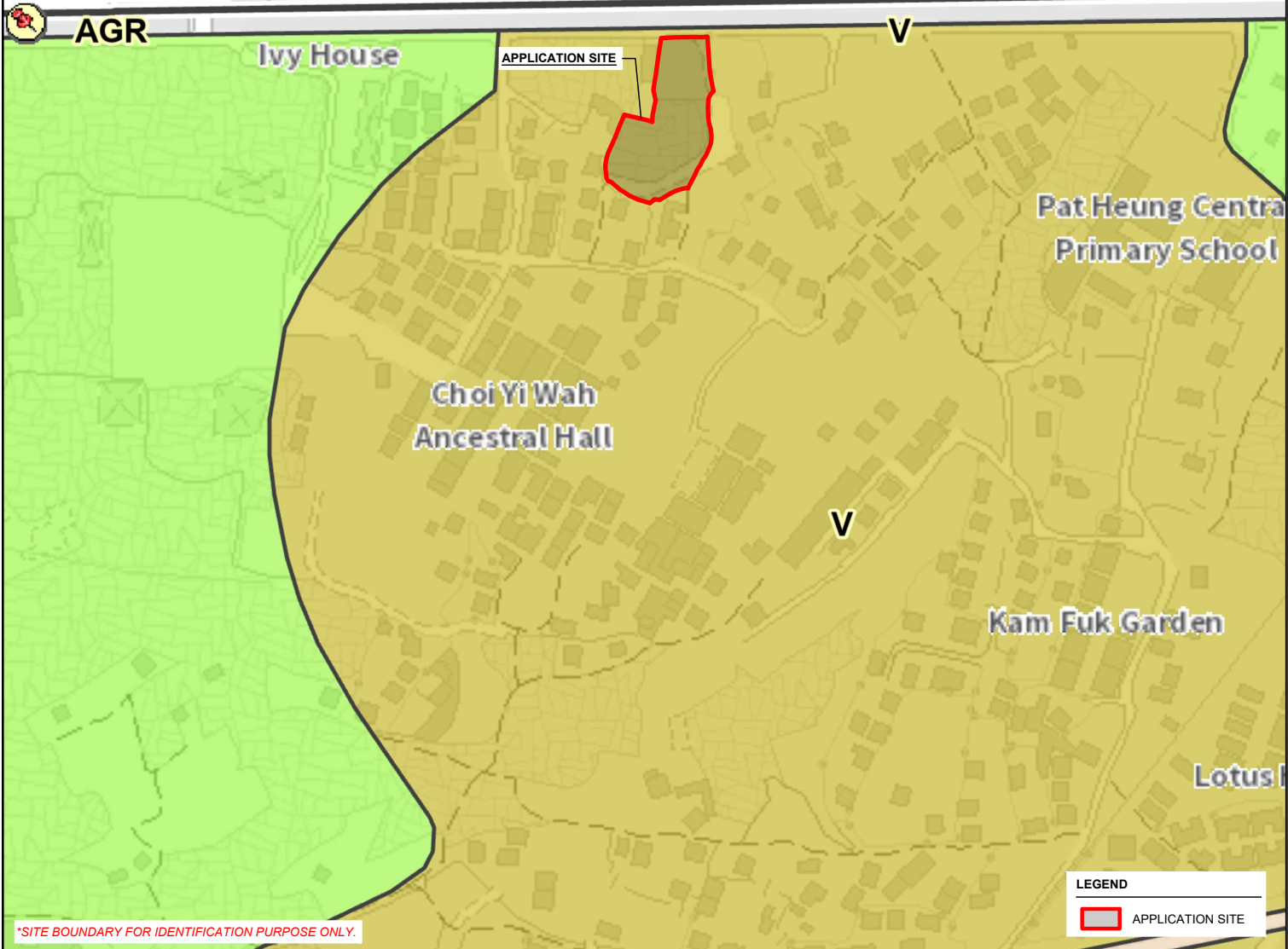
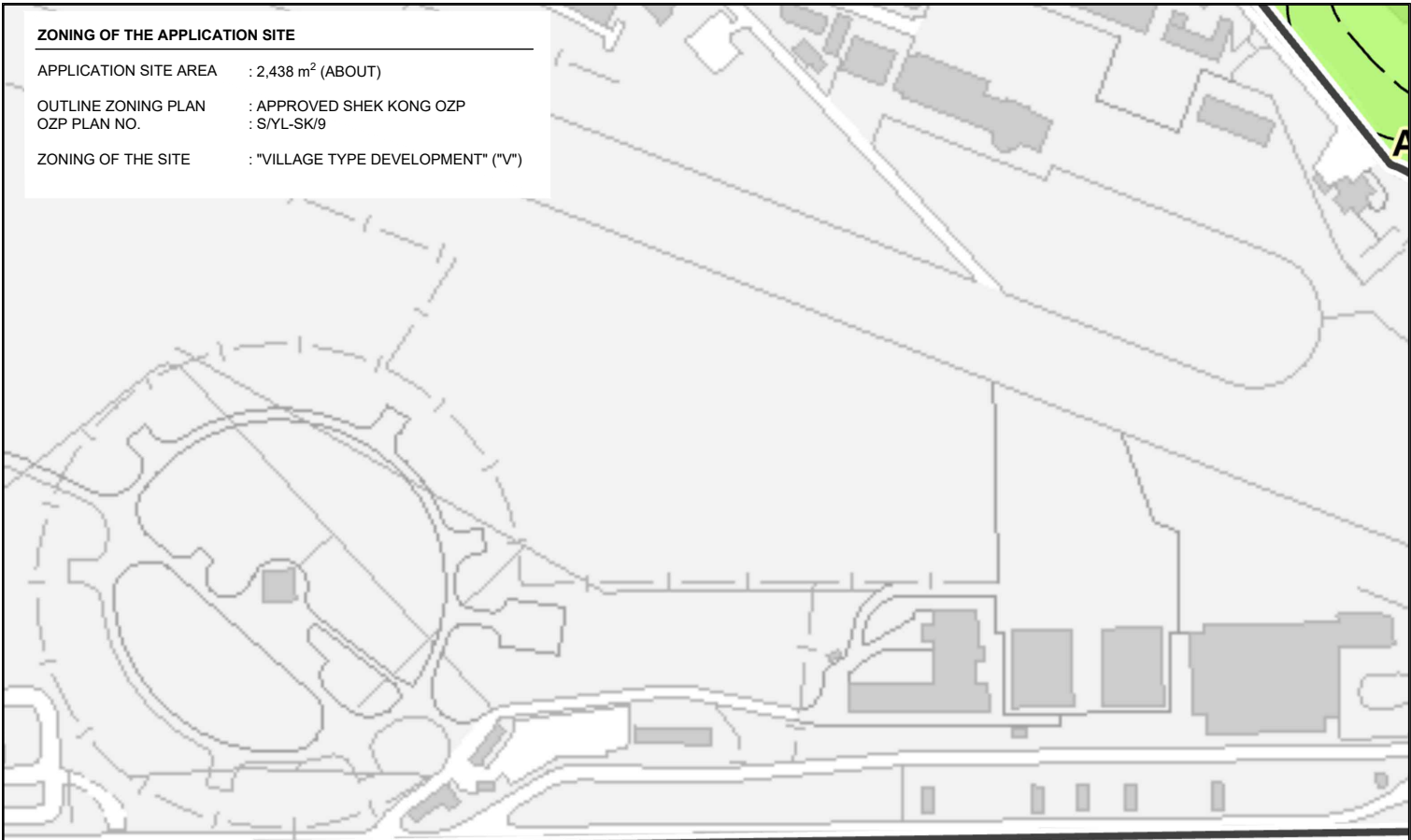

\*SITE BOUNDARY FOR IDENTIFICATION PURPOSE ONLY.

**LEGEND**

APPLICATION SITE

PLANNING CONSULTANT 	PROJECT PROPOSED TEMPORARY SHOP AND SERVICES AND PUBLIC VEHICLE PARK (EXCLUDING CONTAINER VEHICLE) FOR A PERIOD OF 5 YEARS AND ASSOCIATED FILLING OF LAND	ADDRESS LOT 593 IN D.D. 112, SHEK KONG, YUEN LONG, NEW TERRITORIES	SCALE 1 : 3000 @ A4		TITLE ZONING PLAN	
			DRAWN BY MN	DATE 8.1.2025	DWG NO. PLAN 2	VER. 001
			REVISED BY	DATE		

LAND STATUS OF THE APPLICATION SITE

APPLICATION SITE AREA : 2,438 m<sup>2</sup> (ABOUT)

AREA OF PRIVATE LAND : 2,438 m<sup>2</sup> (ABOUT)

AREA OF GOVERNMENT LAND : NOT APPLICABLE

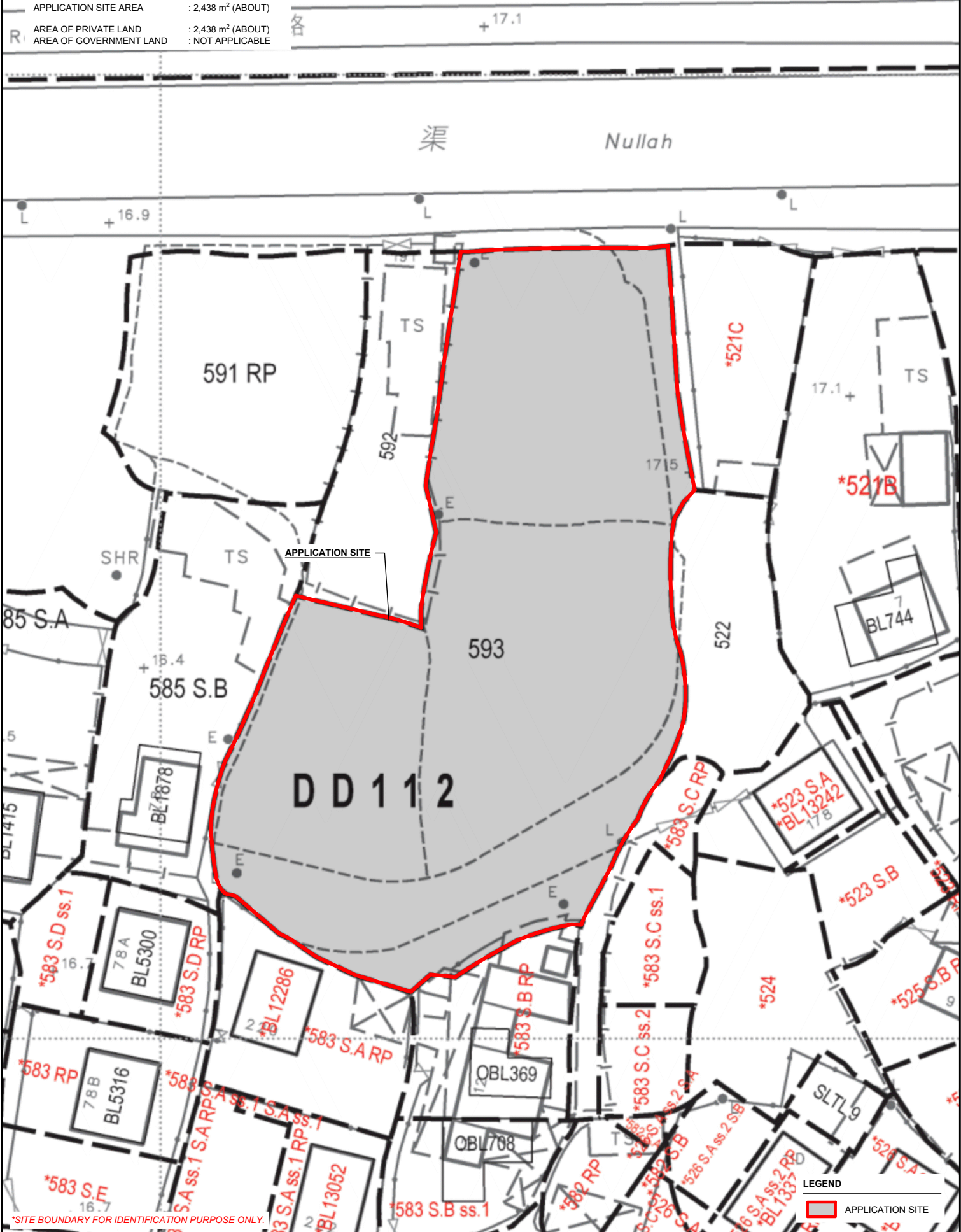

PLANNING CONSULTANT

PROJECT  
 PROPOSED TEMPORARY SHOP AND SERVICES AND PUBLIC VEHICLE PARK (EXCLUDING CONTAINER VEHICLE) FOR A PERIOD OF 5 YEARS AND ASSOCIATED FILLING OF LAND

ADDRESS  
 LOT 593 IN D.D. 112, SHEK KONG, YUEN LONG, NEW TERRITORIES

SCALE  
 1 : 500 @ A4

DRAWN BY  
 MN

DATE  
 8.1.2025

REVISED BY  
 DATE

TITLE  
 LAND STATUS

DWG NO.  
 PLAN 3

VER.  
 001

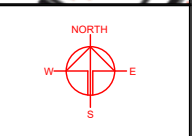

**DEVELOPMENT PARAMETERS**

APPLICATION SITE AREA	: 2,438 m <sup>2</sup>	(ABOUT)
COVERED AREA	: 246 m <sup>2</sup>	(ABOUT)
UNCOVERED AREA	: 2,192 m <sup>2</sup>	(ABOUT)
PLOT RATIO	: 0.19	(ABOUT)
SITE COVERAGE	: 10 %	(ABOUT)
NO. OF STRUCTURE	: 3	
DOMESTIC GFA	: NOT APPLICABLE	
NON-DOMESTIC GFA	: 462 m <sup>2</sup>	(ABOUT)
TOTAL GFA	: 462 m <sup>2</sup>	(ABOUT)
BUILDING HEIGHT	: 7 m	(ABOUT)
NO. OF STOREY	: 2	

STRUCTURE	USE	COVERED AREA	GROSS FLOOR AREA	BUILDING HEIGHT
B1	SHOP AND SERVICES OFFICE AND WASHROOM	82 m <sup>2</sup> (ABOUT)*	154 m <sup>2</sup> (ABOUT)	7 m (ABOUT)(2-STOREY)
B2	SHOP AND SERVICES OFFICE AND WASHROOM	82 m <sup>2</sup> (ABOUT)*	154 m <sup>2</sup> (ABOUT)	7 m (ABOUT)(2-STOREY)
B3	SHOP AND SERVICES OFFICE AND WASHROOM	82 m <sup>2</sup> (ABOUT)*	154 m <sup>2</sup> (ABOUT)	7 m (ABOUT)(2-STOREY)
<b>TOTAL</b>		<b>246 m<sup>2</sup> (ABOUT)</b>	<b>462 m<sup>2</sup> (ABOUT)</b>	

\* COVERED AREA OF STRUCTURE: 72m<sup>2</sup>(ENCLOSED) + 10m<sup>2</sup> (STAIRCASES) = 82 m<sup>2</sup> (ABOUT)  
 GFA OF STRUCTURE: 82m<sup>2</sup> (G/F) + 72 m<sup>2</sup> (1/F) = 154 m<sup>2</sup> (ABOUT)

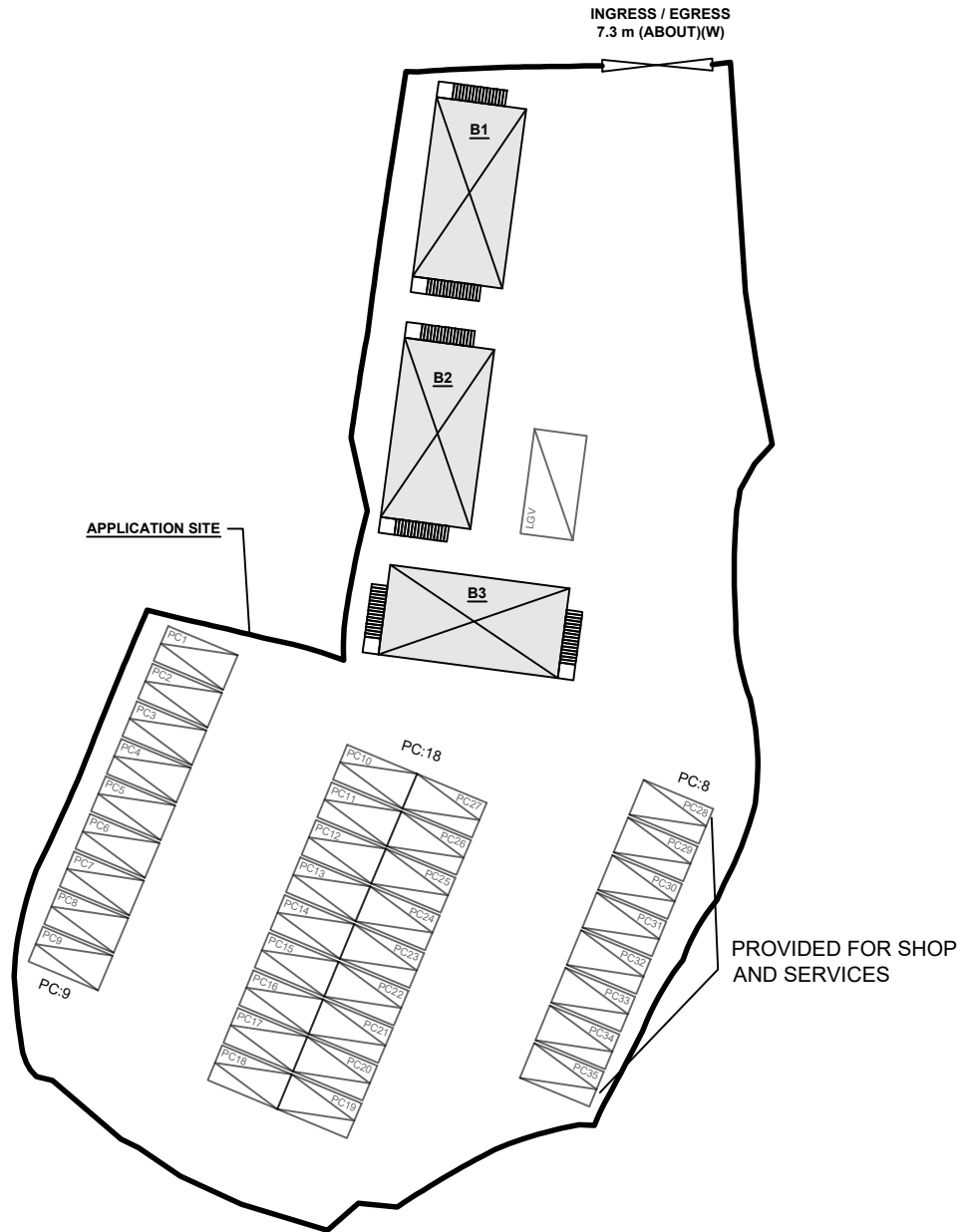

PROVIDED FOR SHOP AND SERVICES

**PARKING PROVISIONS**

NO. OF PRIVATE CAR PARKING SPACE	: 35
DIMENSION OF PARKING SPACE	: 5 m (L) X 2.5 m (W)
NO. OF LIGHT GOODS VEHICLE PARKING SPACE	: 1
DIMENSION OF PARKING SPACE	: 7 m (L) X 3.5 m (W)

**LEGEND**

- APPLICATION SITE
- STRUCTURE
- PARKING SPACE (PC)
- L/V SPACE (LGV)
- INGRESS / EGRESS

PLANNING CONSULTANT 	PROJECT PROPOSED TEMPORARY SHOP AND SERVICES AND PUBLIC VEHICLE PARK (EXCLUDING CONTAINER VEHICLE) FOR A PERIOD OF 5 YEARS AND ASSOCIATED FILLING OF LAND	ADDRESS LOT 593 IN D.D. 112, SHEK KONG, YUEN LONG, NEW TERRITORIES	SCALE 1 : 500 @ A4		TITLE LAYOUT PLAN	
			DRAWN BY MN	DATE 8.1.2025	DWG NO. PLAN 4	VER. 001
				REVISED BY	DATE	

**EXISTING CONDITION OF THE APPLICATION SITE**

APPLICATION SITE AREA	: 2,438 m <sup>2</sup>	(ABOUT)
EXISTING SITE SURFACE	: SOILED GROUND AND HARD-PAVED	
EXISTING SITE LEVELS	: +16.4 mPD TO +16.5 mPD	(ABOUT)
AREA OF SOILED GROUND	: 1,909 m <sup>2</sup>	(ABOUT)
AREA OF HARD-PAVED AREA	: 529 m <sup>2</sup>	(ABOUT)

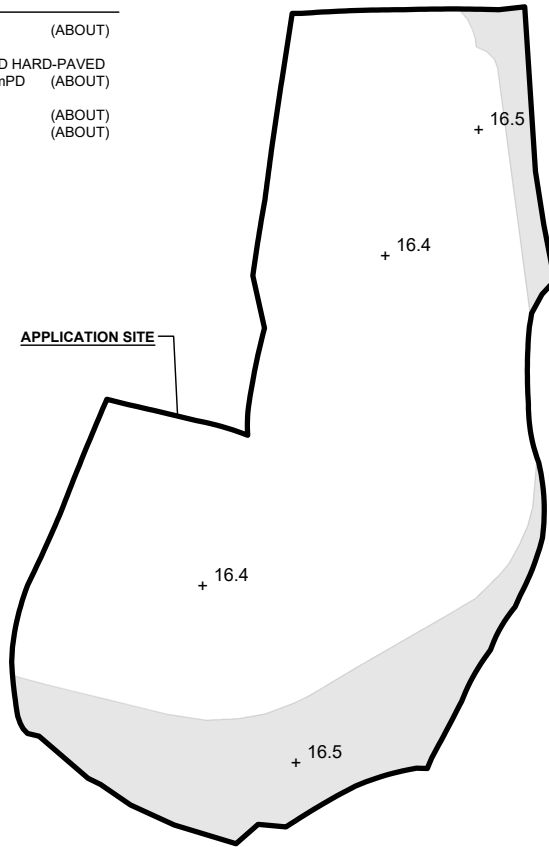

**EXISTING SITE LEVEL OF THE APPLICATION SITE**  
(INDICATIVE ONLY)

**LEGEND**

- APPLICATION SITE
- HARD-PAVED AREA
- SOILED GROUND AREA
- + 16.4 EXISTING SITE LEVEL

**PROPOSED FILLING OF LAND AREA OF THE APPLICATION SITE**

APPLICATION SITE AREA	: 2,438 m <sup>2</sup>	(ABOUT)
PROPOSED FILLING OF LAND AREA	: 2,438 m <sup>2</sup>	(ABOUT)
DEPTH OF LAND FILLING	: NOT MORE THAN 0.2 m	
PROPOSED SITE LEVELS	: +16.6 mPD	(ABOUT)
MATERIAL OF LAND FILLING	: CONCRETE	
PURPOSE OF LAND FILLING	: SITE FORMATION OF STRUCTURE, CIRCULATION SPACE	

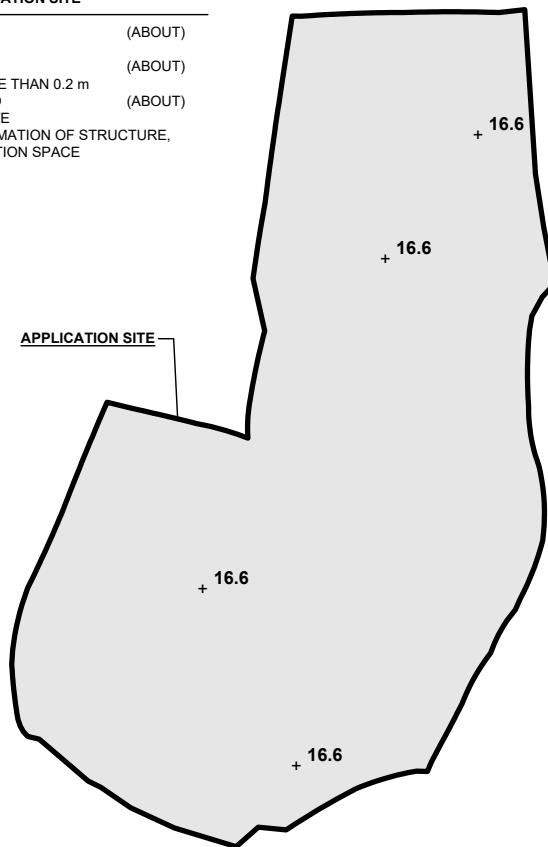

**PROPOSED SITE LEVEL OF THE APPLICATION SITE**  
(INDICATIVE ONLY)

**LEGEND**

- APPLICATION SITE
- FILLING OF LAND AREA
- + 16.6 PROPOSED SITE LEVEL

\*SITE LEVELS ARE FOR REFERENCE ONLY.

	PROJECT PROPOSED TEMPORARY SHOP AND SERVICES AND PUBLIC VEHICLE PARK (EXCLUDING CONTAINER VEHICLE) FOR A PERIOD OF 5 YEARS AND ASSOCIATED FILLING OF LAND	ADDRESS LOT 593 IN D.D. 112, SHEK KONG, YUEN LONG, NEW TERRORIES	SCALE 1 : 700 @ A4		NORTH  SOUTH
			TITLE FILLING OF LAND	DRAWN BY MN	

**SWEPT PATH ANALYSIS**

TYPE OF VEHICLE : LIGHT GOODS VEHICLE  
 DIMENSION OF VEHICLE : 2.1 m (W) X 5.2 m (L)

SWEPT PATHS GENERATED BY AUTODESK VEHICLE TRACKING  
 1000

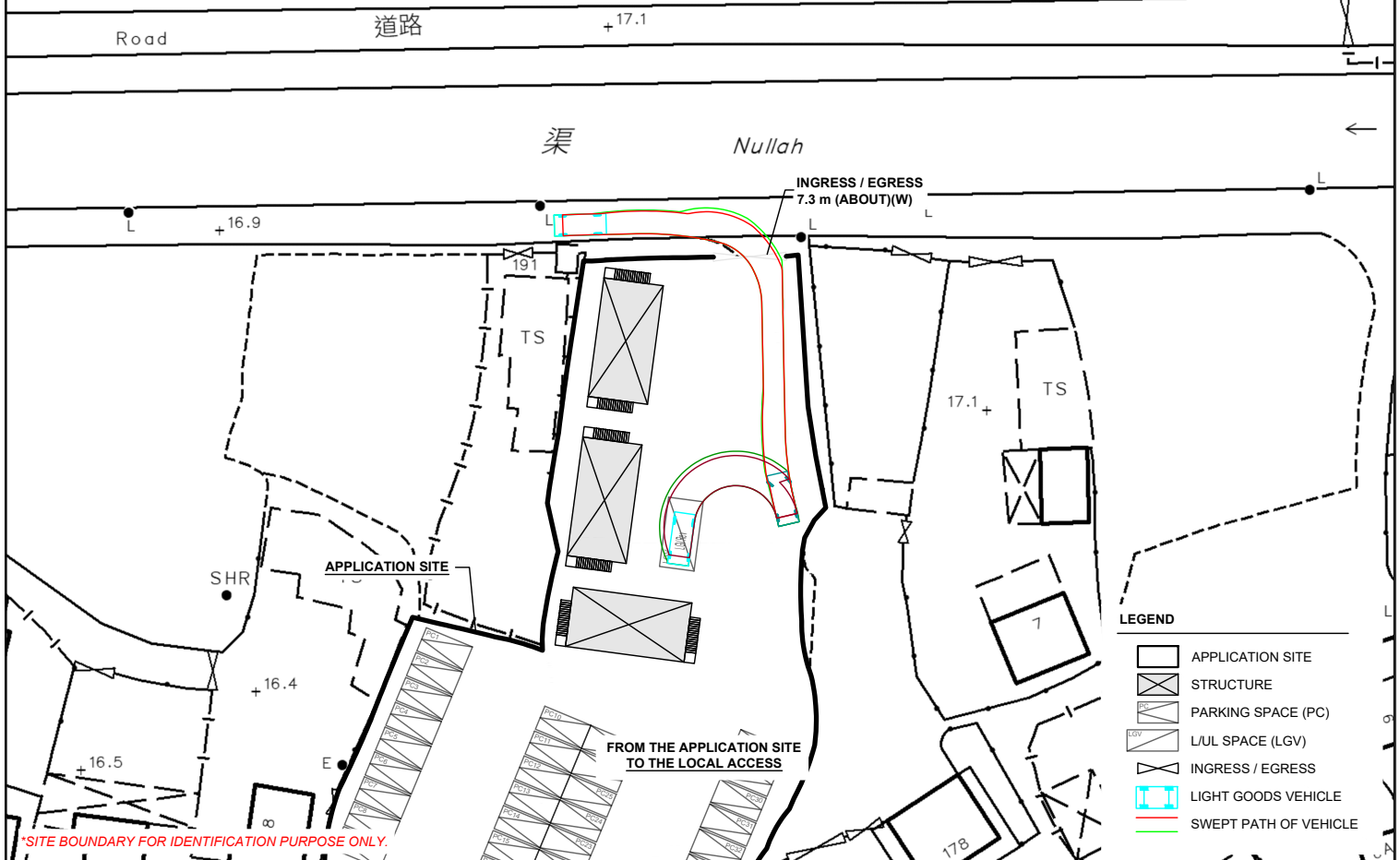
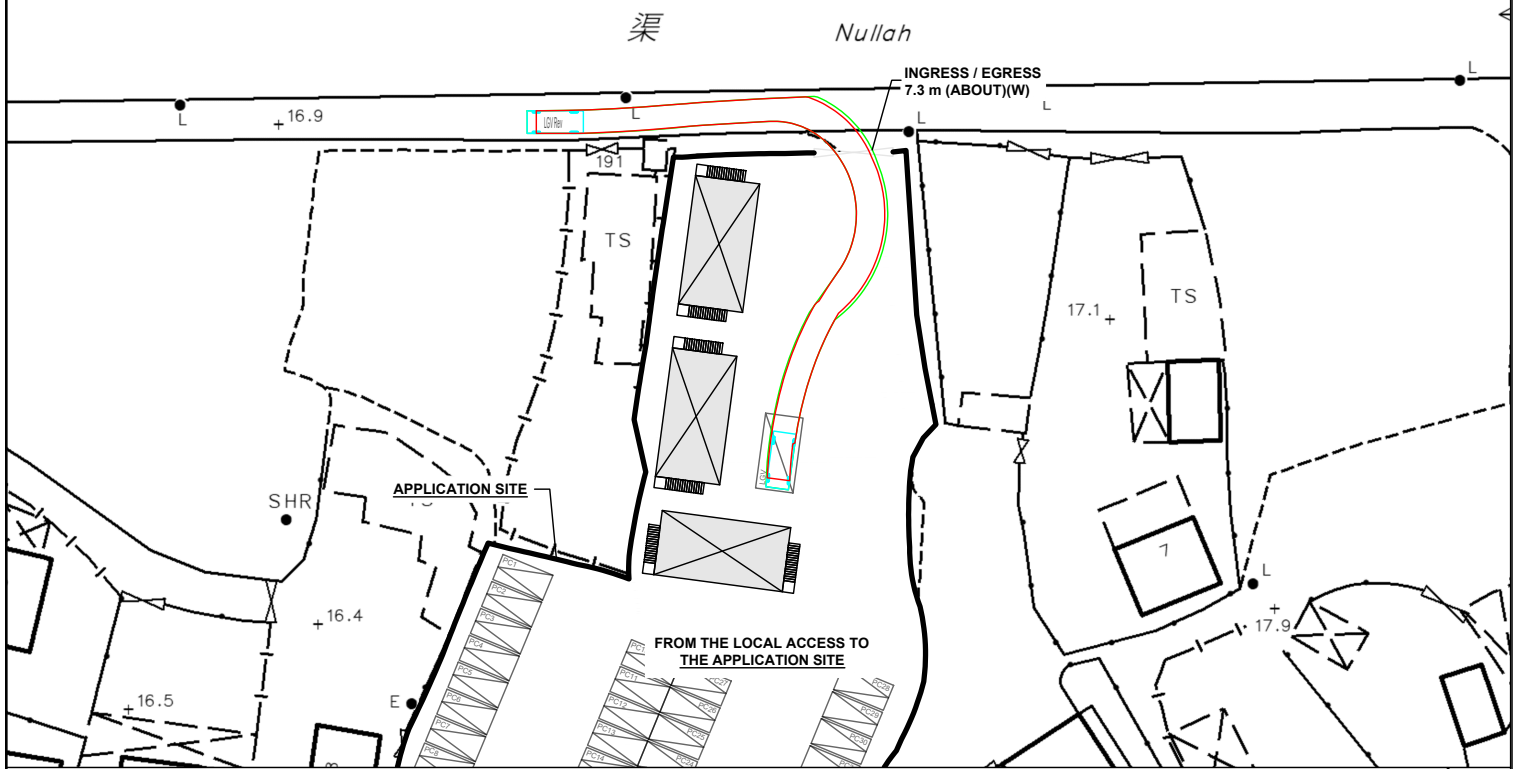

- LEGEND**
- APPLICATION SITE
  - STRUCTURE
  - PARKING SPACE (PC)
  - L/U/L SPACE (LGV)
  - INGRESS / EGRESS
  - LIGHT GOODS VEHICLE
  - SWEEP PATH OF VEHICLE

\*SITE BOUNDARY FOR IDENTIFICATION PURPOSE ONLY.

	PROJECT PROPOSED TEMPORARY SHOP AND SERVICES AND PUBLIC VEHICLE PARK (EXCLUDING CONTAINER VEHICLE) FOR A PERIOD OF 5 YEARS AND ASSOCIATED FILLING OF LAND	ADDRESS LOT 593 IN D.D. 112, SHEK KONG, YUEN LONG, NEW TERRITORIES	SCALE 1 : 700 @ A4	TITLE SWEPT PATH ANALYSIS (LGV)		
			DRAWN BY MN	DATE 8.1.2025		
			REVISED BY	DATE		DWG NO. PLAN 6
						VER. 001

**SWEPT PATH ANALYSIS**

TYPE OF VEHICLE : PRIVATE CAR  
 DIMENSION OF VEHICLE : 1.7 m (W) X 4.6 m (L)

SWEPT PATHS GENERATED BY AUTODESK VEHICLE TRACKING

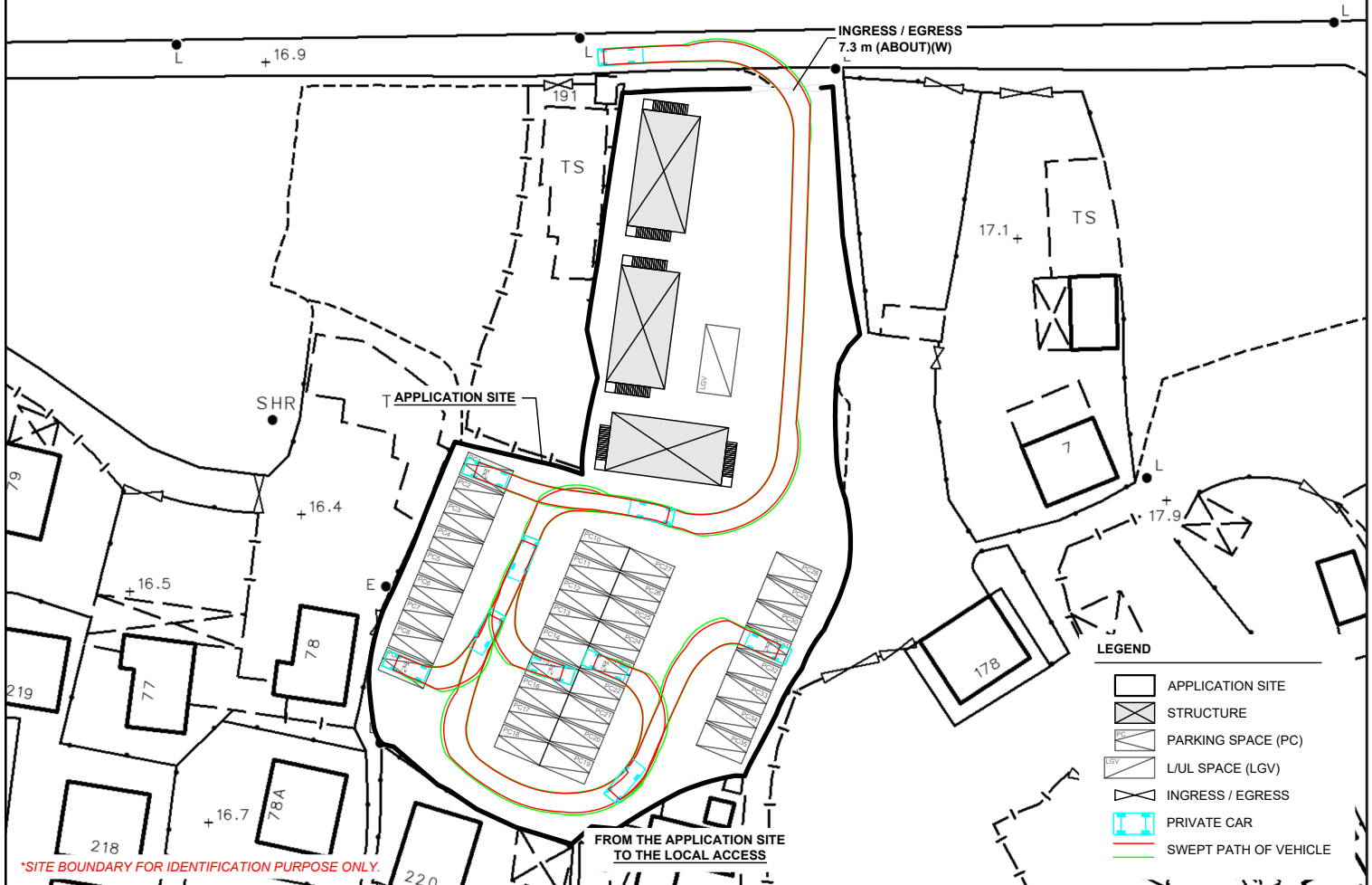
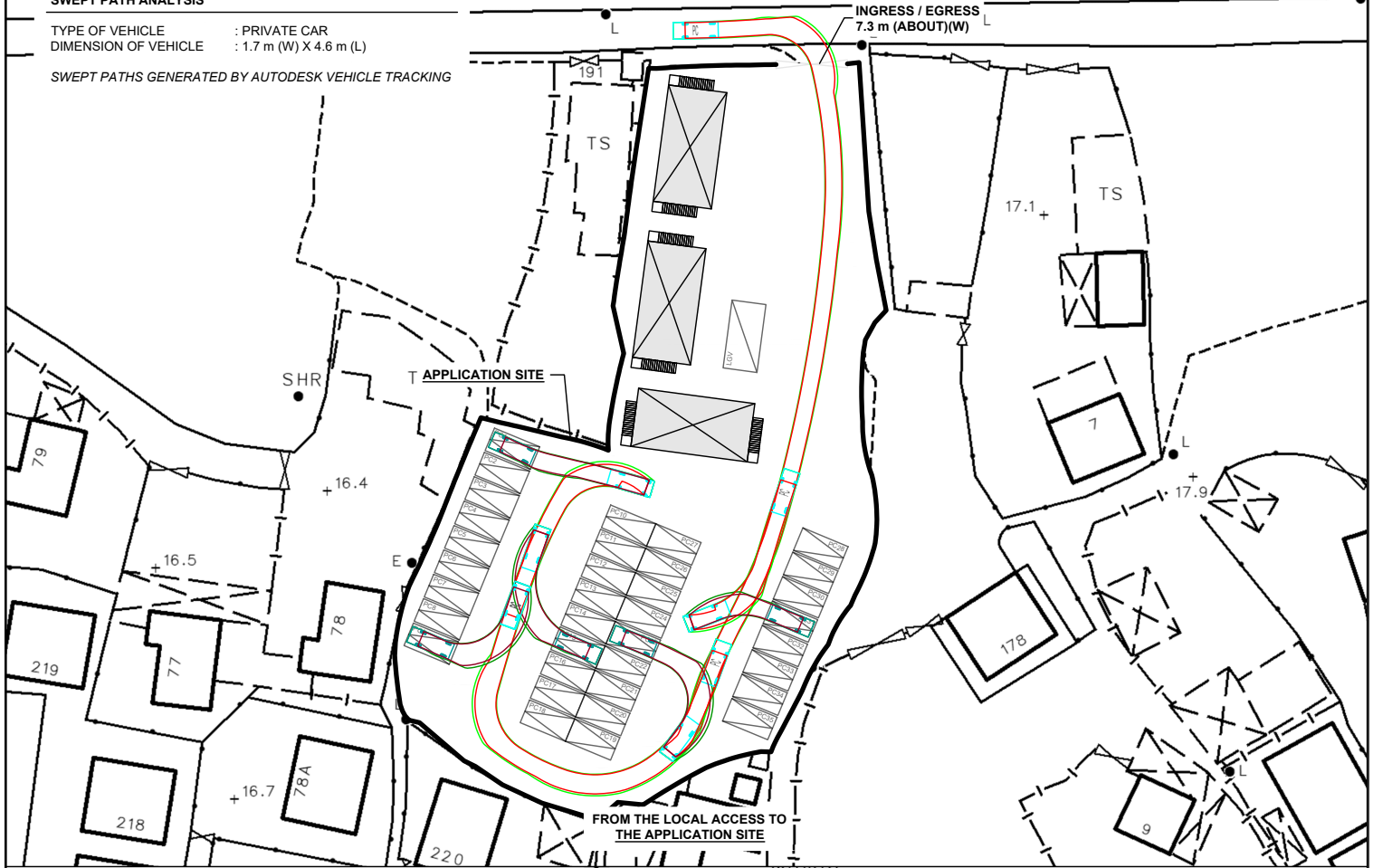

\*SITE BOUNDARY FOR IDENTIFICATION PURPOSE ONLY.

PLANNING CONSULTANT 	PROJECT PROPOSED TEMPORARY SHOP AND SERVICES AND PUBLIC VEHICLE PARK (EXCLUDING CONTAINER VEHICLE) FOR A PERIOD OF 5 YEARS AND ASSOCIATED FILLING OF LAND	ADDRESS LOT 593 IN D.D. 112, SHEK KONG, YUEN LONG, NEW TERRITORIES	SCALE 1 : 700 @ A4		TITLE SWEPT PATH ANALYSIS (PC)	
			DRAWN BY MN	DATE 8.1.2025	DWG NO. PLAN 7	VER. 001

