

LOCATION OF THE APPLICATION SITE

APPLICATION SITE AREA : 166 m² (ABOUT)

VEHICULAR ACCESS

ACCESSIBLE FROM TAI SHU HA ROAD EAST VIA A LOCAL ACCESS

ACCESSIBLE FROM TAI SHU HA ROAD EAST VIA A LOCAL ACCESS

APPLICATION SITE

崇山新村
SUNG SHAN NEW VILLAGE

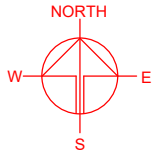

PLANNING CONSULTANT



PROJECT

PROPOSED ANIMAL ESTABLISHMENT WITH ANCILLARY FACILITIES FOR A PERIOD OF 5 YEARS AND ASSOCIATED FILLING OF LAND
TEMPORARY BOARDING WITH ANCILLARY FACILITIES FOR A PERIOD OF 5 YEARS AND ASSOCIATED FILLING OF LAND

SITE LOCATION

LOT 1756 (PART) IN D.D. 118, TAI TONG, YUEN LONG, NEW TERRITORIES

SCALE
1: 1000 @ A4

DRAWN BY: MN DATE: 17.6.2024

REVISED BY: DATE:

APPROVED BY: DATE:

DWG. TITLE
LOCATION PLAN

DWG. NO.: PLAN 1 VER.: 001

LEGEND

 APPLICATION SITE

*SITE BOUNDARY FOR IDENTIFICATION PURPOSE ONLY

ZONING OF THE APPLICATION SITE

APPLICATION SITE AREA : 166 m² (ABOUT)
 OUTLINE ZONING PLAN : APPROVED TAI TONG OZP
 OZP PLAN NO. : S/YL-TT/20
 ZONING OF THE SITE : "AGRICULTURE" ("AGR")

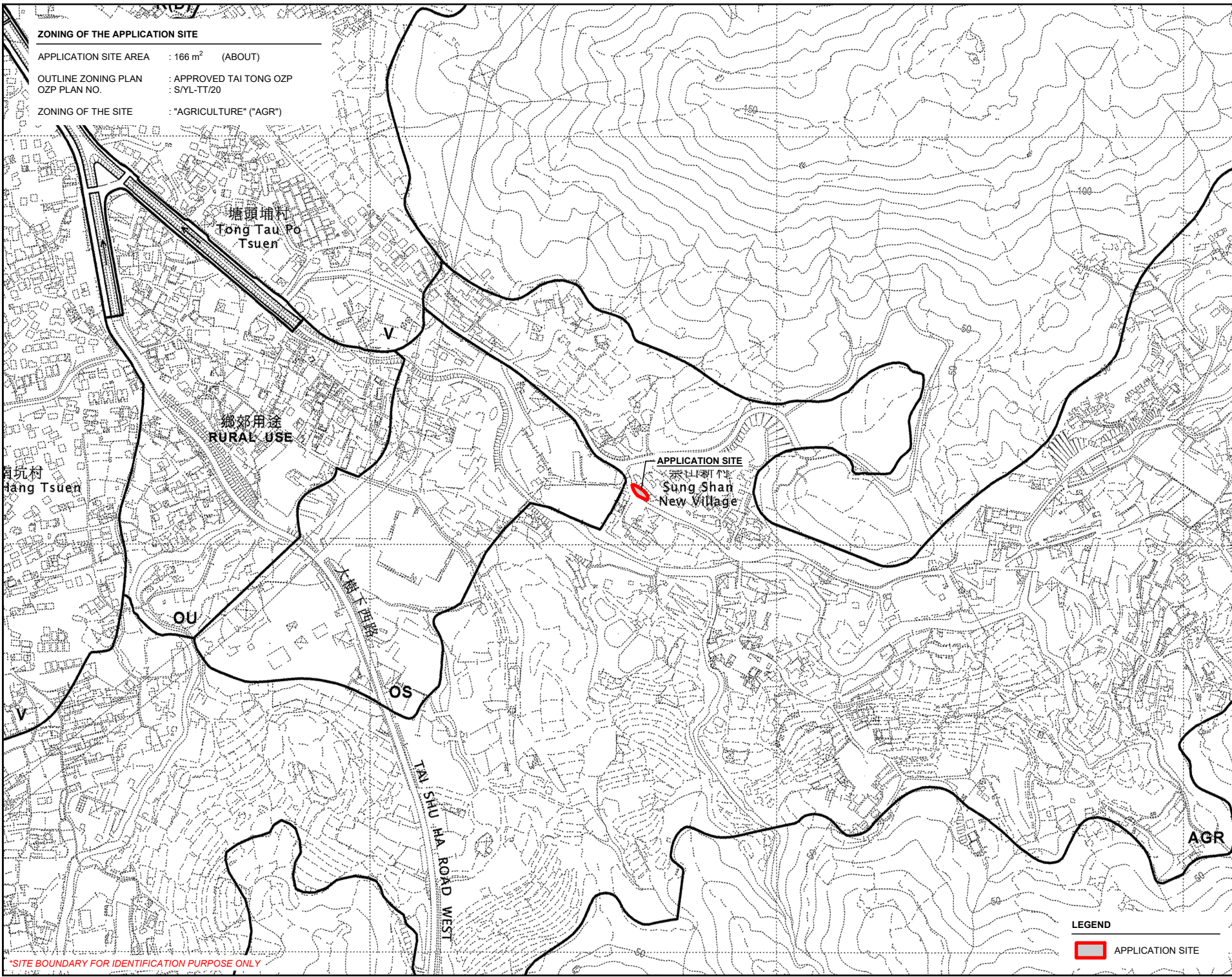
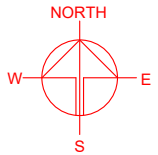

*SITE BOUNDARY FOR IDENTIFICATION PURPOSE ONLY

LEGEND

APPLICATION SITE

PLANNING CONSULTANT	
PROJECT	
PROPOSED ANIMAL ESTABLISHMENT WITH ANCILLARY FACILITIES FOR A PERIOD OF 5 YEARS AND ASSOCIATED FILLING OF LAND	TEMPORARY BOARDING WITH ANCILLARY FACILITIES FOR A PERIOD OF 5 YEARS AND ASSOCIATED FILLING OF LAND
SITE LOCATION	
LOT 1756 (PART) IN D.D. 118, TAI TONG, YUEN LONG, NEW TERRITORIES	
SCALE	
1 : 6000 @ A4	
DRAWN BY	DATE
MN	17.6.2024
REVISED BY	DATE
APPROVED BY	DATE
DWG. TITLE	
ZONING OF THE SITE	
DWG. NO.	VER.
PLAN 2	001

LAND STATUS OF THE APPLICATION SITE

APPLICATION SITE AREA : 166 m² (ABOUT)
 AREA OF PRIVATE LAND : 166 m² (ABOUT)
 AREA OF GOVERNMENT LAND : NOT APPLICABLE

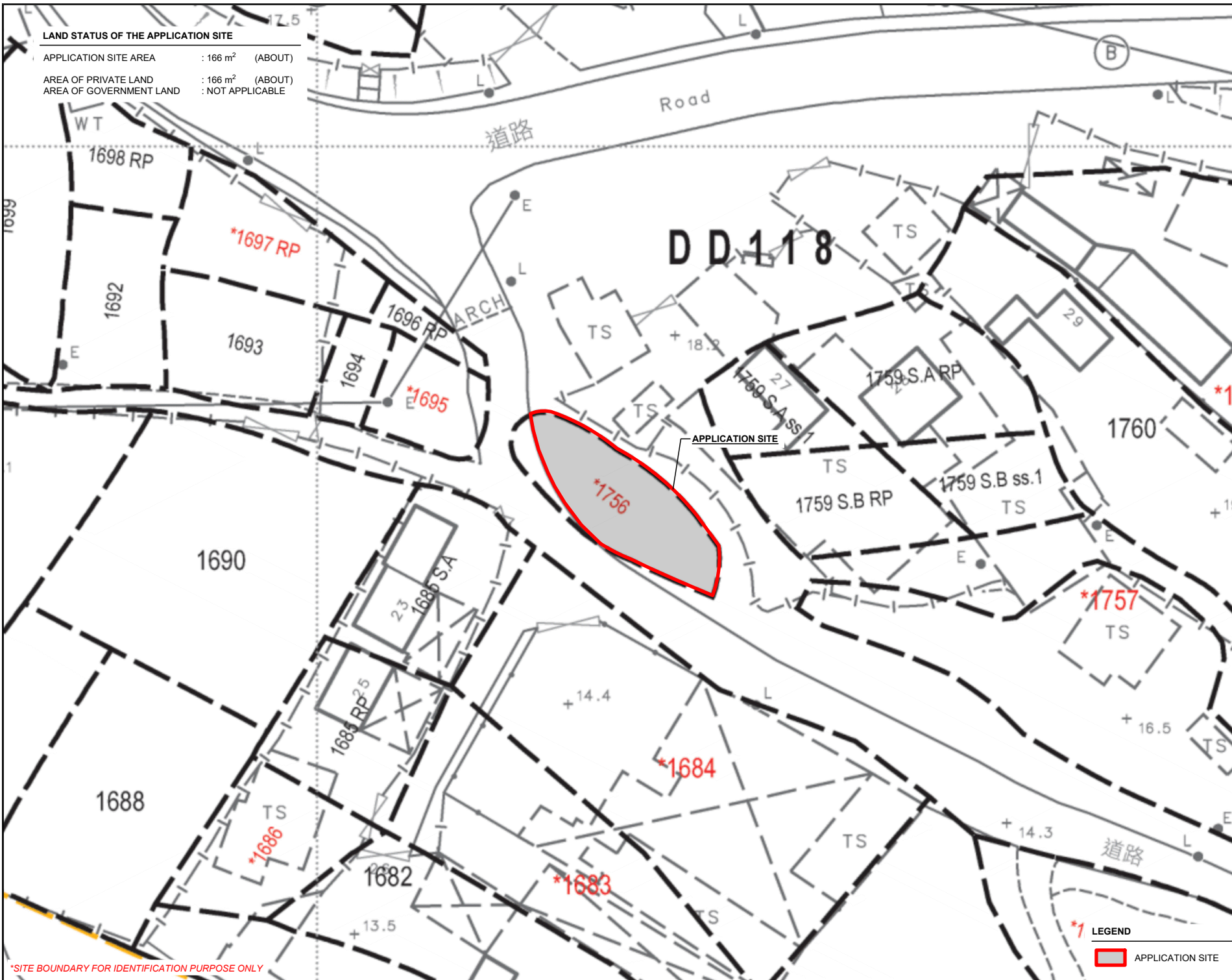
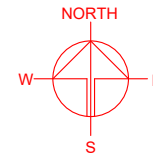

*SITE BOUNDARY FOR IDENTIFICATION PURPOSE ONLY

LEGEND
 APPLICATION SITE

PLANNING CONSULTANT



PROJECT

PROPOSED ANIMAL BOARDING ESTABLISHMENT WITH ANCILLARY FACILITIES FOR A PERIOD OF 5 YEARS AND ASSOCIATED FILLING OF LAND

SITE LOCATION

LOT 1756 (PART) IN D.D. 118, TAI TONG, YUEN LONG, NEW TERRITORIES

SCALE
 1 : 500 @ A4

DRAWN BY: MN DATE: 17.6.2024

REVISED BY: DATE:

APPROVED BY: DATE:

DWG. TITLE
 LAND STATUS OF THE SITE

DWG. NO.: PLAN 3 VER.: 001

DEVELOPMENT PARAMETERS

APPLICATION SITE AREA	: 166 m ²	(ABOUT)
COVERED AREA	: 112 m ²	(ABOUT)
UNCOVERED AREA	: 54 m ²	(ABOUT)
PLOT RATIO	: 1.35	(ABOUT)
SITE COVERAGE	: 67 %	(ABOUT)
NO. OF STRUCTURE	: 1	
DOMESTIC GFA	: NOT APPLICABLE	
NON-DOMESTIC GFA	: 224 m ²	(ABOUT)
TOTAL GFA	: 224 m ²	(ABOUT)
BUILDING HEIGHT	: 7 m	(ABOUT)
NO. OF STOREY	: 2	

STRUCTURE	USE	COVERED AREA	GFA	BUILDING HEIGHT
B1	ANIMAL BOARDING ESTABLISHMENT SITE OFFICE AND WASHROOM	112 m ² (ABOUT)	224 m ² (ABOUT)	7 m (ABOUT)(2-STOREY)
TOTAL		112 m² (ABOUT)	224 m² (ABOUT)	

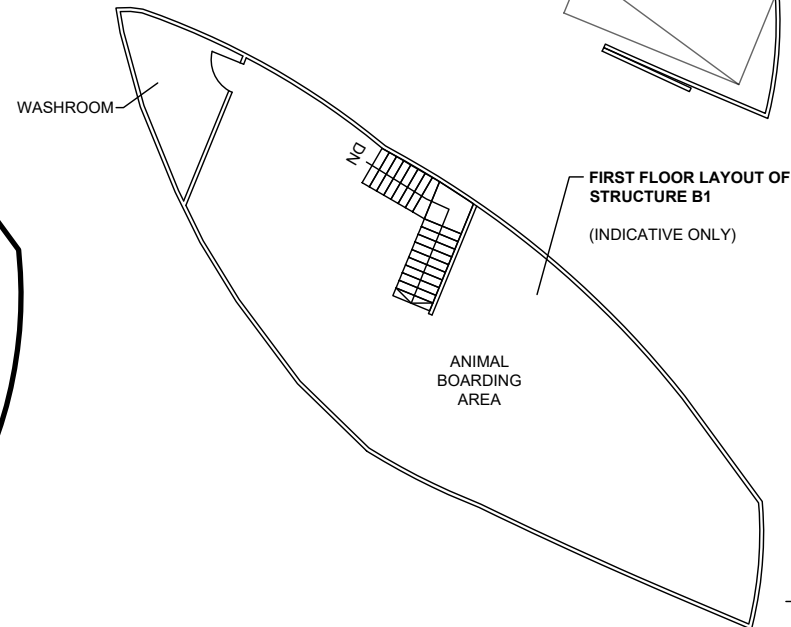
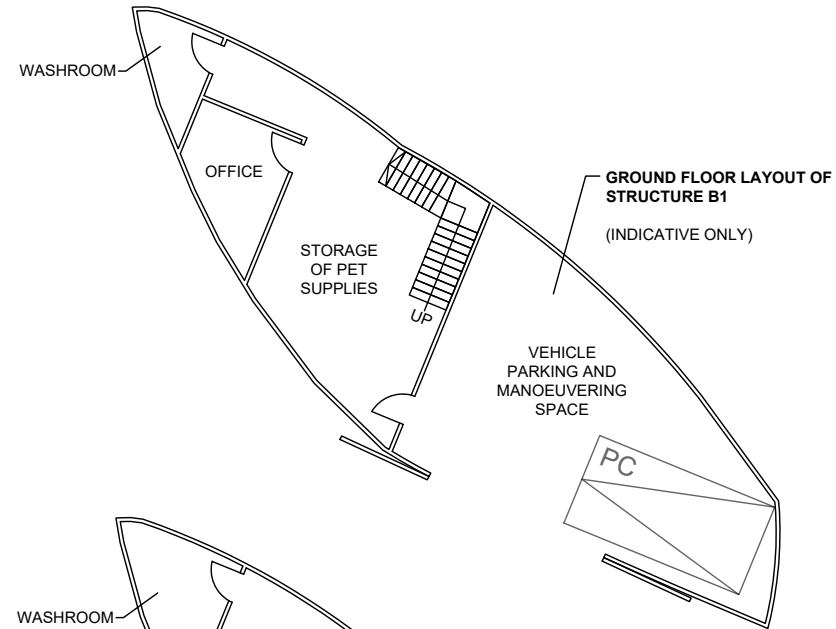
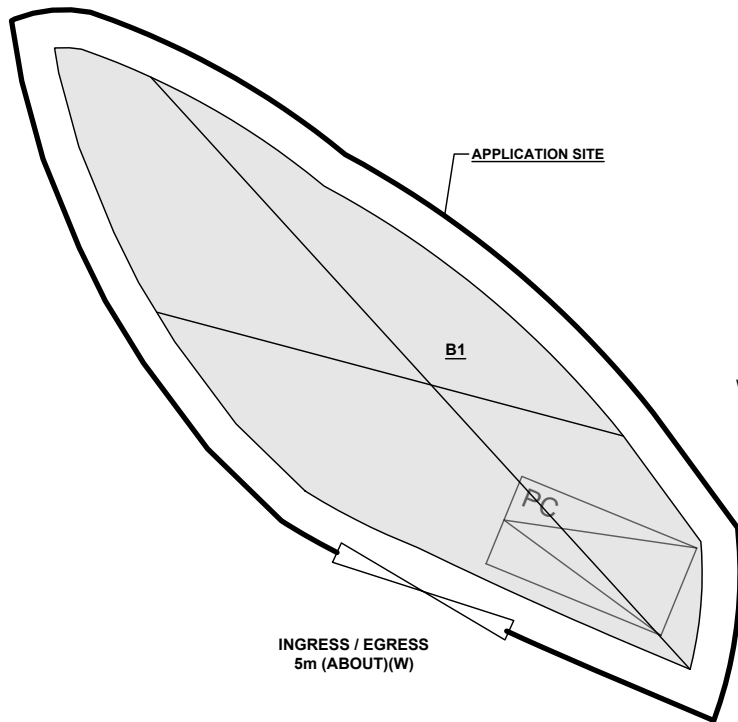
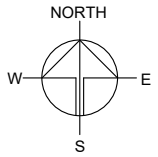

PARKING PROVISIONS

NO. OF PRIVATE CAR PARKING SPACE	: 1
DIMENSION OF PARKING SPACE	: 5 m (L) x 2.5 m (W)

LEGEND

	APPLICATION SITE
	STRUCTURE
	PARKING SPACE (PC)
	INGRESS / EGRESS

PLANNING CONSULTANT



PROJECT

PROPOSED ANIMAL BOARDING ESTABLISHMENT WITH ANCILLARY FACILITIES FOR A PERIOD OF 5 YEARS AND ASSOCIATED FILLING OF LAND

TEMPORARY BOARDING ESTABLISHMENT WITH ANCILLARY FACILITIES FOR A PERIOD OF 5 YEARS AND ASSOCIATED FILLING OF LAND

SITE LOCATION

LOT 1756 (PART) IN D.D. 118, TAI TONG, YUEN LONG, NEW TERRITORIES

SCALE

1 : 200 @ A4

DRAWN BY: MN DATE: 3.7.2024

REVISED BY: DATE:

APPROVED BY: DATE:

DWG. TITLE
LAYOUT PLAN

DWG NO.: PLAN 4 VER.: 001

EXISTING CONDITION OF THE APPLICATION SITE

APPLICATION SITE AREA : 166 m² (ABOUT)
 SOILED GROUND AREA : 166 m² (ABOUT)
 EXISTING SITE LEVEL : +16.5 mPD TO +16.6 mPD (ABOUT)

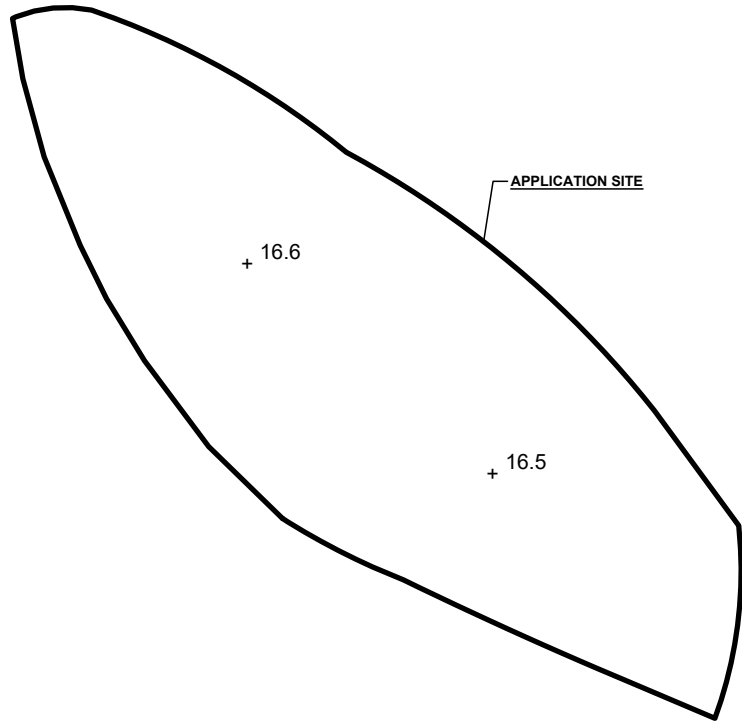

LEGEND

- APPLICATION SITE
- EXISTING SOILED GROUND
- +16.6 SITE LEVEL

SITE LEVELS ARE FOR REFERENCE ONLY.

PROPOSED FILLING OF LAND AT THE APPLICATION SITE

APPLICATION SITE AREA : 166 m² (ABOUT)
 COVERED BY STRUCTURE : 112 m² (ABOUT)
 PROPOSED LAND FILLING AREA : 166 m² (ABOUT)
 DEPTH OF LAND FILLING : NOT MORE THAN 0.2 m
 PROPOSED SITE LEVELS : +16.7 mPD TO +16.8 mPD (ABOUT)
 MATERIAL OF LAND FILLING : CONCRETE
 USE : SITE FORMATION OF STRUCTURES, AND CIRCULATION SPACE

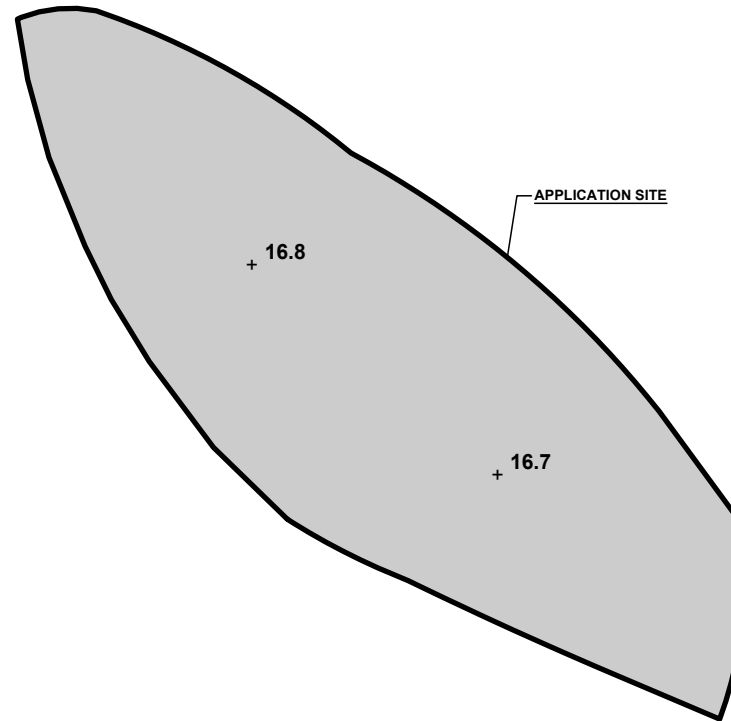

LEGEND

- APPLICATION SITE
- PROPOSED HARD-PAVED AREA
- +16.8 SITE LEVEL

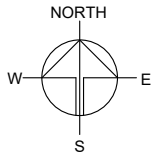

PLANNING CONSULTANT



PROJECT

PROPOSED ANIMAL ESTABLISHMENT WITH ANCILLARY FACILITIES FOR A PERIOD OF 5 YEARS AND ASSOCIATED FILLING OF LAND
 TEMPORARY BOARDING WITH ANCILLARY FACILITIES FOR A PERIOD OF 5 YEARS AND ASSOCIATED FILLING OF LAND

SITE LOCATION

LOT 1756 (PART) IN D.D. 118, TAI TONG, YUEN LONG, NEW TERRITORIES

SCALE

1 : 200 @ A4

DRAWN BY MN	DATE 17.6.2024
----------------	-------------------

REVISED BY	DATE
------------	------

APPROVED BY	DATE
-------------	------

DWG. TITLE
FILLING OF LAND

DWG. NO. PLAN 5	VER. 001
--------------------	-------------

SWEPT PATH ANALYSIS

TYPE OF VEHICLE : PRIVATE CAR
 DIMENSION OF VEHICLE : 1.7 m (W) X 4.6 m (L)

SWEPT PATHS GENERATED BY AUTODESK VEHICLE TRACKING

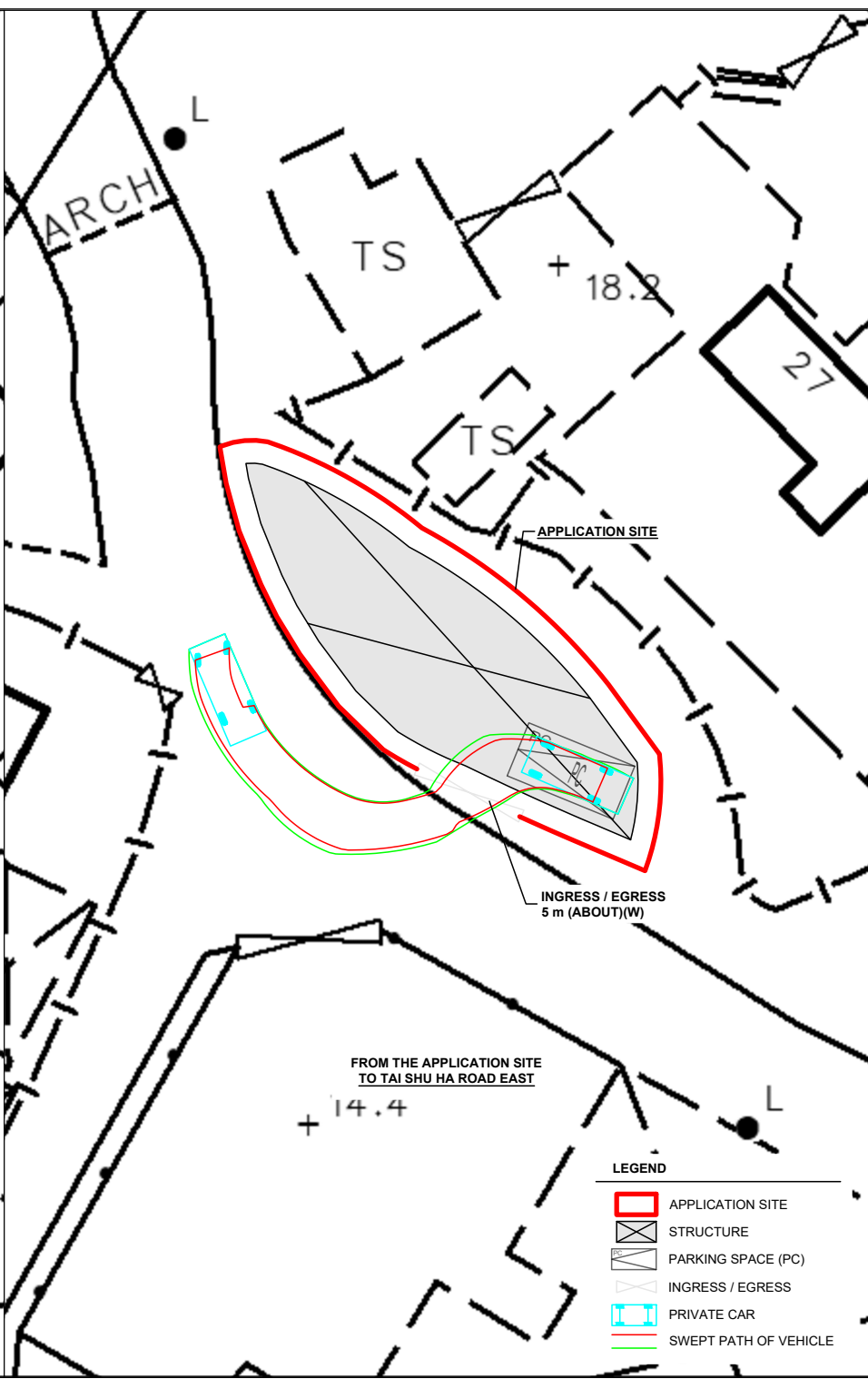
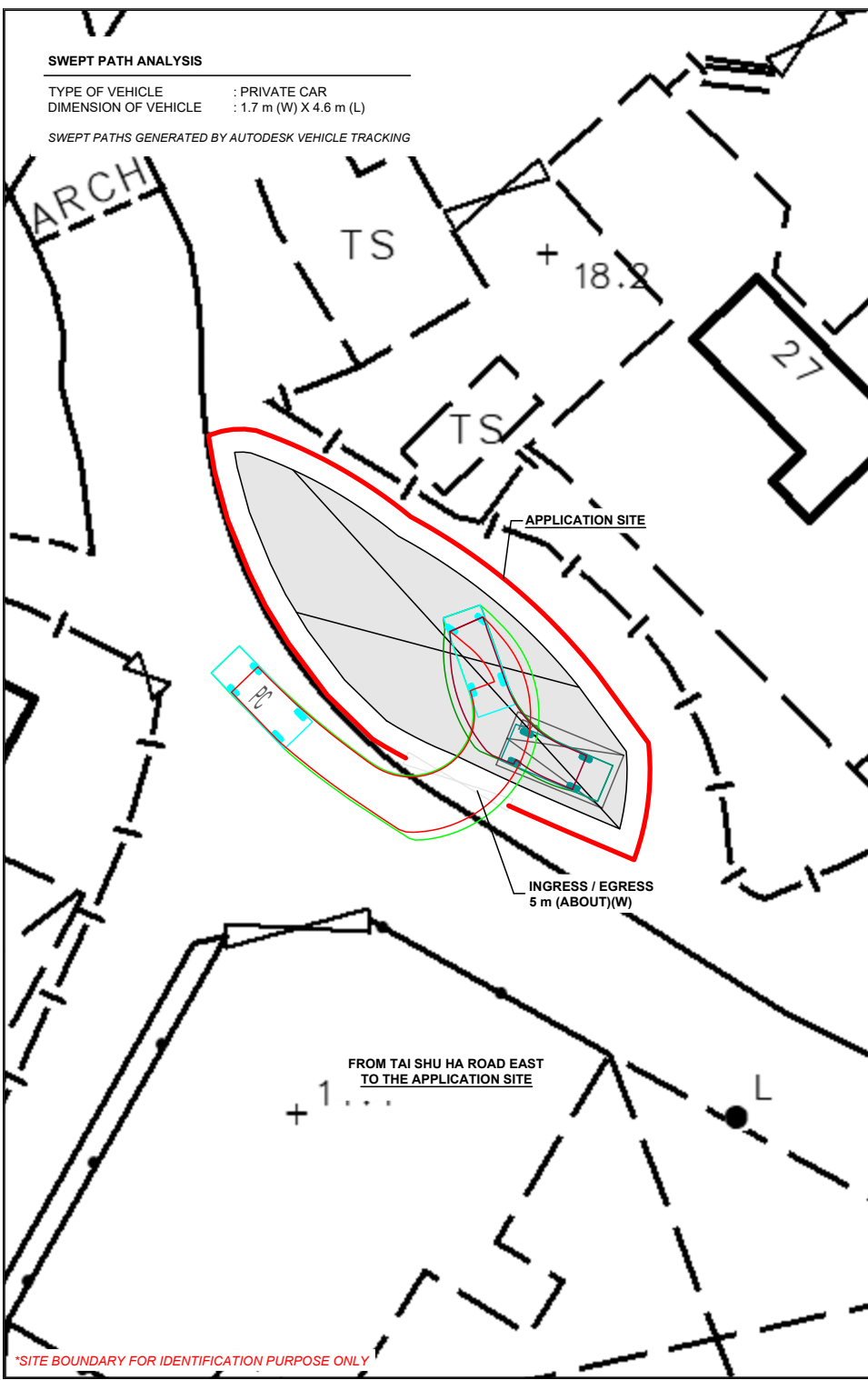
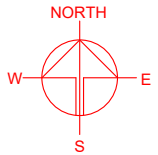

*SITE BOUNDARY FOR IDENTIFICATION PURPOSE ONLY

PLANNING CONSULTANT
 R-Riches
 Property Consultants Ltd.

PROJECT
 PROPOSED ANIMAL BOARDING ESTABLISHMENT WITH ANCILLARY FACILITIES FOR A PERIOD OF 5 YEARS AND ASSOCIATED FILLING OF LAND

SITE LOCATION
 LOT 1756 (PART) IN D.D. 118, TAI TONG, YUEN LONG, NEW TERRITORIES

SCALE
 1 : 300 @ A4

DRAWN BY MN	DATE 17.6.2024
CHECKED BY	DATE
APPROVED BY	DATE

DWG. TITLE SWEPT PATH ANALYSIS	
DWG NO. PLAN 6	VER. 001