



---

From: tpbpd/PLAND <tpbpd@pland.gov.hk>  
Sent: Friday, December 27, 2024 5:37 PM  
To: tmylwdpo\_pd/PLAND <tmylwdpo@pland.gov.hk>  
Cc: Kiff Kit Fu YIU/PLAND <kkfyiu@pland.gov.hk>  
Subject: Fw: 有關申請編號: TT\_681 提交進一步資料

From: ttplanning [REDACTED]  
Sent: Friday, December 27, 2024 5:34 PM  
To: tpbpd/PLAND <[tpbpd@pland.gov.hk](mailto:tpbpd@pland.gov.hk)>  
Subject: 有關申請編號: TT\_681 提交進一步資料

 241227\_渠相.pdf  
4 MB

 241227\_swept path.pdf  
923 KB

 241210\_車輛流量.pdf  
170 KB

 241209\_FS DESIGN DWG.R2.pdf  
800 KB

## FIRE SERVICES NOTES:

### 1. EMERGENCY LIGHTING

- 1.1 SUFFICIENT EMERGENCY LIGHTING SHALL BE PROVIDED THROUGHOUT THE ENTIRE BUILDINGS/STRUCTURES IN ACCORDANCE WITH BS 5266-1:2016 AND BS EN 1838:2013 AND FSD CIRCULAR LETTER NO.4/2021.

### 2. EXIT SIGN

- 2.1 SUFFICIENT DIRECTIONAL AND EXIT SIGN SHALL BE PROVIDED IN ACCORDANCE WITH BS 5266-1:2016 AND FSD CIRCULAR LETTER 5/2008.















### 3. MISCELLANEOUS

- 3.1 PORTABLE FIRE EXTINGUISHERS WITH SPECIFIED TYPE AND CAPACITY TO BE PROVIDED AT LOCATION AS INDICATED ON PLANS.

- 3.2 NO EMERGENCY GENERATOR TO BE PROVIDED FOR SERVING THE EMERGENCY POWER. DUPLICATED POWER SUPPLIES FOR ALL FIRE SERVICES INSTALLATIONS COMPRISING A CABLE CONNECTED FROM ELECTRICITY MAINS DIRECTLY BEFORE THE MAIN SWITCH

- 3.3 WHEN A VENTILATION / AIR CONDITIONING CONTROL SYSTEM TO A BUILDING IS PROVIDED, IT SHALL STOP MECHANICALLY INDUCED AIR MOVEMENT WITHIN A DESIGNATED FIRE COMPARTMENT

## LEGEND (FOR LAYOUT PLAN)

	HOSE REEL W/ LOCKABLE GLASS FRONTED NOZZLE BOX, STRIKER, C/W FIRE ALARM BELL & BREAK GLASS UNIT
	150mm FIRE ALARM BELL
	BREAK GLASS UNIT
	GATE VALVE
	NON RETURN VALVE
	VORTEX INHIBITOR
	BALL FLOAT VALVE
	HOSE REEL PIPE
	CHECK METER POSITION
	5Kg CO2 TYPE FIRE EXTINGUISHER
	4Kg DRY POWDER TYPE FIRE EXTINGUISHER
	PUMP
	CONVENTIONAL TYPE FIRE ALARM PANEL
	PUMP CONTROL PANEL

## ABBREVIATION

SPR.	SPRINKLER
H.R.	HOSE REEL
F.E.	FIRE EXTINGUISHER
CO <sub>2</sub>	CARBON DIOXIDE
L.P.C.	LOSS PREVENTION COUNCIL
F.S.I.	FIRE SERVICES INSTALLATION
H/L	HIGH LEVEL
M/L	MID LEVEL
L/L	LOW LEVEL
F/A	FROM ABOVE
F/B	FROM BELOW
T/A	TO ABOVE
T/B	TO BELOW
U/G	UNDERGROUND
F.S.	FIRE SERVICES

## COLOUR CODE

PIPE SIZES	COLOUR
ø25mm	LIGHT GREEN
ø32mm	RED
ø40mm	PURPLE
ø50mm	YELLOW
ø65mm	BLUE
ø80mm	GREEN
ø100mm	LIGHT BROWN
ø150mm	DEEP BROWN

## DRAWING LIST:

DRAWING NO.	REVISION	DRAWING TITLE
EP-TT596-FS01	A	FIRE SERVICES NOTES, LEGEND, ABBREVIATION, DRAWING LIST, COLOUR CODE.AND SITE LOCATION BLOCK PLAN
EP-TT596-FS02	A	F.S. LAYOUT PLAN ON GROUND FLOOR

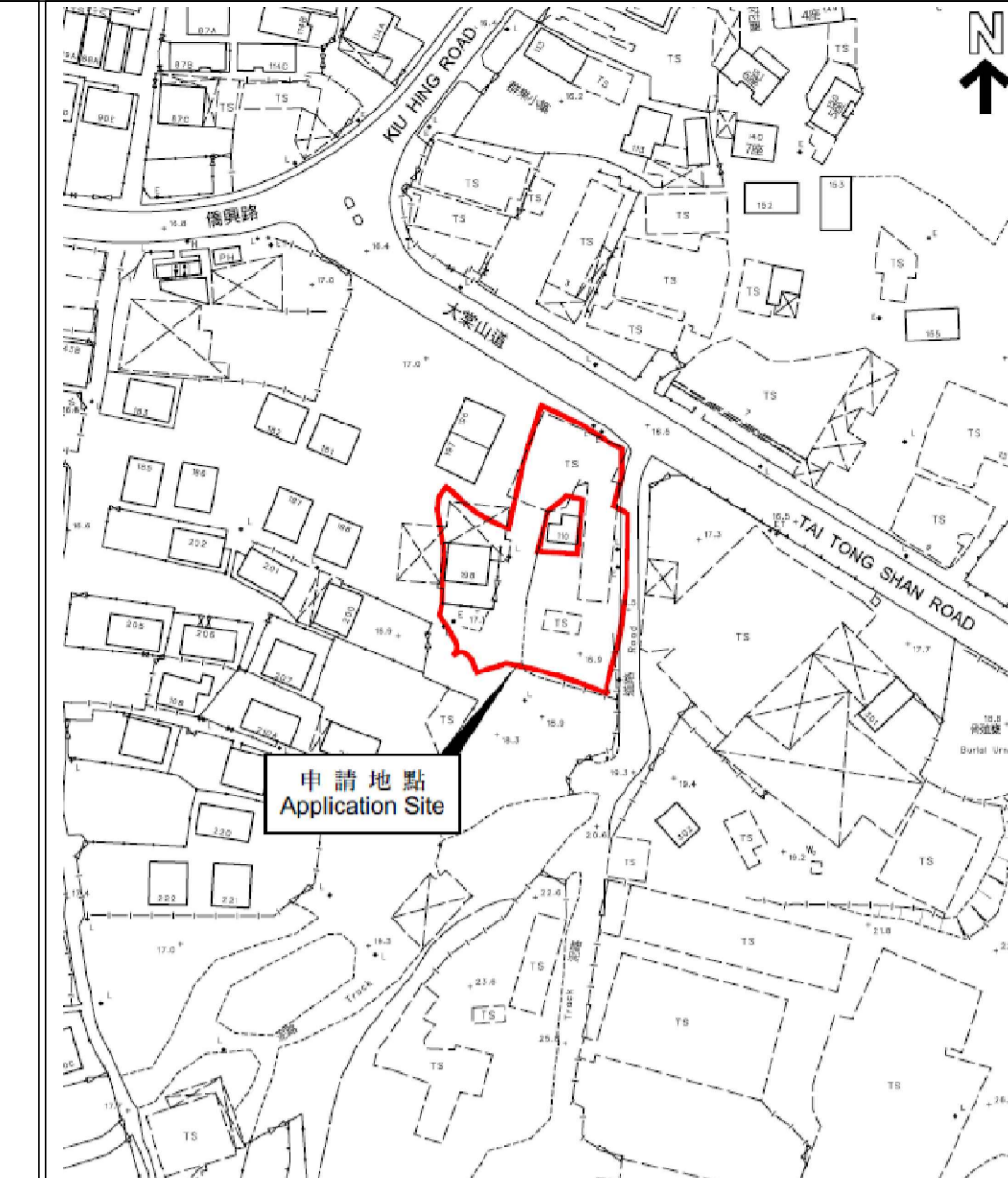

LOCATION PLAN (NOT TO SCALE)

REV	DESCRIPTION	DATE	BY
C	FSD SUBMISSION	08-12-2024	WC
B	FSD SUBMISSION	30-06-2024	WC
A	FSD SUBMISSION	02-06-2024	WC

FSI CONTRACTOR

East Power Engineering Limited

Flat A, 7/F., Hop Shing Commercial Building,  
41 Chi Kiang Street, Tokwawan, Kowloon  
Fax : 2394-3772 Tel : 2397-3238

PROJECT

TEMPORARY USE/DEVELOPMENT IN RURAL AREAS FOR A PERIOD OF 3 YEARS AT LOTS 1185, 1186 (PART), 1187 S.M, 1187 S.L (PART), 1298 RP (PART) AND 2146 IN D.D.117, TAI TONG SHAN ROAD, TAI TONG, YUEN LONG, NEW TERRITORIES

DRAWING TITLE



FIRE SERVICES INSTALLATION-  
F.S NOTES, LEGEND, LOCATOIN PLAN,  
ABBREVIATION

	INITIAL	DESIGNATION	DATE
DRAWN BY	CAD	CAD	07-03-2024
DESIGN BY	JACKIE	S.ENG	07-03-2024
CHECK BY	CM	PM	08-03-2024
APPROVED BY	-	-	-
PROJECT NO.	TT-596		
PAPER SIZE	A3	PLOT SCALE	1 : 1
DRAWING NO.	EP-TT596-FS01		
SCALE	N.T.S	REVISION	C

**Details of Structures:**

Structure No.	Area (m <sup>2</sup> )	Height (m)	Storey
1. Shelter (OSA)	74	4.0	1
2. Shelter (OSA)	146	5.0	1
3. Structure (OSA)	134	4.0	1
4. Container for Storage	22	2.5	1
5. Rain Shelter	4	2.5	1
6. Shelter for Storage	61	2.7	1
7. Shelter for Storage	28	4.0	1
8. Shelter for Storage	34	4.0	1
9. Meter Room	1	2.0	1
10. Toilet	4.66	2.5	1

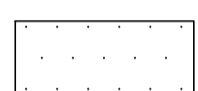
**LEGEND:**

-  Application Site (Area = about 1,450 sq. m.)
-  Shelters/Structures for Temporary Outside Seating
-  Accommodation (OSA) of the Restaurant
-  Area not from part of this application

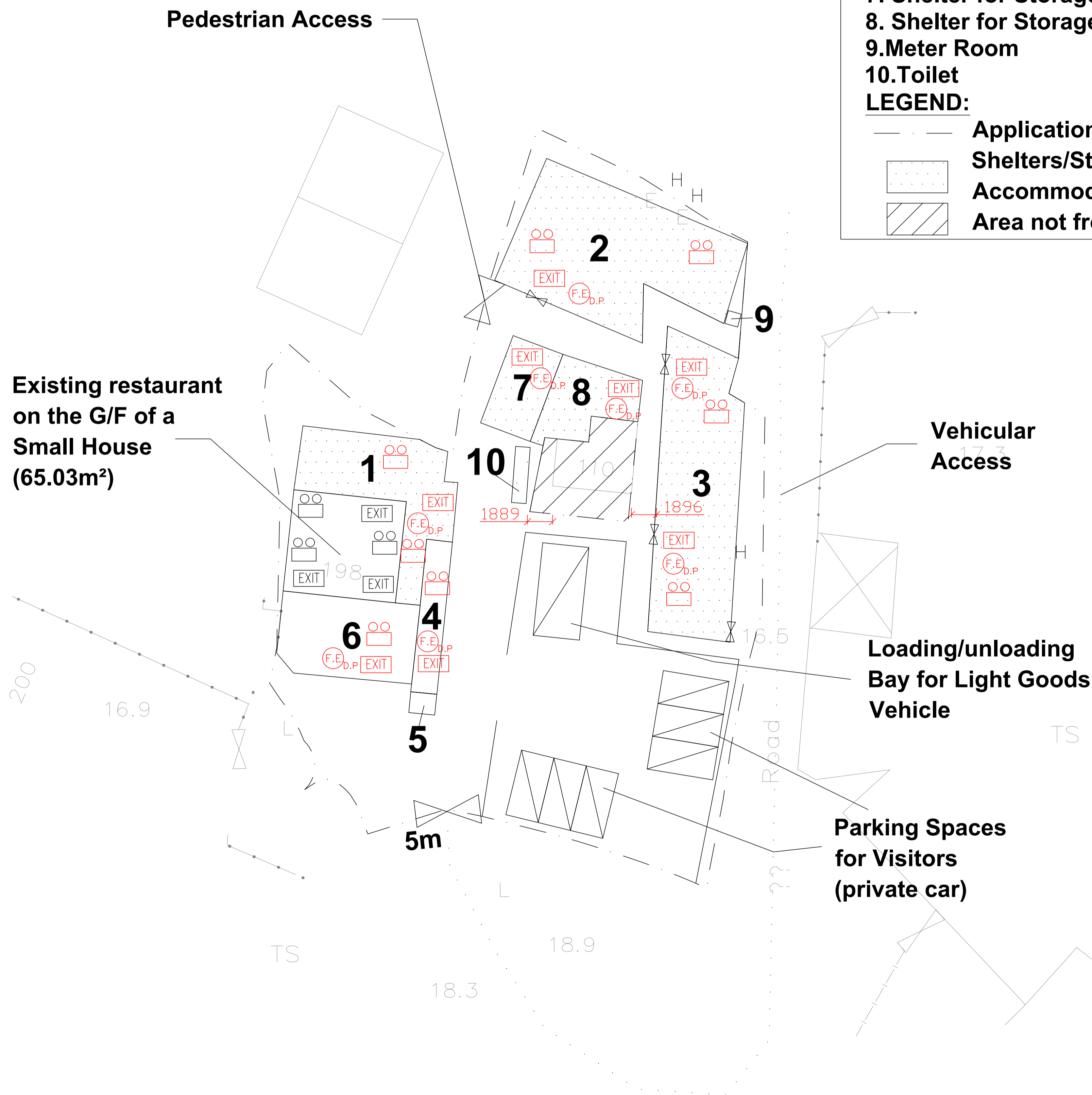

REV	DESCRIPTION	DATE	BY
C	FSD SUBMISSION	08-12-2024	WC
B	FSD SUBMISSION	30-06-2024	WC
A	FSD SUBMISSION	02-06-2024	WC

FSI CONTRACTOR

**East Power Engineering Limited**

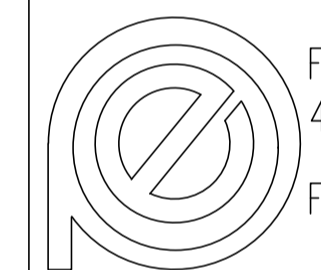

Flat A, 7/F., Hop Shing Commercial Building,  
41 Chi Kiang Street, Tokwawan, Kowloon  
Fax : 2394-3772 Tel : 2397-3238

PROJECT  
 TEMPORARY USE/DEVELOPMENT IN RURAL AREAS FOR A PERIOD OF 3 YEARS AT LOTS 1185, 1186 (PART), 1187 S.M, 1187 S.L (PART), 1298 RP (PART) AND 2146 IN D.D.117, TAI TONG SHAN ROAD, TAI TONG, YUEN LONG, NEW TERRITORIES

DRAWING TITLE  
 F.S. LAYOUT PLAN ON GROUND FLOOR

	INITIAL	DESIGNATION	DATE
DRAWN BY	CAD	CAD	07-03-2024
DESIGN BY	JACKIE	S.ENG	07-03-2024
CHECK BY	CM	PM	08-03-2024
APPROVED BY	-	-	-
PROJECT NO.	TT-596		
PAPER SIZE	A1	PLOT SCALE	1 : 1
DRAWING NO.	EP-TT596-FS02		
SCALE	1:400 @A3	REVISION	C

Application No. A/YL-TT/681

The hourly trip generation and trip attraction of the proposed development are as follows:

Time	No. of Trips (In) (Visitors)	No. of Trips (Out) (Visitors)	No. of Trips (Staff)	No. of Trips (Loading/Unloading)
06:00-07:00	0	0	0	0
07:00-08:00	1	1	1	0
08:00-09:00	2	1	0	0
09:00-10:00	1	2	0	0
10:00-11:00	2	2	0	0
11:00-12:00 (AM Peak)	6	6	0	0
12:00-13:00 (AM Peak)	6	6	1	0
13:00-14:00 (AM Peak)	6	5	0	0
14:00-15:00	2	3	0	0
15:00-16:00	2	1	0	1
16:00-17:00	0	1	0	0
17:00-18:00	1	1	1	0
18:00-19:00 (PM Peak)	4	4	0	0
19:00-20:00	6	3	0	0
20:00-21:00	3	6	0	0
21:00-22:00	1	1	0	0
<b>Total:</b>	<b>43</b>	<b>43</b>	<b>3</b>	<b>1</b>

棠人街餐廳為標題項目申請人,為方便運輸處考慮及接納是項申請,現就附近的車輛管制流量方面作出簡述:

1. 申請地點距離大棠山道入口約 50 米, 村民由 橋興路步行至餐廳需時約 2-3 分鐘, 對交通無阻;
2. 港鐵巴士 K66 平均 4 至 15 一班由黃泥墩往返朗屏西鐵站, 另外亦有往返黃泥墩至元朗市的小型巴士, 班次極密。是故公眾人士毋須自行駕車前往, 不會對交通造成負擔及阻塞。

綜觀上述均為客觀的事實,現如實反映以供考慮及接納是項申請。如有查詢,請致電 [REDACTED] 聯絡。

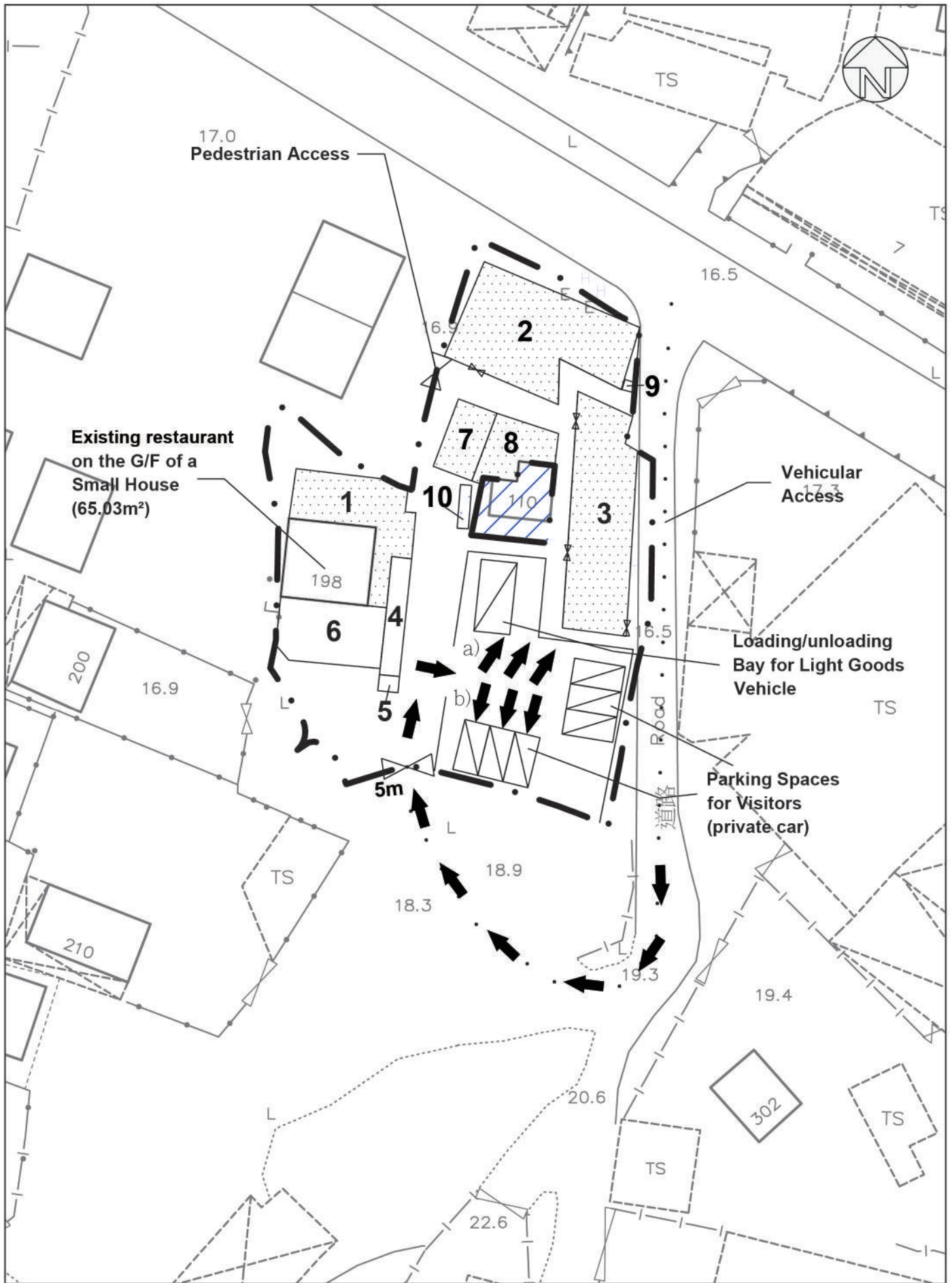

### Layout Plan

Various Lots in DD117,  
 Tai Tong Shan Road, Tai Tong, Yuen Long, N.T.

### FIGURE 5(i)

Swept Path Analysis (Private Car)  
 Date: 20.12.2024  
 Scale: 1 : 500 (A4)

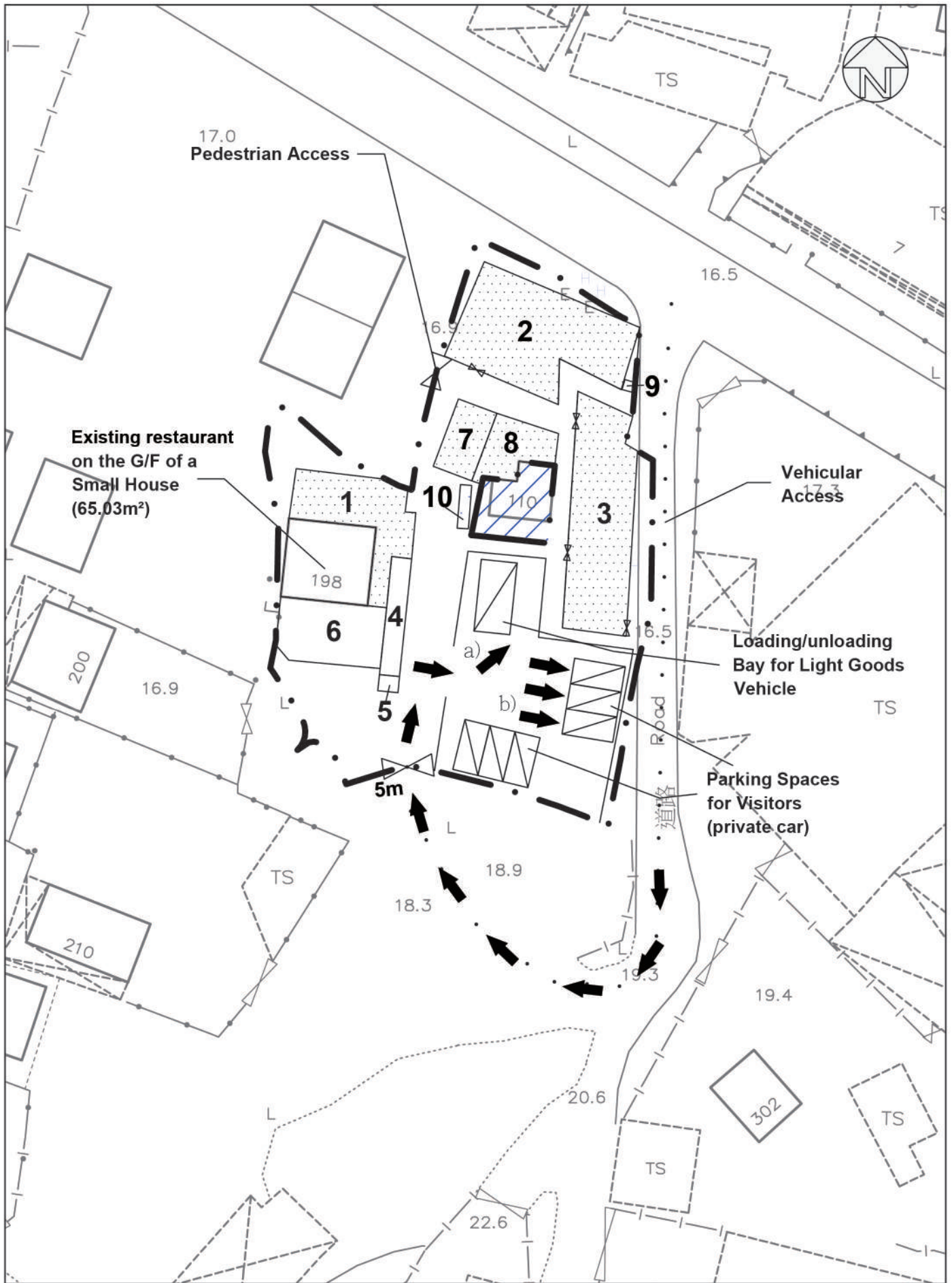

### Layout Plan

Various Lots in DD117,  
Tai Tong Shan Road, Tai Tong, Yuen Long, N.T.

### FIGURE 5(ii)

Swept Path Analysis (Private Car)  
Date: 20.12.2024  
Scale: 1 : 500 (A4)

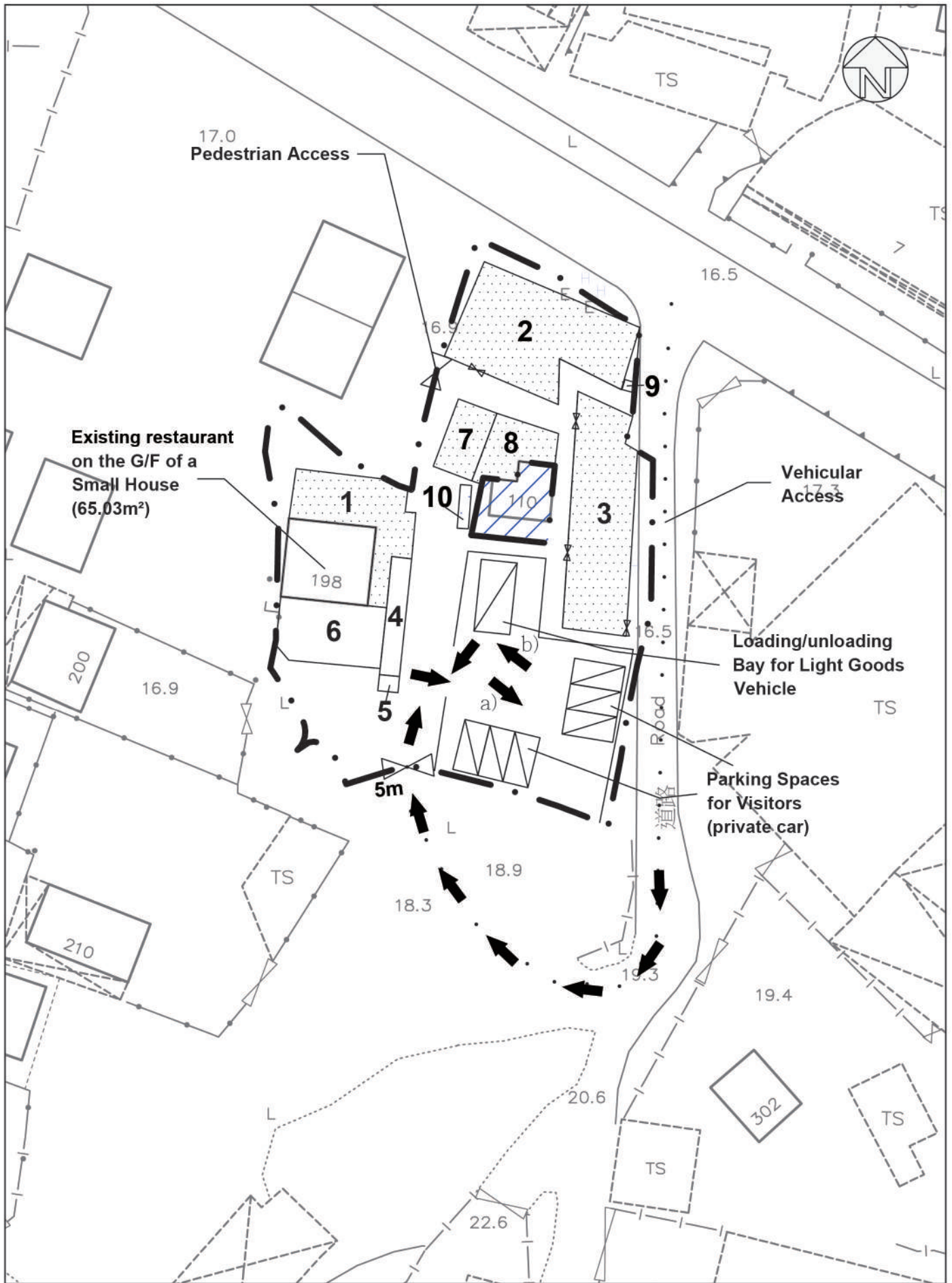

### Layout Plan

Various Lots in DD117,  
Tai Tong Shan Road, Tai Tong, Yuen Long, N.T.

### FIGURE 5(iii)

Swept Path Analysis (Light Goods Vehicle)  
Date: 20.12.2024  
Scale: 1 : 500 (A4)

- Note:**
1. No solid fence wall to be erected.
  2. Cover level of proposed UC shall be flushed with adjoining ground level.
  3. Catchpit and UC follows Typical Details of Geotechnical Manual for Slope Fig.8.10 and Fig.8.11 respectively.
  4. Proposed Terminal Manhole shall follow DSD's Standard Drawing DS 10535

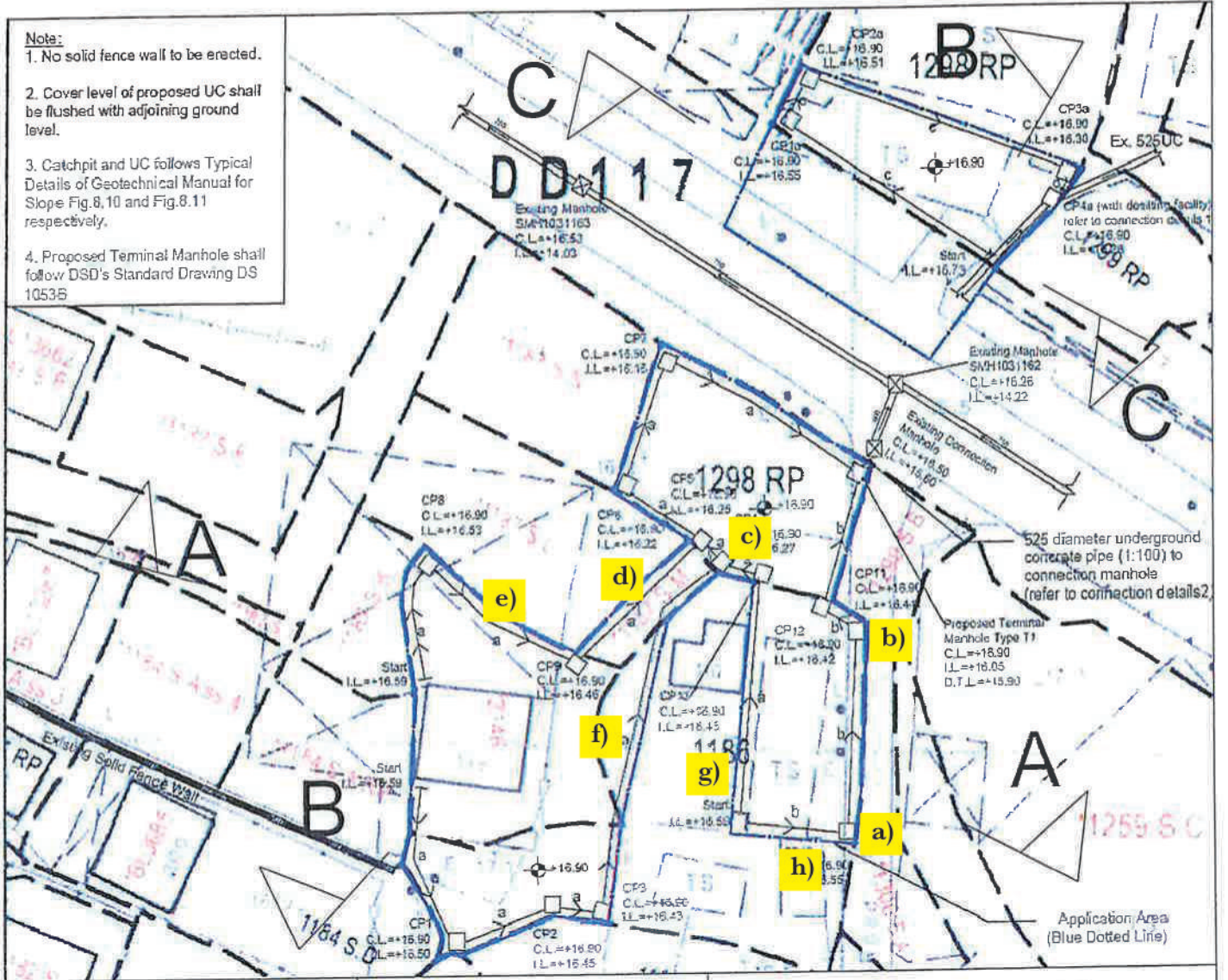

**LEGEND**

- CP Proposed CatchPit
- TM Proposed Terminal Manhole Type T1
- Proposed
  - a: 525HR(1:150)
  - b: 300HR(1:150)
  - c: 225UC(1:100) with Cast Iron Cover
- Existing Manhole
- Existing Underground Pipe

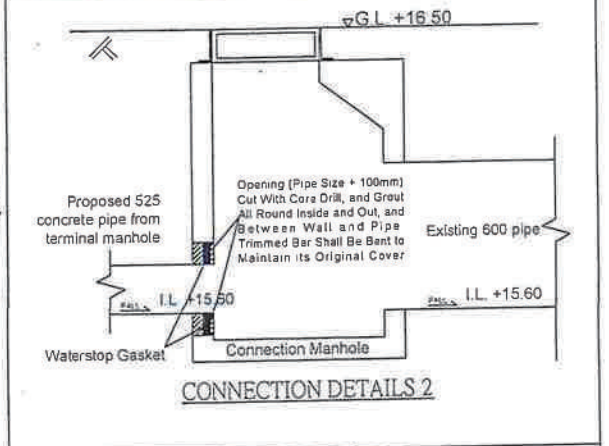
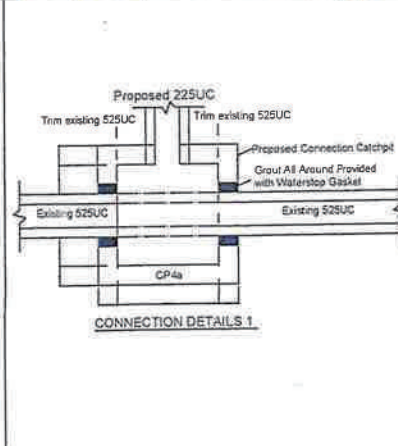

<h1>正宏工程顧問公司</h1> <p>CHING WAN ENGINEERING CONSULTANTS CO.</p>		Title: Drainage Proposal	
Project: Proposed Temporary Eating Place for a Period of 3 Years at Lots 1186(part), 1187S.M., 1298RP(part), 2146 in DD117 and adjoining Government Land, Tai Tong, Yuen Long, N.T.		Drawn by: DM	Date: 8 Mar 2017
		Check by: DM	Scale: ---



a)



b)



c)



d)



e)



f)



g)



h)

