

Extracted from Approved Tai Tong Outline Zoning Plan No. S/YL-TT/20

Not to Scale	Location Plan Lot No. 1213 S.B. ss1 in D. D. 118 Yuen Long, New Territories	Goldrich Planners & Surveyors Ltd.
February 2025		Plan 1 (P 22022)

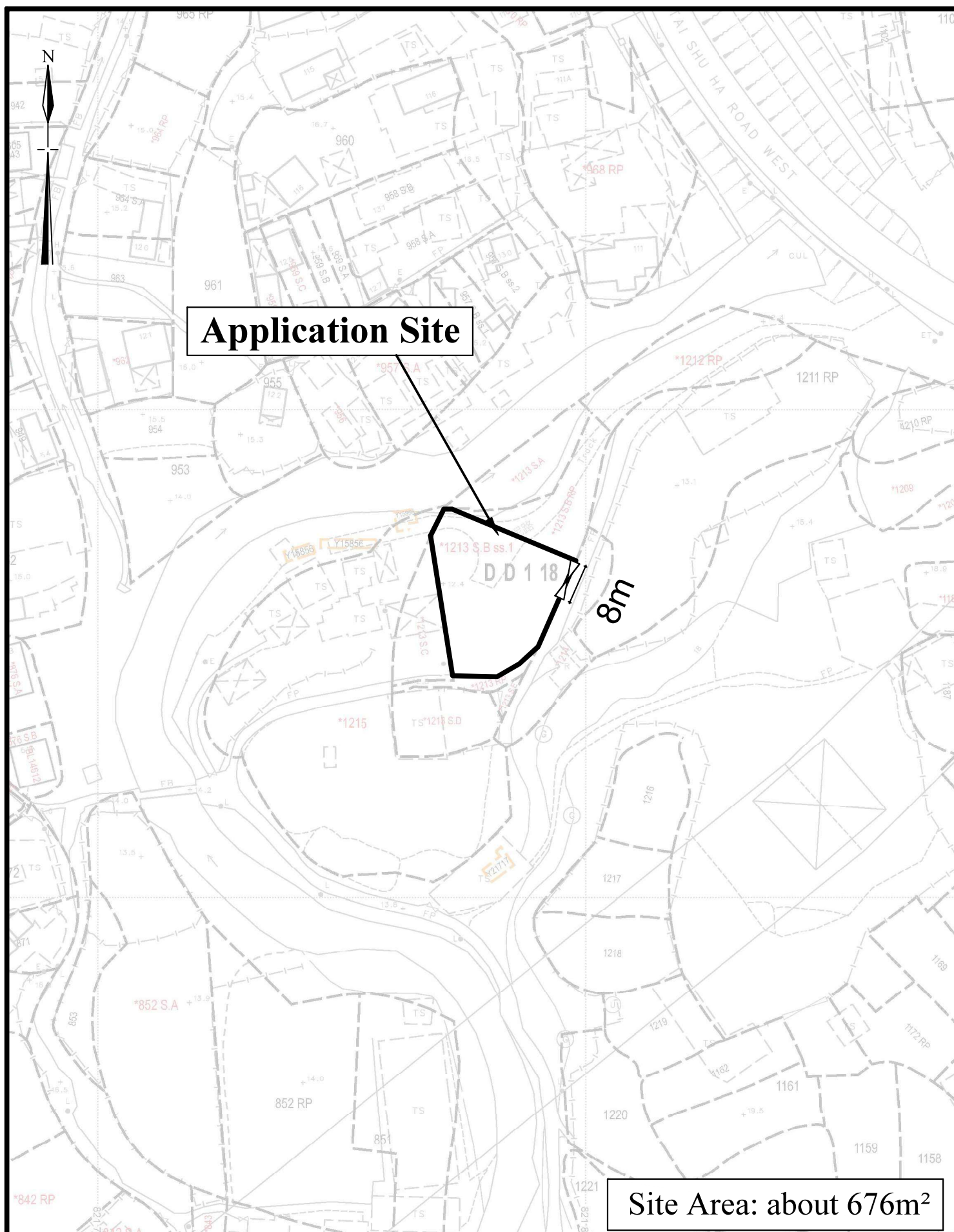

1:1000

Lot Index Plan

**Goldrich Planners &
Surveyors Ltd.**

February 2025

Lot No. 1213 S.B. ss1 in D. D. 118
Yuen Long, New Territories

**Plan 2
(P 22022)**

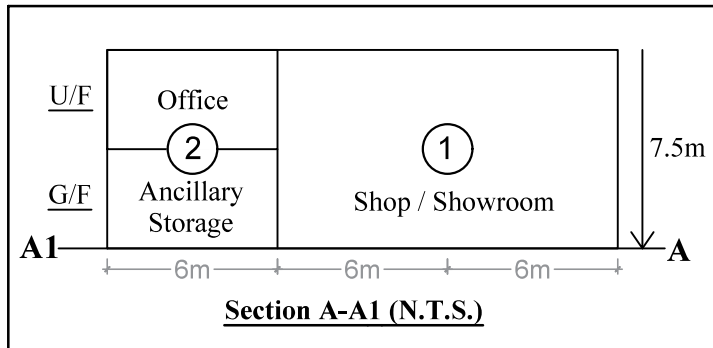
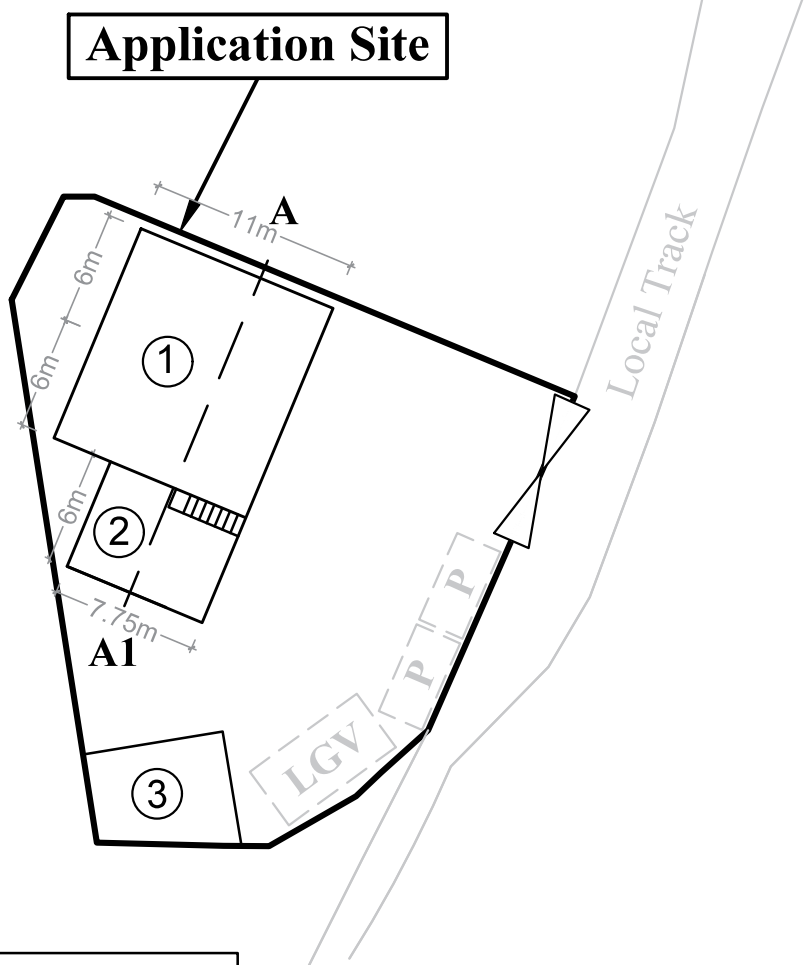
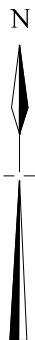

Site Area: about 676m²

No.	Structure / Use	Floor Area (about)	Covered Area (about) (Including canopy)	Height	No. of Storeys
1	G/F: Shop/ Showroom	132m ²	132m ²	7.5m	1
2	G/F: Ancillary Storage	46.5m ²	46.5m ²	7.5m	2
	U/F: Office	46.5m ²			
3	Electrical Room	41m ²	41m ²	4m	1
Total:		266m ²	219.5m ²		

1 : 400	Layout Plan Lot No. 1213 S.B. ss1 in D. D. 118 Yuen Long, New Territories	Goldrich Planners & Surveyors Ltd.
February 2025		Plan 3 (P 22022)

Connection details of proposed outfall between CP4, S1 and existing local river

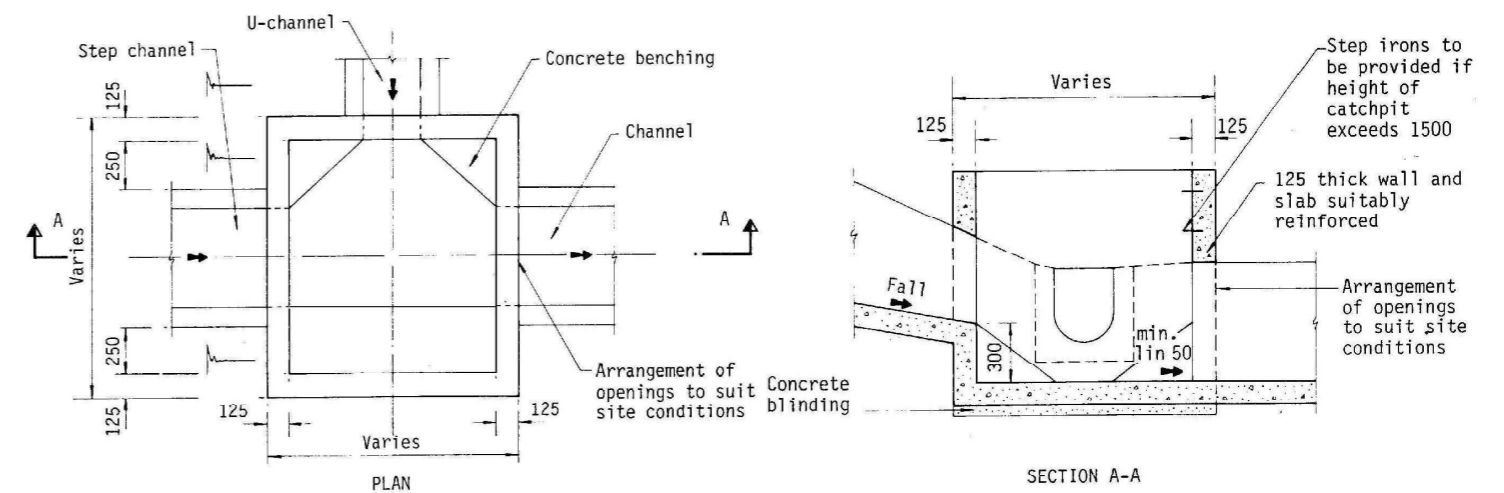
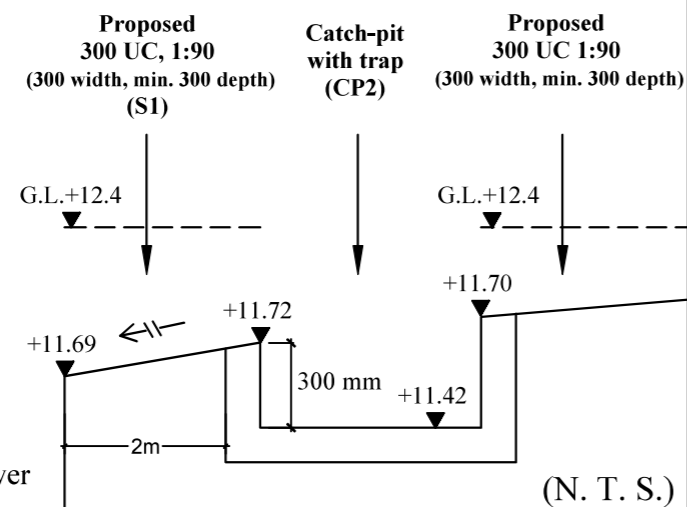

TYPICAL DETAILS OF CATCHPIT

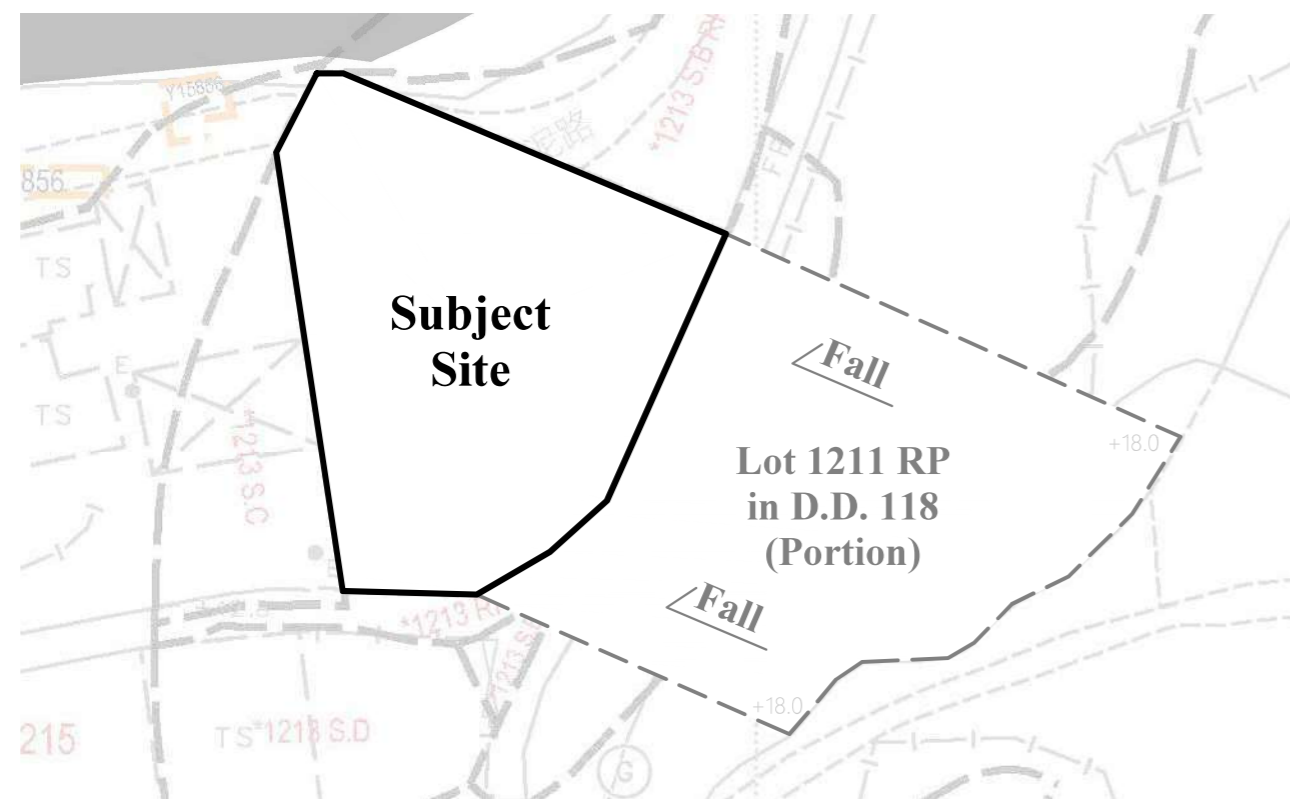

Total area of catchment (about) :1,455m²

AREA OF CATCHMENT
(N.T.S)

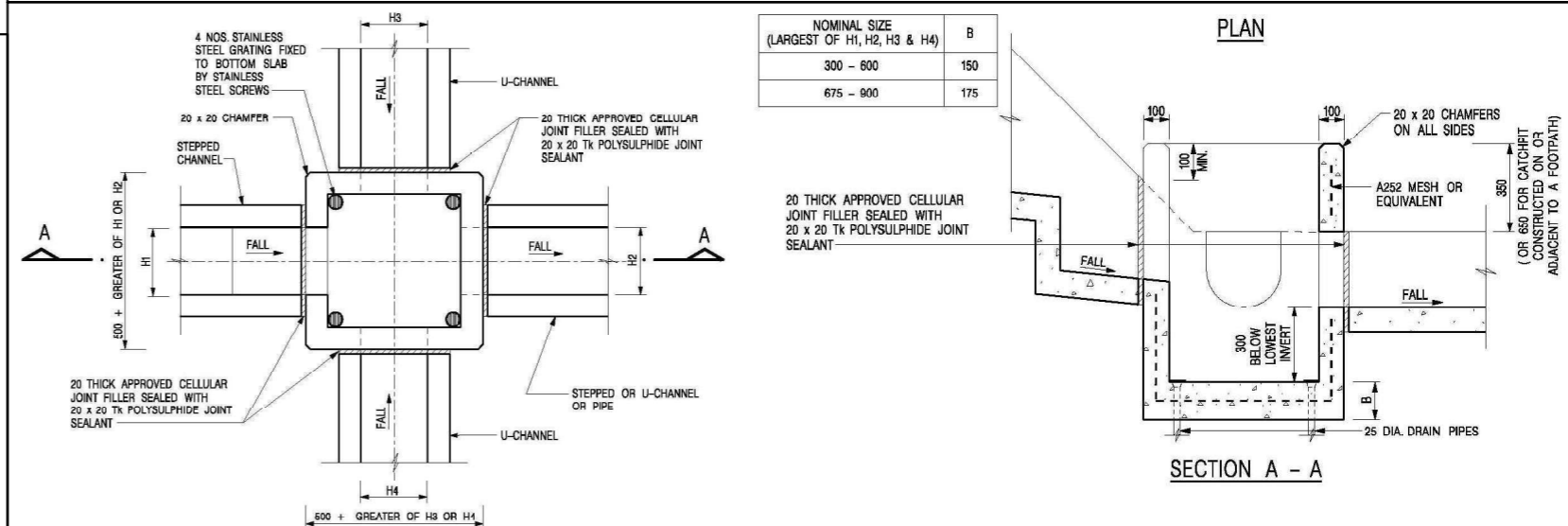

DETAILS OF CATCHPIT WITH TRAP
(REFER TO CEDD'S STANDARD DWG. C2406/1)

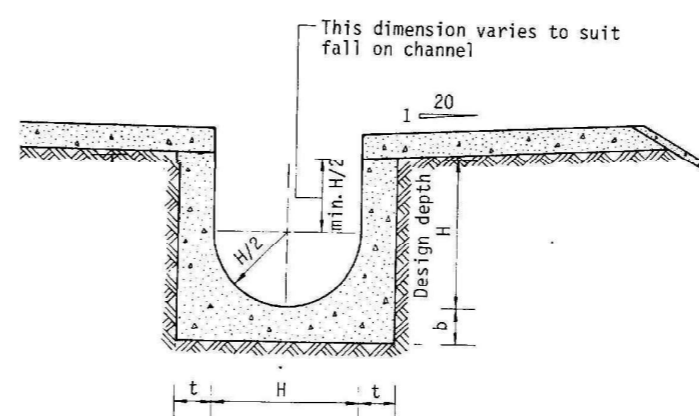

TYPICAL DETAILS OF U CHANNEL

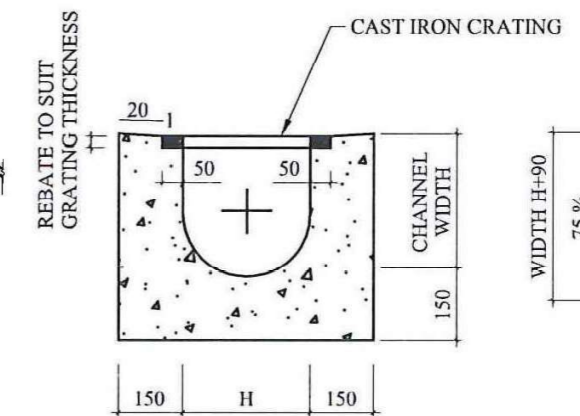

TYPICAL SECTION OF
U-CHANNEL WITH COVER
(N.T.S.)

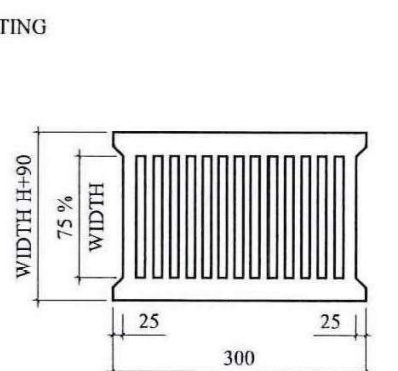

CAST IRON CRATING
(HEAVY DUTY)

N.T.S

February 2025

Approved Drainage Proposal

Lot No. 1213 S.B. ss1 in D. D. 118
Yuen Long, New Territories

Goldrich Planners &
Surveyors Ltd.

Plan 4.2
(P 22022)

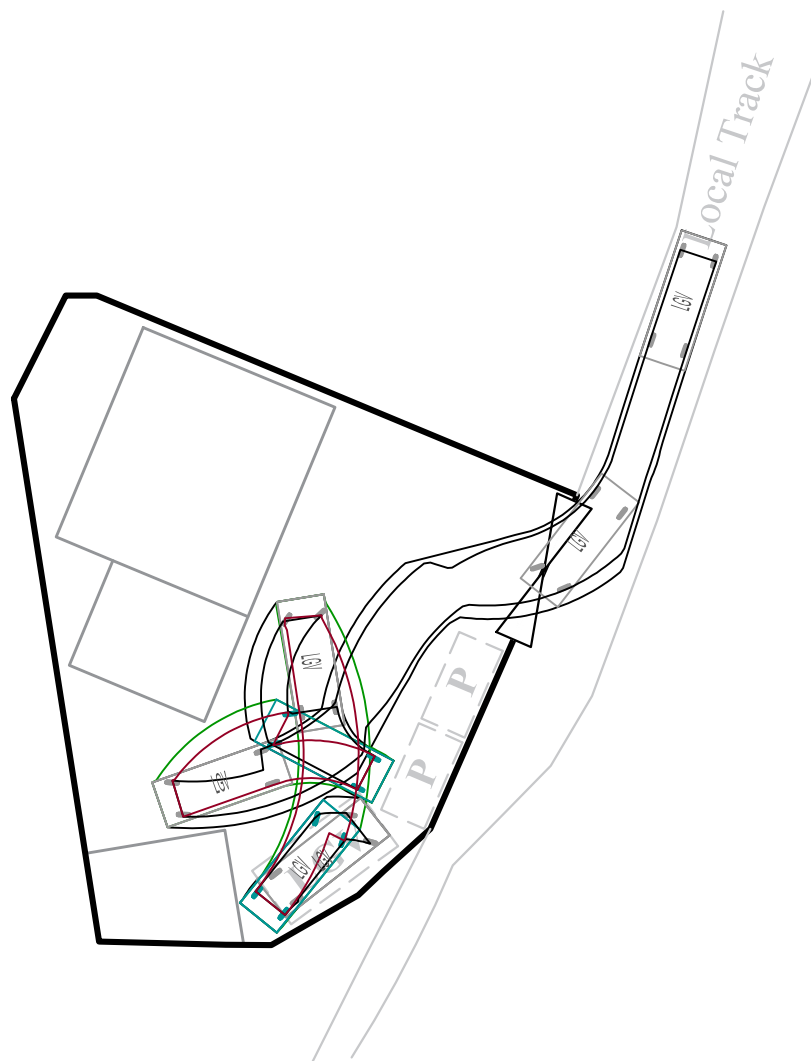

LEGEND



Parking space for private cars
(5m (L) x 2.5(W))



Parking space for light goods vehicles
(7m (L) x 3.5(W))



Light goods vehicles
(7m (L) x 2.5(W))

Site Area: about 676m²

1 : 400

Swept Path Analysis

Goldrich Planners &
Surveyors Ltd.

February 2025

Lot No. 1213 S.B. ss1 in D. D. 118
Yuen Long, New Territories

Plan 5
(P 22022)

