

Project 項目名稱:
 Proposed Temporary Open Storage of Construction Machinery and Material for a Period of 3 Years at Lots 2423RP(Part), 2426RP(Part), 2427, 2428RP(Part), 2429S.A, 2429S.B, 2429S.C, 2429S.D(Part), 2429RP, 2430, 2431(Part), 2432(Part), 2433(Part), 2434(Part), 2688(Part), 2690(Part), 2691, 2692(Part), 2693(Part), 2694, 2695, 2696(Part), 2697, 2698S.A(Part), 2698S.B(Part), 2699(Part), 2700(Part), 2701(Part) & Adjoining Government Land in D.D. 120, Shan Ha Tsuen, Yuen Long, N.T.

Drawing Title 圖目:
Location Plan

Drawing No. 圖號:
Figure 2

Remarks 備註:
 ●●● Vehicular Access Leading to Shan Ha Road

Scale 比例:
 1:7500

N

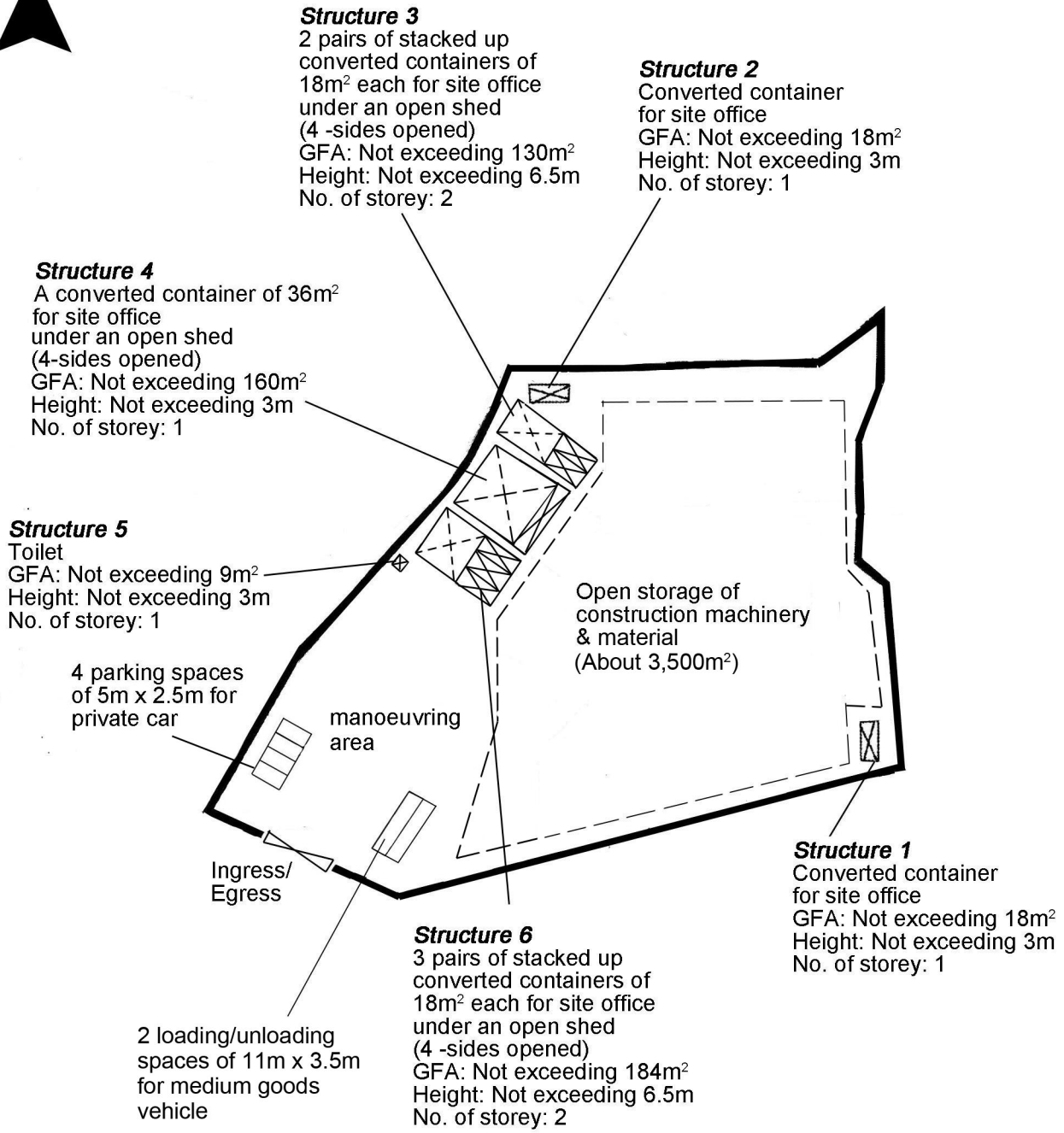

Project 項目名稱:

Proposed Temporary Open Storage of Construction Machinery and Material for a Period of 3 Years at Lots 2423RP(Part), 2426RP(Part), 2427, 2428RP(Part), 2429S.A, 2429S.B, 2429S.C, 2429S.D(Part), 2429RP, 2430, 2431(Part), 2432(Part), 2433(Part), 2434(Part), 2688(Part), 2690(Part), 2691, 2692(Part), 2693(Part), 2694, 2695, 2696(Part), 2697, 2698S.A(Part), 2698S.B(Part), 2699(Part), 2700(Part), 2701(Part) & Adjoining Government Land in D.D. 120, Shan Ha Tsuen, Yuen Long, N.T.

Drawing Title 圖名:

Proposed Layout Plan

Drawing No. 圖號:

Figure 3

Remarks 備註:

Converted container

Open shed

Scale 比例:

1:1000

N

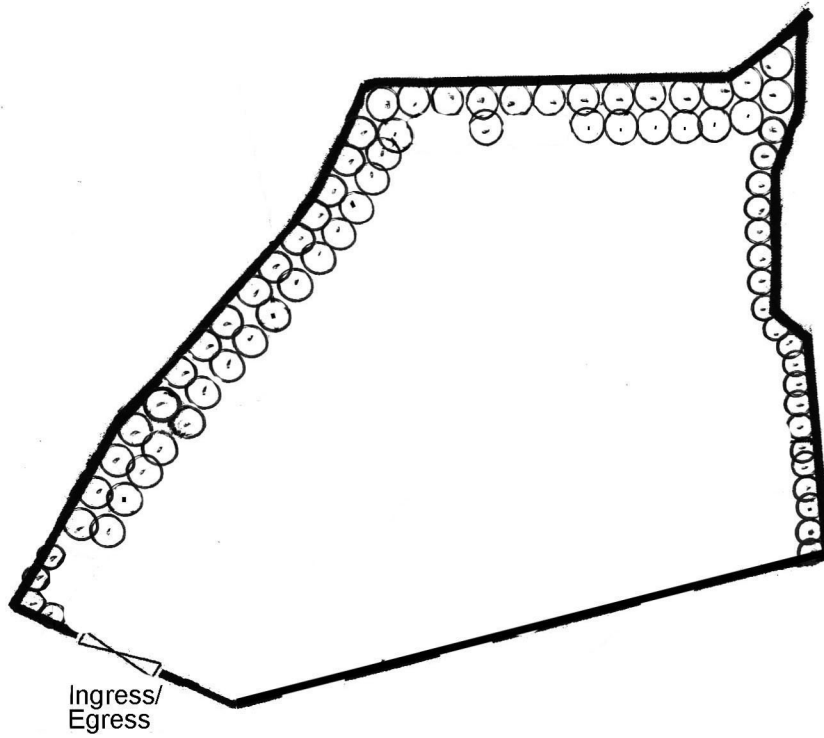

Trees	Approximate Height	Spacing
 Existing trees	3m to 5.5m	3m

Project 項目名稱:

Proposed Temporary Open Storage of Construction Machinery and Material for a Period of 3 Years at Lots 2423RP(Part), 2426RP(Part), 2427, 2428RP(Part), 2429S.A, 2429S.B, 2429S.C, 2429S.D(Part), 2429RP, 2430, 2431(Part), 2432(Part), 2433(Part), 2434(Part), 2688(Part), 2690(Part), 2691, 2692(Part), 2693(Part), 2694, 2695, 2696(Part), 2697, 2698S.A(Part), 2698S.B(Part), 2699(Part), 2700(Part), 2701(Part) & Adjoining Government Land in D.D. 120, Shan Ha Tsuen, Yuen Long, N.T.

Drawing Title 圖片:

Proposed Tree Preservation and Landscape Plan

Drawing No. 圖號:

Figure 4

Remarks 備註:

Scale 比例:

1:1000

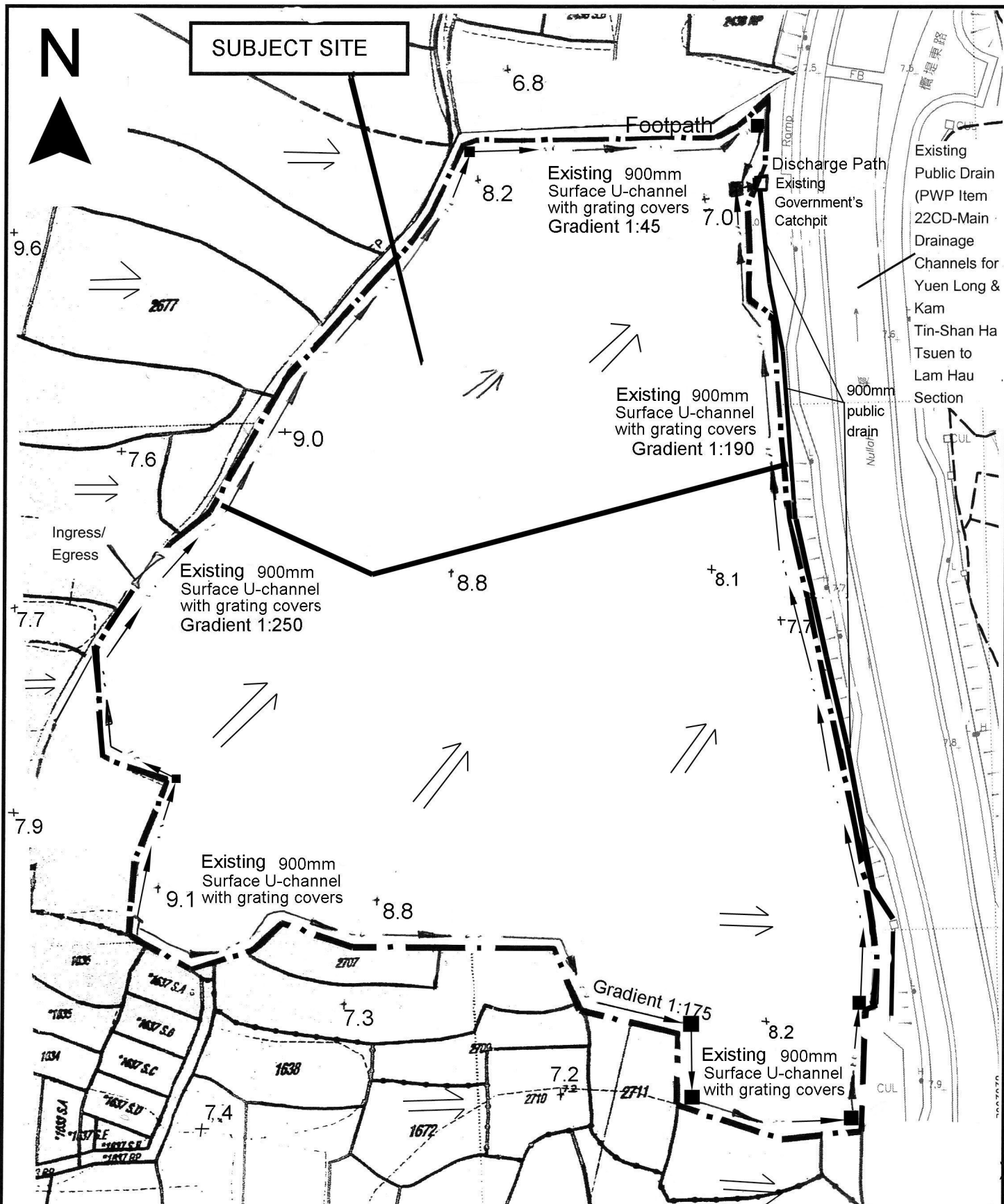

Project 項目名稱:

Proposed Temporary Open Storage of Construction Machinery and Material for a Period of 3 Years at Lots 2423RP(Part), 2426RP(Part), 2427, 2428RP(Part), 2429S.A, 2429S.B, 2429S.C, 2429S.D(Part), 2429RP, 2430, 2431(Part), 2432(Part), 2433(Part), 2434(Part), 2688(Part), 2690(Part), 2691, 2692(Part), 2693(Part), 2694, 2695, 2696(Part), 2697, 2698S.A(Part), 2698S.B(Part), 2699(Part), 2700(Part), 2701(Part) & Adjoining Government Land in D.D. 120, Shan Ha Tsuen, Yuen Long, N.T.

Drawing Title 圖目:

As-built Drainage Plan

Drawing No. 圖號:

Figure 5

Remarks 備註:

- +7.5 Level (mPD)
- ⇒ Flow of Surface Runoff
- Proposed catchpit
- - - Site boundary of A/YL-TYST/458 approved by TPB in 2009
- Approved drainage plan for A/YL-TYST/458 via ex-aplicant's letter dated 23.7.2010

Scale 比例:

1:1000