

Application Site

To Yuen Long Town

|  |  |  |
|--|--|--|
| <p><b>Not to Scale<br/>For Identification<br/>Purpose Only</b></p> | <p><b>Location Plan</b></p>  | <p><b>Goldrich Planners &amp;<br/>Surveyors Ltd.</b></p> |
| <p><b>July 2024</b></p>  | <p>Lots 1198E(Part), 1223 RP(Part), 1224 RP(Part)<br/>in D.D. 119 and Adjoining G.L., Kung Um Road,<br/>Yuen Long, New Territories</p> | <p><b>Plan 1<br/>(A8052)</b></p>                         |

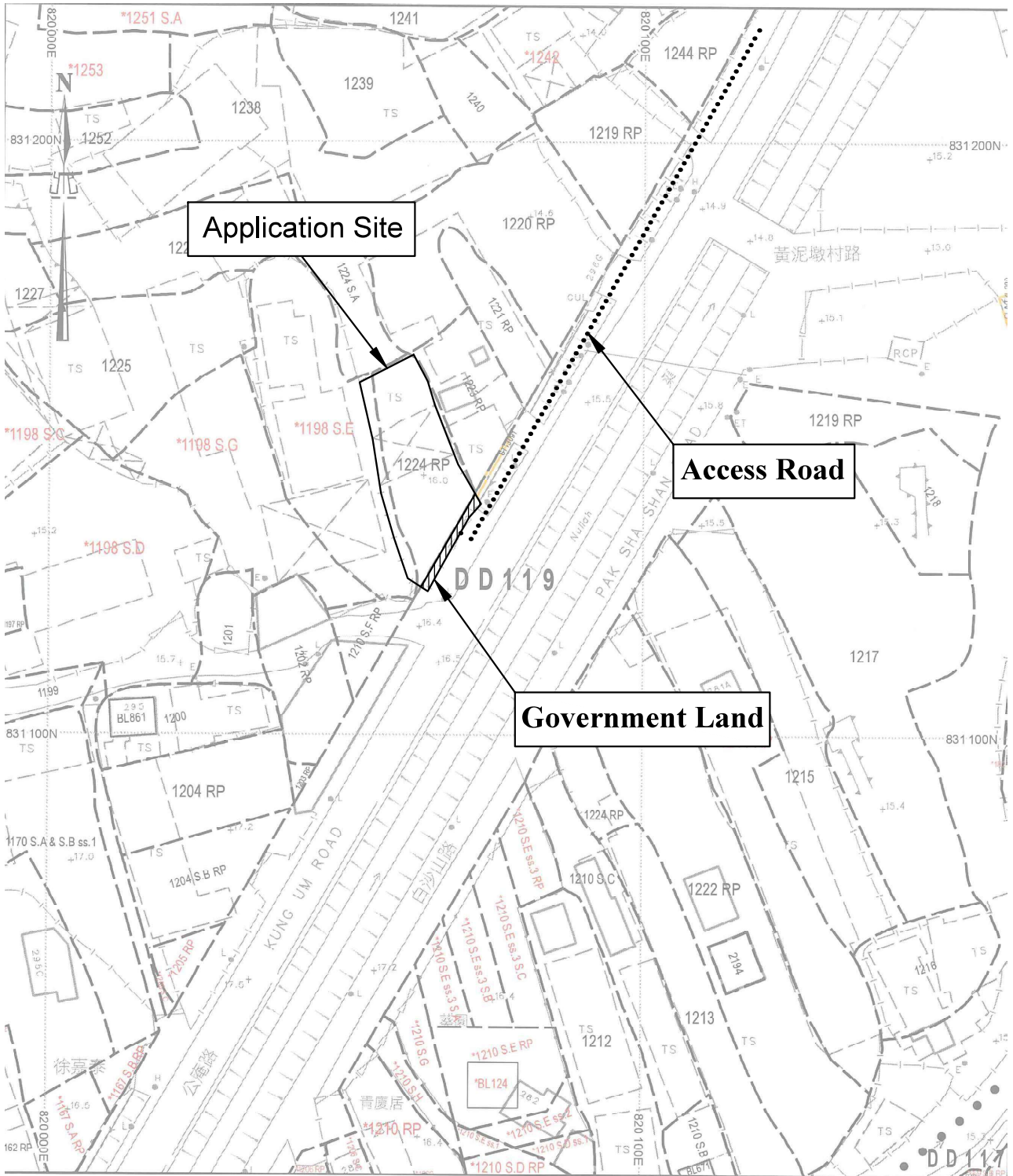

Private Land Area: 429.0m<sup>2</sup>  
 Government Land Area: 24.0m<sup>2</sup>  
**Total Area: 453.0m<sup>2</sup>**

|                  |   |   |
|------------------|---|---|
| <b>1:1000</b>    | <b>Lot Index Plan</b>   | <b>Goldrich Planners &amp; Surveyors Ltd.</b> |
| <b>July 2024</b> | Lots 1198E(Part), 1223 RP(Part), 1224 RP(Part)<br>in D.D. 119 and Adjoining G.L., Kung Um Road,<br>Yuen Long, New Territories | <b>Plan 2<br/>(A8052)</b>                     |

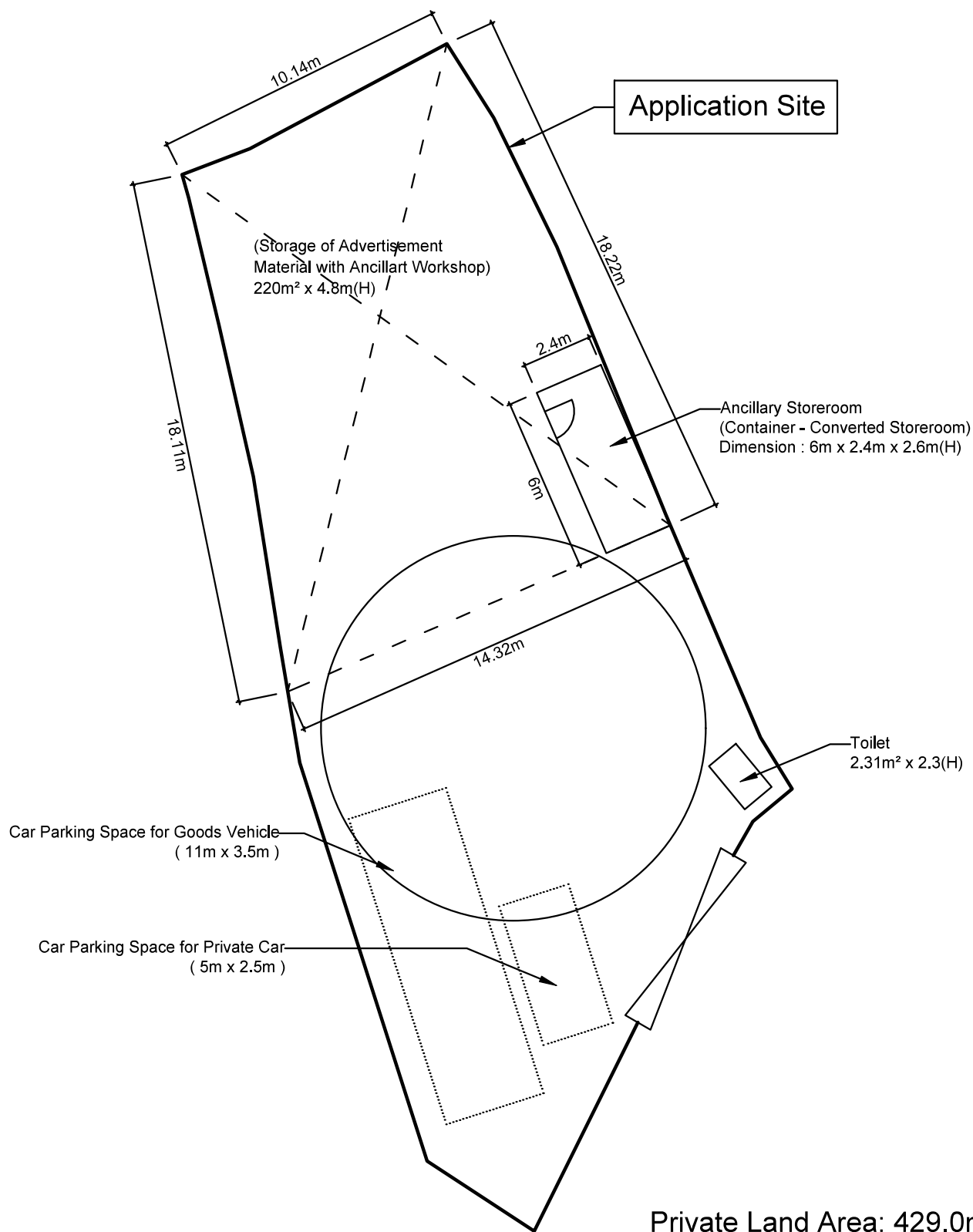

Private Land Area: 429.0m<sup>2</sup>  
Government Land Area: 24.0m<sup>2</sup>  
Total Area: 453.0m<sup>2</sup>

1:200

### Layout Plan

Goldrich Planners & Surveyors Ltd.

July 2024

Lots 1198E(Part), 1223 RP(Part), 1224 RP(Part)  
in D.D. 119 and Adjoining G.L., Kung Um Road,  
Yuen Long, New Territories

Plan 3  
(A8052)

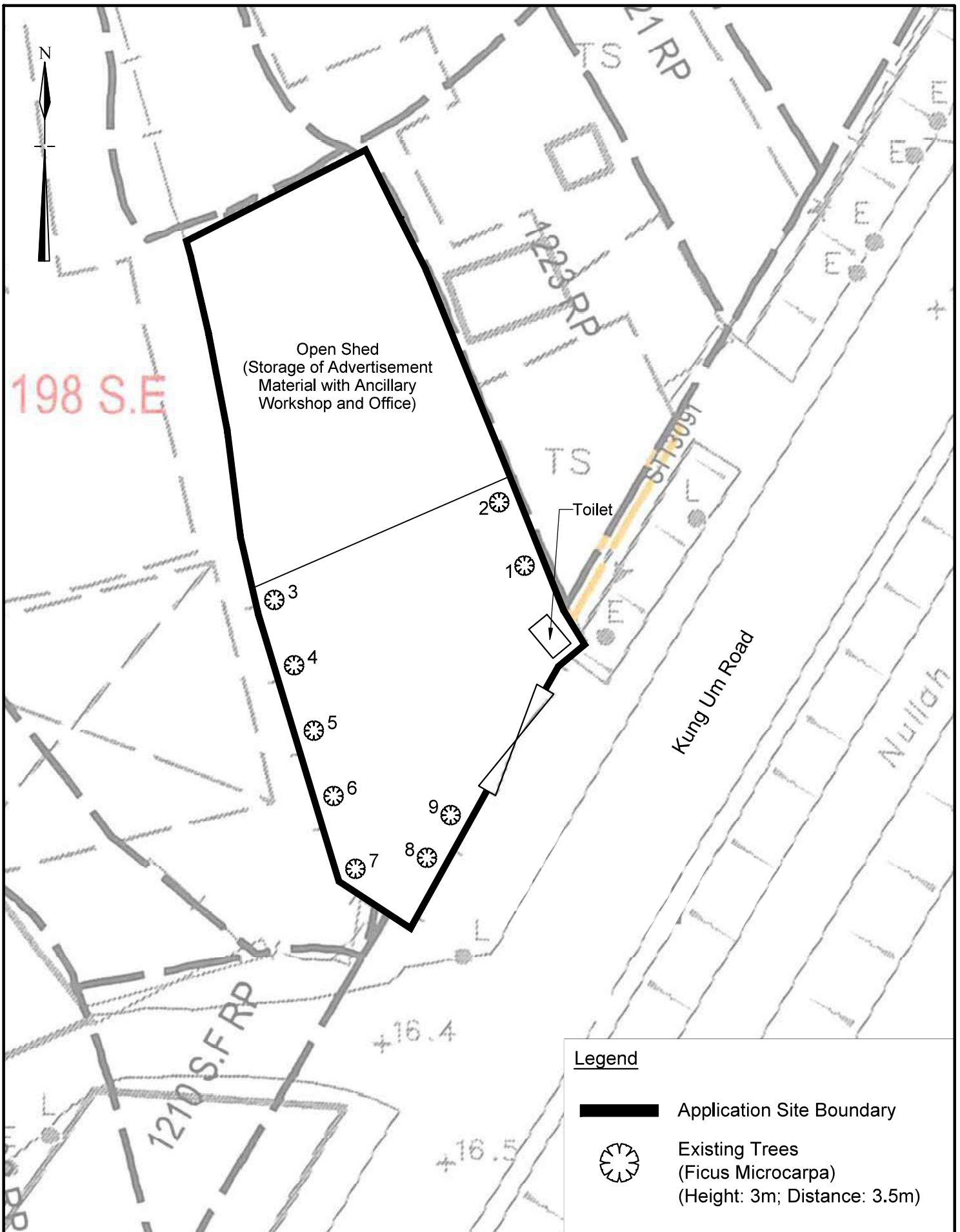

|           |   |                                    |
|-----------|---|------------------------------------|
| 1:250     | Landscape Proposal  | Goldrich Planners & Surveyors Ltd. |
| July 2024 | Lots 1198E(Part), 1223 RP(Part), 1224 RP(Part) in D.D. 119 and Adjoining G.L., Kung Um Road, Yuen Long, New Territories | Plan 4 (A8052)                     |

Note:

1. The adjoining sites have their own drainage facilities to discharge the water run-off from their site.
2. 10 cm spacing is provided under the metal sheet fencing to allow free flow of surface water.
3. The northern shed dips southward. Runoff collected on shed will be drained back to ground level within the site.

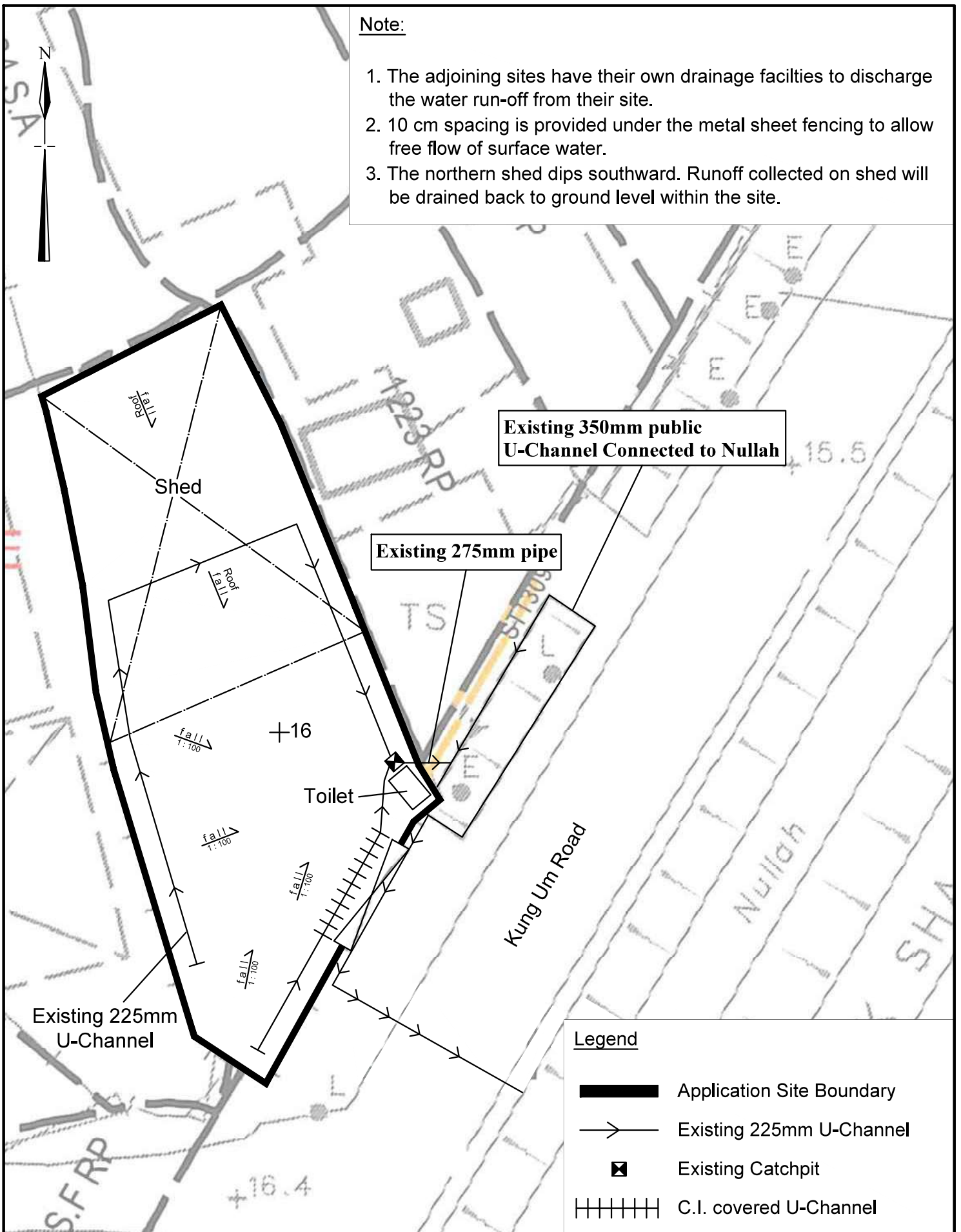

1:250

**Drainage Proposal**

**Goldrich Planners & Surveyors Ltd.**

**July 2024**

Lots 1198E(Part), 1223 RP(Part), 1224 RP(Part)  
in D.D. 119 and Adjoining G.L., Kung Um Road,  
Yuen Long, New Territories

**Plan 5  
(A8052)**

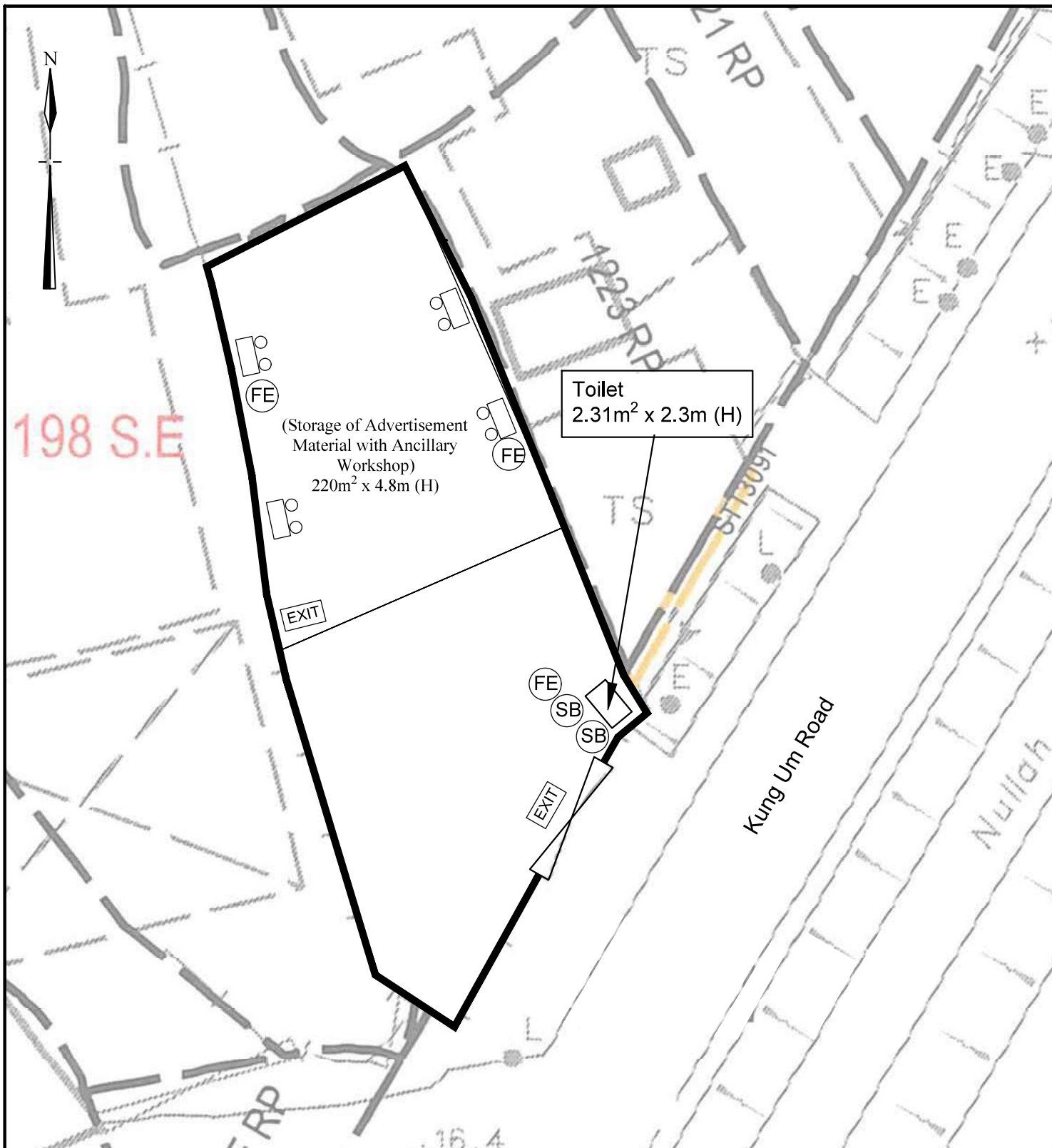

**FS NOTES:**

- (i) Sufficient emergency lighting shall be provided in accordance with BS 5266-1:2016, BS EN 1838:2013 and the FSD Circular Letter No. 4/2021
- (ii) Sufficient directional and exit sign shall be provided in accordance with BS 5266: Part 1 and FSD Circular Letter 5/2008.
- (iii) Portable hand-operated approved appliances shall be provided as required by occupancy.

**LEGEND:**

- 5.0公斤二氧化碳氣體 **5.0 Kg CO2 Gas type Fire Extinguisher**
- 出口 **Exit sign**
- 緊急照明燈 **Emergency Light**
- 沙筒 **Sand Bucket**

|                  |   |   |
|------------------|---|---|
| <b>1:250</b>     | <b>Fire Service Installation Proposal</b>   | <b>Goldrich Planners &amp; Surveyors Ltd.</b> |
| <b>July 2024</b> | Lots 1198E(Part), 1223 RP(Part), 1224 RP(Part)<br>in D.D. 119 and Adjoining G.L., Kung Um Road,<br>Yuen Long, New Territories | <b>Plan 6<br/>(A8052)</b>                     |

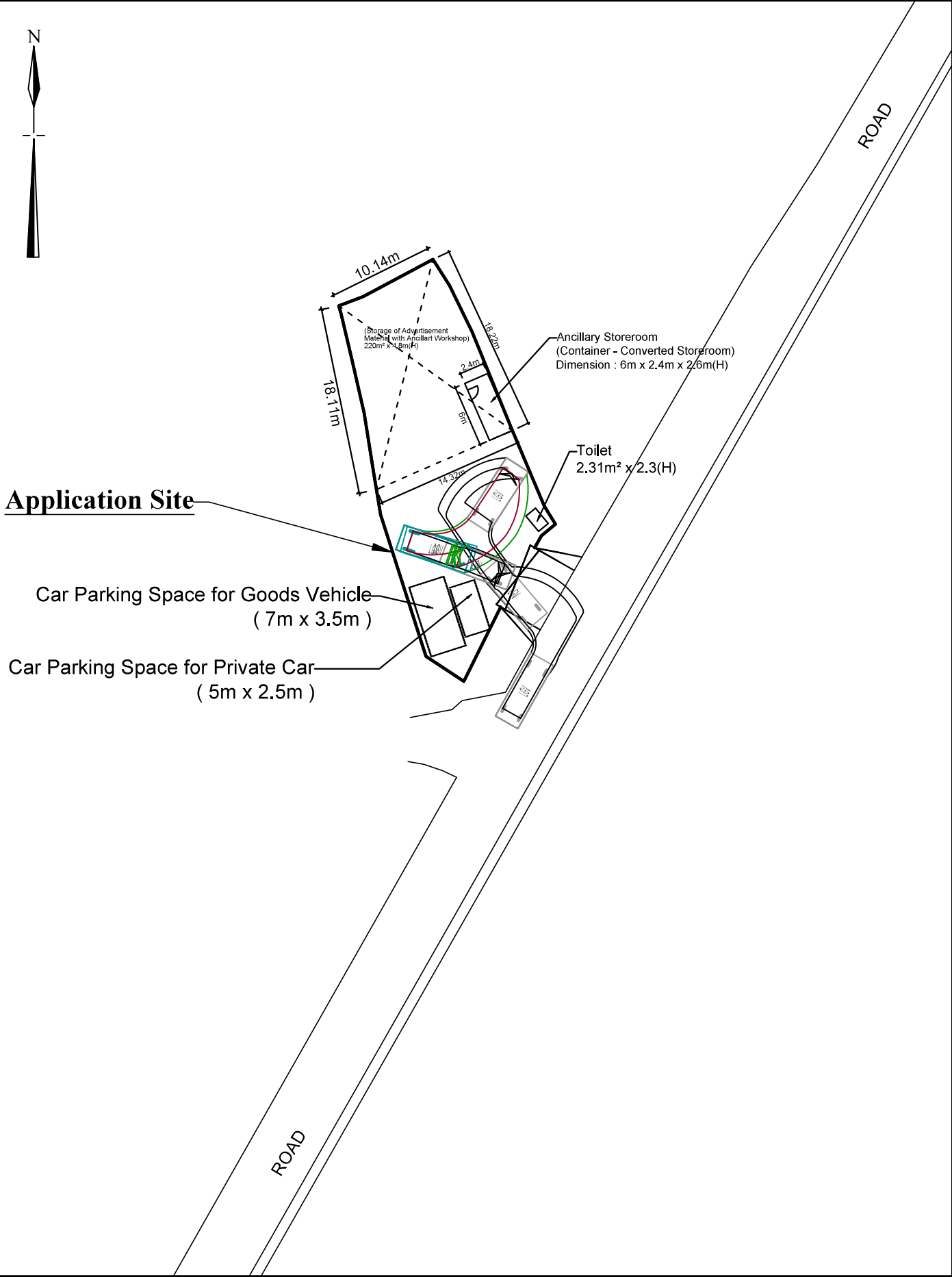

|                  |   |   |
|------------------|---|---|
| <b>1 : 500</b>   | <b>Swept Path Analysis</b><br><b>Lots 1198E(Part), 1223 RP(Part), 1224 RP(Part),</b><br><b>in D.D. 119 and Adjoining G.L., Kung Um Road,</b><br><b>Yuen Long, New Territories</b> | <b>Goldrich Planners &amp;</b><br><b>Surveyors Ltd.</b> |
| <b>July 2024</b> |   | <b>Plan 7</b><br><b>(A8052)</b>                         |