

Proposed Temporary Open Storage of Construction Machinery and Construction Materials with Ancillary Workshop & Office for a Period of 3 Years

at

Lots 2428 RP (Part), 2429 S.D (Part), 2704 S.A & S.B (Part), 2705 (Part), 2712 S.A (Part), 2712 S.B (Part), 2713 (Part), 2714 (Part), 2716 RP (Part), 2717 RP (Part), 2718 RP (Part) in D.D. 120 and Adjoining Government Land, Shan Ha Tsuen, Yuen Long, N.T.

Annex 1 Estimated Traffic Generation

- 1.1 The application site is accessible via a vehicular access leading from the tip of Shan Ha Road. The application site subject to seven planning permissions related to open storage activity since 2000. The current planning application is also intended for open storage use.
- 1.2 The estimated average traffic generation and traffic generation rate at peak hours are as follow:

Type of Vehicle	<u>Average Traffic Generation Rate</u> (pcu/hr)	<u>Average Traffic Attraction Rate</u> (pcu/hr)	<u>Traffic Generation Rate at Peak Hours</u> (pcu/hr)	<u>Traffic Attraction Rate at Peak Hours</u> (pcu/hr)
Private car	0.29	0.29	2	2
Medium goods vehicle (not exceeding 24 tonnes)	0.14	0.14	2	2
Total	0.43	0.43	4	4

Note 1: The opening hour of the proposed development is restricted to 9:00 a.m. to 11:00 p.m. from Mondays to Saturdays. No operation will be held on Sundays and public holidays.

Note 2: The pcu of private car & medium goods vehicle are taken as 1 and 2 respectively.

Note 3: Morning peak is defined as 7:00a.m. to 9:00a.m. whereas afternoon peak is defined as 5:00p.m. to 7:00p.m.

- 1.3 In association with the proposed development, adequate space for manoeuvring of vehicle would be provided as shown in **Figure 3**. The negligible increase in traffic would not aggravate the traffic condition of Shan Ha Road and nearby road networks.

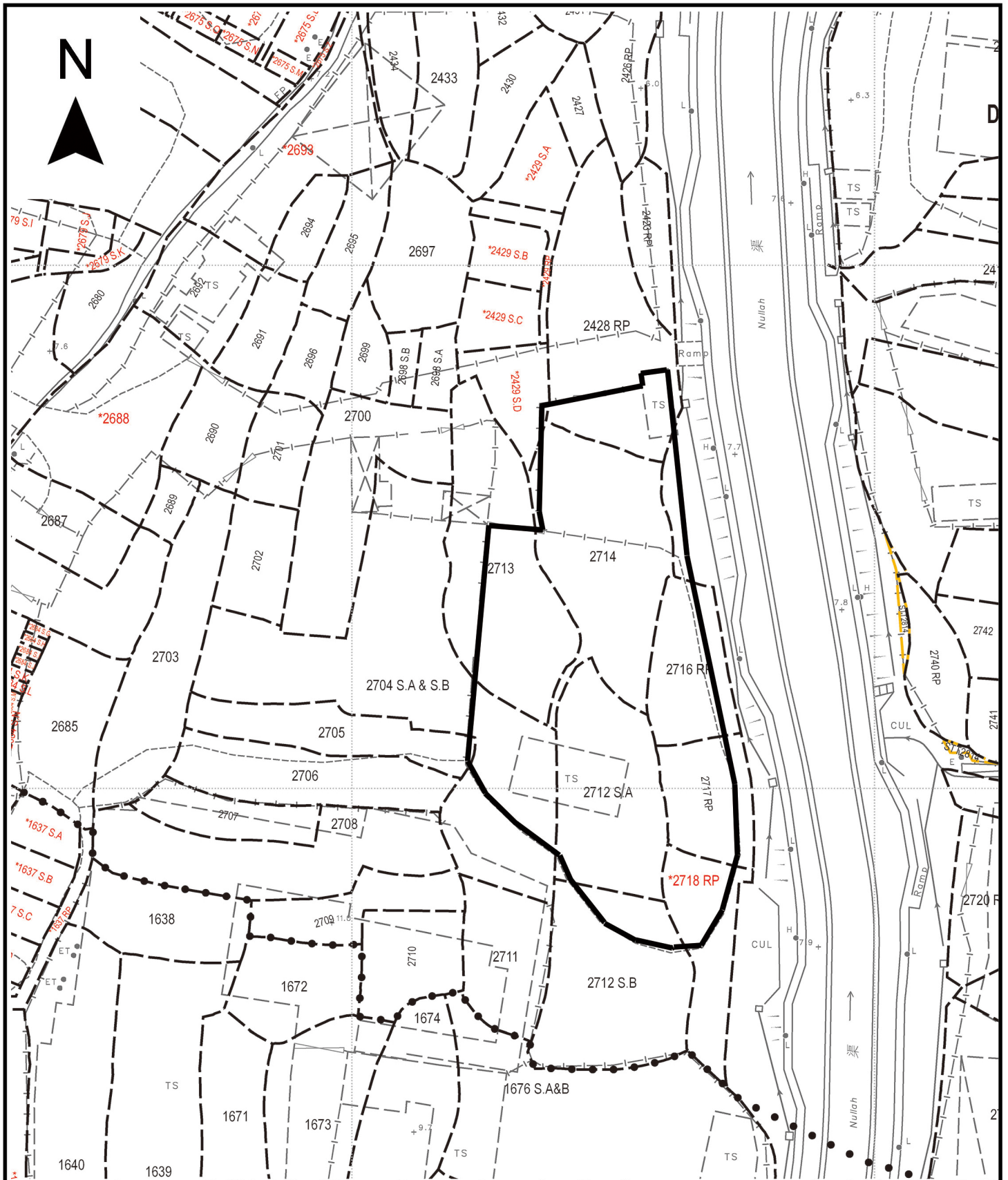

<p>Project 項目名稱: Proposed Temporary Open Storage of Construction Machinery and Construction Materials with Ancillary Workshop & Office for a Period of 3 Years at Lots 2428 RP (Part), 2429 S.D (Part), 2704 S.A & S.B (Part), 2705 (Part), 2712 S.A (Part), 2712 S.B (Part), 2713 (Part), 2714 (Part), 2716 RP (Part), 2717 RP (Part), 2718 RP (Part) in D.D. 120 and Adjoining Government Land, Shan Ha Tsuen, Yuen Long, N.T.</p>	<p>Drawing Title 圖目: Application Site</p>	<p>Remarks 備註:</p>
	<p>Drawing No. 圖號: Figure 1</p>	<p>Scale 比例: 1:1000</p>

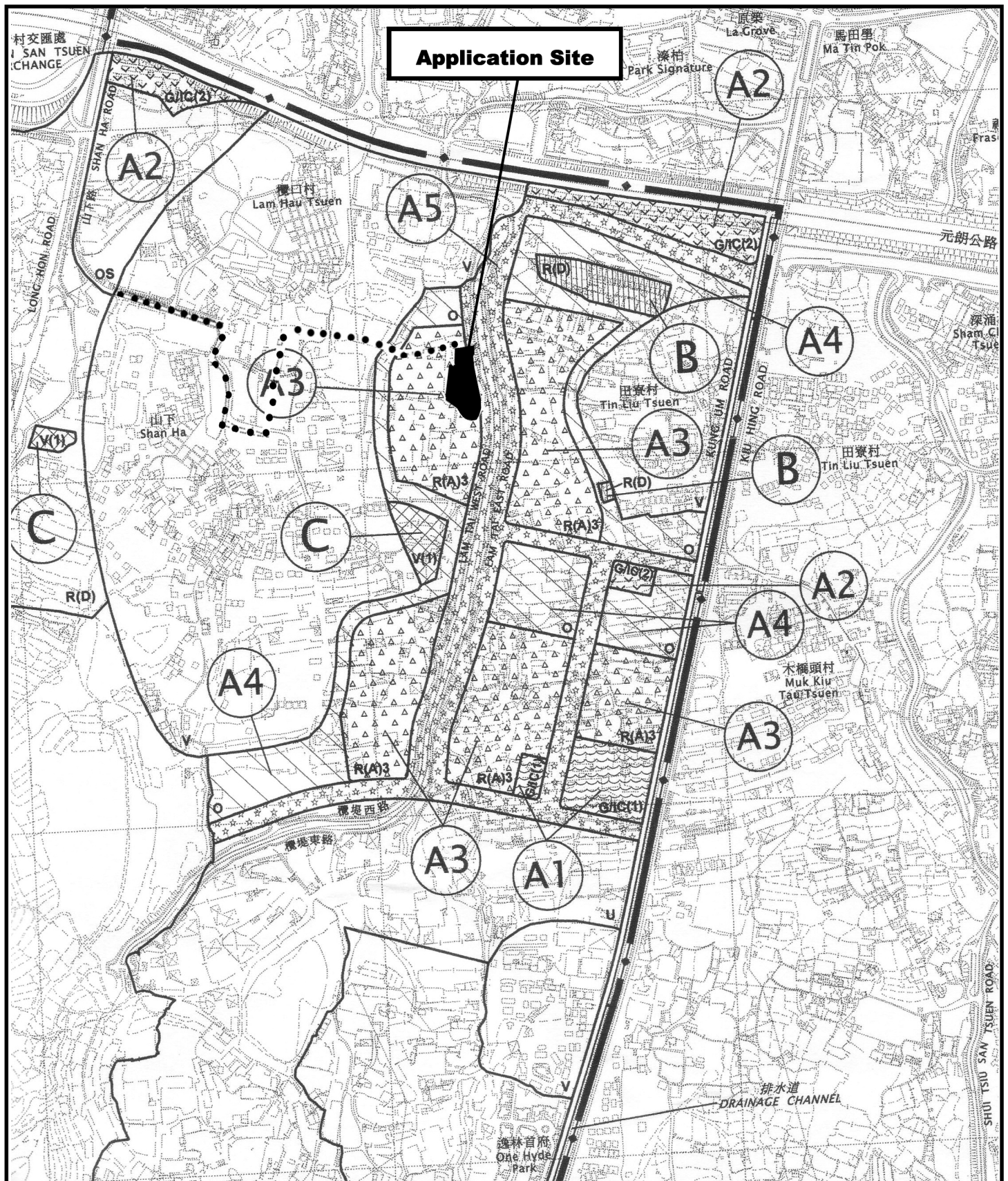

<p>Project 項目名稱: Proposed Temporary Open Storage of Construction Machinery and Construction Materials with Ancillary Workshop & Office for a Period of 3 Years at Lots 2428 RP (Part), 2429 S.D (Part), 2704 S.A & S.B (Part), 2705 (Part), 2712 S.A (Part), 2712 S.B (Part), 2713 (Part), 2714 (Part), 2716 RP (Part), 2717 RP (Part), 2718 RP (Part) in D.D. 120 and Adjoining Government Land, Shan Ha Tsuen, Yuen Long, N.T.</p>	<p>Drawing Title 圖目: Location Plan</p> <p>Drawing No. 圖號: Figure 2</p>	<p>Remarks 備註: ●●● Vehicular Access Leading from Shan Ha Road</p> <p>Scale 比例: 1:7500</p>
---	--	---



Structure 5

Site office below an open shed

GFA: Not exceeding 90m²

No. of storey: 1

Height: Not exceeding 4.5m

8m Ingress/
Egress

Structure 4

Site office

GFA: Not exceeding 20m²

No. of storey: 1

Height: Not exceeding 3.5m

8m Ingress/
Egress

Site 1

Open storage of construction
machinery & construction
materials

manoeuvring circle

Structure 2

Site office

GFA: Not exceeding 20m²

No. of storey: 1

Height: Not exceeding 3.5m

manoeu-
vring
circle

4 parking spaces of
5m x 2.5m for private car
and light goods vehicle

1 loading/unloading bay of
11m x 3.5m for medium
goods vehicle

Structure 3

Guard room

GFA: Not exceeding 4m²

No. of storey: 1

Height: Not exceeding 3.5m

Site 2

Open storage of construction
machinery & construction
materials with ancillary workshop
under Structure 1

Structure 1

Open shed for storage use &
ancillary workshop

GFA: Not exceeding 480m²

No. of storey: 1

Height: Not exceeding 6.5m

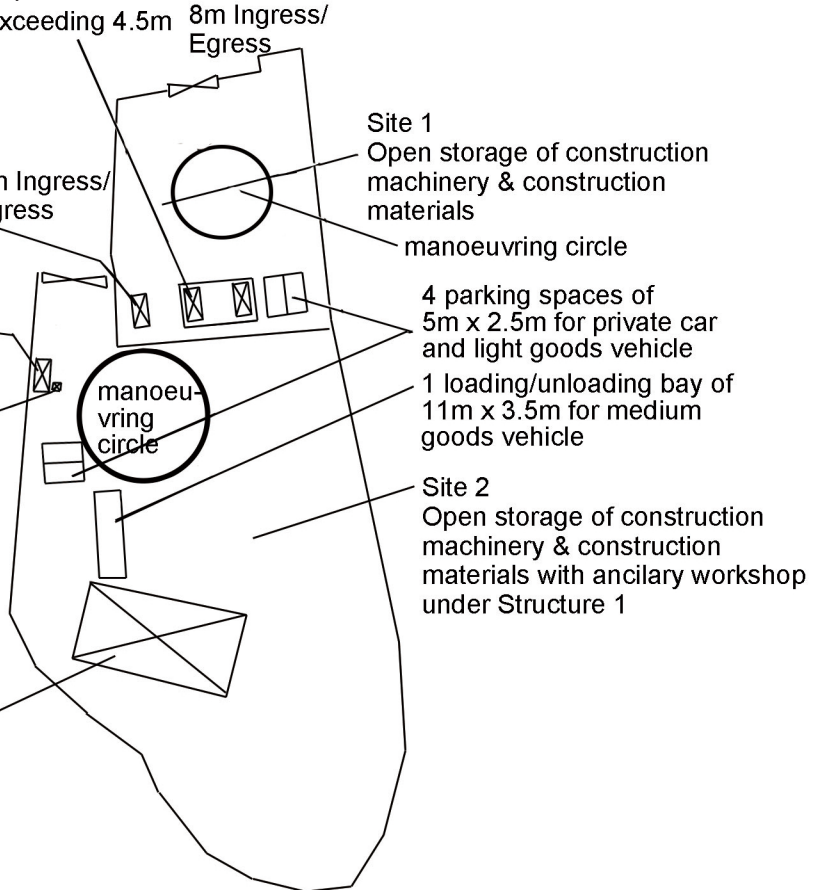

<p>Project 項目名稱: Proposed Temporary Open Storage of Construction Machinery and Construction Materials with Ancillary Workshop & Office for a Period of 3 Years at Lots 2428 RP (Part), 2429 S.D (Part), 2704 S.A & S.B (Part), 2705 (Part), 2712 S.A (Part), 2712 S.B (Part), 2713 (Part), 2714, 2716 RP (Part), 2717 RP (Part), 2718 RP (Part) in D.D. 120 and Adjoining Government Land, Shan Ha Tsuen, Yuen Long, N.T.</p>	<p>Drawing Title 圖目: Proposed Layout Plan</p> <p>Drawing No. 圖號: Figure 3</p>	<p>Remarks 備註:</p> <p>Scale 比例: 1:1000</p>
---	---	--

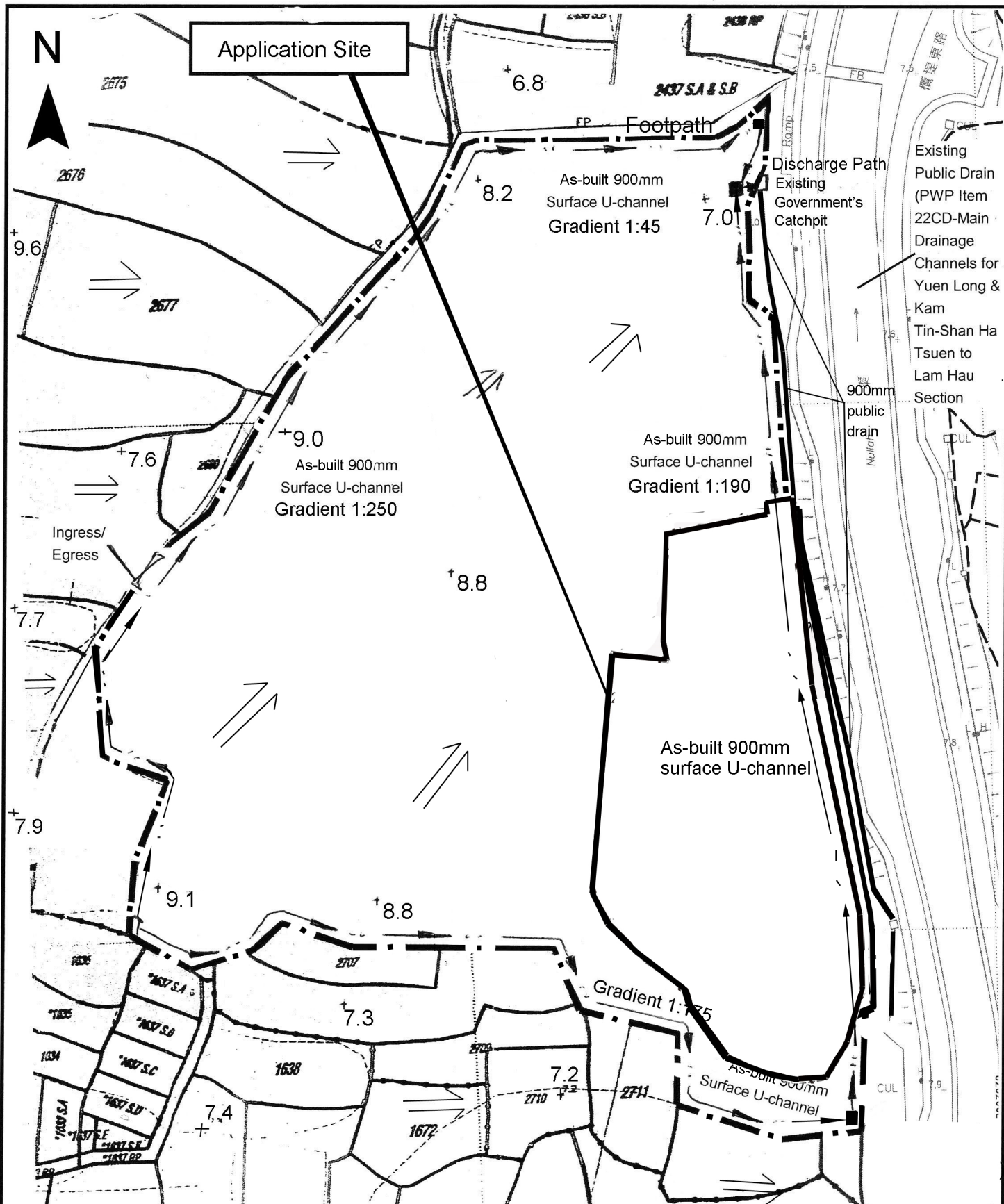

Project 項目名稱:

Proposed Temporary Open Storage of Construction Machinery and Construction Materials with Ancillary Workshop & Office for a Period of 3 Years at Lots 2428 RP (Part), 2429 S.D (Part), 2704 S.A & S.B (Part), 2705 S.D (Part), 2712 S.A (Part), 2712 S.B (Part), 2713 (Part), 2714 (Part), 2716 RP (Part), 2717 RP (Part), 2718 RP (Part) in D.D. 120 and Adjoining Government Land, Shan Ha Tsuen, Yuen Long, N.T.

Drawing Title 圖目:

As-built Drainage Plan

Drawing No. 圖號:

Figure 4

Remarks 備註:

- +7.5 Level (mPD)
- ⇒ Flow of Surface Runoff
- Proposed catchpit
- - - Site boundary of A/YL-TYST/458 approved by TPB in 2009
- Approved drainage plan for A/YL-TYST/458 via ex-aplicant's letter dated 23.7.2010

Scale 比例:

1:1000