

Appendix D Updated Indicative Architectural Drawings

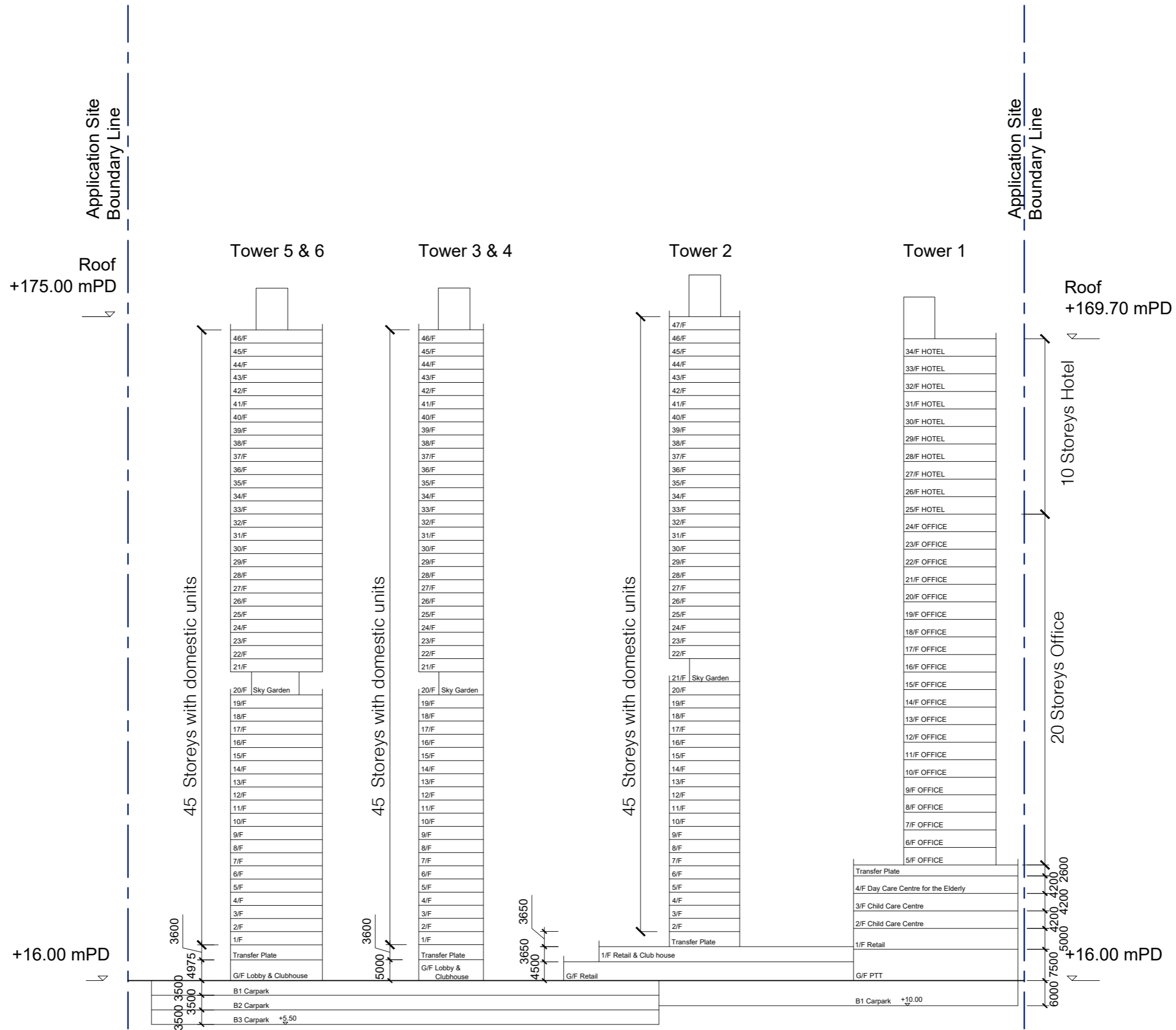

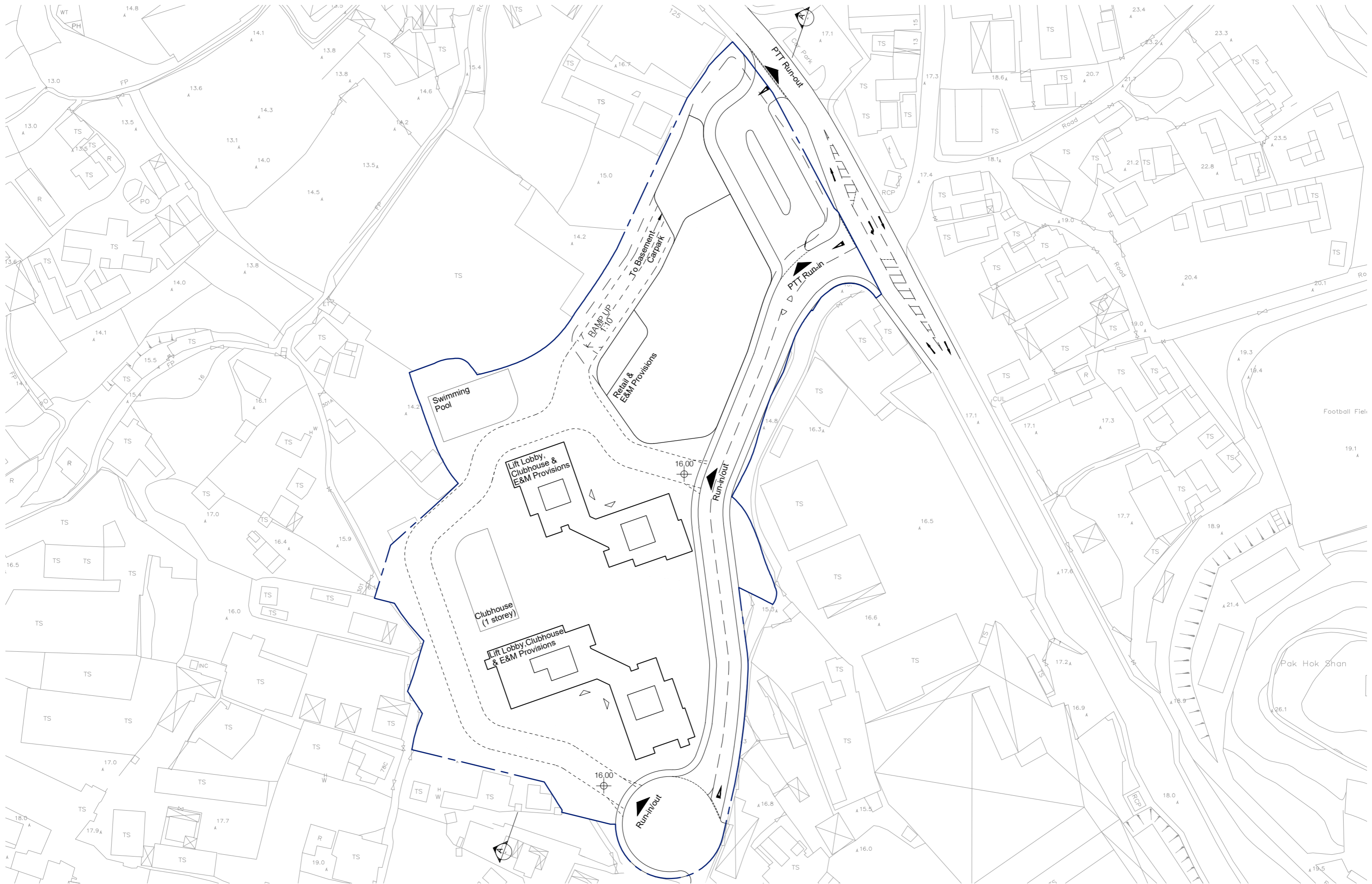



GROUND FLOOR PLAN SK-3
 PROPOSED DEVELOPMENT AT PING CHE DD77, N.T.

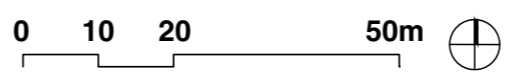

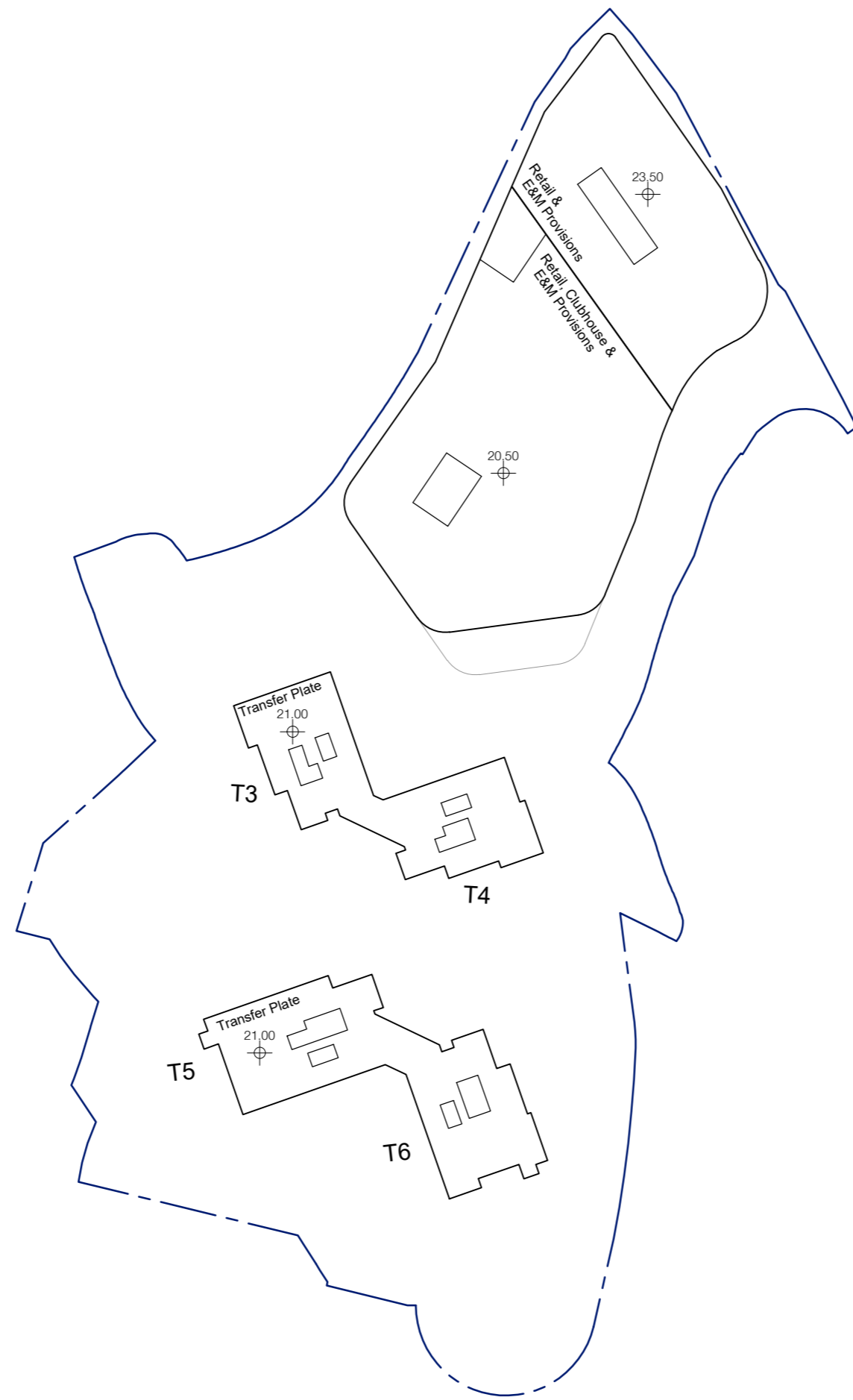

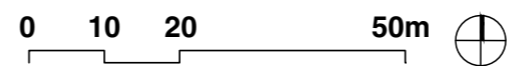
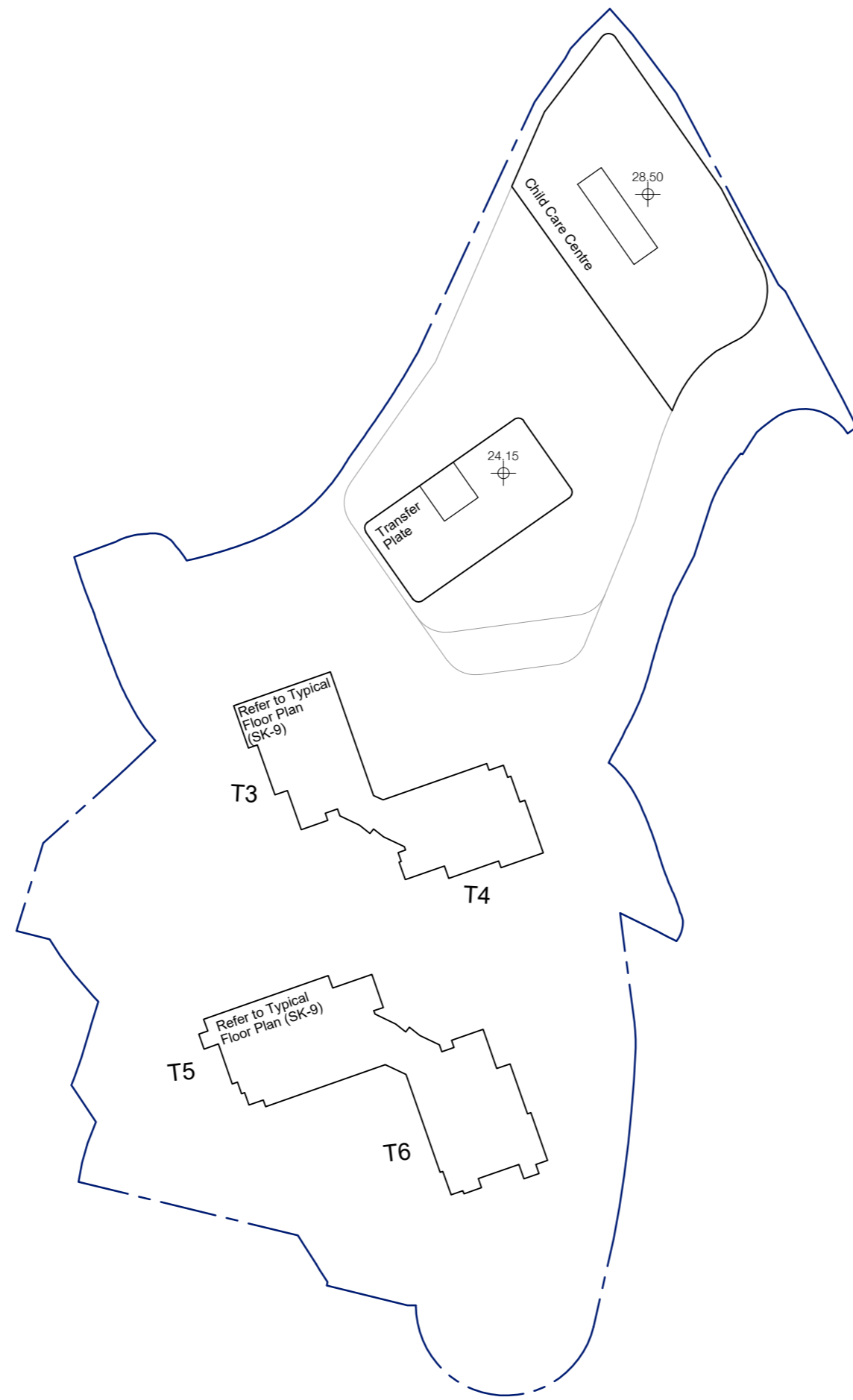

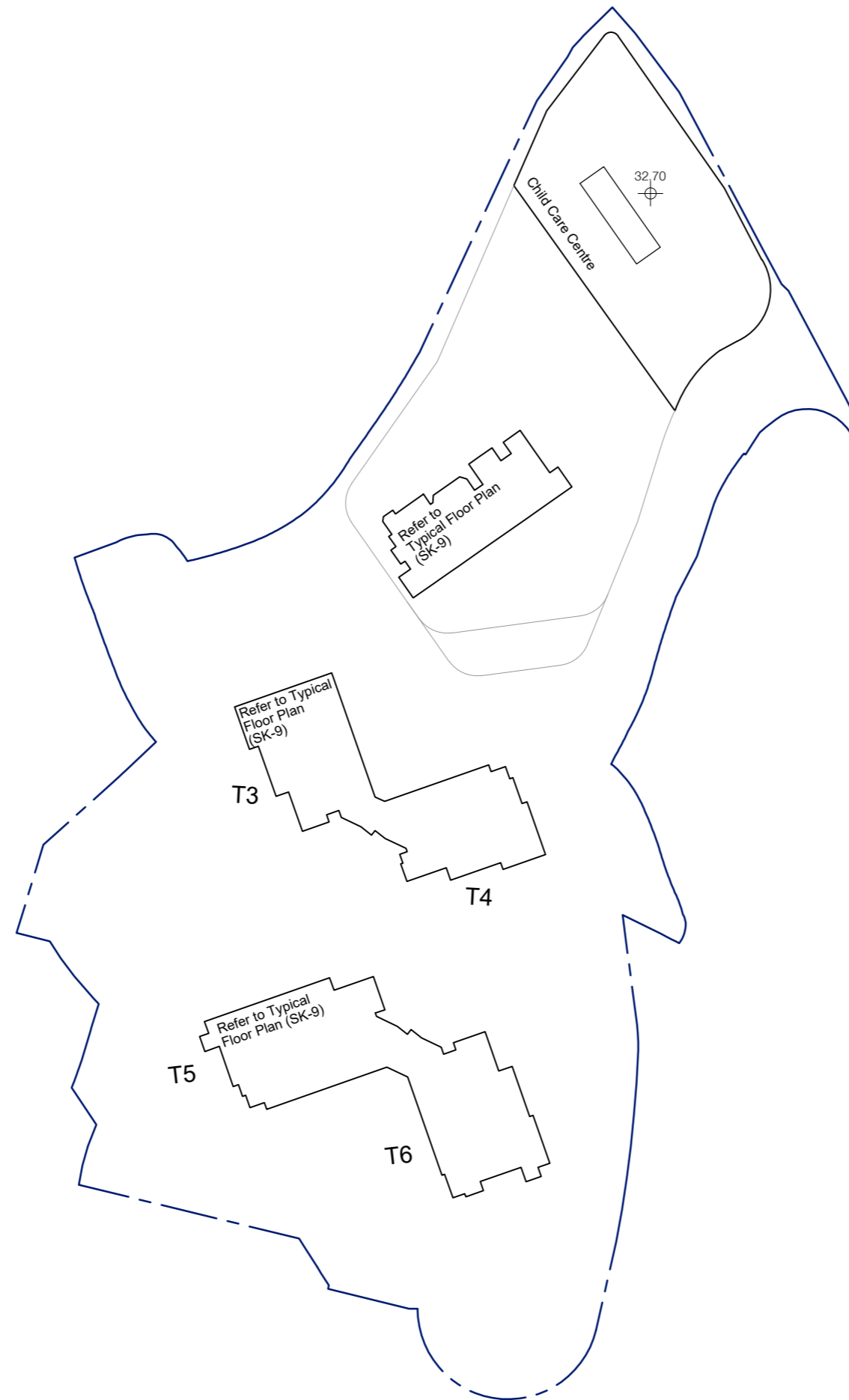

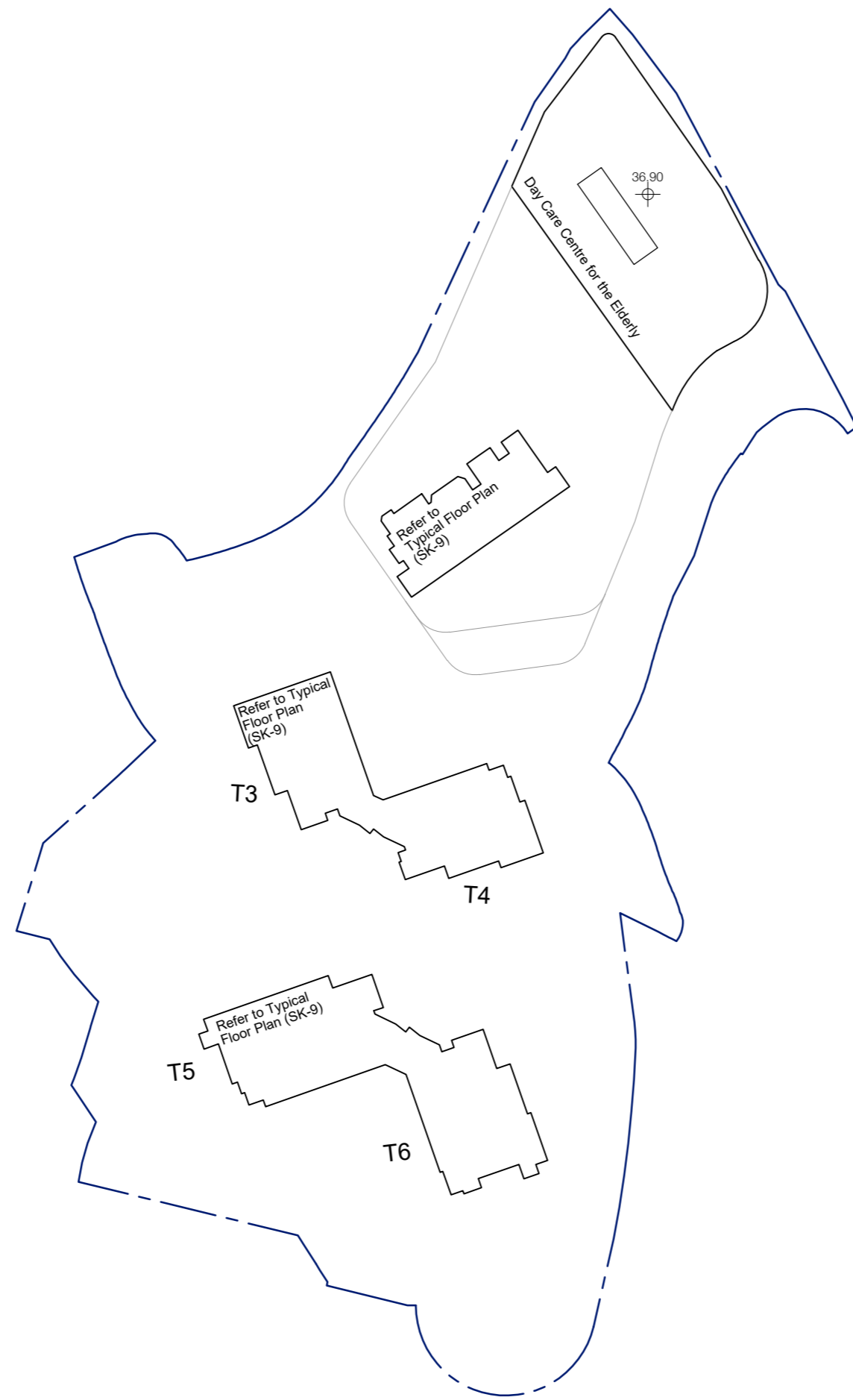

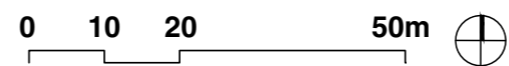
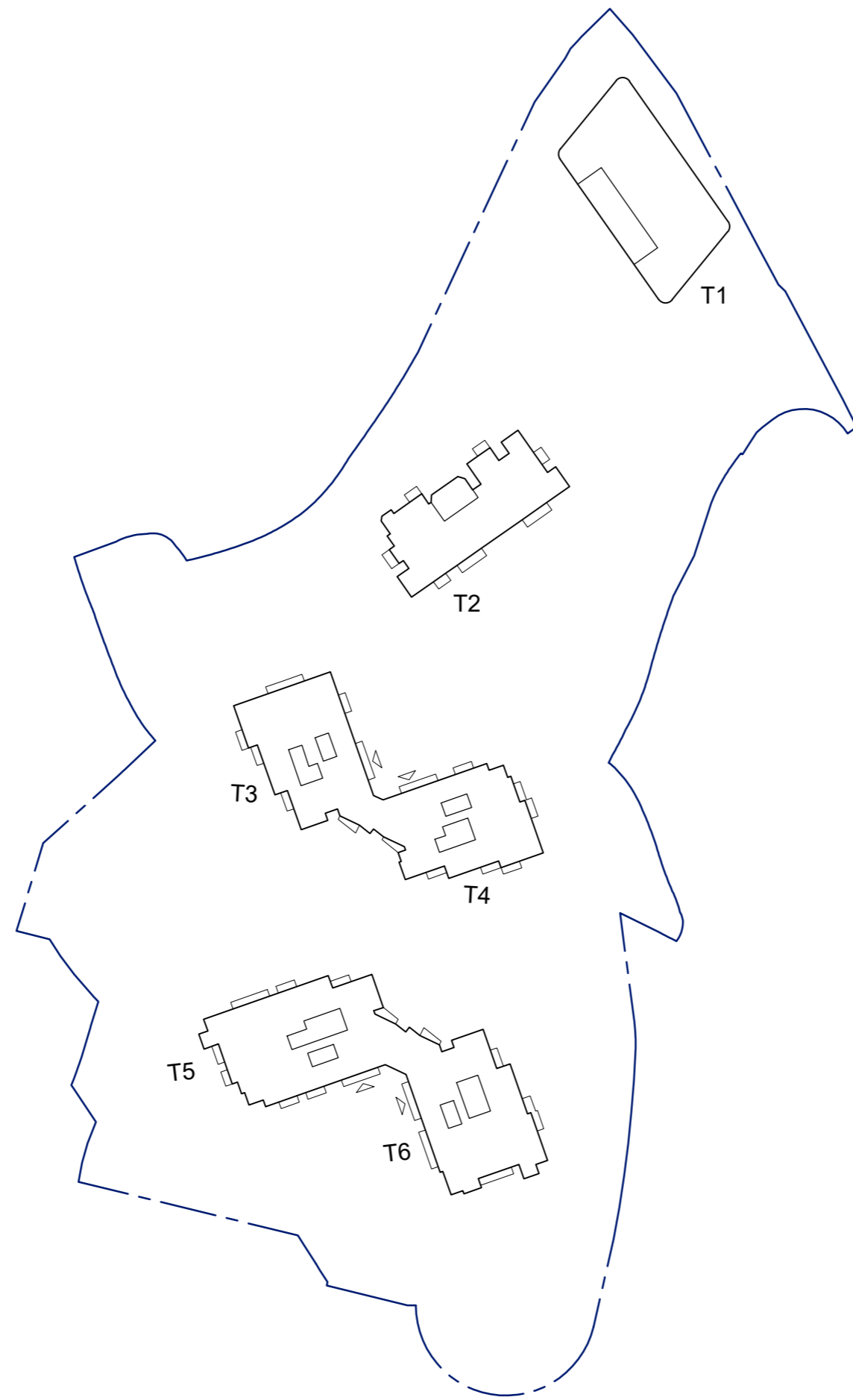

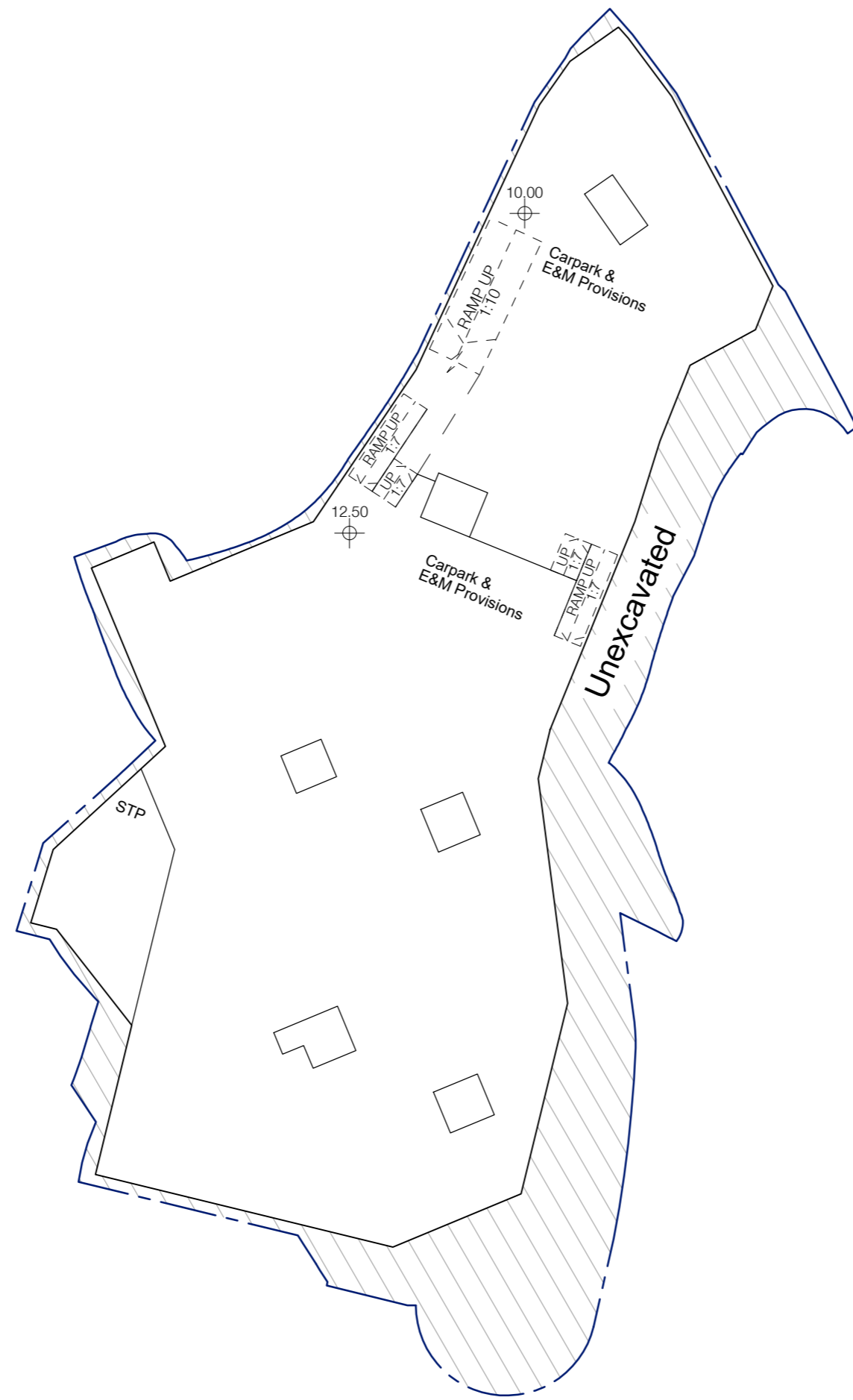

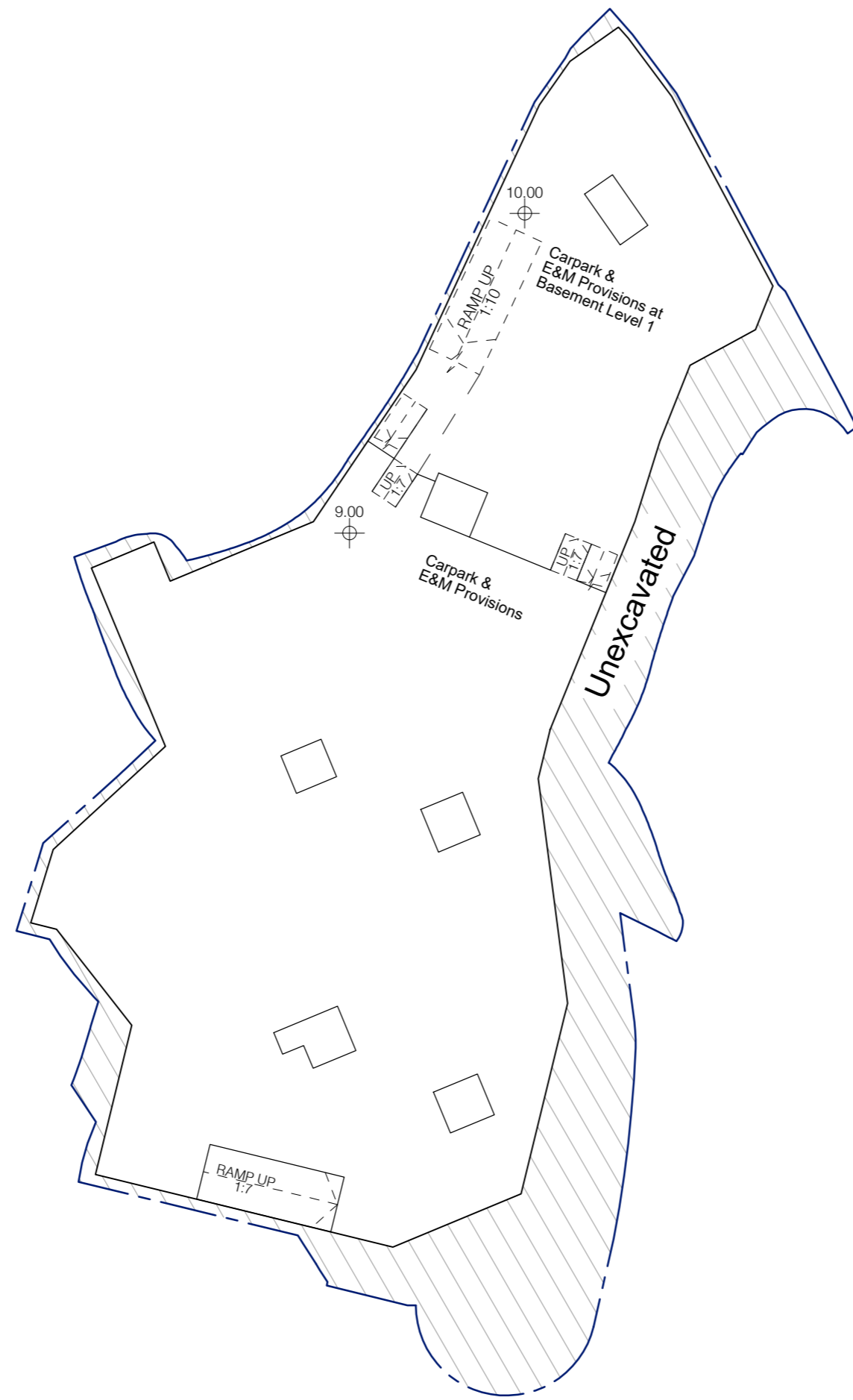

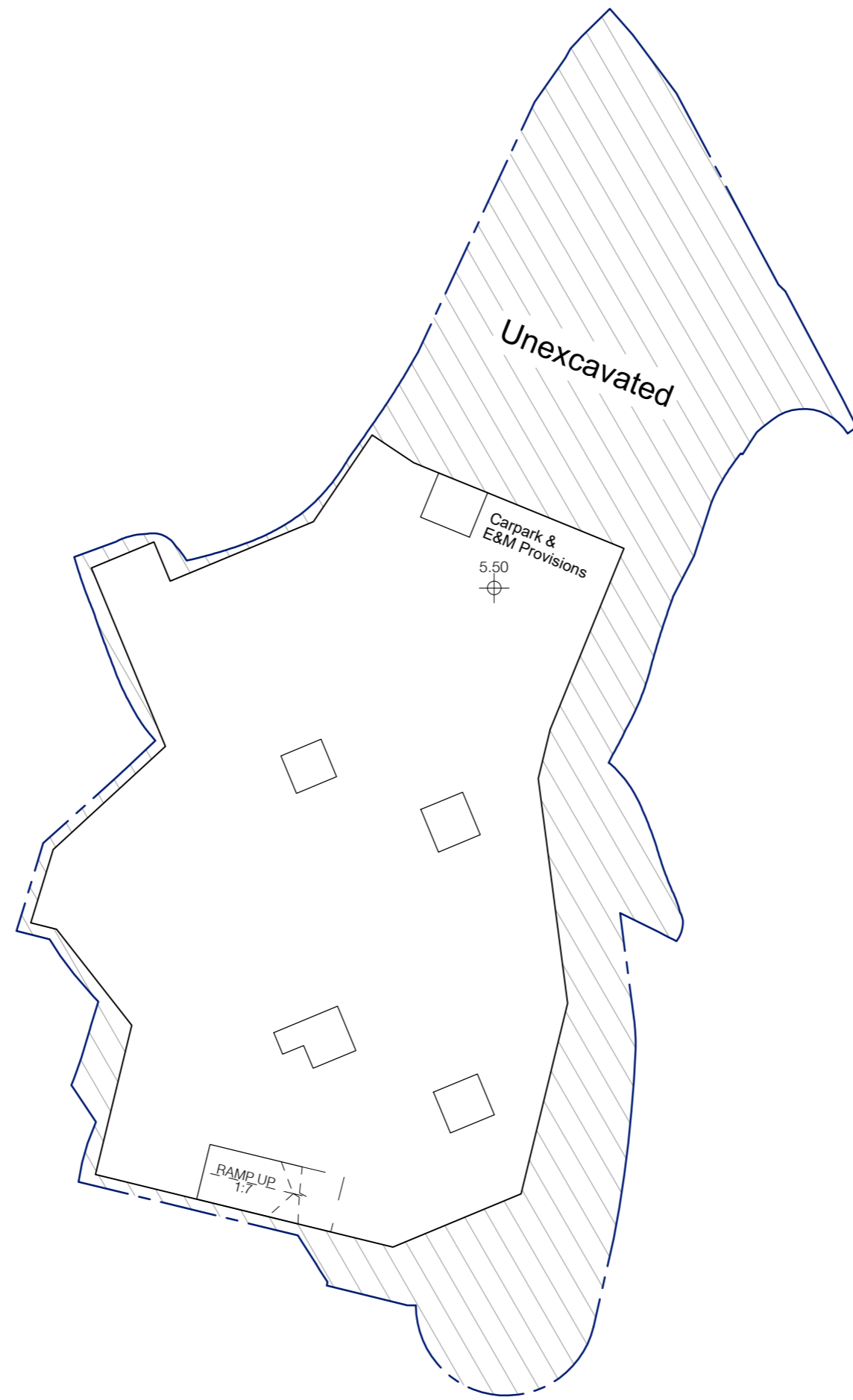

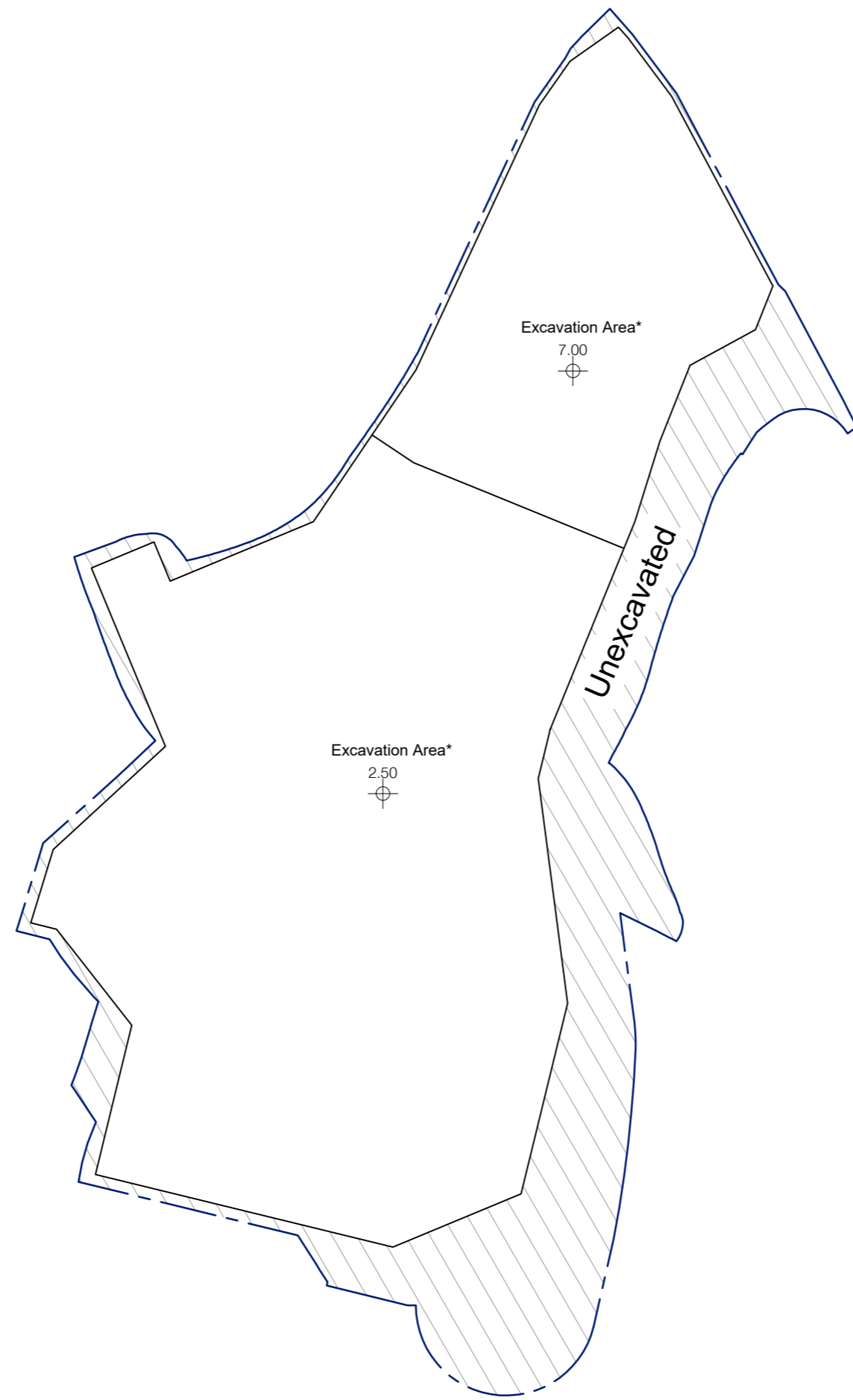

*The excavation area is about 13,500m² and the excavation depth is about 13.5m. The excavation area and depth are subject to future detailed design on foundation based on further geotechnical information.

