

**Broad Development Parameters of the Applied Use/Development
in respect of Application No. A/NE-TK/793**

关于申请编号 A/NE-TK/793 的拟议用途/发展的概括发展规范

| | |
|---|---|
| Application No. 申请编号 | A/NE-TK/793 |
| Location/address 位置/地址 | Lot 391 S.A in D.D. 28, Lung Mei, Tai Po, New Territories 新界大埔龙尾丈量约份第 28 约地段第 391 号 A 分段 |
| Site area 地盘面积 | About 约 162.1 sq. m 平方米 |
| Plan 图则 | Approved Ting Kok Outline Zoning Plan No. S/NE-TK/19 汀角分区计划大纲核准图编号 S/NE-TK/19 |
| Zoning 地带 | "Green Belt" 「绿化地带」 |
| Applied use/ development 申请用途/发展 | Proposed House (New Territories Exempted House - Small House) 拟议屋宇 (新界豁免管制屋宇-小型屋宇) |
| Proposed Gross floor area 拟议总楼面面积 | 195.09 sq. m 平方米 |
| Proposed No. of house(s) 拟议幢数 | 1 |
| Proposed Building height/No. of storeys 拟议建筑物高度/ 层数 | Not more than 不多於 8.23 m 米 |
| | 3 Storey(s) 层 |

* 有关资料是为方便市民大众参考而提供。对于所载资料在使用上的问题及文义上的歧异，城市规划委员会概不负责。若有任何疑问，应查阅申请人提交的文件。

The information is provided for easy reference of the general public. Under no circumstances will the Town Planning Board accept any liabilities for the use of the information nor any inaccuracies or discrepancies of the information provided. In case of doubt, reference should always be made to the submission of the applicant.

| Submitted Plans, Drawings and Documents 提交的图则、绘图及文件 | | |
|--|-------------------------------------|-------------------------------------|
| | <u>Chinese</u> 中文 | <u>English</u> 英文 |
| <u>Plans and Drawings 图则及绘图</u> | | |
| Master layout plan(s)/Layout plan(s) 总纲发展蓝图／布局设计图 | <input type="checkbox"/> | <input checked="" type="checkbox"/> |
| Block plan(s) 楼宇位置图 | <input type="checkbox"/> | <input type="checkbox"/> |
| Floor plan(s) 楼宇平面图 | <input type="checkbox"/> | <input type="checkbox"/> |
| Sectional plan(s) 截视图 | <input type="checkbox"/> | <input type="checkbox"/> |
| Elevation(s) 立视图 | <input type="checkbox"/> | <input type="checkbox"/> |
| Photomontage(s) showing the proposed development 显示拟议发展的合成照片 | <input type="checkbox"/> | <input type="checkbox"/> |
| Master landscape plan(s)/Landscape plan(s) 园境设计总图／园境设计图 | <input type="checkbox"/> | <input type="checkbox"/> |
| Others (please specify) 其他（请注明） | <input type="checkbox"/> | <input checked="" type="checkbox"/> |
| <u>Location Plan 位置图</u> | | |
| <u>Sewerage Proposal 排污建议</u> | | |
| <u>Reports 报告书</u> | | |
| Planning Statement / Justifications 规划纲领 / 理据 | <input type="checkbox"/> | <input type="checkbox"/> |
| Environmental assessment (noise, air and/or water pollutions) 环境评估（噪音、空气及／或水的污染） | <input type="checkbox"/> | <input type="checkbox"/> |
| Traffic impact assessment (on vehicles) 就车辆的交通影响评估 | <input type="checkbox"/> | <input type="checkbox"/> |
| Traffic impact assessment (on pedestrians) 就行人的交通影响评估 | <input type="checkbox"/> | <input type="checkbox"/> |
| Visual impact assessment 视觉影响评估 | <input type="checkbox"/> | <input type="checkbox"/> |
| Landscape impact assessment 景观影响评估 | <input type="checkbox"/> | <input type="checkbox"/> |
| Tree Survey 树木调查 | <input type="checkbox"/> | <input type="checkbox"/> |
| Geotechnical impact assessment 土力影响评估 | <input type="checkbox"/> | <input type="checkbox"/> |
| Drainage impact assessment 排水影响评估 | <input type="checkbox"/> | <input type="checkbox"/> |
| Sewerage impact assessment 排污影响评估 | <input type="checkbox"/> | <input type="checkbox"/> |
| Risk Assessment 风险评估 | <input type="checkbox"/> | <input type="checkbox"/> |
| Others (please specify) 其他（请注明） | <input checked="" type="checkbox"/> | <input checked="" type="checkbox"/> |
| <u>Details of Previous Planning Approval 先前规划许可的详情</u> | | |
| Note: May insert more than one 「✓」. 注：可在多於一个方格内加上「✓」号 | | |

Note: The information in the Gist of Application above is provided by the applicant for easy reference of the general public. Under no circumstances will the Town Planning Board accept any liabilities for the use of the information nor any inaccuracies or discrepancies of the information provided. In case of doubt, reference should always be made to the submission of the applicant.

注：上述申请摘要的资料是由申请人提供以方便市民大众参考。对于所载资料在使用上的问题及文义上的歧异，城市规划委员会概不负责。若有任何疑问，应查阅申请人提交的文件。

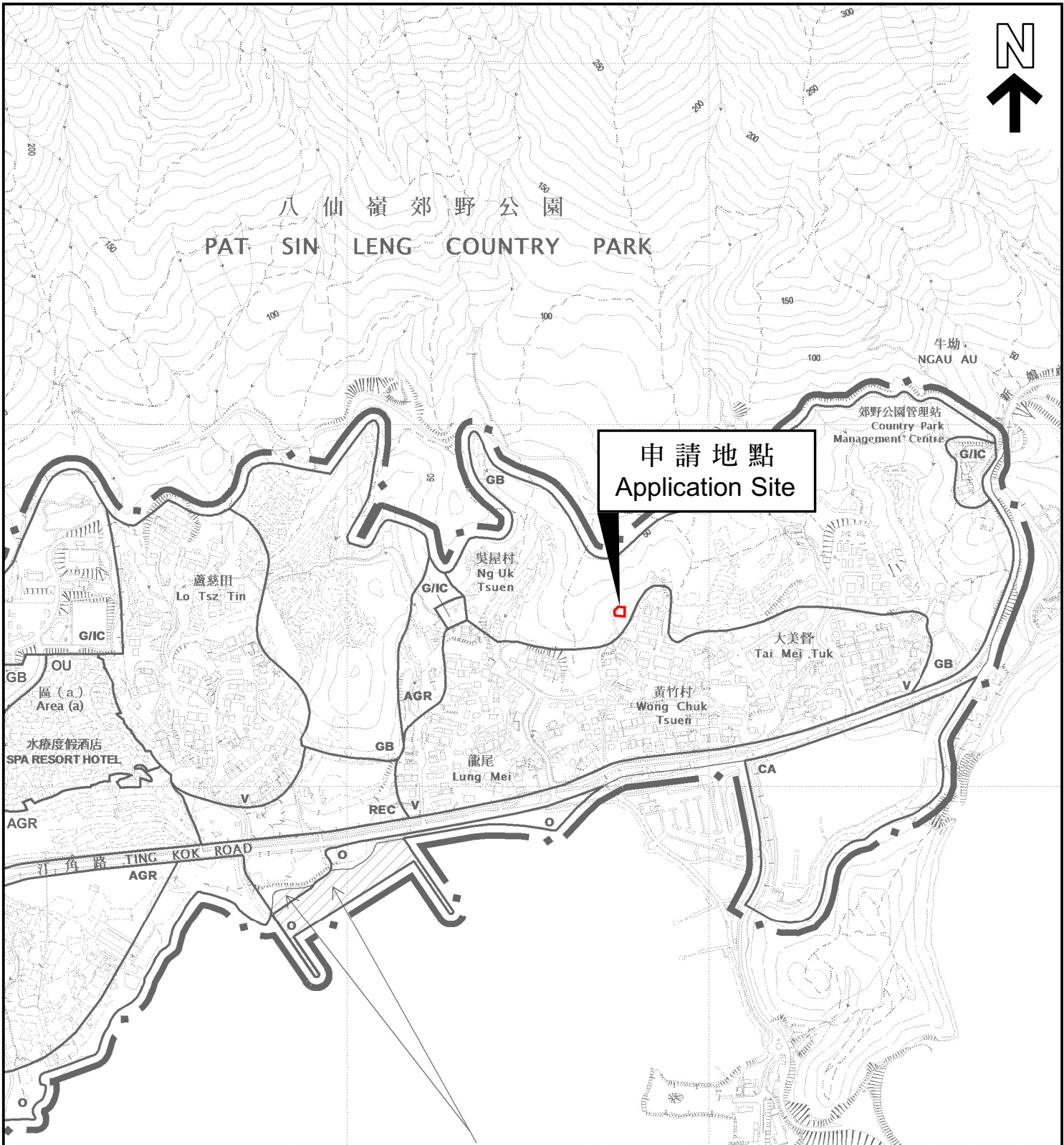

這是1990年9月7日在憲報公布的中期發展審批地區圖編號 IDPA/NE-TK/1 沒有涵蓋的範圍，但已包括在汀角分區計劃大綱草圖編號 S/NE-TK/14 的規劃區內。
 AREA NOT FALLING WITHIN THE BOUNDARIES OF THE IDPA PLAN No. IDPA/NE-TK/1 PUBLISHED IN THE GAZETTE ON 7.9.1990 BUT INCLUDED IN THE PLANNING SCHEME AREA ON THE DRAFT TING KOK OUTLINE ZONING PLAN No. S/NE-TK/14.

本摘要圖於2024年1月31日擬備，所根據的資料為於2015年10月27日核准的分區計劃大綱圖編號S/NE-TK/19
 EXTRACT PLAN PREPARED ON 31.1.2024 BASED ON OUTLINE ZONING PLAN No. S/NE-TK/19 APPROVED ON 27.10.2015

位置圖 LOCATION PLAN

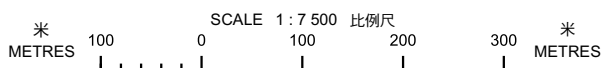

申請地點界線只作識別用
 APPLICATION SITE BOUNDARY FOR IDENTIFICATION PURPOSE ONLY

參考編號
 REFERENCE No.
A/NE-TK/793

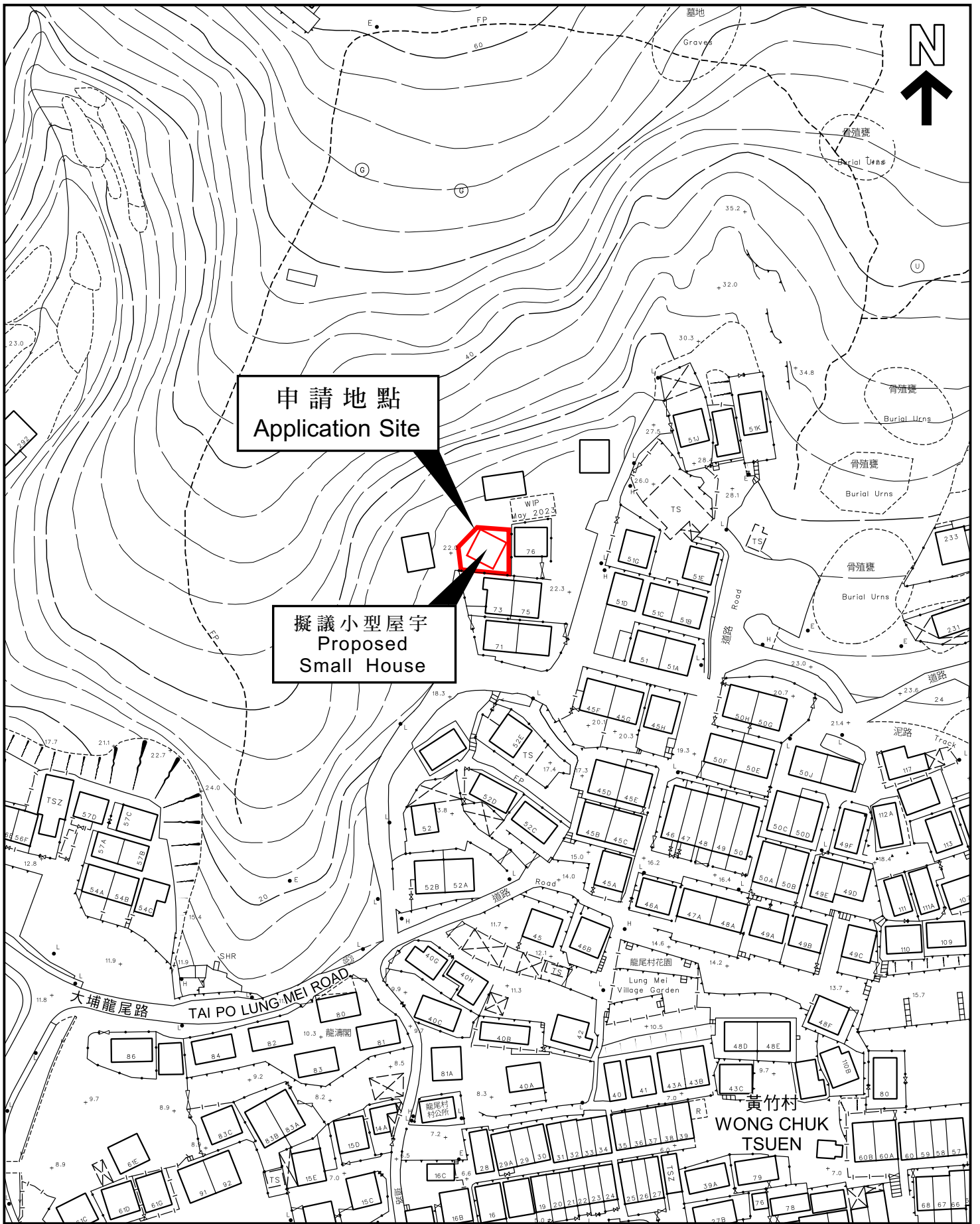

本摘要圖於2024年1月31日擬備，
 所根據的資料為測量圖編號
 3-SE-18D、19C、23B 及24A
 EXTRACT PLAN PREPARED ON 31.1.2024
 BASED ON SURVEY SHEETS No.
 3-SE-18D, 19C, 23B & 24A

平面圖 SITE PLAN

申請地點界線只作識別用
 APPLICATION SITE BOUNDARY
 FOR IDENTIFICATION PURPOSE ONLY

參考編號
 REFERENCE No.
A/NE-TK/793